

YOUR OFFICE
BY DAY



THE **MIGHTY** *WORKSPACE*

@ 1 DAVID ORTIZ DRIVE, BOSTON, MA



OUR BREWERY
BY NIGHT

UNIQUE SUBLEASE OPPORTUNITY

IN THE FENWAY
NEIGHBORHOOD



**4,500 SF
OF WORKSPACE**
on 2nd Floor

THE SQUIRREL DEN

AVAILABLE FOR SUBLEASE:

Monday - Friday

7:00 AM - 5:00 PM

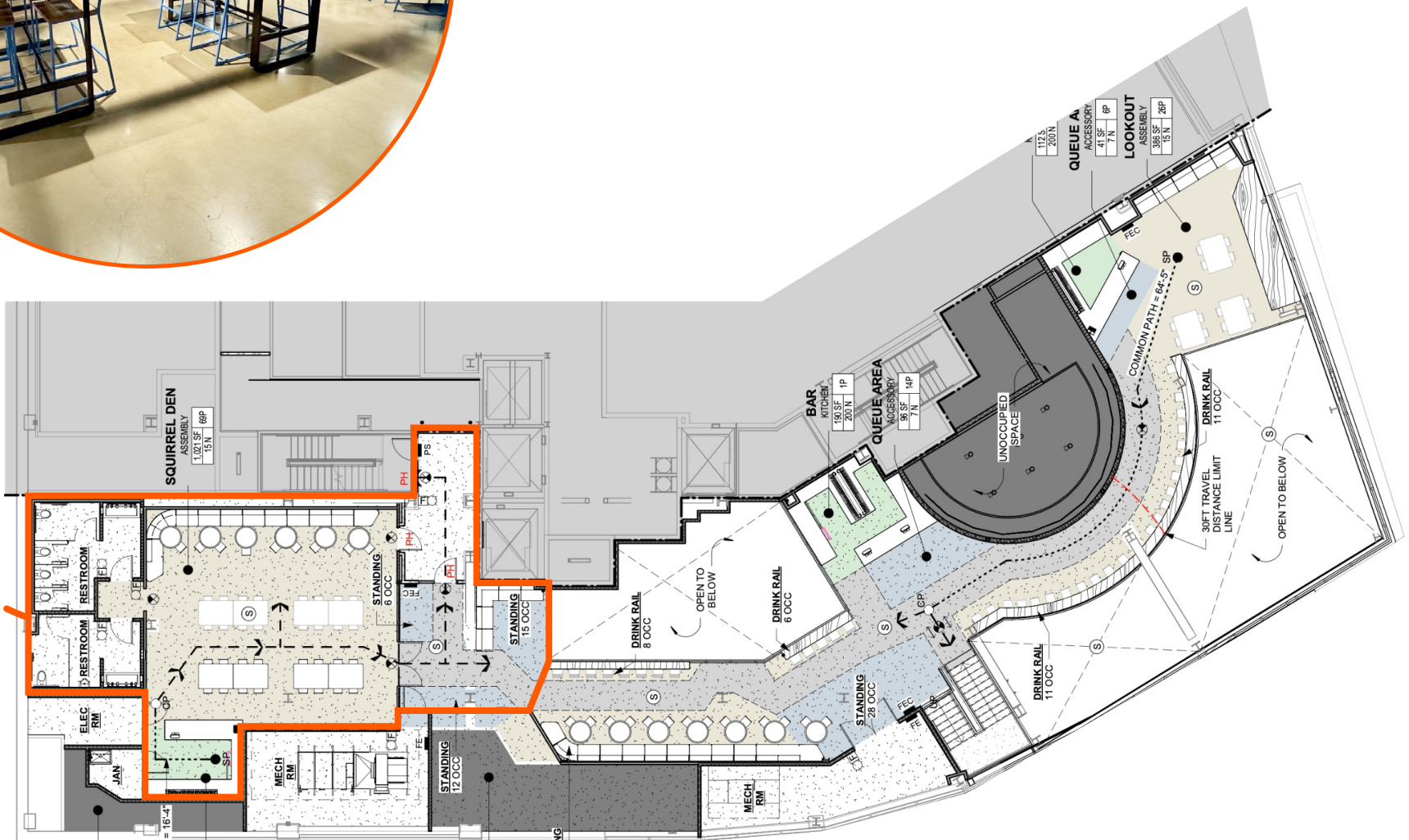



**FULLY
OPERATIONAL
KITCHEN**

run by
In-house chef

***FULL-SERVICE
BREAKFAST AND LUNCH***

Available to the tenant every day
starting at 7:00am and 11:00am
respectively.

Custom menus and buffets can
be arranged.

ADDITIONAL SPACE DETAILS

AVAILABLE SF:

4,500

RENT:

\$30k/month

(includes all utilities and daily cleaning)

FLOOR:

2

TERM:

12-36 months

AMENITIES:

Full-Service Meals
Stair & Elevator Access
Private Restrooms





BOSTON UNIVERSITY

1 DAVID
ORTIZ DRIVE

LANSDOWNE

FENWAY PARK



The area around 1 David Ortiz Drive offers exceptional walkability, an abundance of dining and cultural options, and easy access.

 **BLUEbikes**

 **MBTA BUS STOP**



95
WALK SCORE
WALKER'S PARADISE

40+
RESTAURANTS/CAFES
IN IMMEDIATE AREA

FENWAY NEIGHBORHOOD

2 Min.
WALK TO MBTA
LANDSDOWNE STATION
COMMUTER RAIL

8 Min.
WALK TO MBTA
GREEN LINES B, C, D





THE MIGHTY *WORKSPACE*

@ 1 DAVID ORTIZ DRIVE, BOSTON, MA

PETER EVANS

617.457.3402

pevans@hunnemanre.com

BRIAN FOLEY

617.457.3311

bfoley@hunnemanre.com



303 Congress Street, Boston MA, 02210 | hunnemanre.com

@2025 Hunneman. All rights reserved. All information has been obtained from sources believed reliable but no warranty or representation is verified for accuracy or completeness. Caution and independent investigation of property and information should be verified. Reliance on this information is at your own risk.