

LEASE DRAWINGS NOTES:

- APPLICABLE CODE:**
- 2015 INTERNATIONAL BUILDING CODE (INCLUDING INTERNATIONAL PLUMBING, MECHANICAL, ELECTRICAL, FUEL/GAS, ENERGY AND EXISTING BUILDING CODES.)
 - -TREDYFFRIN TOWNSHIP PROPERTY MAINTENANCE CODE.
- BUILDING INFO:**
- BUILDING TYPE: II - NON-COMBUSTIBLE
 - SPRINKLER SYSTEM: NOT PRESENT
 - (506.2) ALLOWABLE AREA OF A BUILDING: FOR S-1 AND TYPE II => LOWER THAN MAXIMUM ALLOWED
 - (506.3.2) MINIMUM FRONTAGE DISTANCE: COMPLIANT
 - SPACES REQUIREMENTS AND SEPARATION DEPENDS ON TENANT'S OCCUPANCY CLASSIFICATION FOR THE SPECIFIC SPACE.
 - ASSUMED OCCUPANCY CLASSIFICATION AND USE DESIGNATION TO BE:
 - UNIT B1: STORAGE (ACCIDENTAL USE OFFICE) MODERATE-HAZARD STORAGE, GROUP S-1
 - UNIT B2: REPAIR GARAGE (ACCIDENTAL USE OFFICE) MODERATE-HAZARD STORAGE, GROUP S-1
 - OCCUPANCY CLASSIFICATION AND USE DESIGNATION TO BE CONFIRMED.
 - MOTOR-VEHICLE-RELATED OCCUPANCIES SHALL COMPLY WITH SECTION 406.2 AND REPAIR GARAGES SHALL ALSO COMPLY WITH SECTION 406.8.

- DRAWINGS NOTES:**
- DRAWINGS NOT TO BE USED FOR PERMIT SUBMISSION OR CONSTRUCTION:
 - USE & OCCUPANCY PERMITS (U&O) ARE REQUIRED FOR ALL COMMERCIAL USES AND ALL NEW CONSTRUCTION TO CERTIFY THAT THE USE COMPLIES WITH THE ZONING ORDINANCE AND APPLICABLE BUILDING REGULATIONS. USE AND OCCUPANCY APPLICATIONS SHOULD BE SUBMITTED TO TOWNSHIP PRIOR TO THE FINAL REVIEW FOR BUILDING PERMITS.
 - BUILDING PERMITS ARE REQUIRED TO CONSTRUCT, ENLARGE, ALTER, REPAIR, MOVE, DEMOLISH, OR OTHERWISE CHANGE THE OCCUPANCY OF A BUILDING. PERMITS ARE ALSO REQUIRED IN ORDER TO ERECT, INSTALL, ENLARGE, ALTER, REPAIR, REMOVE, CONVERT, OR REPLACE AN ELECTRICAL, GAS, MECHANICAL, OR PLUMBING SYSTEM REGULATED UNDER THE 2015 INTERNATIONAL BUILDING CODE.

DRAWINGS RELEASED FOR LEASE USE ONLY
NOT TO BE USED FOR PERMIT SUBMISSION OR CONSTRUCTION.

- GRAPHIC REFERENCES:**
- EXISTING CONSTRUCTION TO REMAIN
 - - - EXISTING CONSTRUCTION TO BE DEMOLISHED
 - /// NEW CONSTRUCTION

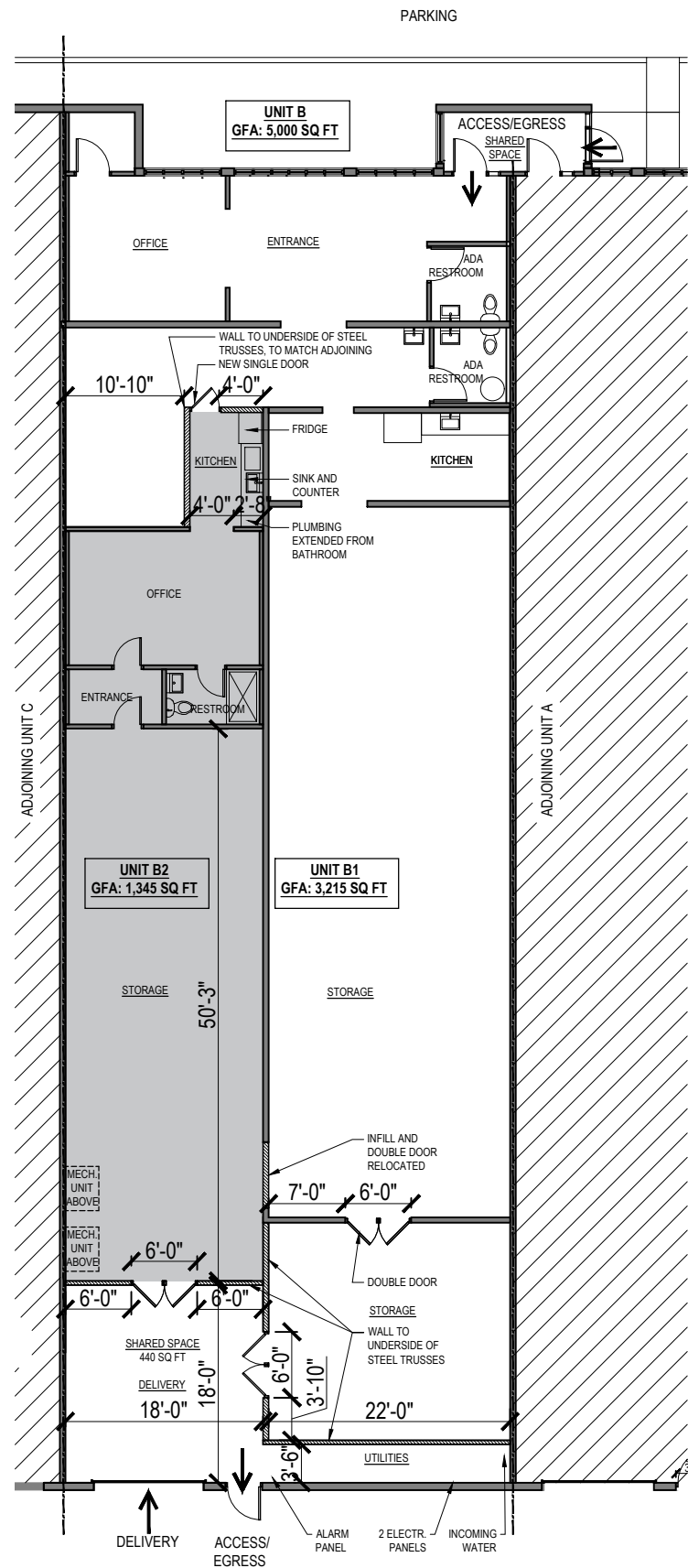

SK01 | LEASE PLAN - UNIT B
3 | 1/16" = 1'-0"

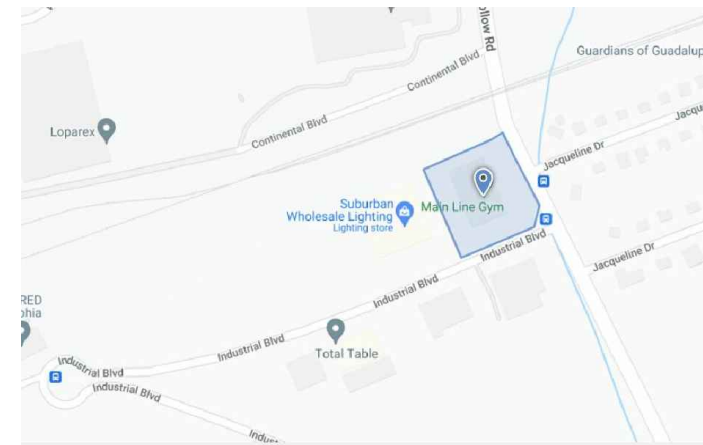

SK01 | SITE PLAN
1 | n.t.s.

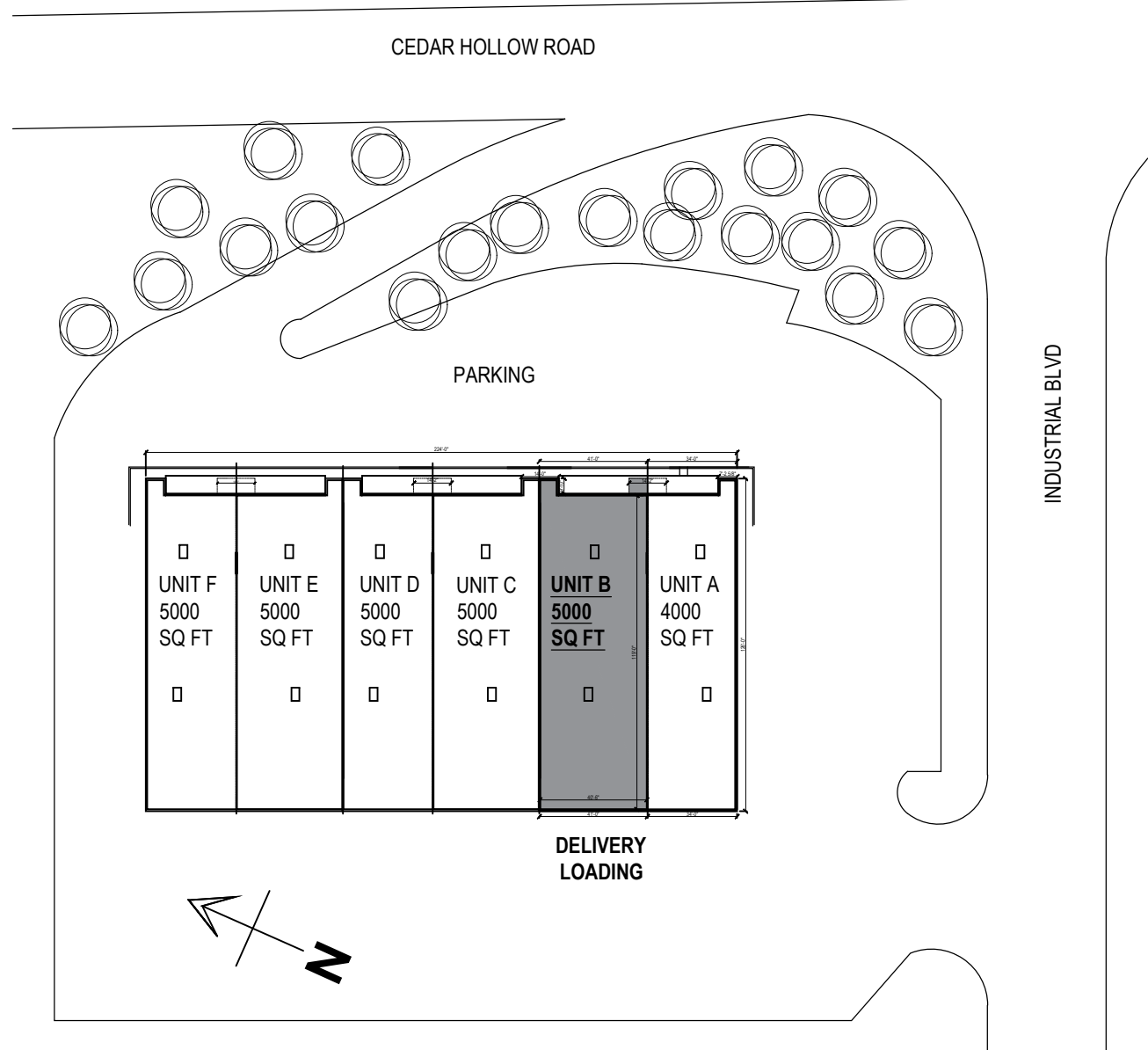

SK01 | SITE PLAN
2 | 1/64" = 1'-0"

architect:

Elisa Lanzutti
ArchitecturaLAB LLC
300 E 8th Ave
Conshohocken, PA 19428



client :

To: Bob Cohen
The Prestige Group
A. 321 S. Valley Forge Rd.
Devon, PA 19333
P. 610.299.9091
E. BCohen@PrestigeGroup.com

job name:
**LEASE DRAWINGS
COMMERCIAL SPACE REMODEL**

address : 37 Industrial Blvd, Paoli, PA 19301

drawing revisions : date:

- 1.
- 2.

date: 04/20/2022

SCALE: 3/32"=1'-0"

drawing name:
LEASE DRAWINGS

drawing number: rev:

SK 001 | -