

**Leigh Hughes**

Vice President  
+1 434 284 4007  
leigh.hughes@colliers.com

**Stuart Rifkin**

Rifkin & Associates  
+1 434 466 9515  
stu.rifkin@gmail.com

---

701 E. Water Street, Suite 301  
Charlottesville, VA 22902  
P: +1 434 974 7377  
colliers.com

## 623 Welsh Run Rd., Ruckersville, VA

- Approximately 48,000 SF For Lease of warehouse, flex, office and lab space(s)
- Currently divided into 15,000 SF of 20' ceiling open warehouse space, 15,000 SF of flex space, 12,500 SF of office space (includes a SCIFF room), and 5,000 SF of lab space
- Space comes furnished with desks, chairs, cubicles, classroom and equipment, cafeteria, and more
- Warehouse space can be doubled in size
- CAN BE DIVIDED INTO SMALLER TENANT AREAS, minimum of approximately 5,000 SF
- Tremendous amount of Power and Water available on-site
- Shared access to loading
- 10 minutes north of Charlottesville, 10 minutes to National Ground Intelligence Center (NGIC), and 20 miles to Interstate 64



623 Welsh Run Rd.



623 Welsh Run Rd.

48,000 SF available

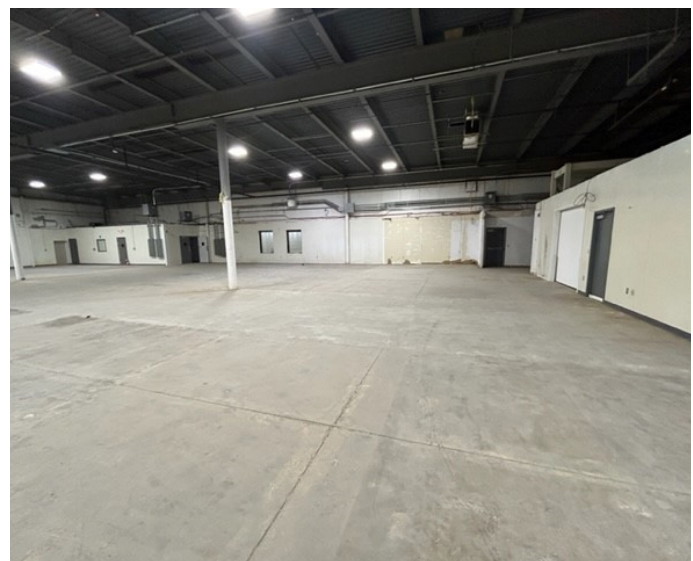
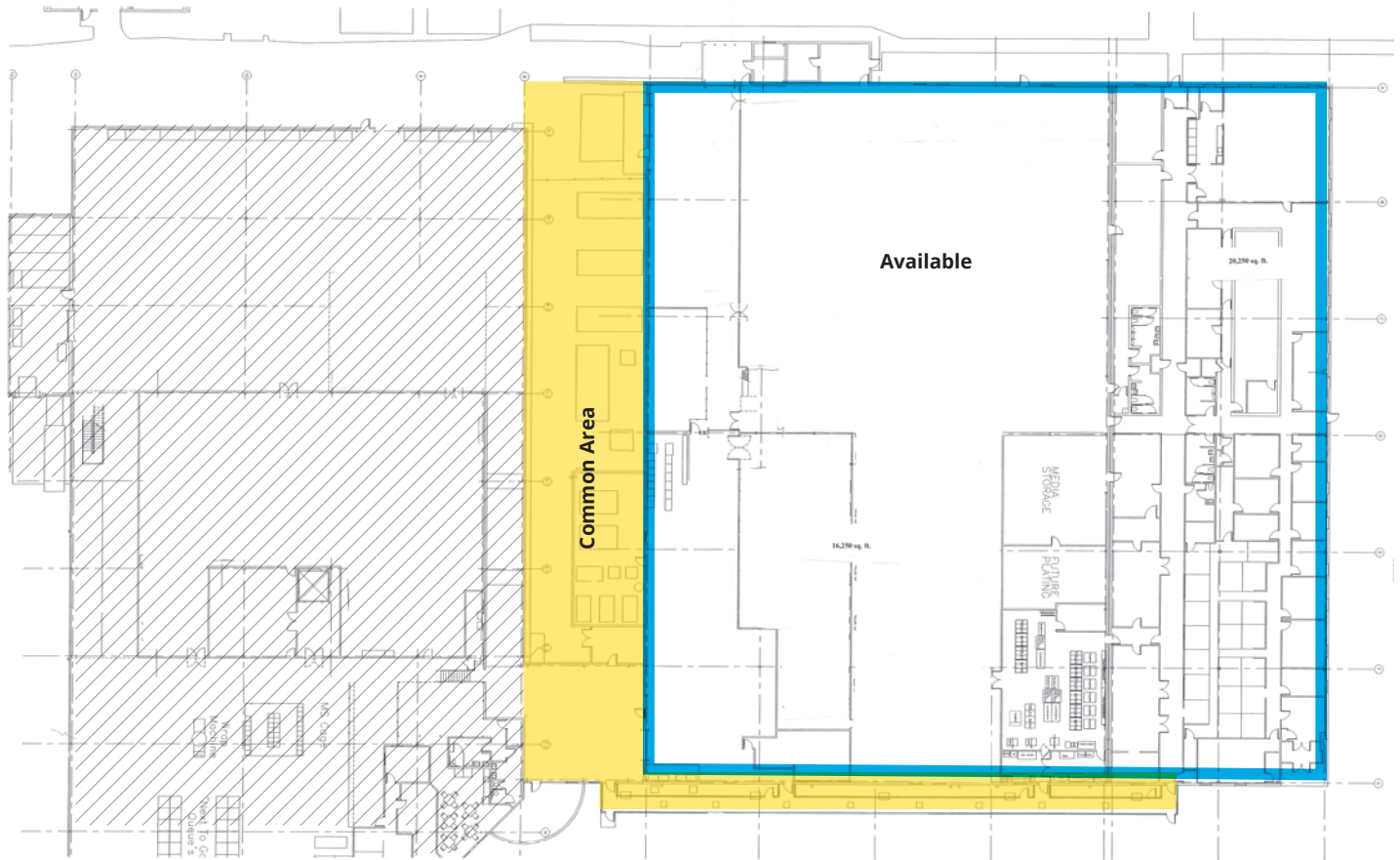



623 Welsh Run Rd.

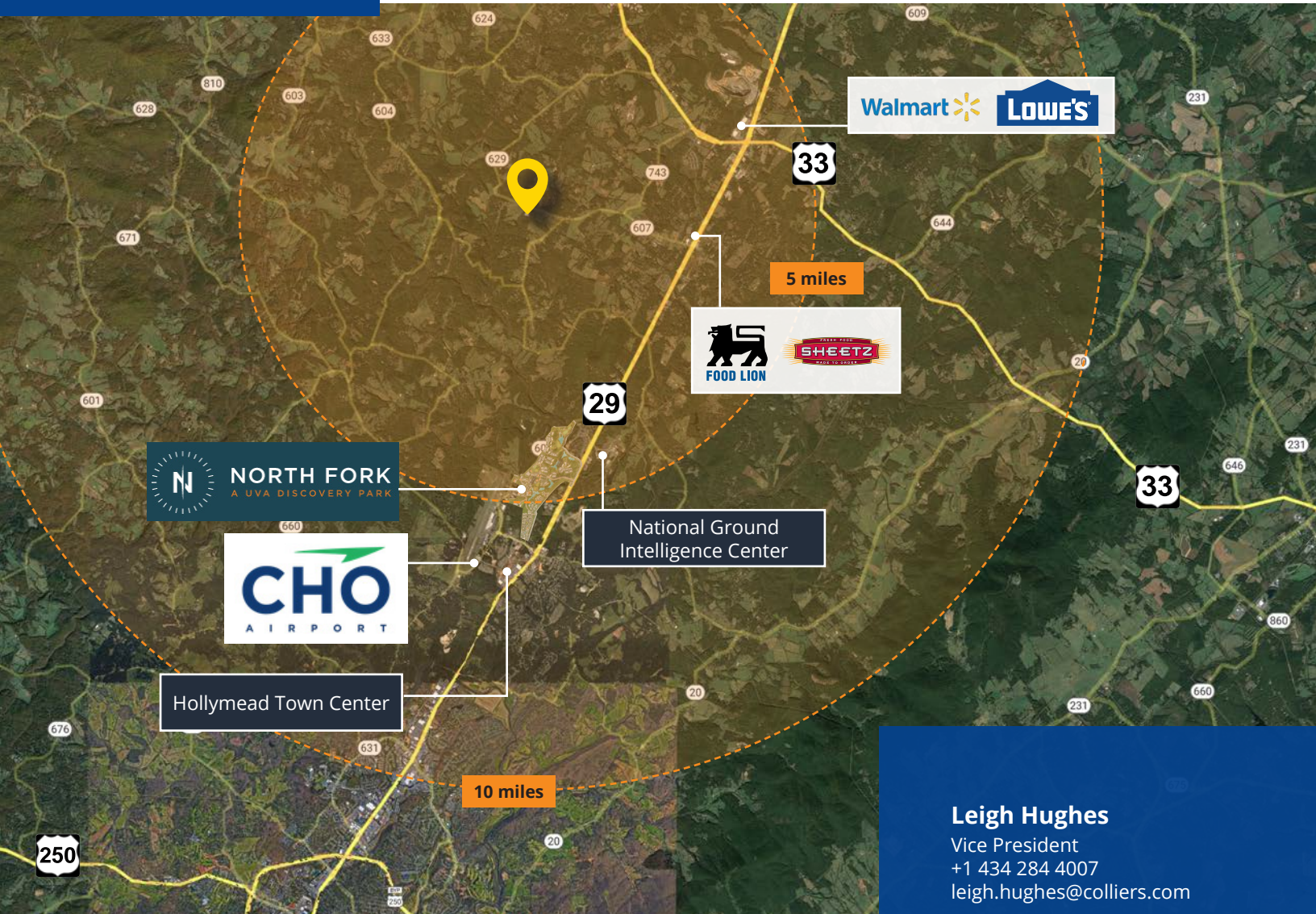

**Leigh Hughes**  
 Vice President  
 +1 434 284 4007  
 leigh.hughes@colliers.com

**Stuart Rifkin**  
 Rifkin & Associates  
 +1 434 466 9515  
 stu.rifkin@gmail.com

## Demographics



2023  
 population  
**8,092**  
 (3 mile)

**20,161**  
 (5 miles)

**55,215**  
 (10 miles)



2023 Average  
 Household Income  
**\$91,248**  
 (3 mile)

**\$86,298**  
 (5 miles)

**\$90,696**  
 (10 miles)

**Colliers**  
 701 E. Water Street, Suite 301  
 Charlottesville, VA 22902  
 P: +1 434 974 7377  
 colliers.com

Copyright © 2024 Colliers International. Information herein has been obtained from sources deemed reliable, however its accuracy cannot be guaranteed. The user is required to conduct their own due diligence and verification.