

# PACIFIC MEDICAL PLAZA

**FOR LEASE**  
NEW AVAILABLE SPACE  
OPPORTUNITY

**1640 Newport Blvd, Costa Mesa CA 92627**



**CBRE**

**welltower**

STEVEN LEWALLEN, Vice President

| +1 949 725 8414

| [Steven.Lewallen@cbre.com](mailto:Steven.Lewallen@cbre.com)

| Lic. 01068304

RYAN G. DOPP, Senior Associate

| +1 949 725 8409

| [Ryan.Dopp@cbre.com](mailto:Ryan.Dopp@cbre.com)

| Lic. 01902830

# PROPERTY OVERVIEW



High identity Newport Boulevard location



Convenient location near Hoag, retail and restaurants



Labs on-site



Abundant free structure and surface parking



New space availability *Owned and managed by*

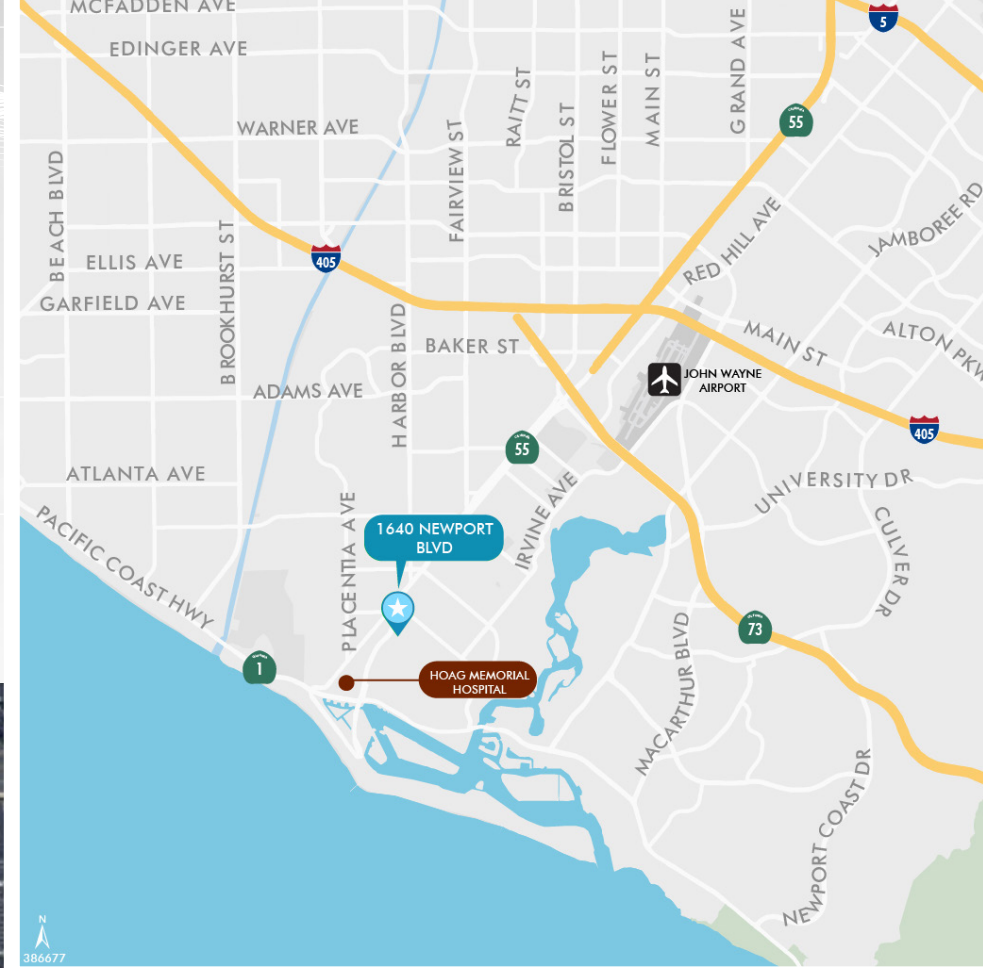

# FLOOR PLAN

SUITE 340 | 1,987 RSF



welltower

CBRE

# FLOOR PLANS

## First Floor

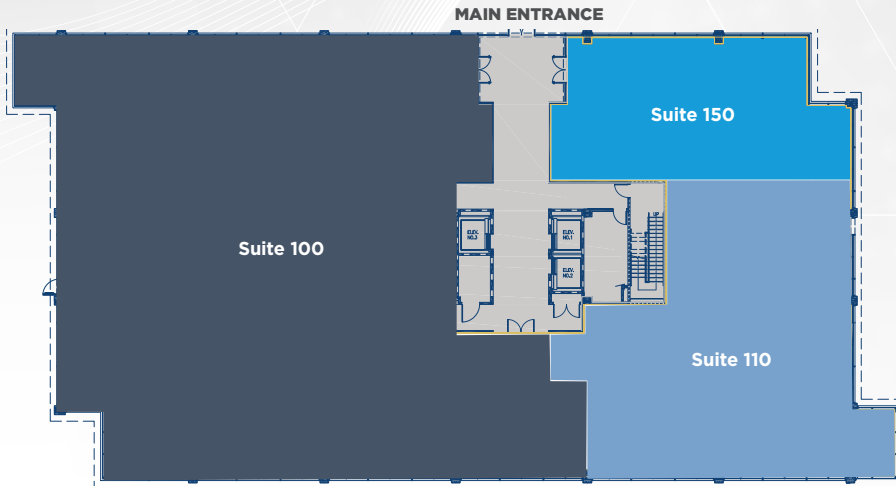

## Third Floor

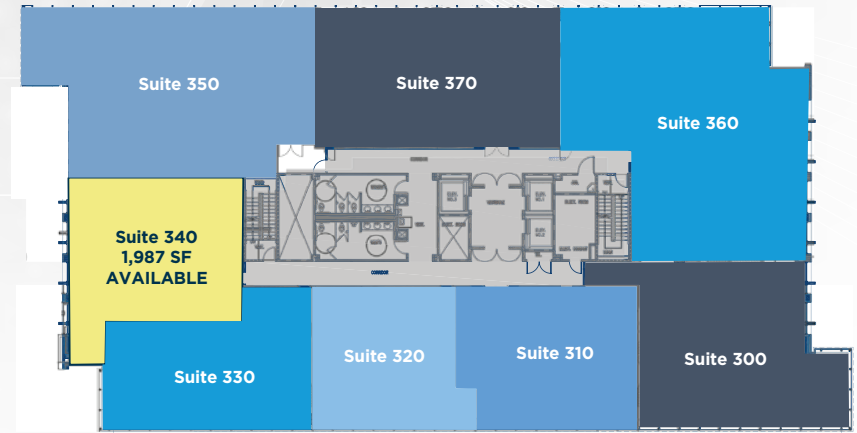

## Second Floor

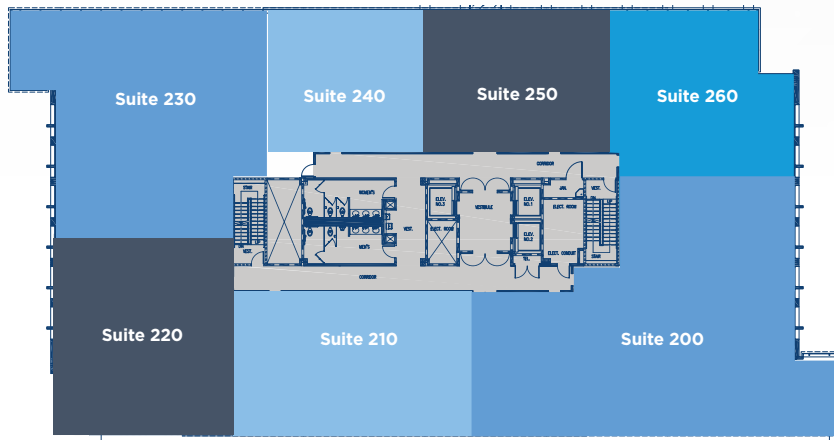

## Fourth Floor

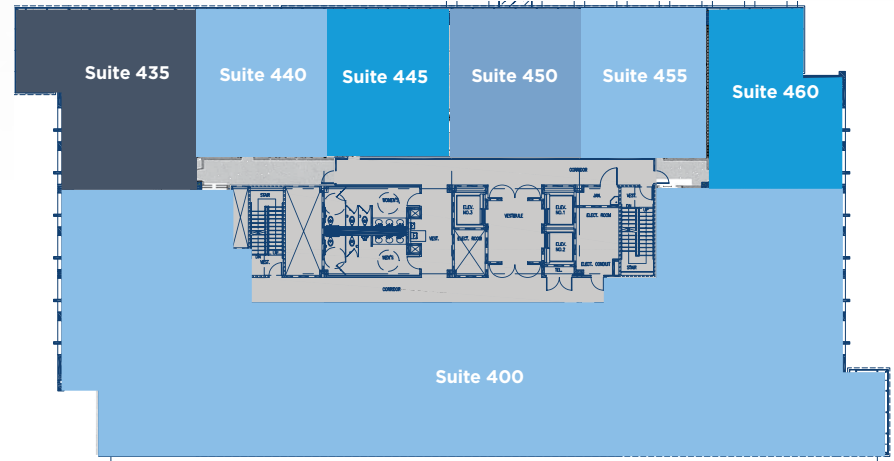

# PACIFIC MEDICAL PLAZA

## FOR LEASE NEW AVAILABLE SPACE OPPORTUNITIES

welltower

1640 Newport Blvd, Costa Mesa CA 92627

### SITE PLAN

STEVEN LEWALLEN  
Vice President  
+1 949 725 8414  
steven.lewallen@cbre.com  
Lic. 01068304

RYAN G. DOPP  
Senior Associate  
+1 949 725 8409  
ryan.dopp@cbre.com  
Lic. 01902830

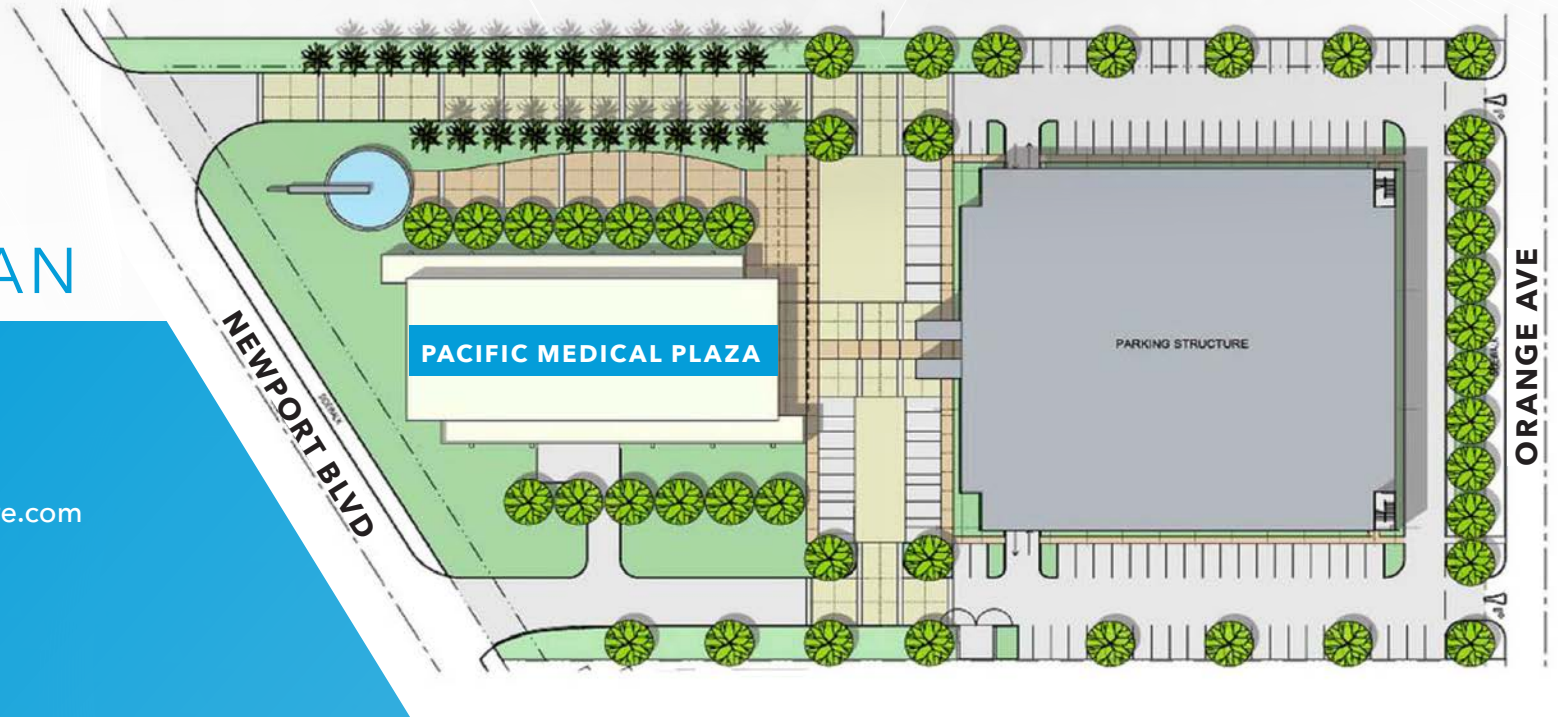

**CBRE**

© 2023 CBRE, Inc. All rights reserved. This information has been obtained from sources believed reliable, but has not been verified for accuracy or completeness. You should conduct a careful, independent investigation of the property and verify all information. Any reliance on this information is solely at your own risk. CBRE and the CBRE logo are service marks of CBRE, Inc. All other marks displayed on this document are the property of their respective owners, and the use of such logos does not imply any affiliation with or endorsement of CBRE. Photos herein are the property of their respective owners. Use of these images without the express written consent of the owner is prohibited.