



SUITES AVAILABLE

1,265 - 1,590 SF

USES

Medical Office
Commercial Office

PARKING

4.3 per 1,000 SF

RENTAL RATE

Negotiable

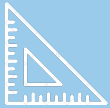

38,000

Square Feet



3

Stories

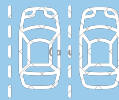

165

Parking
Spots



1

Drop Off
Area

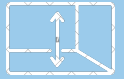

10'

Unfinished
Ceiling Height

PROPERTY HIGHLIGHTS

- ✓ Class A Office-Medical Building
- ✓ Move-in ready suites
- ✓ Ample parking
- ✓ Modernized lobby and common areas
- ✓ Collaborative tenant base
- ✓ Great window lines available
- ✓ Grand lobby entrance
- ✓ Professionally owned & managed locally

SHOPPING

Various shopping centers < 5 min drive

ROUTE 50

4 miles

ROUTE 2

0.1 miles

WASHINGTON, D.C.

24 miles

BALTIMORE

16 miles

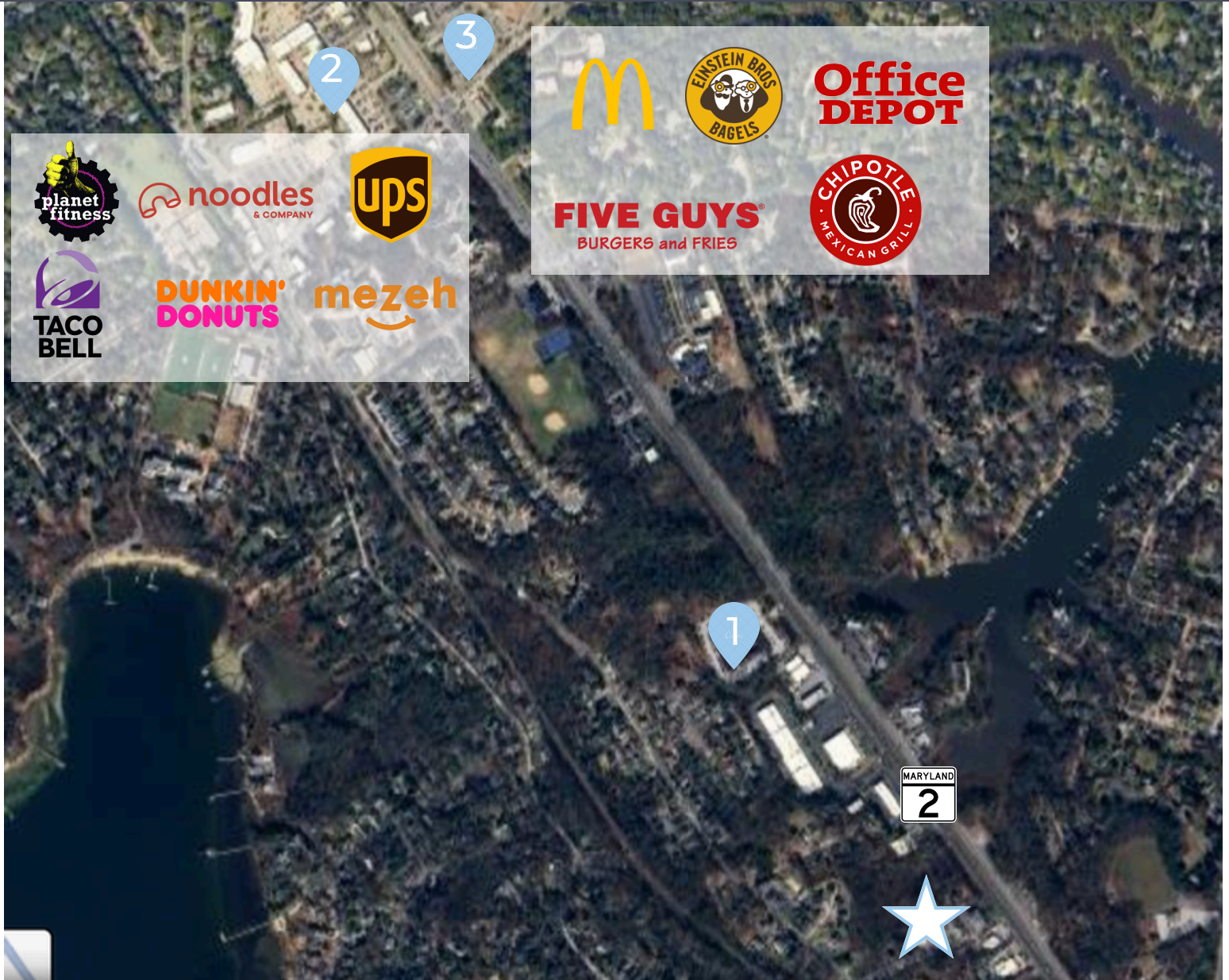

CAFE MEZZANOTTE



PARK PLAZA SHOPPING CENTER



SEVERNA PARK MARKETPLACE

A: 1906 Towne Centre Blvd. Suite 270 Annapolis, MD 21401

E: mason.popham@thomas-park.com | **W:** www.thomas-park.com | **P:** 410.280.0220

**SUITE 200
FLOORPLAN**

**1,500
RENTABLE
SQUARE FEET**

**WINDOW
LINED
OFFICES**

**SPACIOUS
CONFERENCE
ROOM**



CLICK BELOW FOR VIRTUAL TOUR



**SUITE 201
FLOORPLAN**

**1,590
RENTABLE
SQUARE FEET**

**WINDOW
LINED
OFFICES**

**CORNER
SUITE**



CLICK BELOW FOR VIRTUAL TOUR



A: 1906 Towne Centre Blvd. Suite 270 Annapolis, MD 21401

E: mason.popham@thomas-park.com | **W:** www.thomas-park.com | **P:** 410.280.0220

**SUITE 209
FLOORPLAN**

**1,265
RENTABLE
SQUARE FEET**

**LOCATED
DIRECTLY
OFF LOBBY
ENTRANCE**

**IDEAL FOR
PROFESSIONAL
SERVICES OFFICE**



CLICK BELOW FOR VIRTUAL TOUR



A: 1906 Towne Centre Blvd. Suite 270 Annapolis, MD 21401

E: mason.popham@thomas-park.com | **W:** www.thomas-park.com | **P:** 410.280.0220

**SUITE 312
FLOORPLAN**

**1,313
RENTABLE
SQUARE FEET**

**CORNER SUITE
WITH PLENTY OF
NATURAL LIGHT**

**VERY ADAPTABLE
FLOOR PLAN**

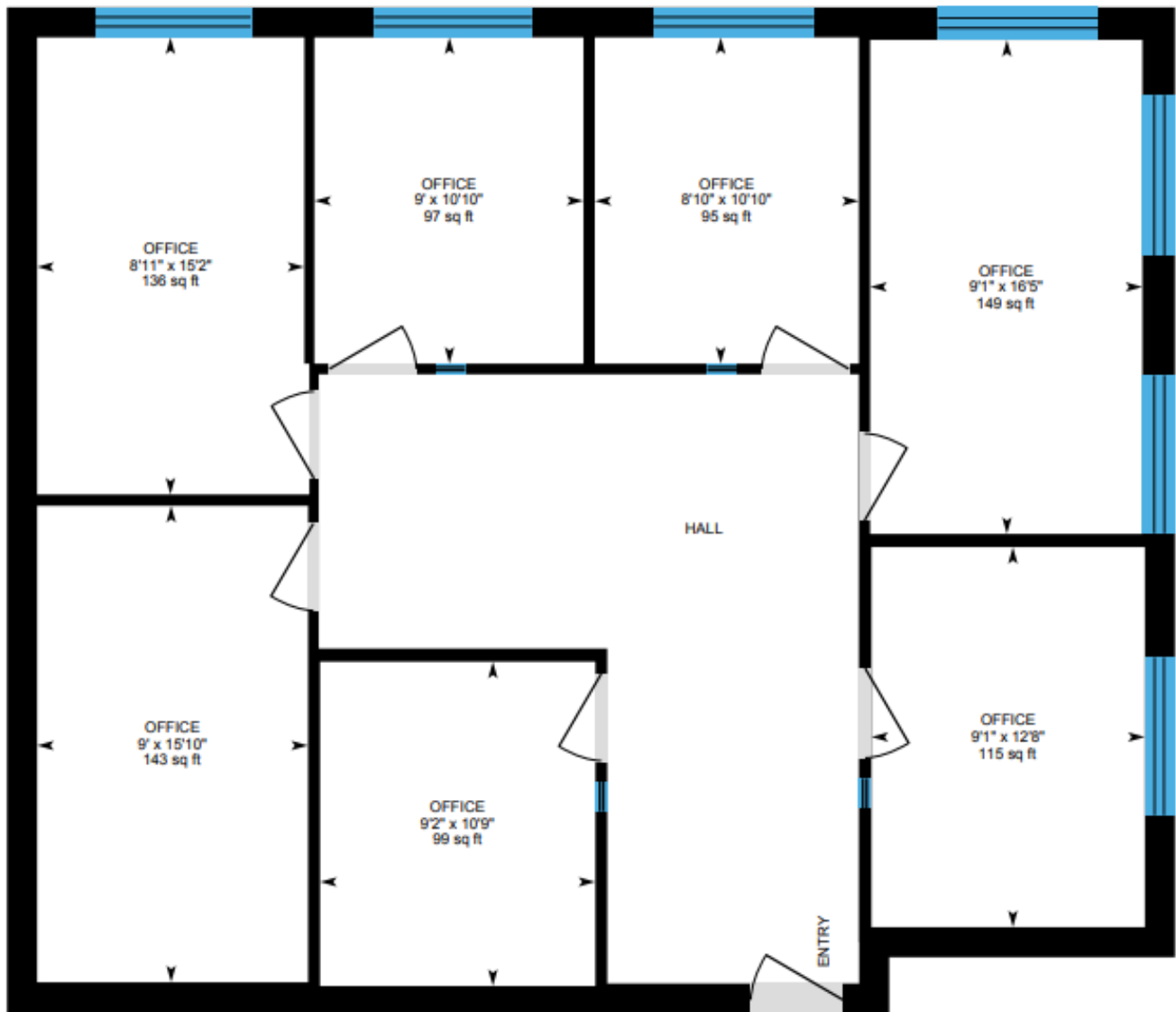

CLICK BELOW FOR VIRTUAL TOUR



**SUITE 313
FLOORPLAN**

**1,378
RENTABLE
SQUARE FEET**

**FLEXIBLE
WORKSPACES &
LAYOUT OPTIONS**

**IDEAL FOR
CONSULTING OR
FINANCIAL
SERVICES FIRM**



CLICK BELOW FOR VIRTUAL TOUR



Thomas Park is a **full-service commercial real estate firm** offering alternative investment strategies and third-party commercial real estate services.

 **THOMAS PARK
COMMERCIAL**

Thomas Park Commercial specializes in leasing and investment brokerage across all commercial asset classes throughout Maryland.

**MASON POPHAM**

EXECUTIVE VICE PRESIDENT
THOMAS PARK COMMERCIAL

E: mason.popham@thomas-park.com

T: 410.280.0220

 **THOMAS PARK
INVESTMENTS**

TPI is one of the fastest growing private equity real estate investment firms on the East Coast focused exclusively on healthcare real estate.

 **THOMAS PARK
MANAGEMENT**

TPM is a best in class property management firm with a 30+ year track record in the commercial real estate industry.

 **THOMAS PARK
DESIGN**

TPD is an innovative interior design firm specializing in healthcare, medical office, commercial office, and retail.

 **THOMAS PARK
CONSTRUCTION**

TPC focuses on commercial construction within the healthcare, retail, office and industrial sectors.