

MIXED USE FOR SALE

5334 MAIN STREET E

MAPLE PLAIN, MN 55359



## COMMERCIAL OR MF REDEVELOPMENT

**KW COMMERCIAL | MINNETONKA**

13100 Wayzata Blvd #400  
Minnetonka, MN 55305



Each Office Independently Owned and Operated

*PRESENTED BY:*

**JEFFREY STEDMAN**

Senior Associate

O: (952) 473-0903

C: (952) 473-0903

jeff@kwcommercial.com

#RA-20454772, Minnesota

**RICK BATESON**

Senior Associate

O: 612-850-1916

rickbateson@kw.com

We obtained the information above from sources we believe to be reliable. However, we have not verified its accuracy and make no guarantee, warranty or representation about it. It is submitted subject to the possibility of errors, omissions, change of price, rental or other conditions, prior sale, lease or financing, or withdrawal without notice. We include projections, opinions, assumptions or estimates for example only, and they may not represent current or future performance of the property. You and your tax and legal advisors should conduct your own investigation of the property and transaction.



# EXECUTIVE SUMMARY

5334 MAIN STREET EAST



## OFFERING SUMMARY

<b>PRICE:</b>	\$190,000
<b>BUILDING SF:</b>	Approx. 2211 SF
<b>LOT SIZE:</b>	0.15 Acres
<b>YEAR BUILT:</b>	1902
<b>ZONING:</b>	Mixed Use Downtown

## PROPERTY HIGHLIGHTS

- Current two story building, small utility basement
- Building may be redevelopment with adjacent 1635 Delano parcel
- Corner lot, Main Street frontage, Delano Ave side street
- Zoning allows multi family development, best done with adjacent parcel also for sale
- Within blocks of post office, library, Blackwater Coffee & Café, McGarry's Pub, Ace Hardware, local park and other amenities
- Possible combined sale with 1635 Delano Avenue



**KW COMMERCIAL | MINNETONKA**  
13100 Wayzata Blvd #400  
Minnetonka, MN 55305



Each Office Independently Owned and Operated

**JEFFREY STEDMAN**  
Senior Associate  
O: (952) 473-0903  
C: (952) 473-0903  
jeff@kwcommercial.com  
#RA-20454772, Minnesota

**RICK BATESON**  
Senior Associate  
O: 612-850-1916  
rickbateson@kw.com



# PROPERTY PHOTOS

5334 MAIN STREET EAST



## KW COMMERCIAL | MINNETONKA

13100 Wayzata Blvd #400  
Minnetonka, MN 55305



Each Office Independently Owned and Operated

## JEFFREY STEDMAN

Senior Associate  
O: (952) 473-0903  
C: (952) 473-0903  
jeff@kwcommercial.com  
#RA-20454772, Minnesota

## RICK BATESON

Senior Associate  
O: 612-850-1916  
rickbateson@kw.com



# PROPERTY PHOTOS

5334 MAIN STREET EAST



**KW COMMERCIAL | MINNETONKA**  
13100 Wayzata Blvd #400  
Minnetonka, MN 55305



Each Office Independently Owned and Operated

**JEFFREY STEDMAN**  
Senior Associate  
O: (952) 473-0903  
C: (952) 473-0903  
jeff@kwcommercial.com  
#RA-20454772, Minnesota

**RICK BATESON**  
Senior Associate  
O: 612-850-1916  
rickbateson@kw.com

# MAIN AND UPPER FLOORPLANS

5334 MAIN STREET EAST



## 5334 Main St., Maple Plain. Main Floor

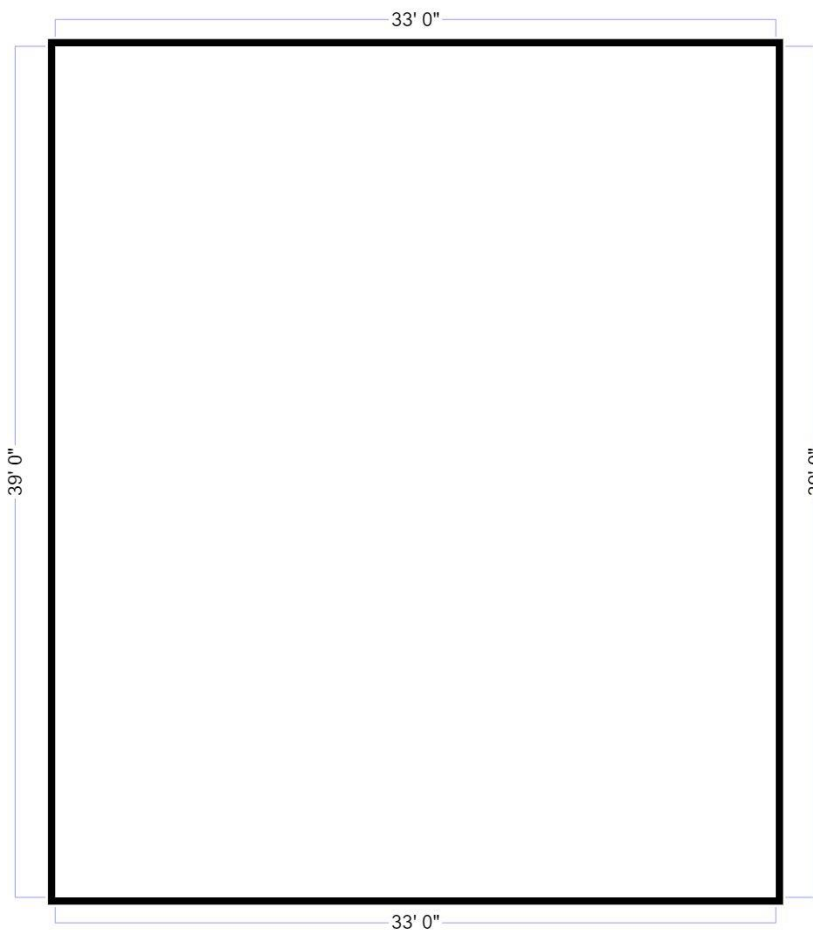

## 5334 Main St., Maple Plain. Upper Floor

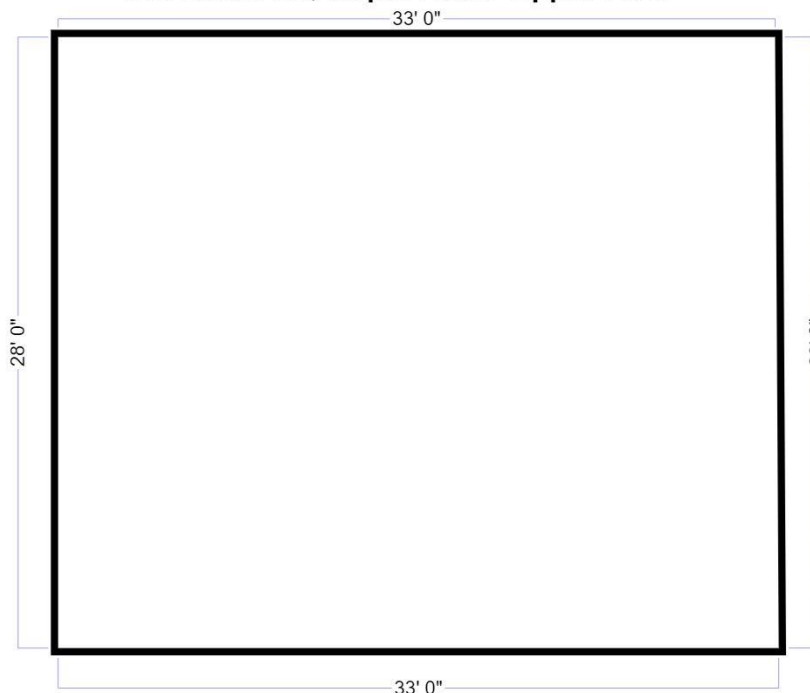

**KW COMMERCIAL | MINNETONKA**  
13100 Wayzata Blvd #400  
Minnetonka, MN 55305



Each Office Independently Owned and Operated

**JEFFREY STEDMAN**  
Senior Associate  
O: (952) 473-0903  
C: (952) 473-0903  
jeff@kwcommercial.com  
#RA-20454772, Minnesota

**RICK BATESON**  
Senior Associate  
O: 612-850-1916  
rickbateson@kw.com



# LOCATION MAPS

5334 MAIN STREET EAST

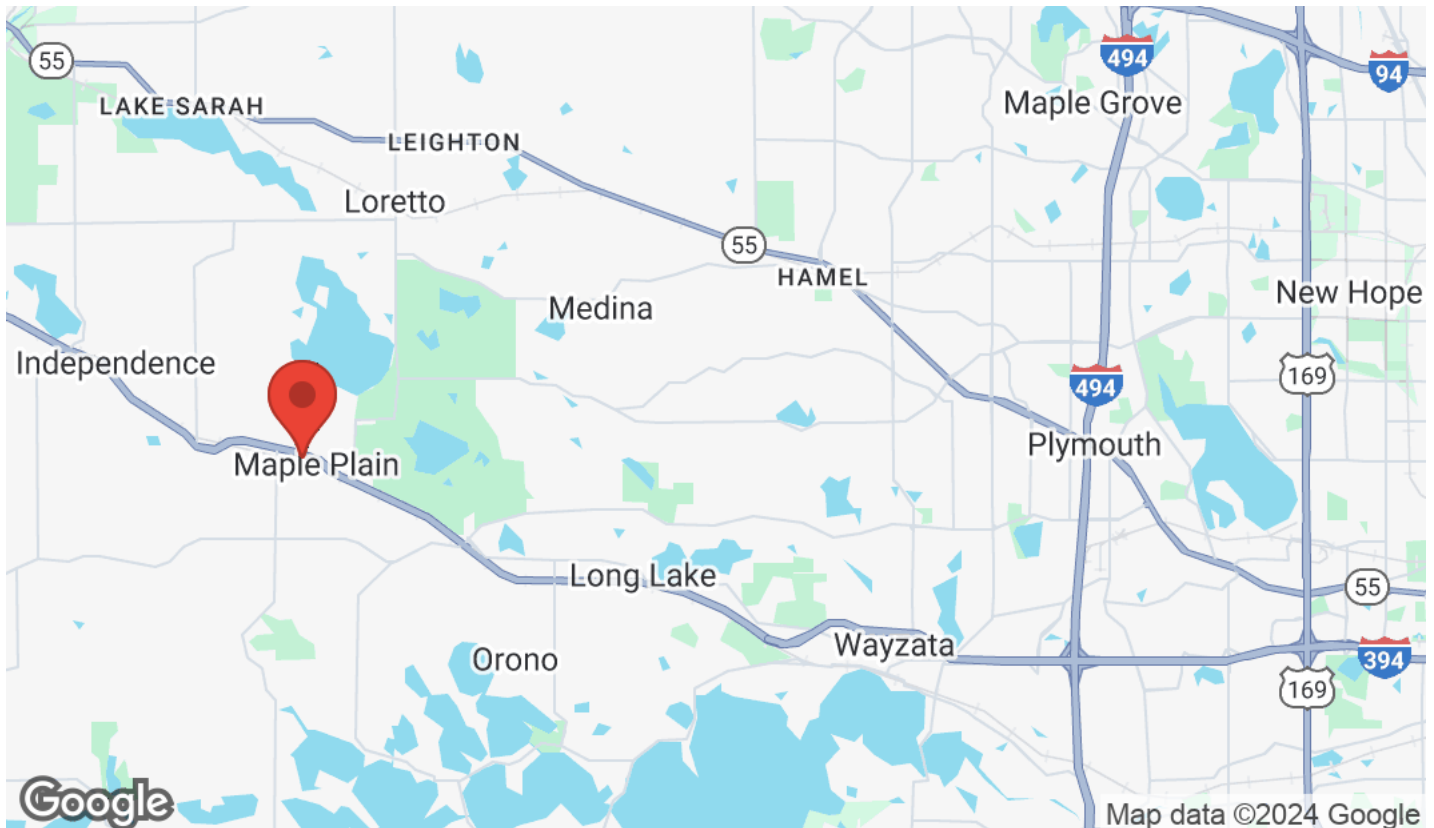
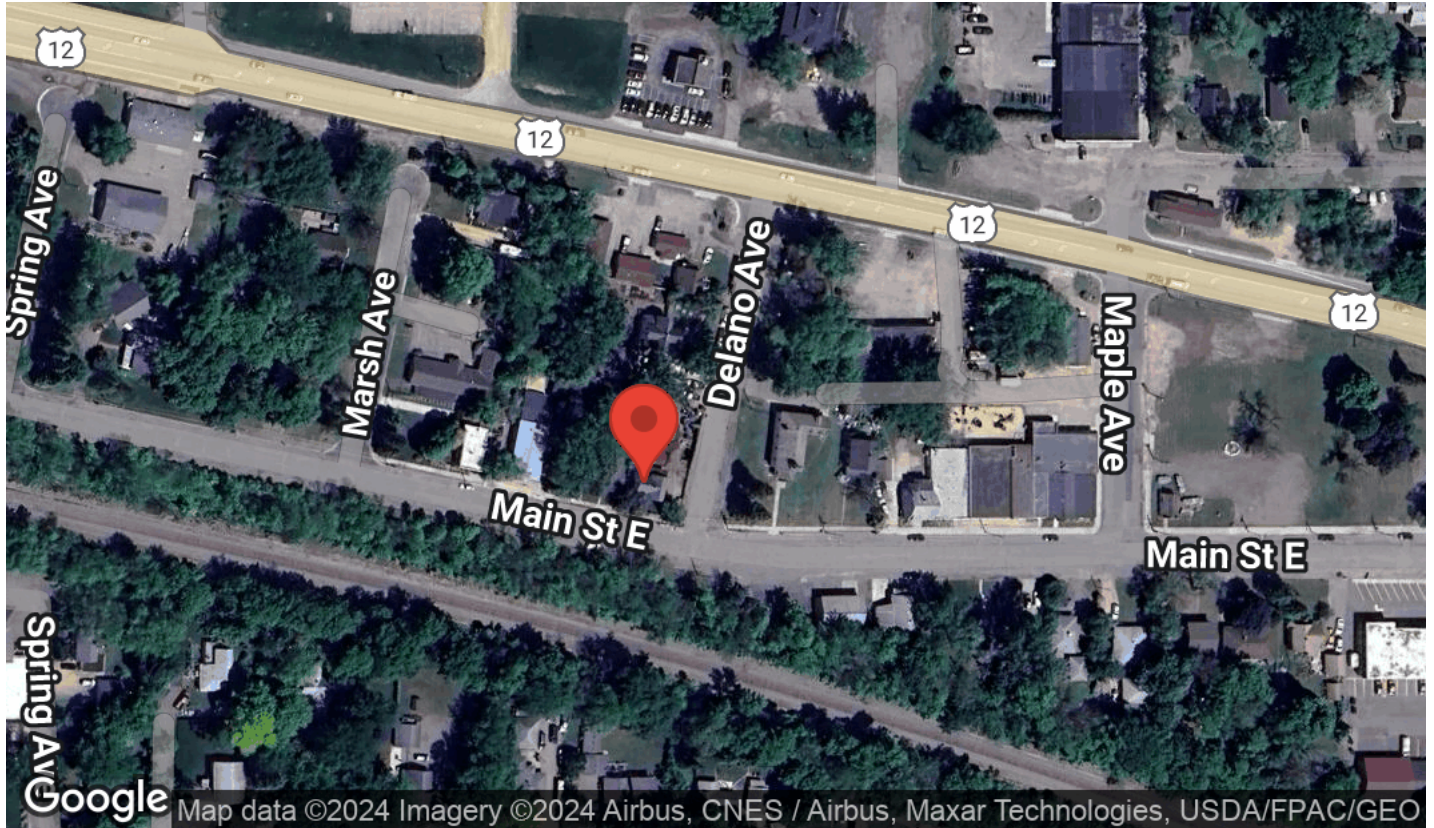

**KW COMMERCIAL | MINNETONKA**  
13100 Wayzata Blvd #400  
Minnetonka, MN 55305



Each Office Independently Owned and Operated

**JEFFREY STEDMAN**  
Senior Associate  
O: (952) 473-0903  
C: (952) 473-0903  
jeff@kwcommercial.com  
#RA-20454772, Minnesota

**RICK BATESON**  
Senior Associate  
O: 612-850-1916  
rickbateson@kw.com

# DEMOGRAPHICS

5334 MAIN STREET EAST

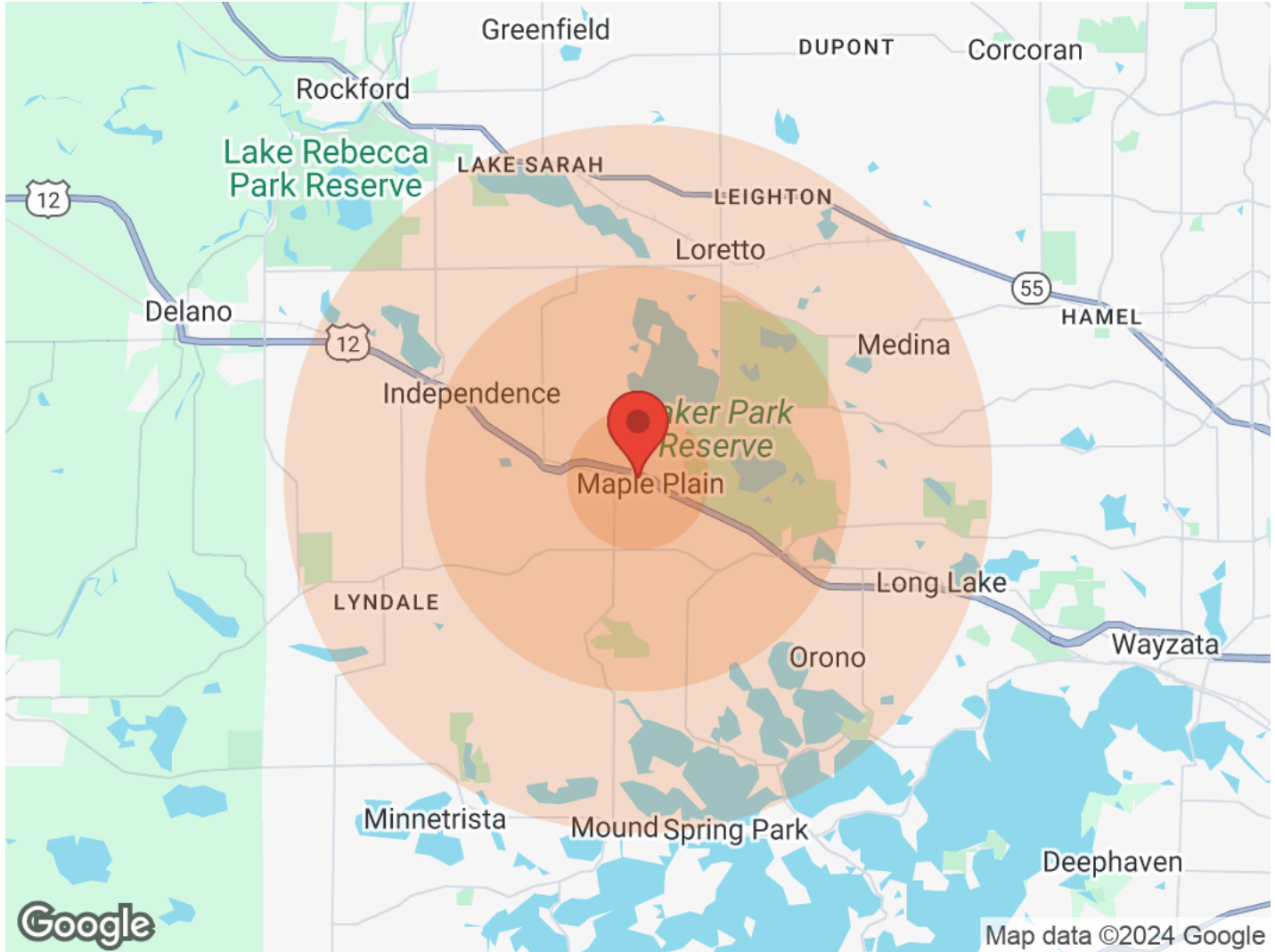

Population	1 Mile	3 Miles	5 Miles
Male	N/A	2,358	10,157
Female	N/A	2,341	10,035
Total Population	N/A	4,699	20,192

Age	1 Mile	3 Miles	5 Miles
Ages 0-14	N/A	884	3,537
Ages 15-24	N/A	730	2,965
Ages 25-54	N/A	1,596	7,148
Ages 55-64	N/A	671	3,012
Ages 65+	N/A	818	3,530

Race	1 Mile	3 Miles	5 Miles
White	N/A	4,674	19,975
Black	N/A	8	37
Am In/AK Nat	N/A	N/A	N/A
Hawaiian	N/A	N/A	N/A
Hispanic	N/A	82	216
Multi-Racial	N/A	32	298

Income	1 Mile	3 Miles	5 Miles
Median	N/A	\$119,240	\$84,712
< \$15,000	N/A	52	488
\$15,000-\$24,999	N/A	65	322
\$25,000-\$34,999	N/A	101	390
\$35,000-\$49,999	N/A	152	725
\$50,000-\$74,999	N/A	231	1,233
\$75,000-\$99,999	N/A	269	1,314
\$100,000-\$149,999	N/A	368	1,550
\$150,000-\$199,999	N/A	220	560
> \$200,000	N/A	275	1,213

Housing	1 Mile	3 Miles	5 Miles
Total Units	N/A	1,810	8,452
Occupied	N/A	1,653	7,813
Owner Occupied	N/A	1,439	6,579
Renter Occupied	N/A	214	1,234
Vacant	N/A	157	639

**KW COMMERCIAL | MINNETONKA**  
13100 Wayzata Blvd #400  
Minnetonka, MN 55305



Each Office Independently Owned and Operated

**JEFFREY STEDMAN**  
Senior Associate  
O: (952) 473-0903  
C: (952) 473-0903  
jeff@kwcommercial.com  
#RA-20454772, Minnesota

**RICK BATESON**  
Senior Associate  
O: 612-850-1916  
rickbateson@kw.com

# Disclaimer

5334 MAIN STREET EAST



All materials and information received or derived from KW Commercial its directors, officers, agents, advisors, affiliates and/or any third party sources are provided without representation or warranty as to completeness, veracity, or accuracy, condition of the property, compliance or lack of compliance with applicable governmental requirements, developability or suitability, financial performance of the property, projected financial performance of the property for any party's intended use or any and all other matters.

Neither KW Commercial its directors, officers, agents, advisors, or affiliates makes any representation or warranty, express or implied, as to accuracy or completeness of the materials or information provided, derived, or received. Materials and information from any source, whether written or verbal, that may be furnished for review are not a substitute for a party's active conduct of its own due diligence to determine these and other matters of significance to such party. KW Commercial will not investigate or verify any such matters or conduct due diligence for a party unless otherwise agreed in writing.

EACH PARTY SHALL CONDUCT ITS OWN INDEPENDENT INVESTIGATION AND DUE DILIGENCE.

Any party contemplating or under contract or in escrow for a transaction is urged to verify all information and to conduct their own inspections and investigations including through appropriate third-party independent professionals selected by such party. All financial data should be verified by the party including by obtaining and reading applicable documents and reports and consulting appropriate independent professionals. KW Commercial makes no warranties and/or representations regarding the veracity, completeness, or relevance of any financial data or assumptions. KW Commercial does not serve as a financial advisor to any party regarding any proposed transaction.

All data and assumptions regarding financial performance, including that used for financial modeling purposes, may differ from actual data or performance. Any estimates of market rents and/or projected rents that may be provided to a party do not necessarily mean that rents can be established at or increased to that level. Parties must evaluate any applicable contractual and governmental limitations as well as market conditions, vacancy factors and other issues in order to determine rents from or for the property. Legal questions should be discussed by the party with an attorney. Tax questions should be discussed by the party with a certified public accountant or tax attorney. Title questions should be discussed by the party with a title officer or attorney. Questions regarding the condition of the property and whether the property complies with applicable governmental requirements should be discussed by the party with appropriate engineers, architects, contractors, other consultants, and governmental agencies. All properties and services are marketed by KW Commercial in compliance with all applicable fair housing and equal opportunity laws.

## KW COMMERCIAL | MINNETONKA

13100 Wayzata Blvd #400  
Minnetonka, MN 55305



Each Office Independently Owned and Operated

## PRESENTED BY:

### JEFFREY STEDMAN

Senior Associate

O: (952) 473-0903

C: (952) 473-0903

jeff@kwcommercial.com

#RA-20454772, Minnesota

### RICK BATESON

Senior Associate

O: 612-850-1916

rickbateson@kw.com

The calculations and data presented are deemed to be accurate, but not guaranteed. They are intended for the purpose of illustrative projections and analysis. The information provided is not intended to replace or serve as substitute for any legal, accounting, investment, real estate, tax or other professional advice, consultation or service. The user of this software should consult with a professional in the respective legal, accounting, tax or other professional area before making any decisions.