

# FOR LEASE

**24947 LARSON LANE**  
**LAKEVILLE MN**



**NORTH STAR**  
**COMMERCIAL**  
REAL ESTATE ADVISORS  
KELLER WILLIAMS PREFERRED REALTY



**SCOTT NAASZ**  
D: 612.662.4442  
M: 612.819.8285  
[scott@northstarexperts.com](mailto:scott@northstarexperts.com)

# EXECUTIVE SUMMARY

## LEASE RATE

\$2,500

## LEASE TYPE

Gross Lease

## YEAR BUILT

2024

## TOTAL SF AVAILABLE

13,720

## PARKING STALLS

6 Indoor Parking Spaces in  
Unit / Exterior Parking

## BUILDING TYPE

Warehouse - Condo

## ABOUT THE PROPERTY

---

- New Construction Storage Condos in Field Stone Industrial Park. These condos can be used for storage, businesses, or a place to gather with friends!
- Located just South of Lakeville and moments to I-35

## PROPERTY HIGHLIGHTS

---

- Size: 28 x 70 insulated steel buildings, are heated, include 14 x 14 overhead doors with opener, fan, hose bib, LED lighting, 100 amp three phase power, 4 amp circuits, 6" reinforced concrete floors, overhead sprinklers, over 21' ceiling
- Option: add mezzanine 16 x 28 or 24 x 28 and bathrooms.
- Option to have contiguous space 28 X 140
- Community parking on west side of building

## AVAILABLE UNITS

---

115: 1,980

116: 1,980

122: 1,980

208: 1,980

209: 1,980

216: 3,960

- Options:
  - Suites 208, 209, 216: 7,920 consecutive SF
  - Suites 115, 116, 122: 5,940 Consecutive SF



# PROPERTY PHOTOS



# AERIAL PHOTO



# FLOORPLAN

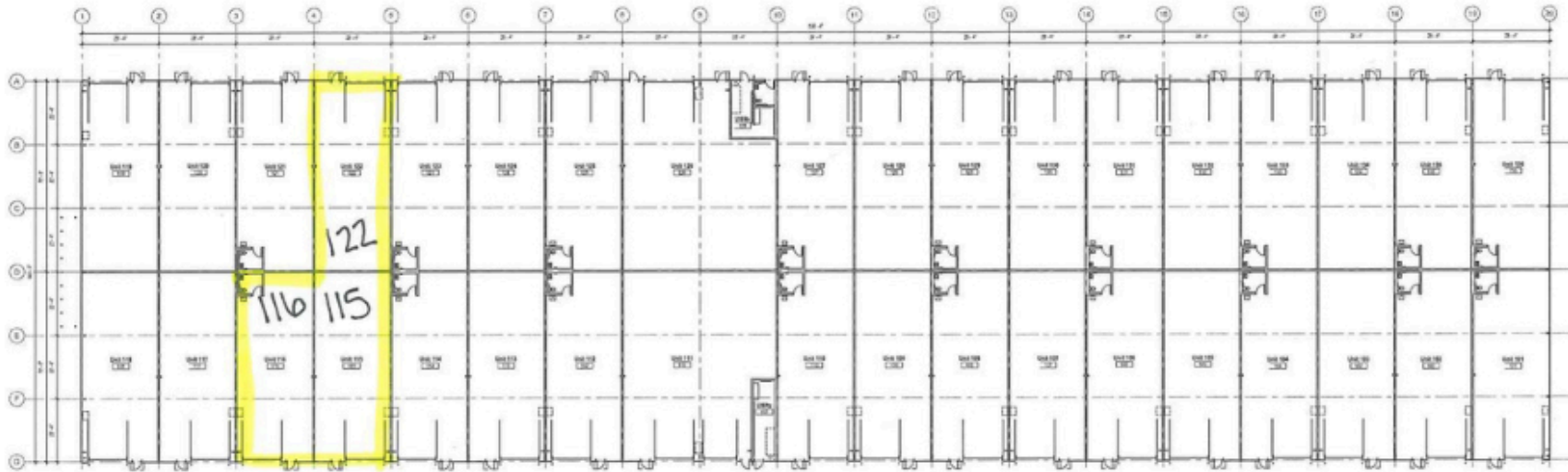

1) Marketing Plan, Condos 4



2) Marketing Plan, Condos 4

**PLANFORCE**  
ARCHITECTURE + DESIGN

21 Glenwood Avenue  
Suite 330  
Minneapolis, Minnesota  
612.541.9950  
planforcegroup.com

FIELD STONE  
INDUSTRIAL PARK/  
BRINK CONDOS 4 and 5  
(209) and (217)

23847 LARSON LN  
LAKEVILLE, MN 55044

**MESENBRINK**  
COMMERCIAL REAL ESTATE  
& ENGINEERING  
P.L.L.C.

Rev.	Description	Date