

# LASALLE PARK

16113 S LASALLE STREET, SOUTH HOLLAND, IL 60473

**LM**  
Lagestee-Mulder  
Commercial Real Estate

OFFICE SPACE FOR LEASE



## PROPERTY DESCRIPTION

One suite remains in the LaSalle Park Medical/Office Complex. Constructed in 2005-2006, LaSalle Park was designed as a 19,841 SF professional office/medical park consisting of four, free-standing, masonry buildings situated around a cul de sac. Each of the four 4,953-square-foot buildings contains two or three individual office suites. The development is within 2.5 miles of the I-94 interchange.

The property is part of a larger master planned development called College Park, which includes College Center One, a multi-tenant office property, to the south, and South Suburban College to the north. The property is under the Class 8 tax status through 2026. The park's tenants include medical, health care and service providers. Advocate Medical Immediate Care Center and DaVita Dialysis are located directly across the street.

## PROPERTY HIGHLIGHTS

- Last suite (#16113 - 1,150 SF) remaining for Lease.
- Neighboring Advocate Medical Center
- Plenty of parking
- Suite & monument signage

DEMOGRAPHICS	2 MILES	5 MILES	10 MILES
Total Households	14,165	89,319	370,451
Total Population	43,008	256,910	1,022,695
Average HH Income	\$65,603	\$64,908	\$74,470

## MARTHA WINTER

Senior Vice President & Designated Managing Broker  
224.523.9174  
MARTHA@LMTEAM.COM

## GWEN LAMPERT

Vice President & Commercial Broker  
630.560.2906  
GWEN@LMTEAM.COM

17005 Westview Ave.,  
South Holland, IL 60473  
630.325.8338  
WWW.LMTEAM.COM

Notice: Unless a Consent to Dual Agency has been signed by both parties to a transaction for this property Martha Winter and Gwen Lampert represent(s) the Landlord only, and not the Tenant.

# LASALLE PARK

16113 S LASALLE STREET, SOUTH HOLLAND, IL 60473

OFFICE SPACE FOR LEASE

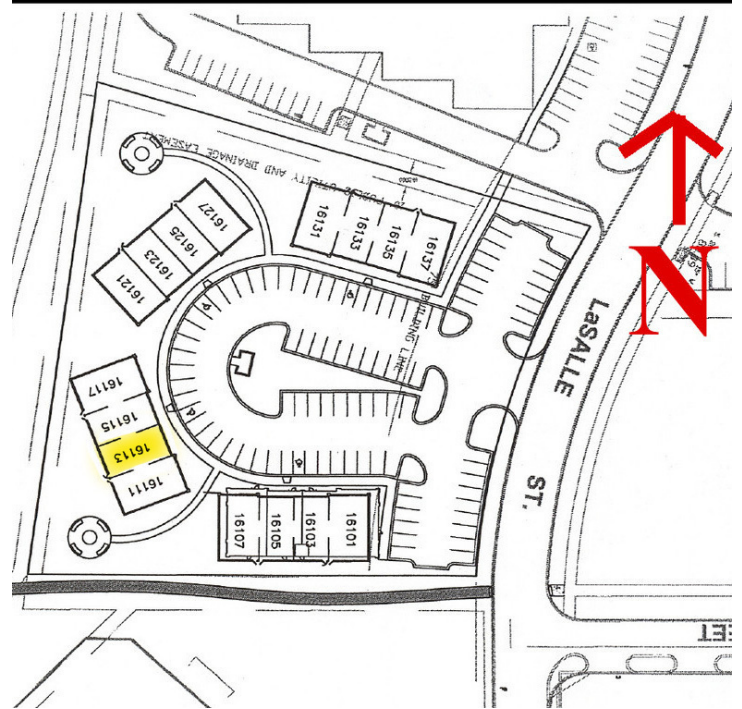

## AVAILABLE SPACES

SUITE	TENANT	SIZE (SF)	LEASE TYPE	LEASE RATE	DESCRIPTION
16101 - 16103 S LaSalle Street	Federal Protection Agency	2,458 SF	Modified Gross	Leased	-
16105 S LaSalle Street	Sound Sleep Center	1,140 SF	Modified Gross	Leased	-
16107 S LaSalle Street	Chicago Christian	1,353 SF	Modified Gross	Leased	-
16111 S LaSalle Street	Elite Dental Care	1,353 SF	Modified Gross	Leased	-
16113 S LaSalle Street	Available	1,150 SF	Modified Gross	\$2,718 per month	Office suite w/restroom
16115 S LaSalle Street	Cityblock Health	1,141 SF	Modified Gross	Leased	-
16117 S LaSalle Street	Michele Foods	1,353 SF	Modified Gross	Leased	-
16121-16127 S LaSalle Street	JMA Architects	4,953 SF	Modified Gross	Leased	-
16131-16137 S LaSalle Street	Robinson Engineering	4,940 SF	Modified Gross	Leased	-

## MARTHA WINTER

Senior Vice President & Designated Managing Broker  
224.523.9174  
MARTHA@LMTEAM.COM

## GWEN LAMPERT

Vice President & Commercial Broker  
630.560.2906  
GWEN@LMTEAM.COM

17005 Westview Ave.,  
South Holland, IL 60473  
630.325.8338  
WWW.LMTEAM.COM



