

FOR LEASE

GARYDEL CENTER

9710 SW DAY ROAD
WILSONVILLE, OR

*±58,125 SF Logistics Building Available For
Lease with Easy Access to I-5 in Wilsonville.*

BUILDING AREA	±58,125 SF, divisible to 33,802 SF
LOADING	15 dock-high doors with mechanical levelers and 2 grade-level doors, all doors motorized
TRAILER STAGING	21 surplus trailer spots Additional 59 trailer spots available
CLEAR HEIGHT	30'
SPRINKLERS	ESFR
FLOOR SLAB	6" reinforced concrete
POWER	480V 3-phase 2,000 Amps
LIGHTING	LED fixtures
OFFICE AREA	2,468 SF
LOCATION	±1 mile from I-5 freeway interchange
AVAILABLE	December 2025

\$0.95/\$1.35

NNN LEASE RATE

TONY RESER, SIOR
503.221.2271
tony.reser@kidder.com

KIDDER.COM

This information supplied herein is from sources we deem reliable. It is provided without any representation, warranty, or guarantee, expressed or implied as to its accuracy. Prospective Buyer or Tenant should conduct an independent investigation and verification of all matters deemed to be material, including, but not limited to, statements of income and expenses. Consult your attorney, accountant, or other professional advisor.

**km Kidder
Mathews**

OFFICE FLOOR PLAN

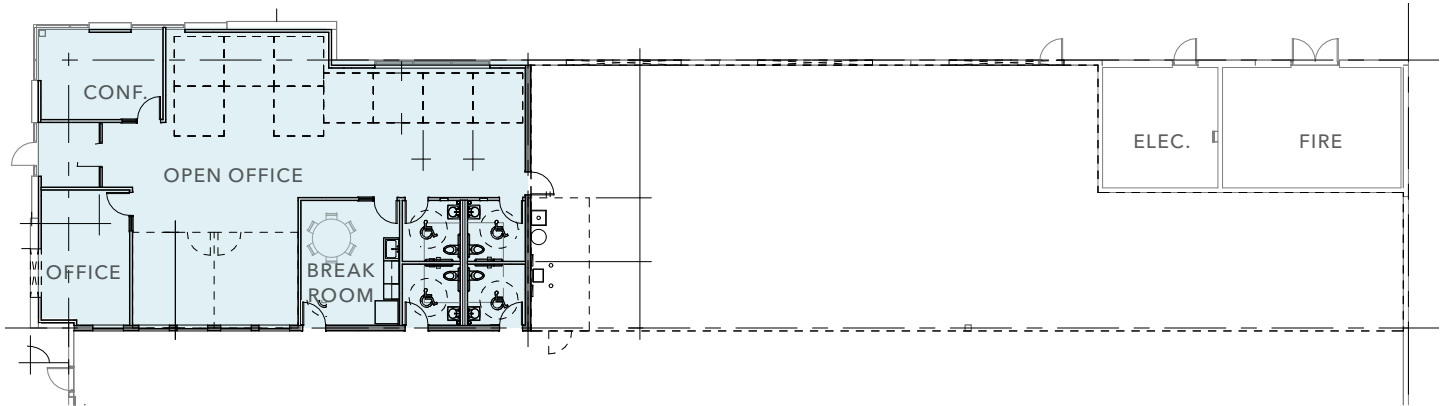

2,468 SF

OFFICE

30'

CEILING HEIGHT

DEC 2025

AVAILABLE

KIDDER.COM

This information supplied herein is from sources we deem reliable. It is provided without any representation, warranty, or guarantee, expressed or implied as to its accuracy. Prospective Buyer or Tenant should conduct an independent investigation and verification of all matters deemed to be material, including, but not limited to, statements of income and expenses. Consult your attorney, accountant, or other professional advisor.

GARYDEL CENTER

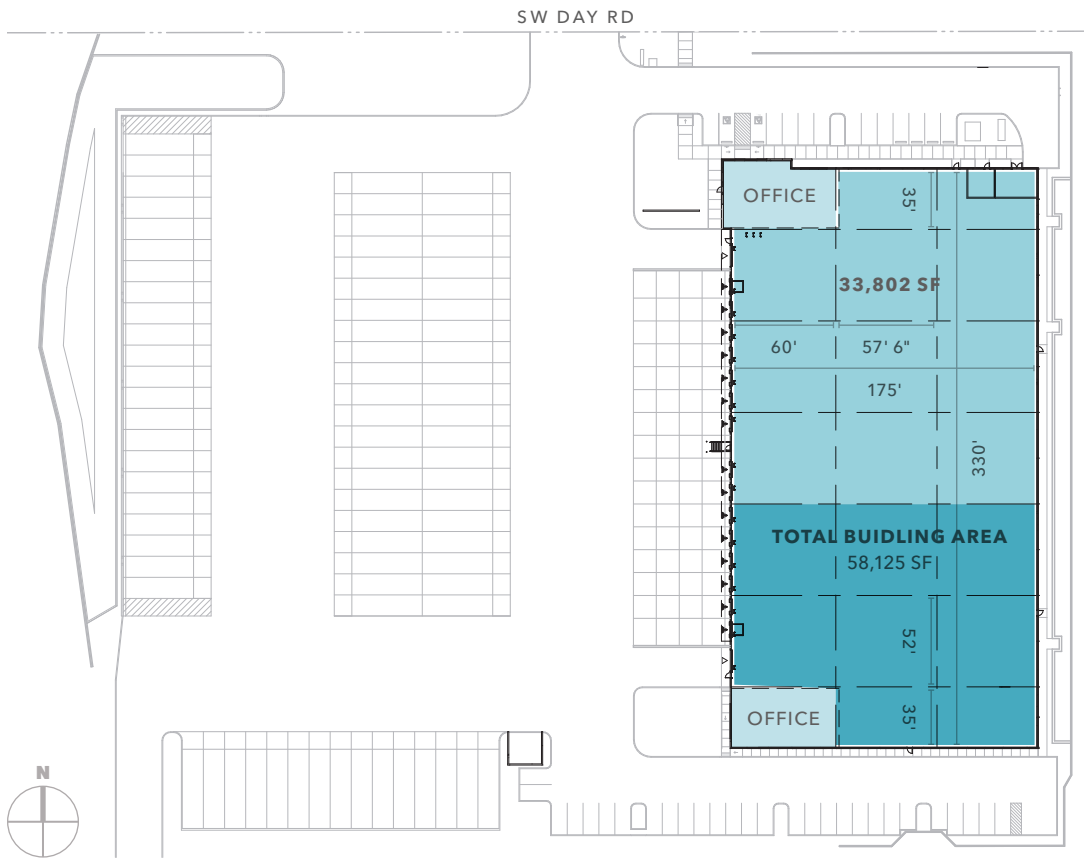

±58,125

SF AVAILABLE

33,802

SF DIVISIBLE TO

DEC '25

AVAILABLE



KIDDER.COM

This information supplied herein is from sources we deem reliable. It is provided without any representation, warranty, or guarantee, expressed or implied as to its accuracy. Prospective Buyer or Tenant should conduct an independent investigation and verification of all matters deemed to be material, including, but not limited to, statements of income and expenses. Consult your attorney, accountant, or other professional advisor.

km Kidder Mathews