

SOUTH DOWNTOWN MIXED-USE FOR LEASE - Office | Flex Space



HUGHES
CAPITAL
HOLDINGS



233 W. GRANT STREET, ORLANDO, FL 32806

PROPERTY FEATURES

BUILDING #1 : 12,600± SF - AVAILABLE FOR LEASE

- Flex Space / Office / Industrial
- Suites Divisible: (2) 3,600 SF or (1) 5,400 SF
- Construction: Block/Metal
- Clear Height: +20' / Clear Span
- Loading:
 - (1) 14' x 16' Grade Level Door
- Office: TBD
- Surface Parking
- Fire Protection: Wet System

ASKING RATE: \$18 / SF

(varies based on office build out)

- Brand New Construction
- Electrical Service: TBD
- Utilities: OUC
- Land Size: 6 +/- acres
- 2 miles to downtown
- Easy access to I-4, SR 408, Orange Avenue & Blossom Trail.
- Exterior site lighting, Fully Landscaped, Multiple Access Points.

CONTACT

Patrick Hughes, Senior Development Manager
407-770-2581 | phughes@hughes-capital.com
1150 Louisiana Ave. Unit 3 | Winter Park, FL 32789 | www.hughes-capital.com

No warranty or representation, express or implied, is made as to the accuracy of the information contained herein, and same is submitted subject to errors, omissions, change of price, rental or other conditions, withdrawal without notice, and to any special listing conditions imposed by our principals.

SOUTH DOWNTOWN MIXED-USE FOR LEASE - Office | Flex Space



HUGHES
CAPITAL
HOLDINGS

SITE PLAN

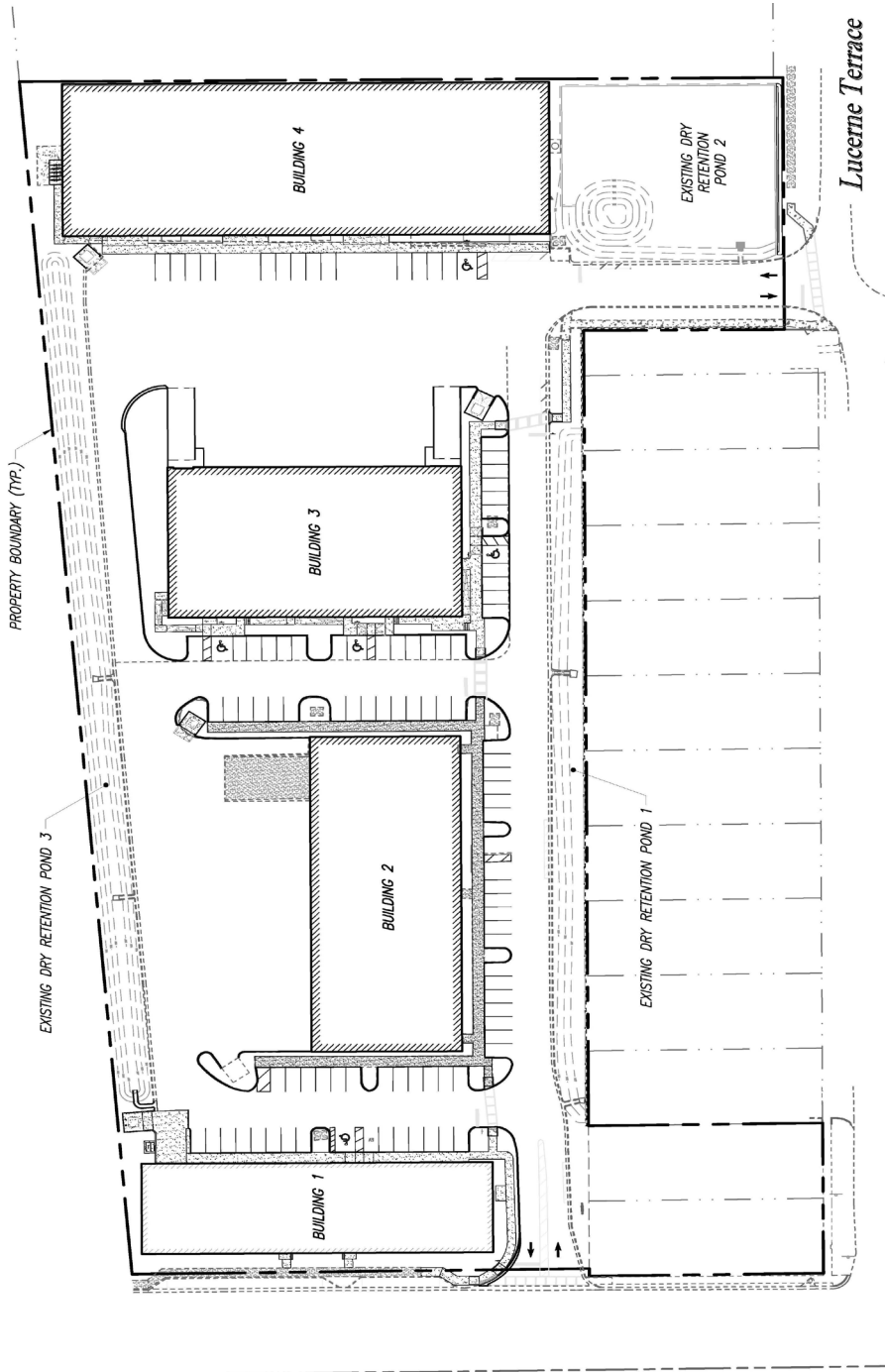

AVAILABLE FOR LEASE:

Building #1:

12,600 SF - Flex / Industrial Space

FUTURE PHASES:

Building #3:

19,000 SF - Flex / Industrial
Space

CURRENTLY LEASED:

Building #4:

29,200 SF - Industrial Space

Building #2:

18,900 SF - Flex / Industrial
Space

CONTACT

Patrick Hughes, Senior Development Manager
407-770-2581 | phughes@hughes-capital.com
1150 Louisiana Ave. Unit 3 | Winter Park, FL 32789 | www.hughes-capital.com

No warranty or representation, express or implied, is made as to the accuracy of the information contained herein, and same is submitted subject to errors, omissions, change of price, rental or other conditions, withdrawal without notice, and to any special listing conditions imposed by our principals.

SOUTH DOWNTOWN MIXED-USE FOR LEASE - Office | Flex Space



HUGHES
CAPITAL
HOLDINGS

LOCATION AERIAL



CONTACT

Patrick Hughes, Senior Development Manager
407-770-2581 | phughes@hughes-capital.com
1150 Louisiana Ave. Unit 3 | Winter Park, FL 32789 | www.hughes-capital.com

No warranty or representation, express or implied, is made as to the accuracy of the information contained herein, and same is submitted subject to errors, omissions, change of price, rental or other conditions, withdrawal without notice, and to any special listing conditions imposed by our principals.

SOUTH DOWNTOWN MIXED-USE FOR LEASE - Office | Flex Space



HUGHES
CAPITAL
HOLDINGS

PHOTOS



CONTACT

Patrick Hughes, Senior Development Manager
407-770-2581 | phughes@hughes-capital.com
1150 Louisiana Ave. Unit 3 | Winter Park, FL 32789 | www.hughes-capital.com

No warranty or representation, express or implied, is made as to the accuracy of the information contained herein, and same is submitted subject to errors, omissions, change of price, rental or other conditions, withdrawal without notice, and to any special listing conditions imposed by our principals.