

9390 Bunsen Parkway

Louisville, KY 40220

86,610± SF Available



Property Features

- + 86,610± SF Available
- + 12.47± acres
- + Efficient layout – single story operations center
- + Ample parking – approximately 5:1,000 sf
- + Easy access to I-64, Hurstbourne Lane, I-264 and I-265
- + Building generator
- + Updated finishes in common areas and office space
- + No additional occupational tax
- + Building signage available.
- + Large training rooms
- + Fitness center with showers
- + Large break area for employees
- + Private offices and conference rooms with sidelights

Property Aerial



Floor Plan - 86,610± SF

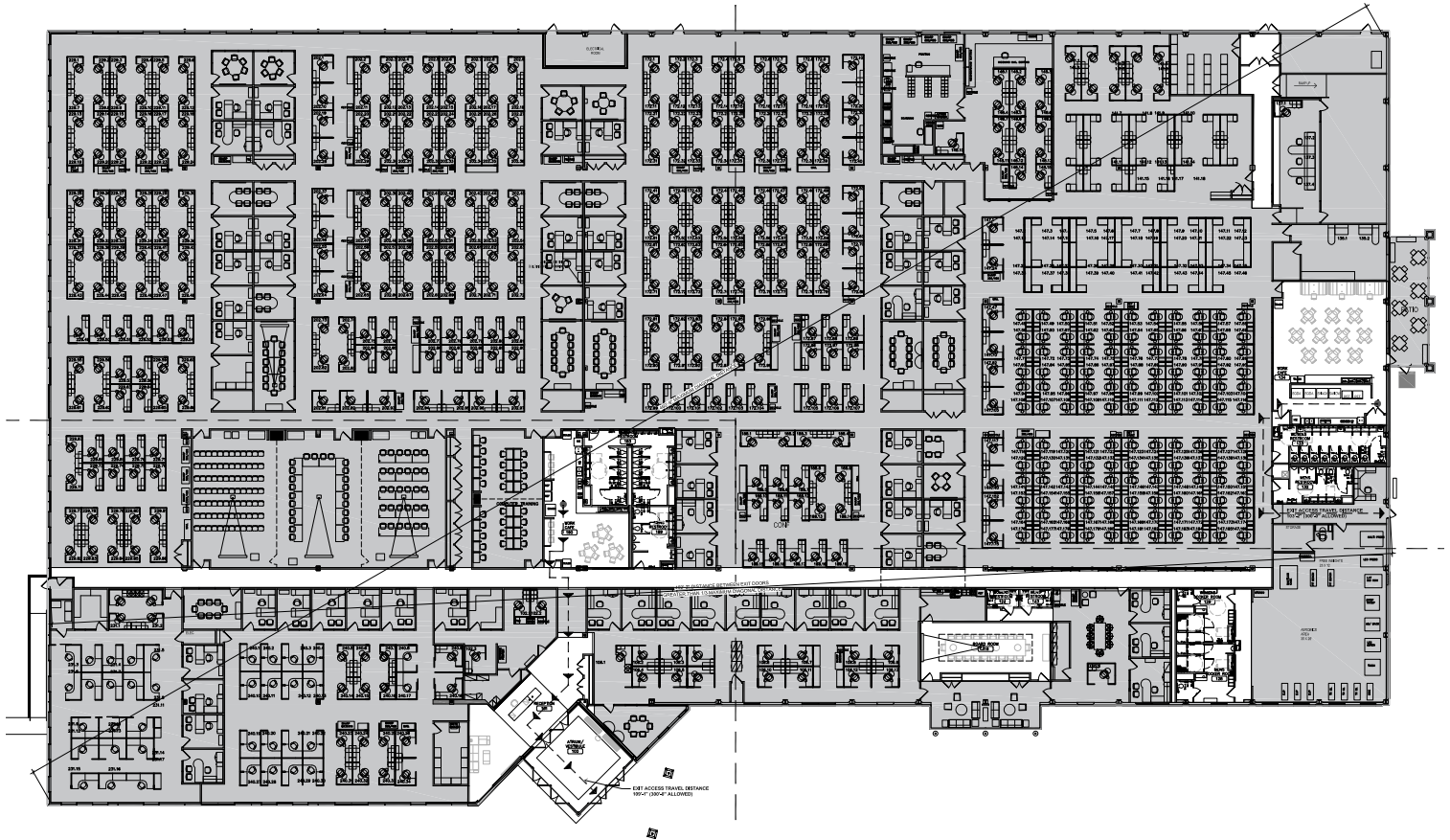

Plan does not necessarily reflect all current conditions

Interior Photos



Location Map

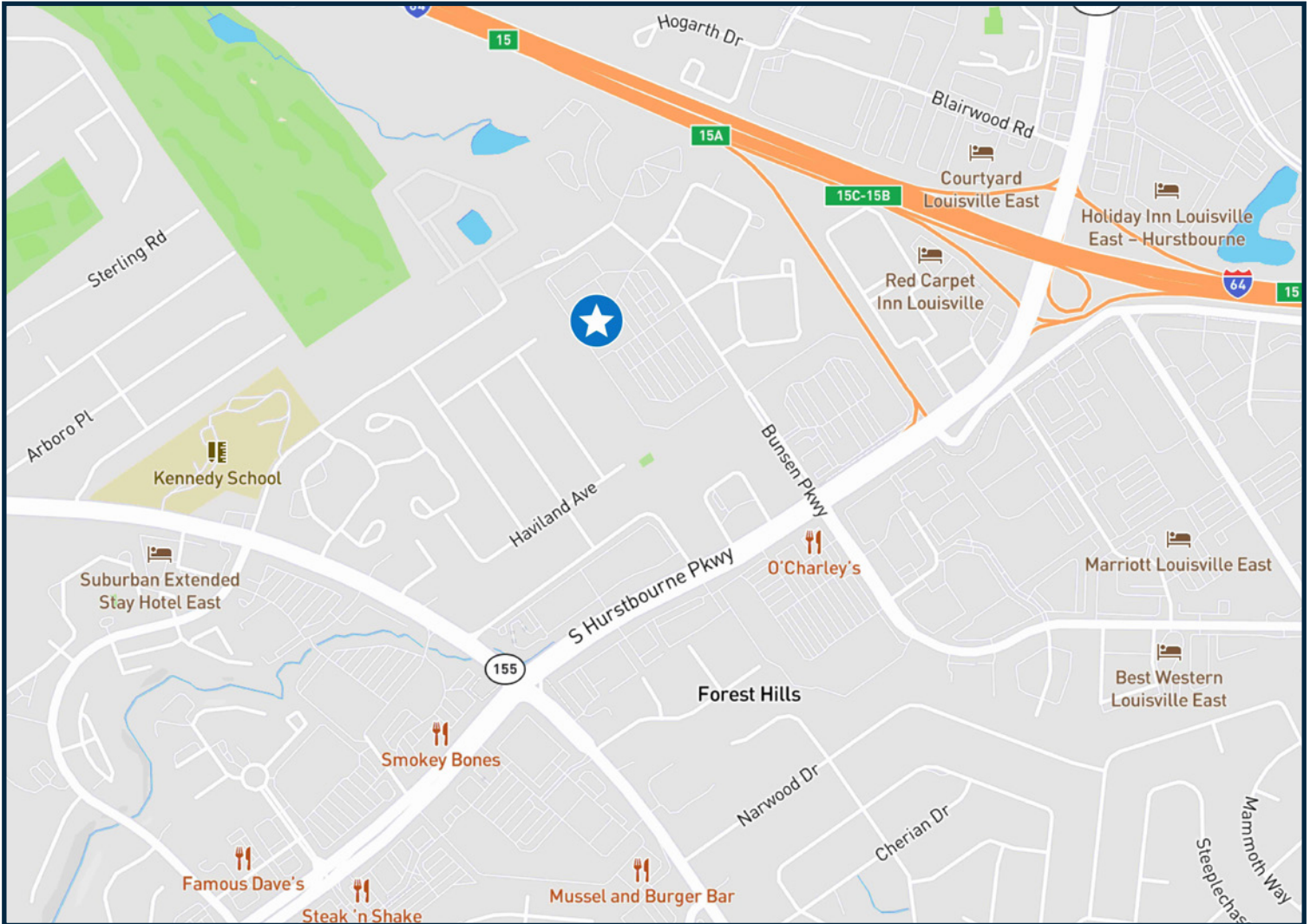

Contact Us

Rick Ashton, CCIM
Senior Vice President
+1 502 412 7612
rick.ashton@cbre.com

Jeff Dreher, SIOR
Senior Vice President
+1 502 412 7610
jeff.dreher@cbre.com

© 2024 CBRE, Inc. All rights reserved. This information has been obtained from sources believed reliable, but has not been verified for accuracy or completeness. You should conduct a careful, independent investigation of the property and verify all information. Any reliance on this information is solely at your own risk. CBRE and the CBRE logo are service marks of CBRE, Inc. All other marks displayed on this document are the property of their respective owners, and the use of such logos does not imply any affiliation with or endorsement of CBRE. Photos herein are the property of their respective owners. Use of these images without the express written consent of the owner is prohibited.