

FOR LEASE
±12,128 SF
INDUSTRIAL
BUILDING



PROPERTY FEATURES

- ±12,128 SF Industrial Warehouse
- ±4,456 SF Office / Shop Office
- 16' Clear Height
- Three (3) Ground Level Doors
- One (1) Shipping & Receiving Door
- 400 Amps, 277-480 V Power (Verify)
- Private Fenced Yard
- 23 Parking Spaces
- Fire Sprinklered
- New Exterior Paint & Asphalt
- Close Proximity to 71 & 60 Freeways



John Viscounty
Vice President
direct (909) 545-8002
jviscounty@voitco.com
Lic. 02028915

Shy Assar, MBA
Senior Vice President
direct (909) 545-8091
sassar@voitco.com
Lic. 01964667

Voit
REAL ESTATE SERVICES

FOR LEASE
±12,128 SF
INDUSTRIAL
BUILDING

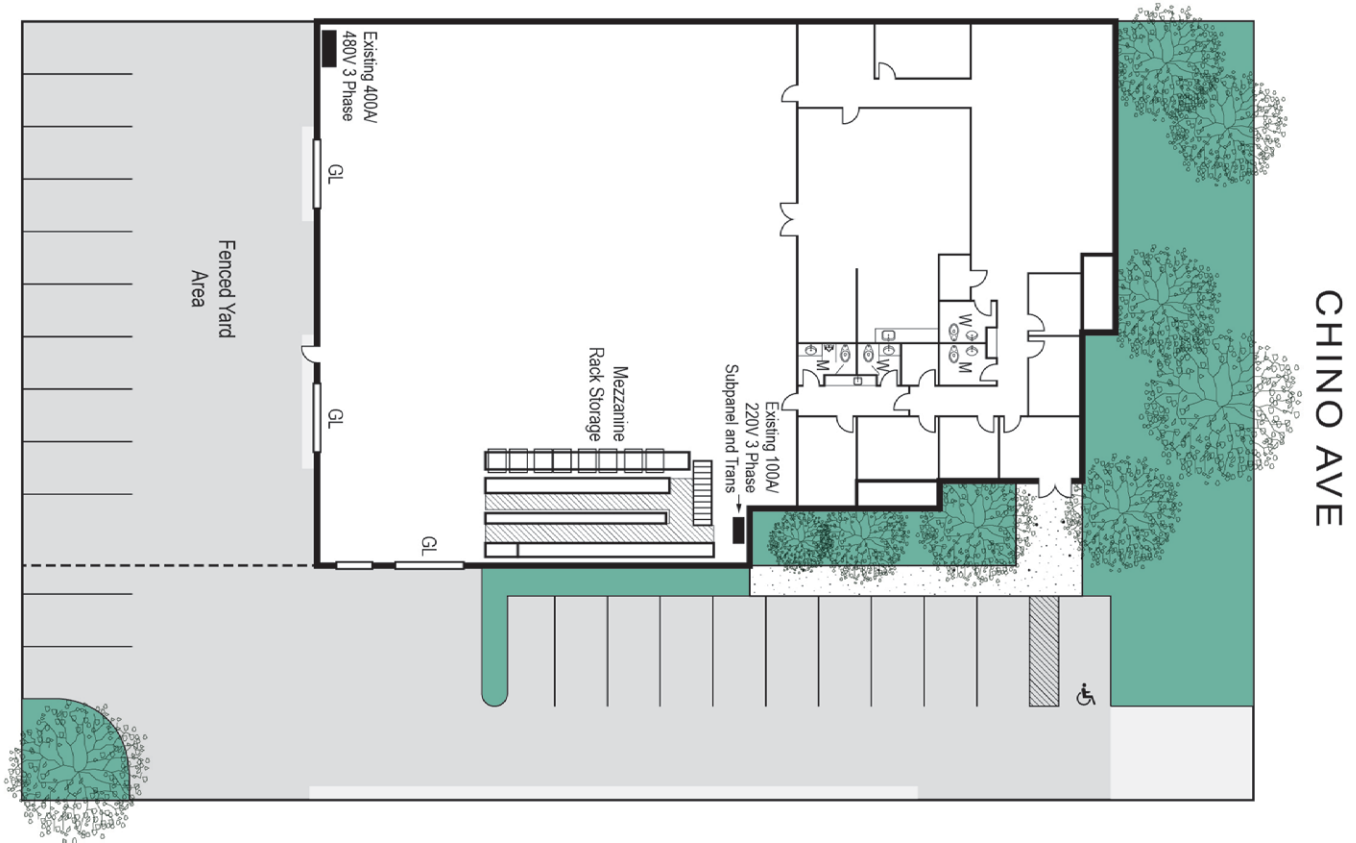

John Viscounty
Vice President

direct (909) 545-8002
mobile (714) 343-7677
jviscounty@voitco.com
Lic. 02028915

Shy Assar, MBA
Senior Vice President

direct (909) 545-8091
mobile (949) 981-4494
sassar@voitco.com
Lic. 01964667

Voit

REAL ESTATE SERVICES