

# Ideal Corporate Headquarters Available Immediately

savills

FOR LEASE & SALE

2525 Lake Park Boulevard Salt Lake City, UT 84120



## BUILDING PROFILE

125,130 SF

Total SF

Call Broker for Pricing

Rental rate & Sale price

Immediate

Availability

5.45 / 1,000 SF

Parking

## KEY HIGHLIGHTS

- Located in an opportunity zone
- Adjacent to Stonebridge Golf Course
- Walking trails, courtyard, and waterfront views
- Equipped with a back-up generator



## PROPERTY OVERVIEW

Discover this exceptional 125,130 sq. ft. Class A office building nestled within a thriving, master-planned community. Surrounded by lush greenery and a wealth of amenities, it offers a unique escape from the urban bustle.

This prime location boasts a vibrant mix of residential, retail, dining, hotel, and entertainment options, creating an ideal environment to attract and retain top talent.

Equipped with cutting-edge infrastructure, including an in-house data center, back-up generator, 12-inch raised floors, and a UPS system, this property presents a rare opportunity for tech, financial services, insurance, and healthcare companies seeking a sophisticated and reliable workspace.

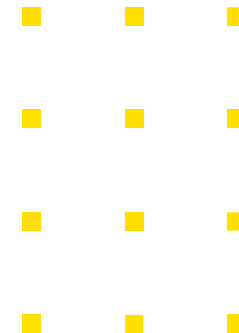



## FIRST FLOOR

41,710 SF TOTAL AVAILABLE

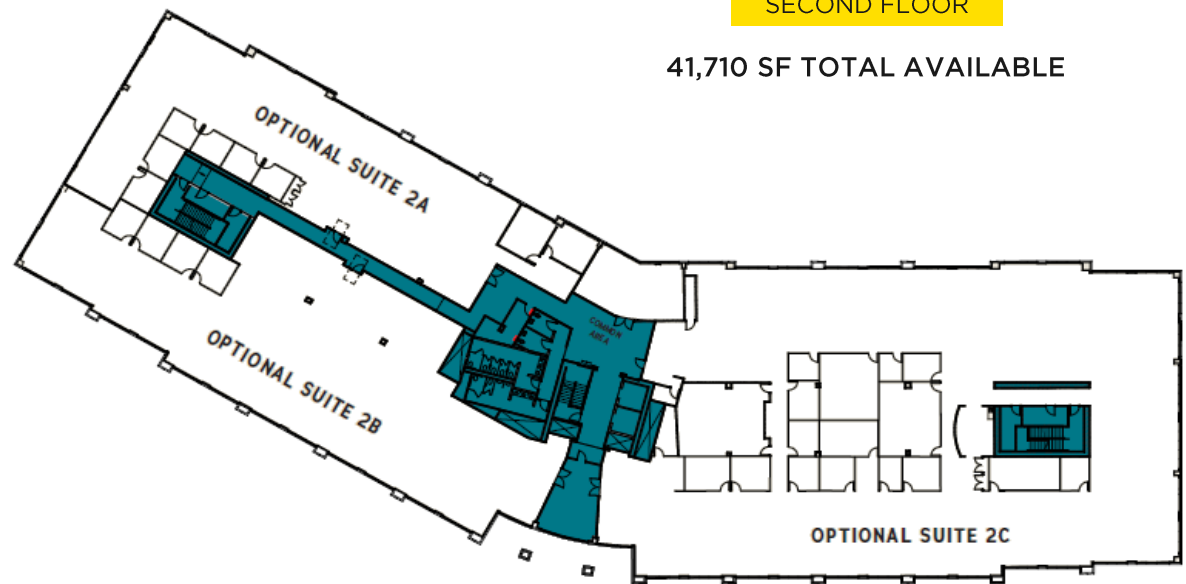

## SECOND FLOOR

41,710 SF TOTAL AVAILABLE



THIRD FLOOR

41,710 SF TOTAL AVAILABLE

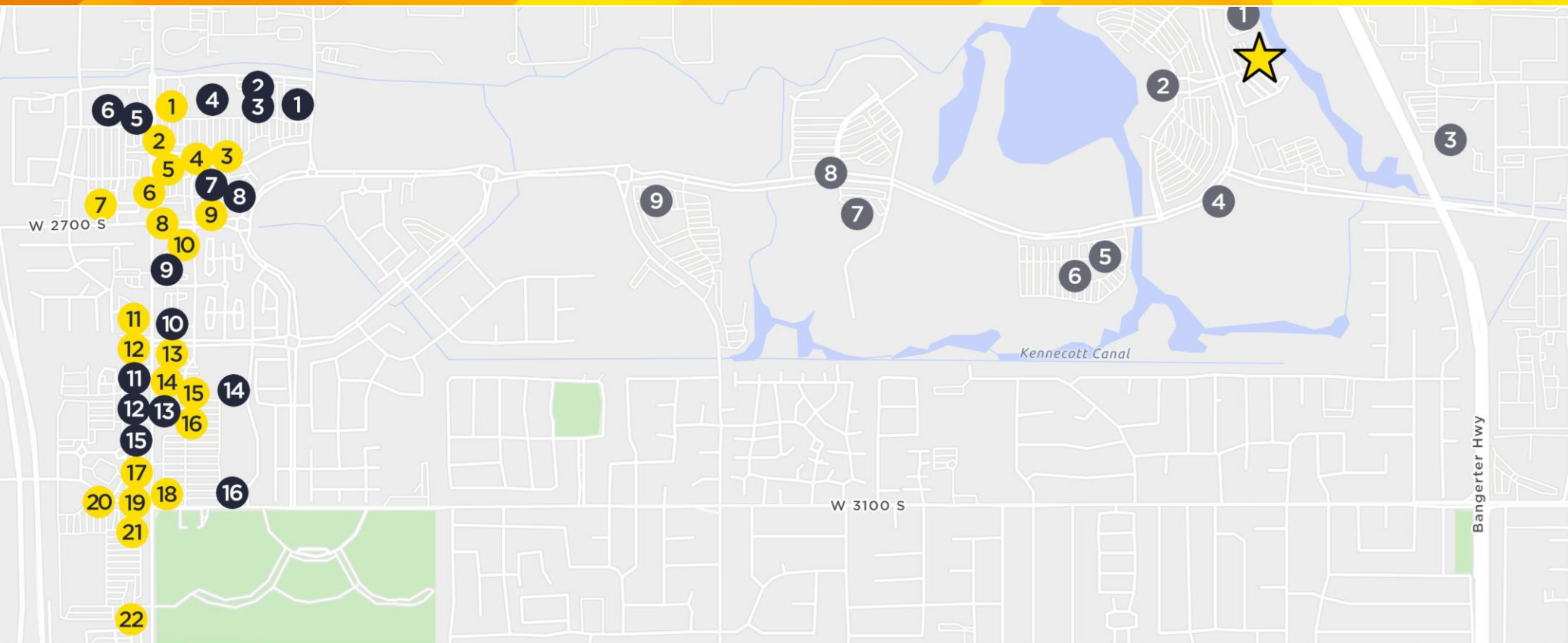

## Retail

- |                     |                         |
|---------------------|-------------------------|
| 1 Cinemark          | 9 Cyprus CU             |
| 2 Maurice           | 10 T-Mobile             |
| 3 Marshalls         | 11 Verizon              |
| 4 Target            | 12 Mountain American CU |
| 5 Great Clips       | 13 Ross                 |
| 6 Winco Foods       | 14 Burlington           |
| 7 Hampton Inn       | 15 Discount Tire        |
| 8 Town Place Suites | 16 Petsmart             |

## Food & Drink

- |                    |                       |
|--------------------|-----------------------|
| 1 Black Bear Diner | 12 Five Guys          |
| 2 Cafe Rio         | 13 Wing Stop          |
| 3 Freddy's         | 14 Buffalo Wild Wings |
| 4 Kneaders         | 15 Pizza Rev          |
| 5 Firehouse Subs   | 16 Del Taco           |
| 6 Dunkin' Donuts   | 17 Panda Express      |
| 7 Popeyes          | 18 Chilis             |
| 8 Potbelly         | 19 Beans & brew       |
| 9 Zaxby's          | 20 ElPollo Loco       |
| 10 MoBettah        | 21 IHOP               |

## Major Tenants

- |   |
|---|
| 1 Utah Housing Corp                     |
| 2 Discover Financial Services           |
| 3 Usana                                 |
| 4 SOLEIL Tech Park (Under Construction) |
| 5 Carbonite                             |
| 6 Sutter Shared Services                |
| 7 Motorola                              |
| 8 Intermountain Healthcare              |
| 9 Fiserv                                |

 **2525 Lake Park Blvd**



## **Nick Teseros**

Senior Managing Director

+1 619 885 9502

[nteseros@savills.us](mailto:nteseros@savills.us)



© 2024 Savills. All rights reserved. The information contained in this communication has been obtained from a variety of sources believed to be reliable but has not been verified. NO WARRANTY OR REPRESENTATION, EXPRESS OR IMPLIED, IS MADE AS TO THE CONDITION OF THE PROPERTY OR ACCURACY OR COMPLETENESS OF THE INFORMATION CONTAINED HEREIN AND SAME IS SUBMITTED SUBJECT TO ERRORS, OMISSIONS, CHANGE OF PRICE, RENTAL OR OTHER CONDITIONS, WITHDRAWAL WITHOUT NOTICE AND TO ANY SPECIFIC CONDITIONS IMPOSED BY THE PROPERTY OWNER OR LESSOR.