



# CENTRE RÉGIONAL CHÂTEAUGUAY CHÂTEAUGUAY, QUÉBEC

COMMERCIAL - À LOUER  
RETAIL - FOR LEASE

*JUSQU'À 25 000 PI. CA. | UP TO 25 000 SQ. FT.*

- **Situé au coeur de Châteauguay** | *Located in the heart of Châteauguay*
- **À quelques minutes de l'autoroute 30** | *Minutes from Highway 30*
- **Seul centre commercial fermés de la région** | *Only enclosed shopping center in the region*



**BRASSWATER**

245, avenue Victoria,  
Suite 801  
Westmount, Qc | H3Z 2M6

T: +1 514 535 4444  
[www.brasswater.ca](http://www.brasswater.ca)

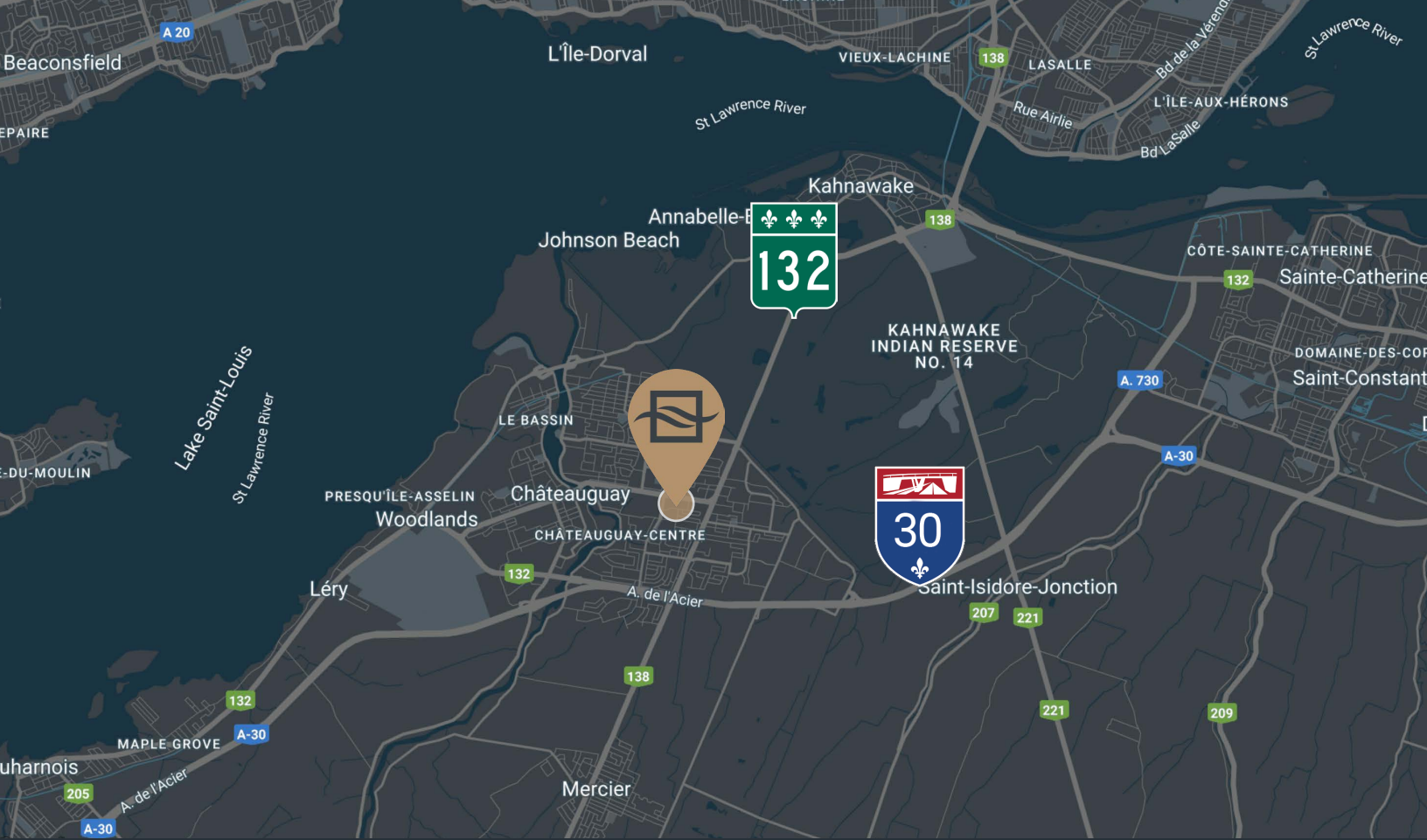

<b>Population</b>	<b>139 295</b>
<b>Familles</b> Families	<b>36 579</b>
<b>Foyer</b> Housing	<b>56 211</b>
<b>Salaire médian par foyer</b> Avg household income	<b>\$99 666</b>
<b>Âge moyen de la population</b> Avg Population age	<b>42</b>

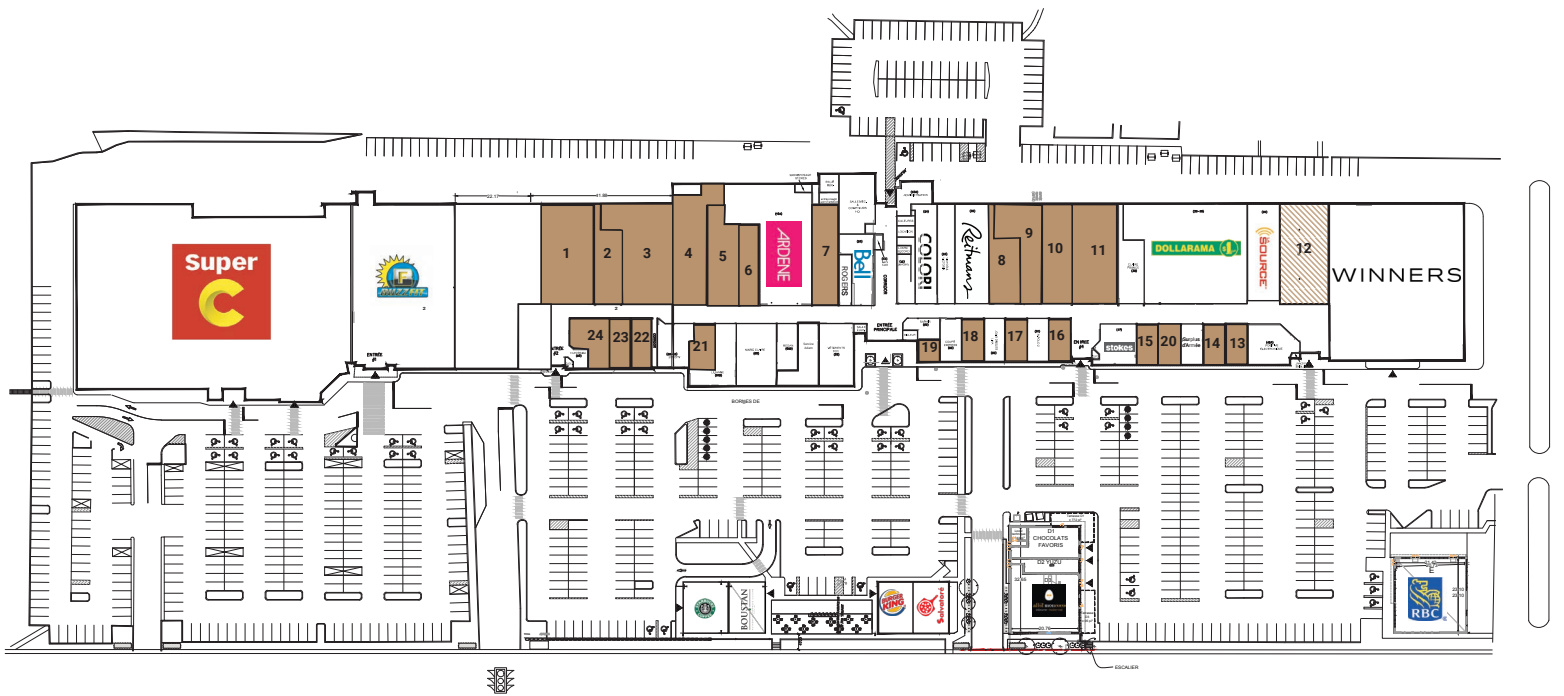

1	15	7 750 pi. ca	6	18B	1 670 pi. ca	11	30	4 500 pi. ca	16	50	924 pi. ca	21	61A	933 pi. ca
2	16	2 103 pi. ca	7	18	2 606 pi. ca	12	40	5 000 pi. ca	17	52	940 pi. ca	22	64	2 023 pi. ca
3	17	5 506 pi. ca	8	27	2 167 pi. ca	13	42B	911 pi. ca	18	54	962 pi. ca	23	65	1 034 pi. ca
4	18D	3 909 pi. ca	9	28	2 852 pi. ca	14	43	853 pi. ca	19	57	507 pi. ca	24	66-67	1 551 pi. ca
5	18C	2 799 pi. ca	10	29	3 058 pi. ca	15	46	856 pi. ca	20	45	846 pi. ca			

 Mois par Mois  
 Month to Month



## CONTACTEZ-NOUS – CONTACT US

### ÉQUIPE DE LOCATION LEASING TEAM

T: +1 514 535 4444  
[leasing@brasswater.ca](mailto:leasing@brasswater.ca)

---

### JORDAN KATZ

Directeur principal, location  
Senior Leasing Director

T: + 514 713 5289  
[jkatz@brasswater.ca](mailto:jkatz@brasswater.ca)



**BRASSWATER**

245, avenue Victoria,  
Suite 801  
Westmount, Qc | H3Z 2M6  
T: +1 514 535 4444  
[www.brasswater.ca](http://www.brasswater.ca)