

Burlington Centre, Burlington, Ontario



Located at the intersection of Guelph Line and Fairview Street in Burlington, this enclosed shopping centre offers 132 units totalling 738,000 sq. ft featuring retailers such as Indigo, Winners, Denninger's, SportChek, HomeSense, Hudson's Bay and Goodlife Fitness.

Population 

260,437

Average Household Income 

\$143,206

Households with Children 

46%

Median Age 

42 years

All figures are within a 10 Km radius.

Source: All demographic information is Copyright 2019 by Environics Analytics (EA).



Site Plan

Burlington Centre

Burlington, Ontario
777 Guelph Line
Guelph Line &
Fairview Street

Bryan Kolle
BKolle@riocan.com
416-866-8401

■ Shadow Anchor

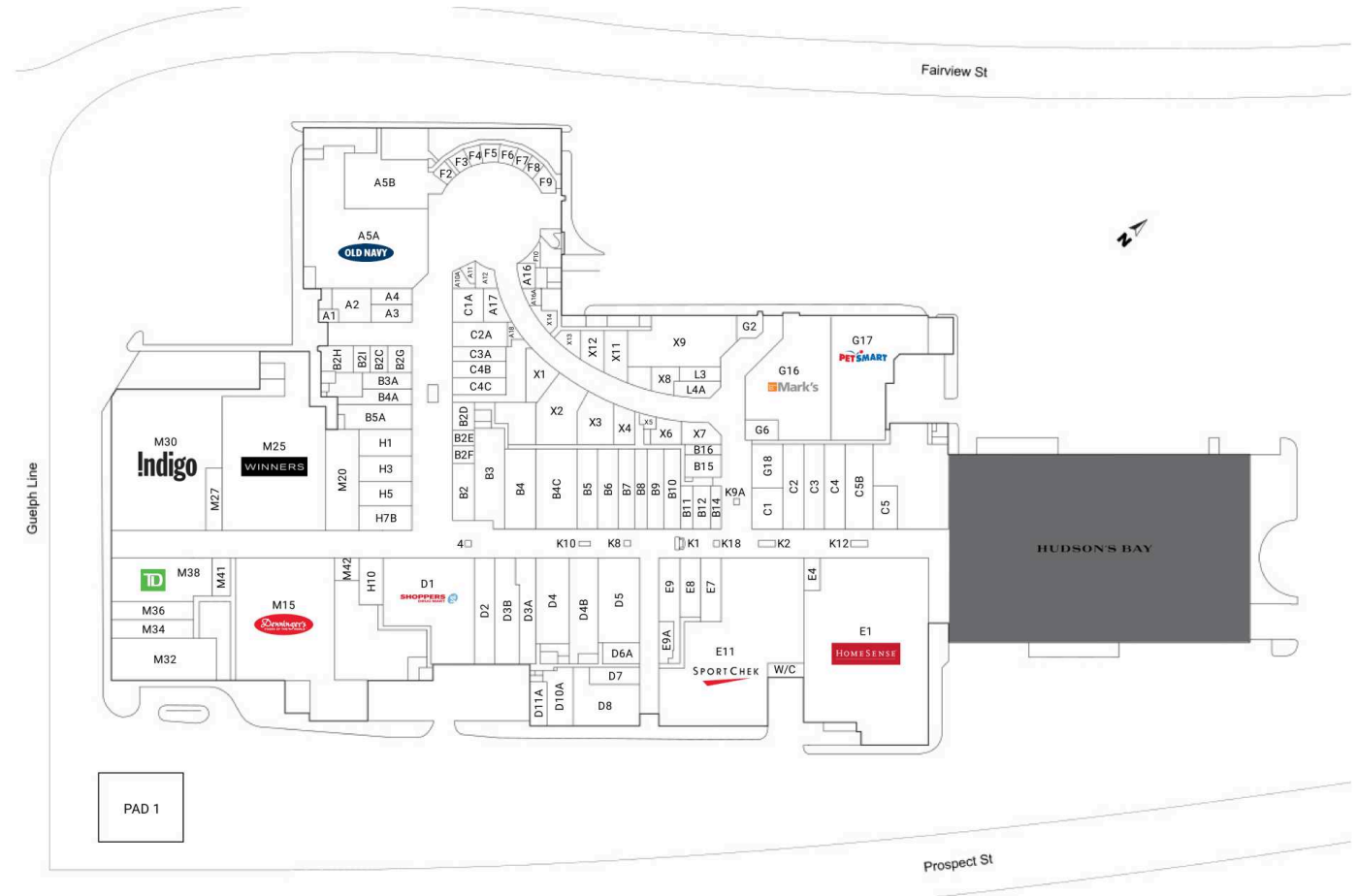

This site plan is presented solely for the purpose of identifying the approximate location and size of the building, and intended for use as a reference only. Ce plan de site est présenté uniquement dans le but d'identifier l'emplacement approximatif et la taille du bâtiment, et destiné à être utilisé comme référence seulement.

riocan.com | 1-800-465-2733

Site Plan

A010	Ardene	5,123 SF	B5	Available	3,045 SF	E1	HomeSense	30,250 SF	K9A	Wow! Mobile Boutique	150 SF
A1	CIBC	343 SF	B5A	Available	2,661 SF	E11	SportChek	25,224 SF	L3	Available	905 SF
A10A	Freshly Squeezed	390 SF	B6	Available	2,426 SF	E4	Trade Secrets	796 SF	L4A	Available	1,163 SF
A11	Sakura Ichiban Express	319 SF	B7	Available	1,941 SF	E7	Telus	1,400 SF	M15	Denninger's	22,842 SF
A12	Freshii	653 SF	B8	Bentley	1,456 SF	E8	Available	2,772 SF	M20	Famous Footwear	5,034 SF
A16	Available	577 SF	B9	Conspiracy Comics	1,941 SF	E9	Rogers	1,200 SF	M25	Winners	21,937 SF
A16A	Mr. Pretzels	415 SF	C006	Dollarama	8,969 SF	E9A	Nails For You	879 SF	M27	Real Fruit Bubble Tea	1,261 SF
A17	Showcase	984 SF	C1	Griffin Jewellery Design	1,897 SF	F10	Famous Wok	374 SF	M30	Indigo	22,281 SF
A18	Available	347 SF	C1A	Eye Q	1,524 SF	F2	A&W	395 SF	M32	East Side Mario's	5,068 SF
A2	Cogeco Cable	1,841 SF	C2	Hallmark	2,567 SF	F3	Jimmy The Greek	400 SF	M34	Blaze Fast Fire'd Pizza	2,472 SF
A3	Michael Hill Jeweller	1,000 SF	C2A	My Lauft	1,978 SF	F4	Thai Express	390 SF	M36	Five Guys Burgers	2,481 SF
A4	Change	1,023 SF	C3	Classique Decor	2,588 SF	F5	New York Fries	333 SF	M38	TD	6,093 SF
A5A	Old Navy	17,398 SF	C3A	Available	1,073 SF	F6	KFC/Taco Bell	350 SF	M41	Available	1,535 SF
A5B	The Shoe Company	7,210 SF	C4	Changehouse Store & Hello Monday Shop	2,576 SF	F7	Subway	300 SF	M42	New York News	733 SF
B10	Northern Reflections	1,952 SF	C4B	Available	1,308 SF	F8	Koya Japan	373 SF	MRU1	Timepiece Plus	60 SF
B11	Value Mobile	788 SF	C4C	Available	1,378 SF	F9	Tim Hortons	598 SF	MRU 1.00	Available	
B12	Claire's	1,174 SF	C5	Martindale Dental	1,544 SF	G16	Mark's	15,300 SF	PAD 1	Kelsey's	6,026 SF
B14	Laura Secord	696 SF	C5B	Tip Top	3,541 SF	G17	PetSmart	14,252 SF	X1	Available	1,650 SF
B15	Total Image	1,287 SF	D1	Shoppers Drug Mart	11,195 SF	G18	Pearle Vision	1,981 SF	X10	Available	676 SF
B16	Personal Edge (Relocation)	568 SF	D10A	Stacked Pancake & Breakfast House	2,273 SF	G2	Available	814 SF	X11	Available	1,609 SF
B2	Peoples Jewellers	1,698 SF	D11A	Jasmine Rice By First Choice Kitchen	1,072 SF	G6	Kristals	976 SF	X12	The Artisanville	1,184 SF
B2C	Available	666 SF	D2	Dress People Ltd.	3,167 SF	H1	Available	1,978 SF	X13	Future Tech	2,437 SF
B2D	Maverick Studio for Men	897 SF	D3A	The Source	2,720 SF	H10	EB Games	1,550 SF	X14	Arain Jewellers	531 SF
B2E	Stitch It	510 SF	D3B	Available	3,678 SF	H3	Beauty First	1,916 SF	X2	Eh Canada	3,868 SF
B2F	Kernels And Baskin-Robbins	563 SF	D4	Cleo	4,147 SF	H5	Flight Centre	1,943 SF	X3	Available	2,437 SF
B2G	Available	902 SF	D4B	Reitmans	4,001 SF	H7B	Bell	1,958 SF	X4	J'adore	1,176 SF
B2H	Total Beauty Essentials	1,200 SF	D5	Bluenotes	5,136 SF	K020	Available	100 SF	X5	Freedom Mobile	318 SF
B2I	The Hub	660 SF	D6A	Public Washrooms	1,114 SF	K1	Burlington Lotto	74 SF	X6	Available	980 SF
B3	Urban Kids	4,265 SF	D7	Hair Forum	1,220 SF	K10	TBooth	220 SF	X7	Burlap and Twine	1,204 SF
B3A	Cellicon	1,197 SF	D8	Bank of Montreal	4,429 SF	K12	Koodo	200 SF	X9	West Coast Kids	12,392 SF
B4	Fairweather	3,799 SF				K18	Fido	112 SF	4	Guest Services Kiosk	319 SF
B4A	Available	1,515 SF				K2	Wirelesswave	200 SF			
B4C	Available	6,539 SF				K8	Virgin Plus	150 SF			

Burlington Centre

Burlington, Ontario
777 Guelph Line
Guelph Line &
Fairview Street

Bryan Kolle
BKolle@riocan.com
416-866-8401

■ **Shadow Anchor**

Office Galleria 2nd Floor



201	GoodLife Fitness	58,062 SF	210	RioCan Property Services	3,028 SF
202	Best Stitches	1,263 SF	212	ABL Employment	856 SF
203	Move Physiotherapy & Massage Therapy	2,250 SF	213	Burlington Mall Dental	3,188 SF
204	HMC Connections	3,437 SF	214	Adapt	4,271 SF
207	Thrive Counselling Services	6,557 SF	215	Softron Tax	628 SF
209	Ms. Karina Gould MP for Burlington	1,084 SF			