

GENERAL NOTES

REV.	DESCRIPTION	DATE	BY
5			
4			
3			
2			
1			

TH&P
 Tysinger, Hampton & Partners, Inc.
 Civil Engineering - Surveying - Environmental Consulting
 3428 BRISTOL HIGHWAY
 JOHNSON CITY, TENNESSEE 37601
 Phone: (423) 282-2687 - Fax: (423) 854-4563
 Email: thp@tysinger-engineering.com
 WWW.TYSINGER-ENGINEERING.COM

These documents prepared by Tysinger, Hampton & Partners, Inc. (TH&P) are instruments of TH&P's service. Unless otherwise indicated, TH&P shall be deemed the author of drawings, specifications and other documents and will retain all common law, statutory and other reserved rights. In addition to the copyright, documents prepared by TH&P are for use solely with respect to this project. These documents shall not be used, copied or retained without the specific written consent of TH&P. Any violation of the above rights of TH&P shall be prosecuted to the maximum possible extent within the law.

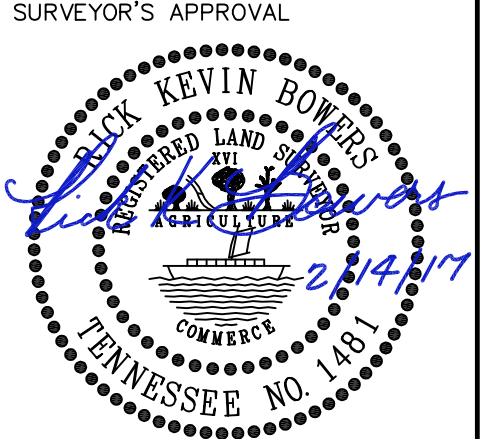

I (we) hereby certify that the information, as shown herein, is true and correct to the best of my (our) knowledge and belief. And this survey was done in compliance with current Tennessee Minimum Standards of Practice.

SURVEY FOR:
JOHN WALKER

LOCATION:
**9th CIVIL DISTRICT
 WASHINGTON COUNTY,
 TENNESSEE**

DWG. TITLE
**TOPOGRAPHICAL
 SURVEY**

ISSUE DATE:
 CADD FILE: 1767500s-Topo.dwg
 SCALE: 1"=50' JOB NO.
 DRAWN: RKT
 CHECK: RKB **1767500S**
 DATE: 2/14/17



- LEGEND**
- SAN.MH (S) - SANITARY SEWER MANHOLE
 - CO (O) - CLEAN OUT
 - FH (FH) - FIRE HYDRANT
 - WV (WV) - WATER VALVE
 - PP (PP) - POWER POLE
 - LP (LP) - LIGHT POLE
 - CB (CB) - CATCH BASIN
 - CI (CI) - CURB INLET
 - DBL.CI (DBL.CI) - DOUBLE CURB INLET
 - ST.MH (ST.MH) - STORM MANHOLE
 - SN (SN) - SIGN
 - (T) - TREE

- NOTES:**
- THIS SURVEY WAS MADE WITHOUT THE BENEFIT OF A TITLE COMMITMENT.
 - THIS PROPERTY DOES NOT LIE IN A SPECIAL FLOOD HAZARD AREA, AS PER FIRM MAP NO. 47179C0159D, EFFECTIVE DATE: SEPTEMBER 29, 2006.

NOTICE
 LOCATION OF ALL UTILITIES AND UNDERGROUND STRUCTURES SHOWN ARE APPROXIMATE AND THOSE SHOWN ARE NOT NECESSARILY ALL OF THE EXISTING UTILITIES AND STRUCTURES. IT IS THE CONTRACTOR'S RESPONSIBILITY TO DETERMINE THE EXACT LOCATION AND THE EXISTENCE OF ALL UTILITIES AND UNDERGROUND STRUCTURES.