

BOARDWALK SHOPPES II

RESTAURANT &
RETAIL SPACE
AVAILABLE



1076 WEST SR 436 ALTAMONTE SPRINGS, FL 32714

BOARDWALK SHOPPES II



2ND GEN RESTAURANT + RETAIL
IN ALTAMONTE SPRINGS

PROPERTY HIGHLIGHTS

- **1,683- 5,760 SF AVAILABLE**
- 2nd GEN FREESTANDING RESTAURANT SPACE W/ OUTDOOR DECK SEATING AND OPEN INTERIOR LAYOUT
- ON SR 436 A MAJOR THOROUGHFARE THROUGH ALTAMONTE SPRINGS, LONGWOOD AND MORE
- SIGNALIZED INTERSECTION AT ENTRANCE ON A BUSY RETAIL CORRIDOR
- NEWLY PAVED PARKING LOT
- HIGH TRAFFIC COUNTS- 51,000+ CARS TRAVELING ON SR 436 DAILY



SITE PLAN

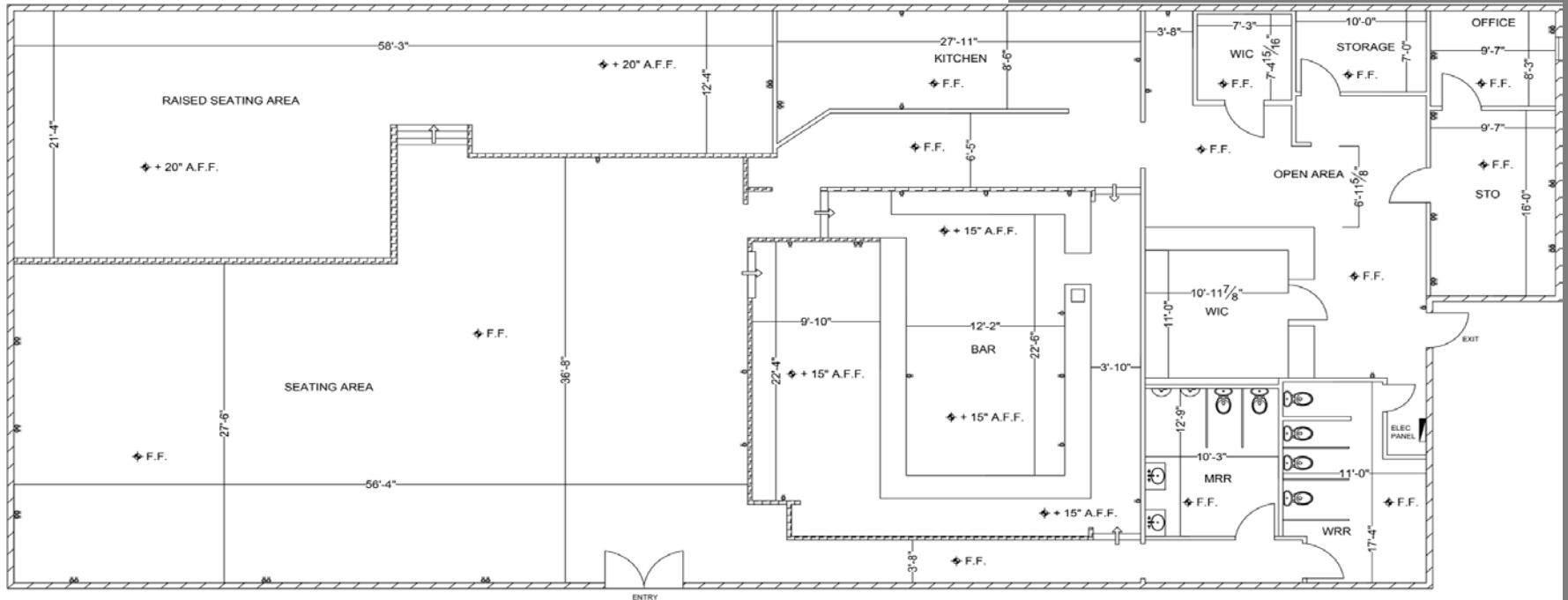

5,760 SF FREESTANDING 2ND GENERATION RESTAURANT SPACE

SITE PLAN

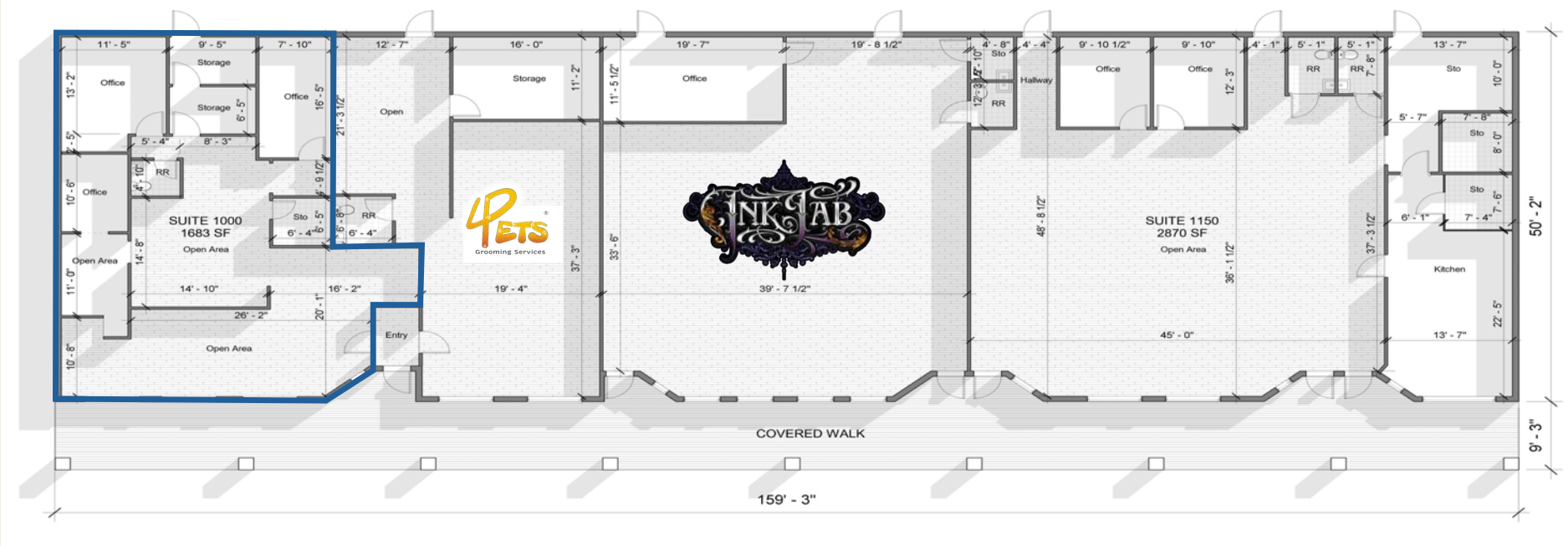

SUITE 1000
1,683 SF

SUITE 1050
4 PETS
1,300 SF

SUITE 1100
THE INK LAB
2,029 SF

SUITE 1150
TASTE OF BRAZIL
2,870 SF

DEMOGRAPHICS

ALTAMONTE SPRINGS IS A SUBURBAN CITY JUST NORTH OF ORLANDO BOASTING A DIVERSE ECONOMY WITH A MIX OF RETAIL, HEALTHCARE AND SERVICE INDUSTRIES. THE CITY IS WELL CONNECTED BY MAJOR HIGHWAYS, PARTICULARLY I-4, MAKING IT AN IDYLIC LOCATION FOR BUSINESS PROFESSIONALS AND FAMILIES TRAVELING TO ORLANDO AND OTHER AREAS OF CENTRAL FLORIDA.

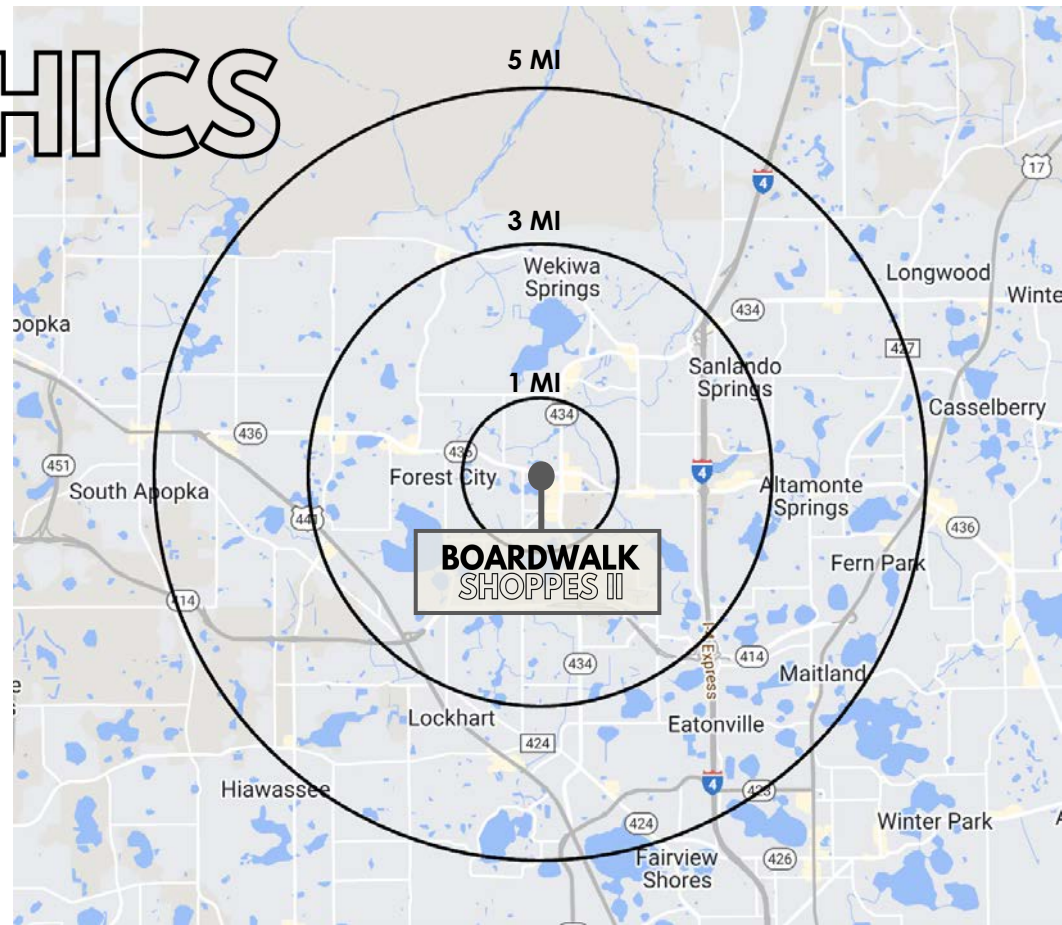

	1 MILE	3 MILES	5 MILES
POPULATION	14,276	108,092	221,079
AVG HH INCOME	\$102,294	\$114,668	\$113,973
AVG AGE	35.0	37.5	37.7
DAYTIME EMPLOYEES	6,847	68,175	138,485

BOARDWALK SHOPPES II

RETAIL AROUND TOWN



RETAIL LEASING CONTACTS

BOARDWALK SHOPPES II

Alden Pkwy



436
LIC. REAL ESTATE BROKER

SERENITY LORENZ

VP of Sales & Leasing
Central Florida Office
serenity@acrefl.com
(904) 887-3302

SANDI BARGFREDE

Managing Partner
sandi@acrefl.com
(407) 491-8149

This presentation is provided for informational purposes only and does not constitute legal, financial, or investment advice. It is intended solely to provide general information about the properties and services offered by ACRE Commercial, its affiliates, partners, and subsidiaries. All information contained herein is obtained from sources deemed reliable; however, we make no representations or warranties, express or implied, regarding the accuracy, completeness, or reliability of any information provided. Prospective buyers, sellers, landlords, tenants, investors, or other parties should conduct their own due diligence and consult with appropriate professionals (including legal, financial, and real estate advisors) before making any decisions or entering into any agreements. ©2024. All rights reserved.

