

# FOR SUB-LEASE

27,150 SF – Office Space - Subdividable  
7 Technology Park Drive, Bourne, MA

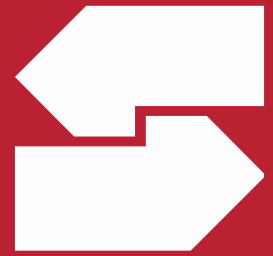

<b>Size:</b>	2,928 SF up to the Entire Building of 27,150 SF. Mix of Open & Private Offices. Shared Conference Room, Baths and Large Kitchenette
<b>Fully Furnished</b>	Desks & Work Stations are included.
<b>Parking Spaces:</b>	117 non-exclusive spaces.
<b>Location:</b>	1.5 Miles from the Bourne Bridge. Adjacent to MacArthur Blvd. / Route 28.
<b>CAM:</b>	\$5.75 SF, includes All Utilities, Snow, Landscaping, Interior Janitorial, Trash.
<b>For Sub-Lease:</b>	<b>\$17.00 SF Plus CAM.</b>



**SOUTHEAST  
COMMERCIAL  
REAL ESTATE, INC**

**MICHAEL GIANCOLA, SIOR**  
Southeast Commercial Real Estate, Inc.  
3131 Cranberry Highway, P.O. Box 570  
East Wareham, MA 02538

| 508.759.3030  
| mgiancola@ccim.net  
| southeastcommercialre.com

**8,534 RSF**  
6,625 USF



~7,900 RSF  
~6,130 USF

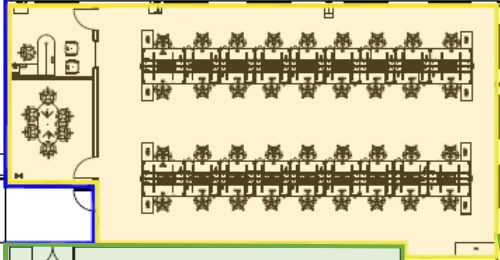
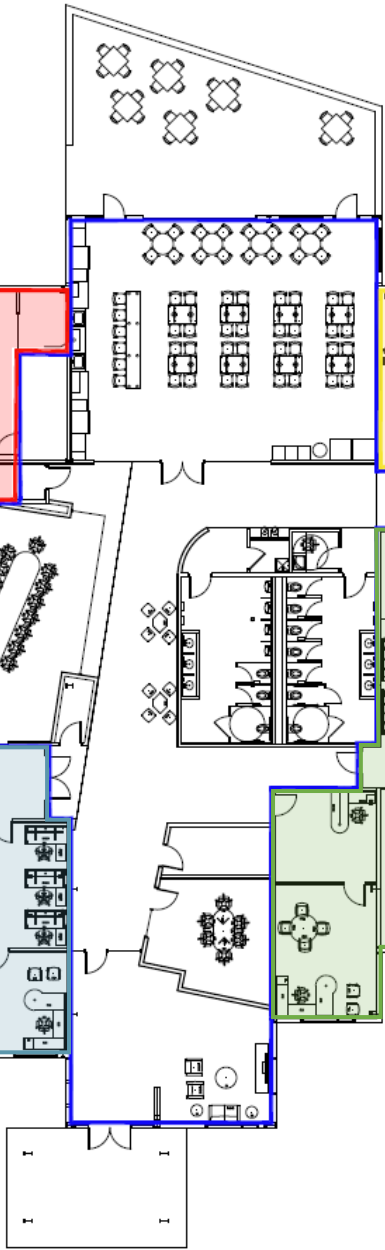

**2,928 RSF**  
2,273 USF

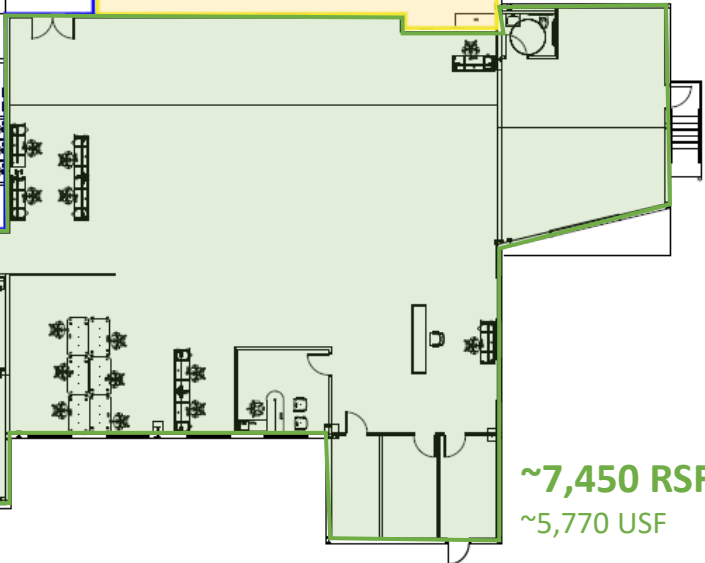

~7,450 RSF  
~5,770 USF