

- Existing Water Line
- - - Proposed Water - El Rio North PICP
- Existing Wastewater Line
- - - Existing Overhead Electric
- Existing Underground Electric
- - - Existing Gas Line
- - - Easements
- Trace Boundary
- Tract Boundaries
- Existing Access

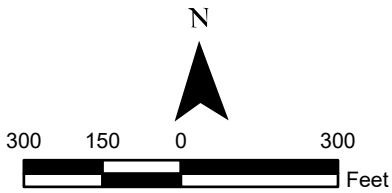

Spatial Reference
 PCS: NAD 1983 State Plane Texas Central FIPS 4203 Feet
 GCS: North American 1983
 Datum: North American 1983
 Projection: Lambert Conformal Conic
 Map Units: Foot US

PROJECT NO.: 70091-01-029
 DRAWN BY: BOBBY ROSS
 DATE: 7/30/2024 8:24 AM

*Asterisks indicate access that is right-turn in and right-turn out only.

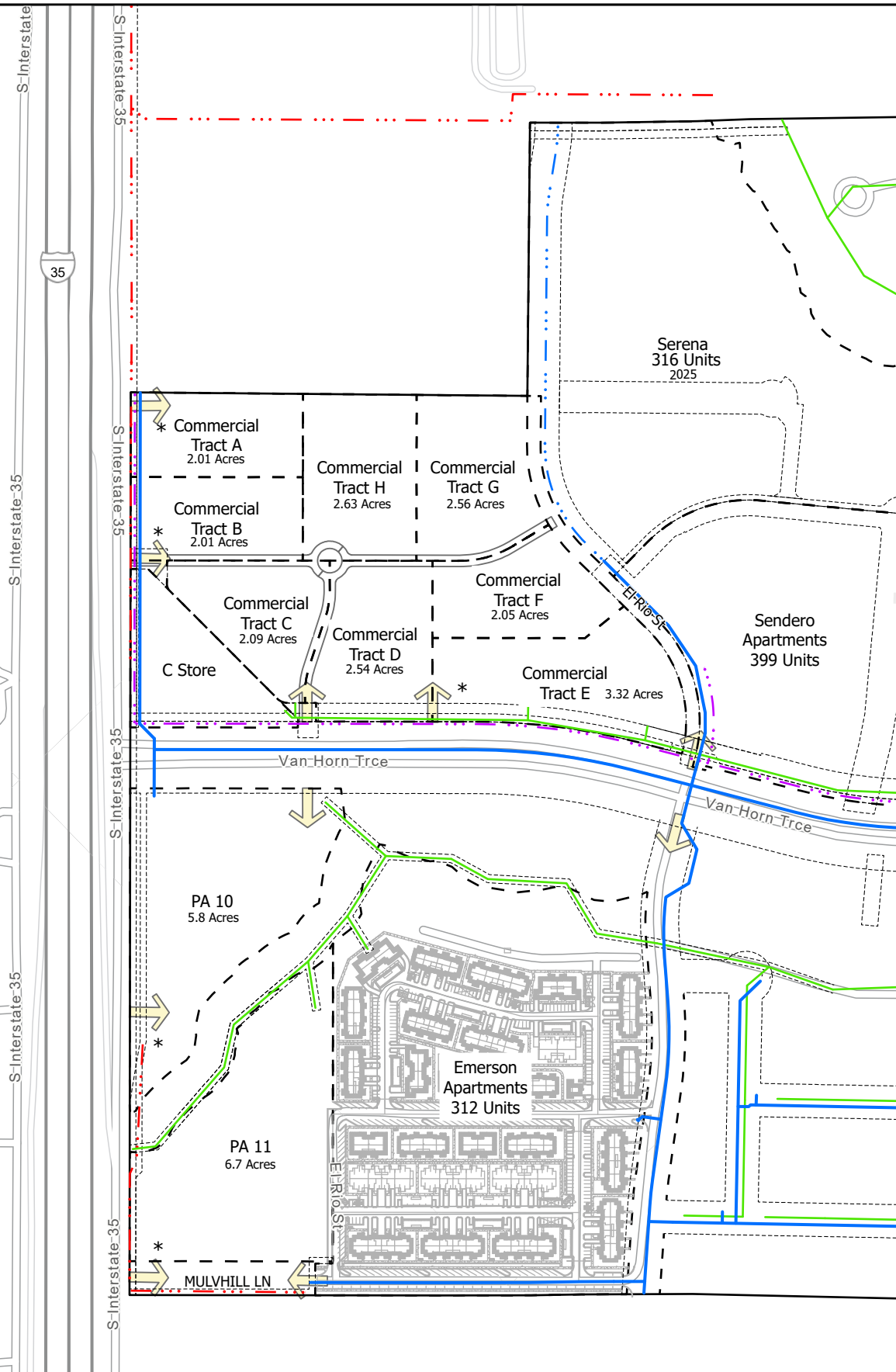

Bowman

© 2024 Bowman Consulting Group Ltd
 151 Stagecoach Trail | Suite 130 | San Marcos, Texas 78666
 Phone: (512) 396-2600 | www.bowman.com
 TBPE Firm Registration No. F-14309

HIGHPOINTE TRACE

COMMERCIAL TRACTS PA 9, 10, & 11

CONCEPTUAL LAYOUT

SAN MARCOS, TX 78666

THIS DOCUMENT IS RELEASED
 FOR THE PURPOSE OF INTERIM
 REVIEW, MARK-UP, AND/OR
 DRAFTING UNDER THE
 AUTHORITY OF
 BOBBY ROSS, P.E.
 #149399
 ON TUESDAY, JULY 30, 2024
 IT IS NOT TO BE USED FOR
 CONSTRUCTION, BIDDING,
 OR PERMIT PURPOSES.