

18201 JOY ROAD
DETROIT, MICHIGAN

RETAIL FOR SALE
2,156 Square Feet Available



**SIGNATURE
ASSOCIATES**
KNOW SIGNATURE | KNOW RESULTS



PROPERTY FEATURES

- 2,156 square feet available
- Multi-tenant retail building
- Zoned B4
- Street parking
- Available immediately
- Sale Price: \$195,000 (\$90.45/sq. ft.)



For more information, please contact:

JOE STACK
(248) 359 0615
jstack@signatureassociates.com

MARVIN PETROUS
(248) 359 0647
mpetrous@signatureassociates.com

SIGNATURE ASSOCIATES
One Towne Square, Suite 1200
Southfield, MI 48076
www.signatureassociates.com

Information is subject to verification and no liability for errors or omissions is assumed. Price is subject to change and listing withdrawal.

18201 Joy Road – Detroit, Michigan
Retail For Sale

2,156
Square Feet
AVAILABLE

Site Plan

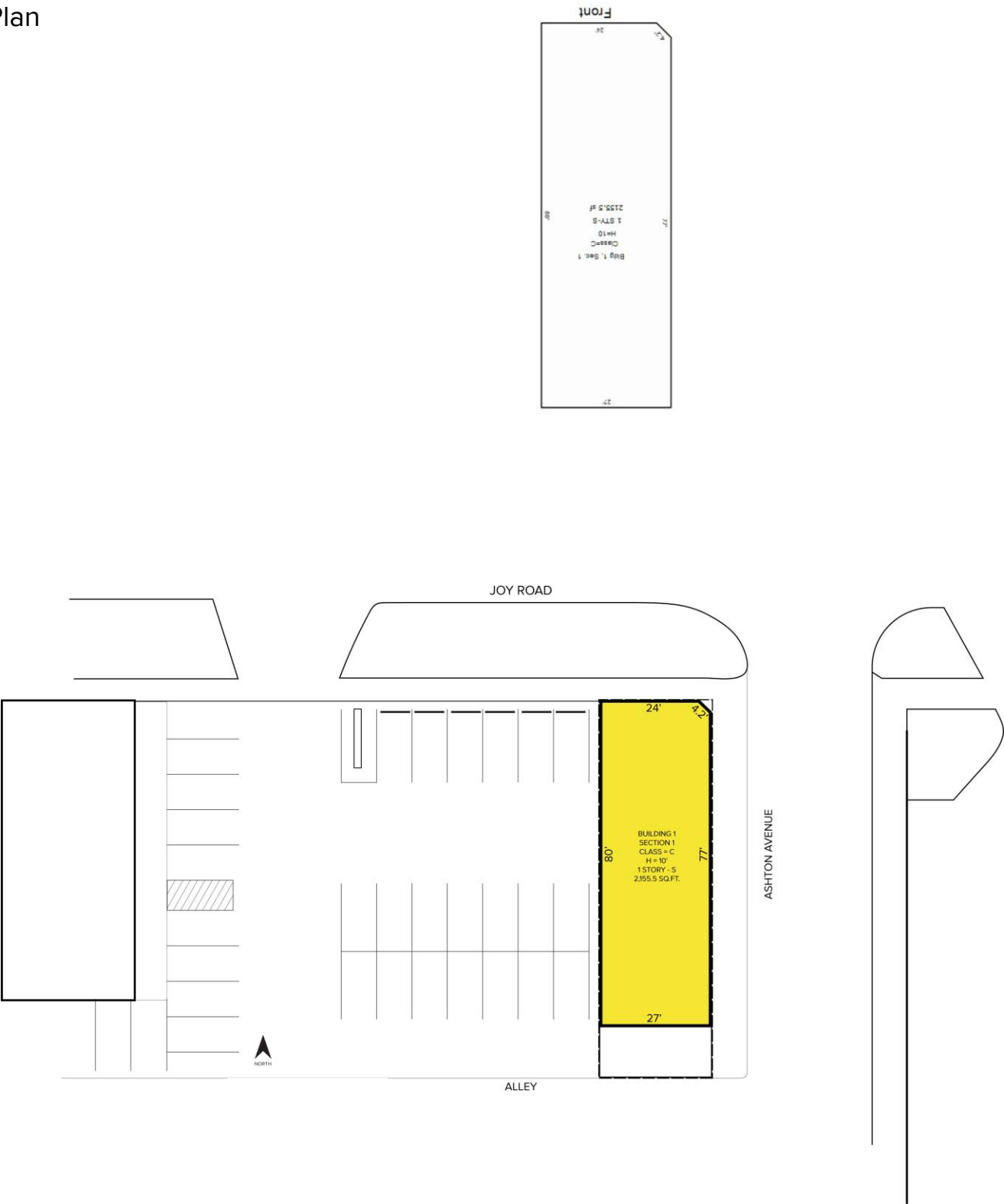

For more information, please contact:

JOE STACK
(248) 359 0615
jstack@signatureassociates.com

MARVIN PETROUS
(248) 359 0647
mpetrous@signatureassociates.com

SIGNATURE ASSOCIATES
One Towne Square, Suite 1200
Southfield, MI 48076
www.signatureassociates.com

18201 Joy Road – Detroit, Michigan

Retail For Sale

2,156
Square Feet
AVAILABLE

DEMOGRAPHICS

	POPULATION	MED. HH INCOME
1 MILE	18,646	\$38,465
3 MILE	149,649	\$46,464
5 MILE	369,267	\$51,301

TRAFFIC COUNTS (TWO-WAY)

15,361	Joy Rd. E. of M-39
13,443	Joy Rd. W. of M-39
132,831	M-39 N. of Joy Rd.
135,782	M-39 S. of Joy Rd.



For more information, please contact:

JOE STACK
(248) 359 0615
jstack@signatureassociates.com

MARVIN PETROUS
(248) 359 0647
mpetrous@signatureassociates.com

SIGNATURE ASSOCIATES
One Towne Square, Suite 1200
Southfield, MI 48076
www.signatureassociates.com