

300 E. MILWAUKEE AVENUE
DETROIT, MICHIGAN

INDUSTRIAL FOR SALE
9,000 Square Feet Available



**SIGNATURE
ASSOCIATES**
KNOW SIGNATURE | KNOW RESULTS



PROPERTY FEATURES

- 9,000 square feet available
- 12' – 22' clear height
- (1) 10' x 12' grade level door
- Zoned M3
- Available immediately
- Easy access to I-75 and I-94
- Sale Price: \$775,000 (\$86.11/sq. ft.)



For more information, please contact:

CHRIS MONSOUR
(248) 948 0107
cmonsour@signatureassociates.com

STEVE GORDON
(248) 948 0101
sgordon@signatureassociates.com

SIGNATURE ASSOCIATES
One Towne Square, Suite 1200
Southfield, MI 48076
www.signatureassociates.com

300 E. Milwaukee Avenue – Detroit, Michigan

Industrial For Sale

9,000
Square Feet
AVAILABLE

Site Plan

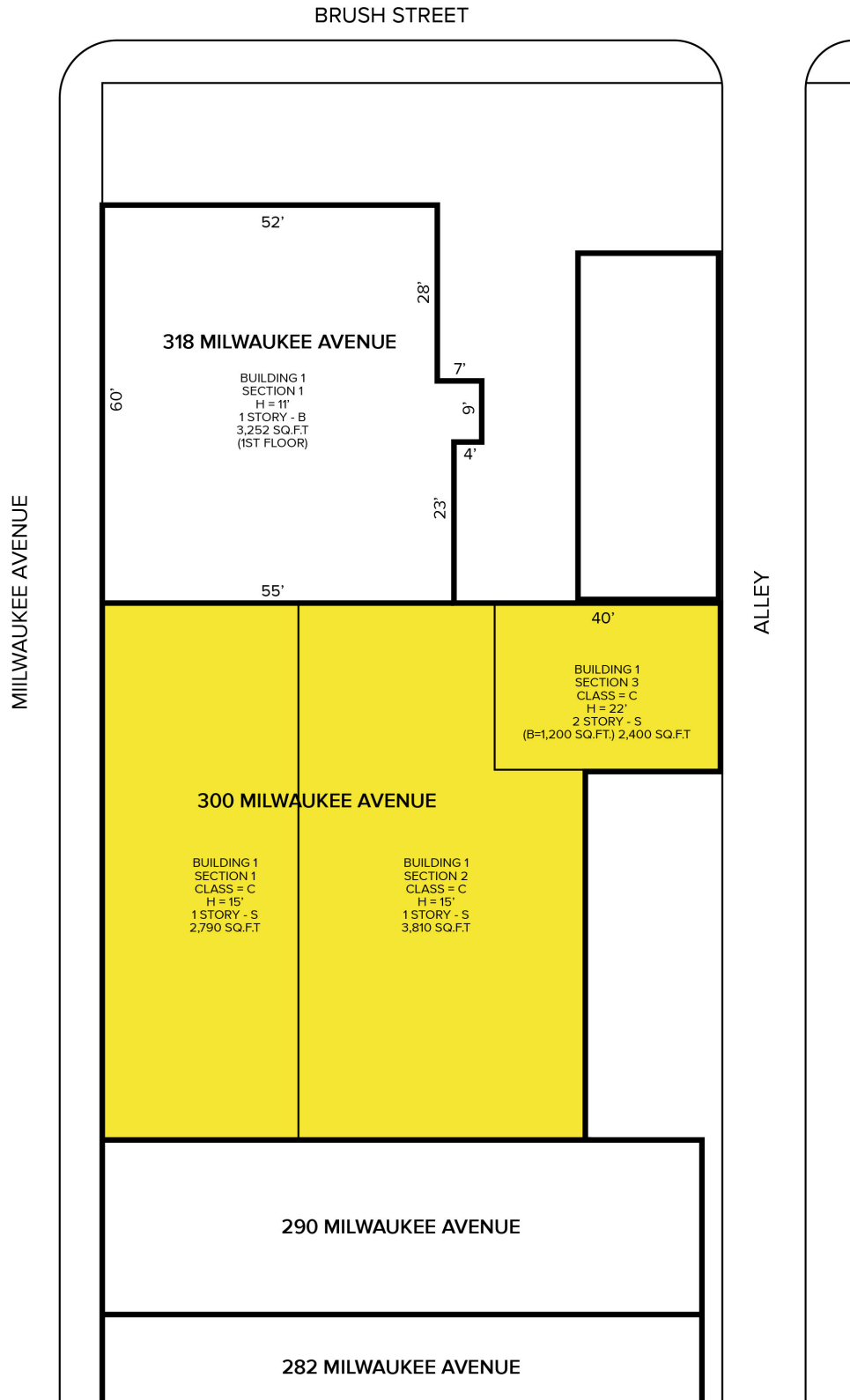

For more information, please contact:

CHRIS MONSOUR
(248) 948 0107
cmonsour@signatureassociates.com

STEVE GORDON
(248) 948 0101
sgordon@signatureassociates.com

SIGNATURE ASSOCIATES
One Towne Square, Suite 1200
Southfield, MI 48076
www.signatureassociates.com

300 E. Milwaukee Avenue – Detroit, Michigan

Industrial For Sale

9,000
Square Feet
AVAILABLE

Aerial



For more information, please contact:

CHRIS MONSOUR
(248) 948 0107
cmonsour@signatureassociates.com

STEVE GORDON
(248) 948 0101
sgordon@signatureassociates.com

SIGNATURE ASSOCIATES
One Towne Square, Suite 1200
Southfield, MI 48076
www.signatureassociates.com