

DRONE VIDEO

FOR LEASE

# Parktowne Village

1600 East Woodlawn Road  
Charlotte, NC 28209



1111 Metropolitan Avenue,  
Suite 700  
Charlotte, NC 28204

**Contact:** George Cornelson  
direct: 704.975.4652  
gcornelson4@gmail.com

The information contained herein has been obtained by sources we deem reliable. We have no reason to doubt its accuracy, but we do not guarantee it. All information should be verified prior to purchase or lease.



# Parktowne Village

## Property Overview

### PROPERTY FEATURES

- Available Spaces:  
SF, 2,200 SF and 2,336 SF (2nd Generation Kitchen)
- ParkTowne Village is located at the heavily-trafficked intersection of Woodlawn Road and Park Road in Charlotte, NC. This ±101,802 SF Specialty Center is located across from Charlotte's oldest shopping center, Park Road Shopping Center.
- Tenants include: Easy Like Sunday, Bon Chon, Total Wine, Starbucks, Jason's Deli, Charlotte Yoga, Project Lean Nation, The Joint Chiropractic, Smoothie King, Palm Beach Tan, Jon Ric Med Spa, The Local Scoop, Anjou, Verizon, Sports Clips, Calico, Massage Envy and more!

### DEMOGRAPHICS (2025)

	1 mile	3 miles	5 miles
Population	14,474	114,535	290,675
Projected Pop.	14,813	120,074	310,246
Daytime Pop.	9,616	110,785	229,819
Avg. HH Income	\$188,177	\$208,034	\$167,039

### TRAFFIC COUNTS (2023)

East Woodlawn Rd	27,546 VPD
Park Road	29,191 VPD

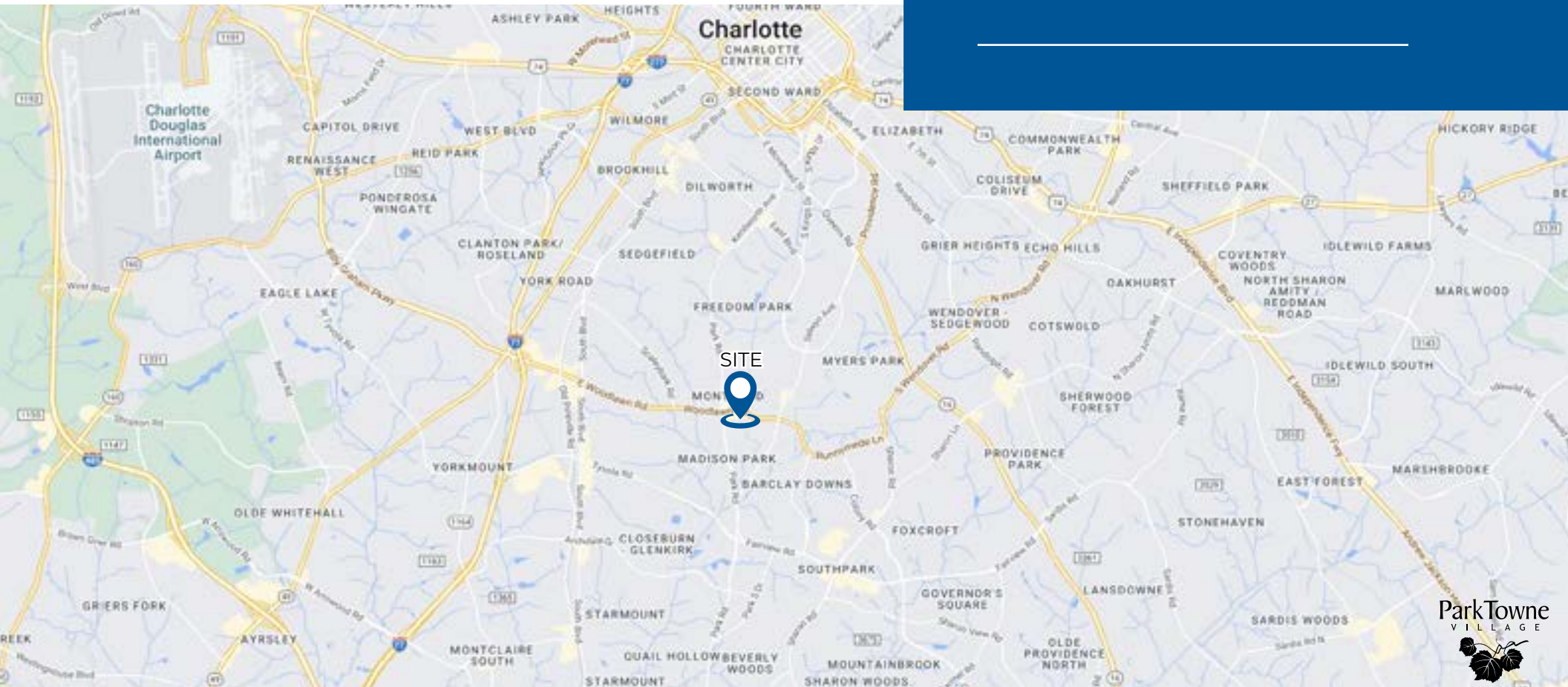



# Parktowne Village

## Property Overview





P  
A  
R  
K  
R  
D

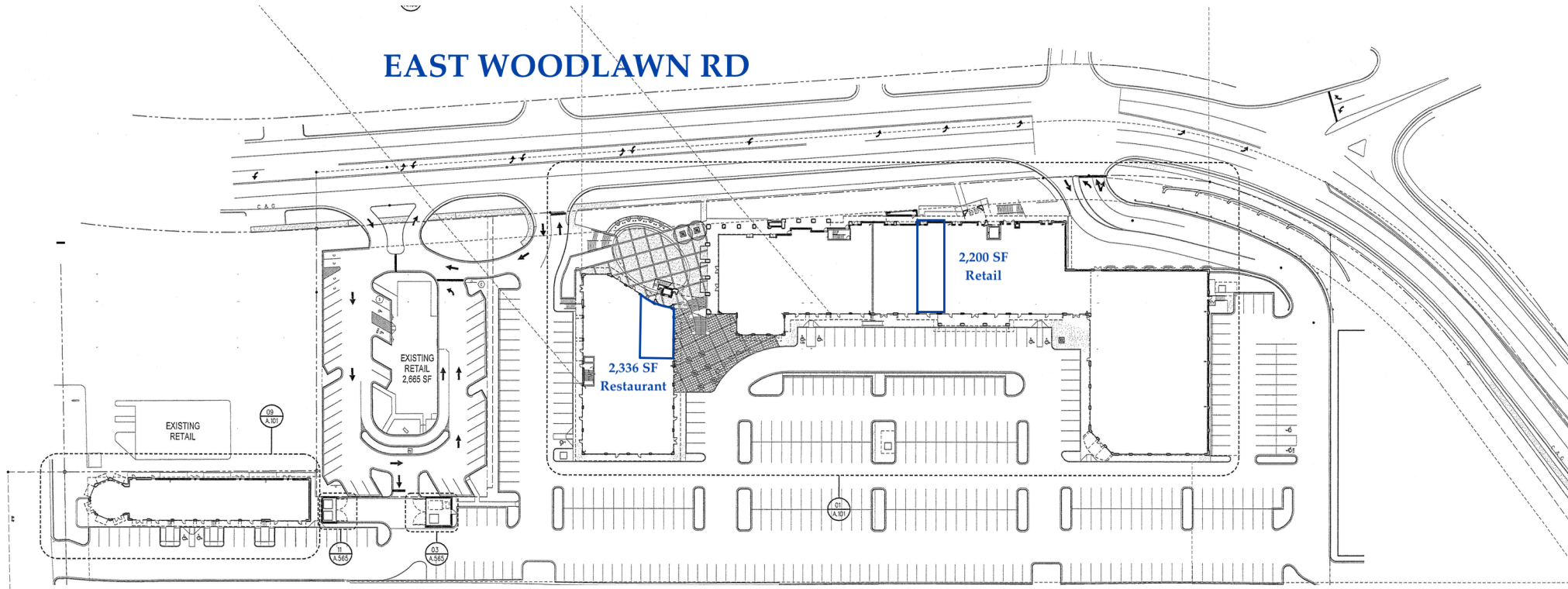

### FEATURED TENANTS

Total Wine & More | Calico | Jason's Deli | The Crust Pizza | Massage Envy | Palm Beach Tan |  
Bon Chon | Starbucks | Charlotte Yoga | Verizon Wireless | Fitness Together | Yame Noodle | The  
Joint | The Local Scoop | Nalan | Anju | Sports Clips | Kumon | Topsail | Benchmark PT