

**185 Chemin Old Chelsea**

**Apartments For Rent – Appartements à Louer**

**Available September 2024 – Disponible Septembre 2024**

**For more information please contact:**

**Michelle Deriger**

**Email: [info@inharmony-dev.com](mailto:info@inharmony-dev.com)**

**Phone: 438-466-5980**

# Project Elevations - Élévations du Projet



# Site Plan - Plan de Site

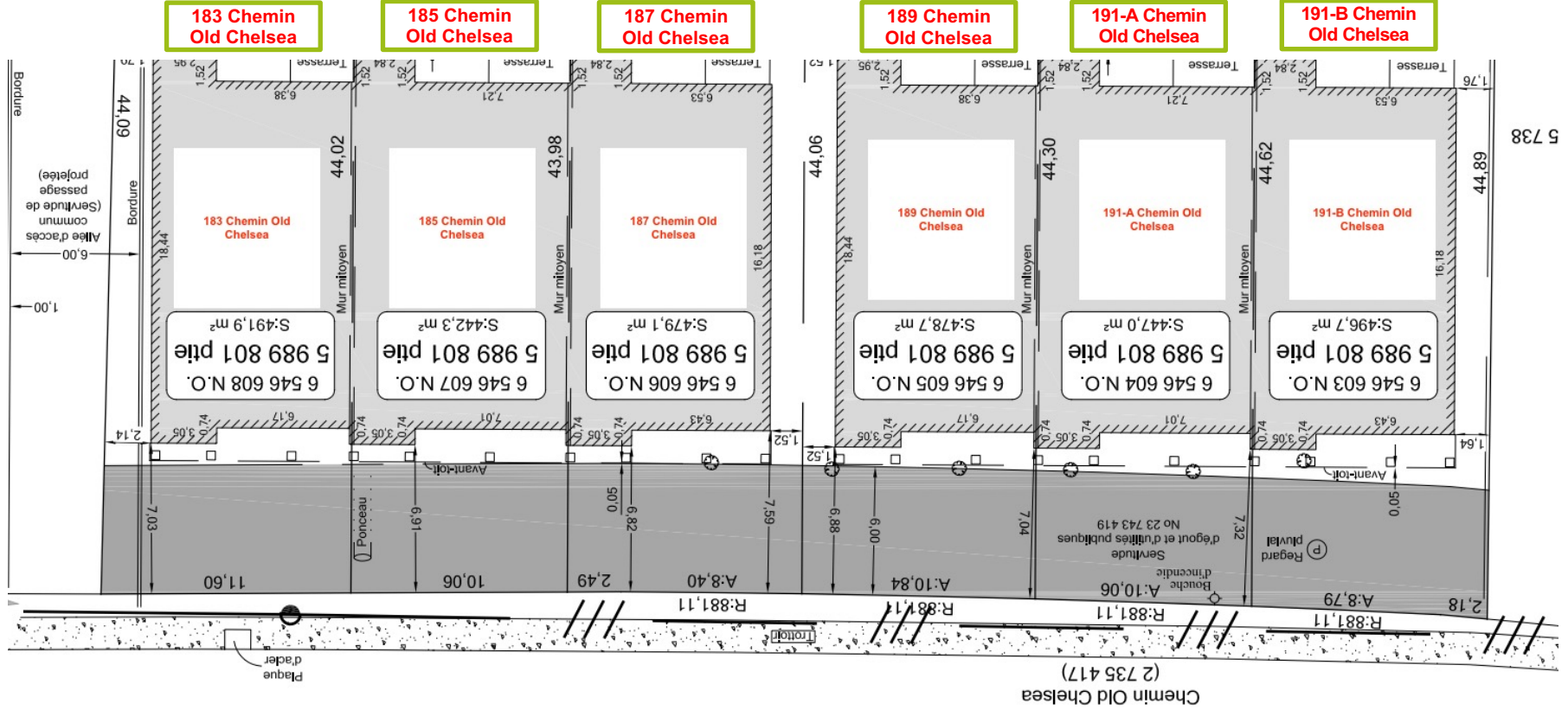

# Suites Ground Floor – Suites Rez-de-chaussée

## Reduced Mobility – Mobilité Réduite

189 Ch Old Chelsea – Unit 102/Unité 102

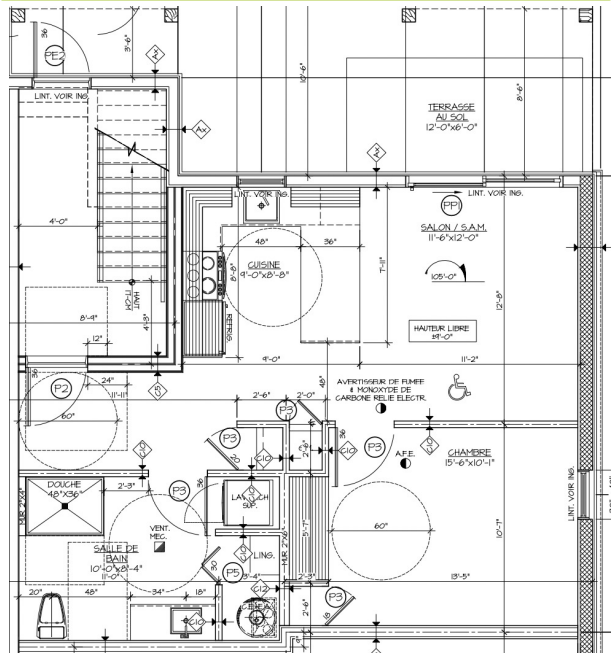

191-A Ch Old Chelsea – Unit 102/Unité 102

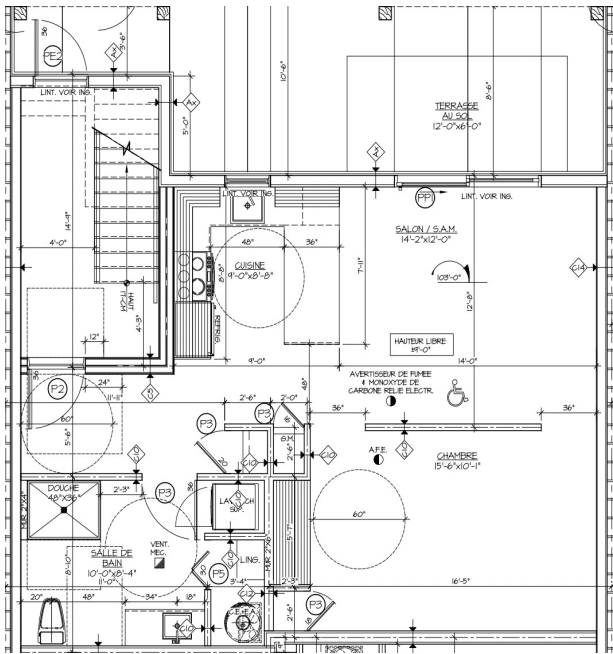

191-B Ch Old Chelsea – Unit 102/Unité 102

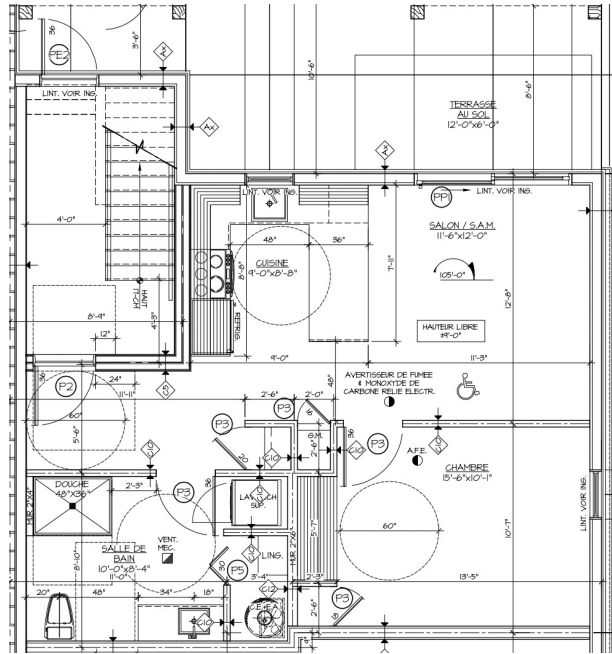

# Second Floor – Deuxième Étage

## North Facing – Exposition Nord

189 Ch Old Chelsea - Unit 103/Unité 103

191-A Ch Old Chelsea - Unit 103/Unité 103

191-B Ch Old Chelsea - Unit 103/Unité 103

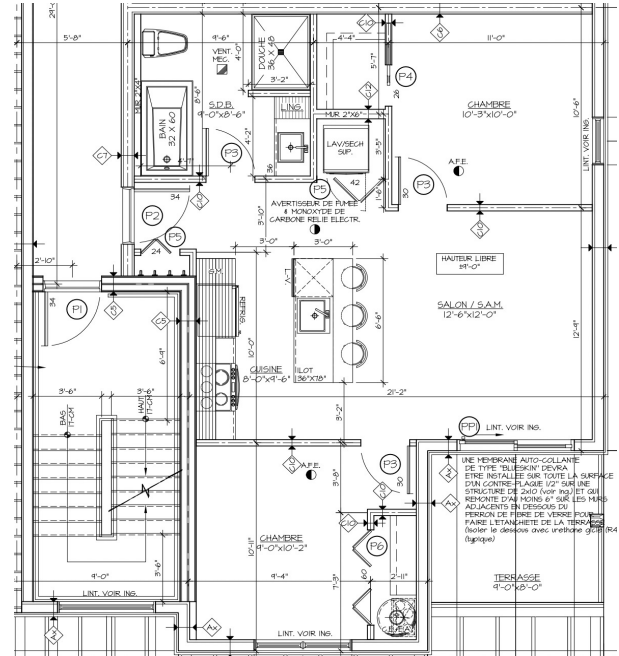
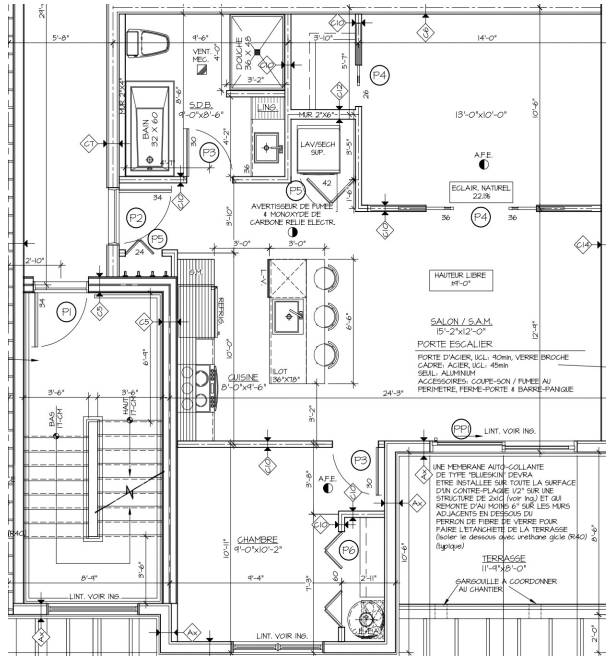
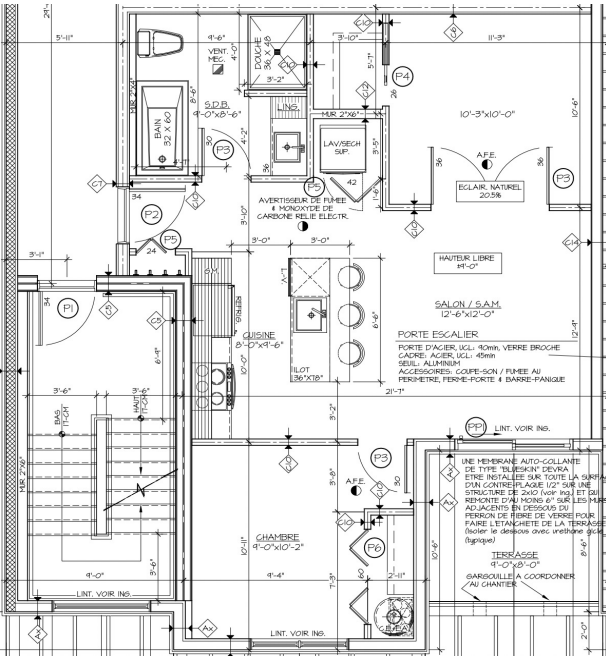

# Second Floor – Deuxième Étage

## South Facing – Exposition Sud

189 Ch Old Chelsea - Unit 104/Unité 104

191-A Ch Old Chelsea - Unit 104/Unité 104

191-B Ch Old Chelsea - Unit 104/Unité 104

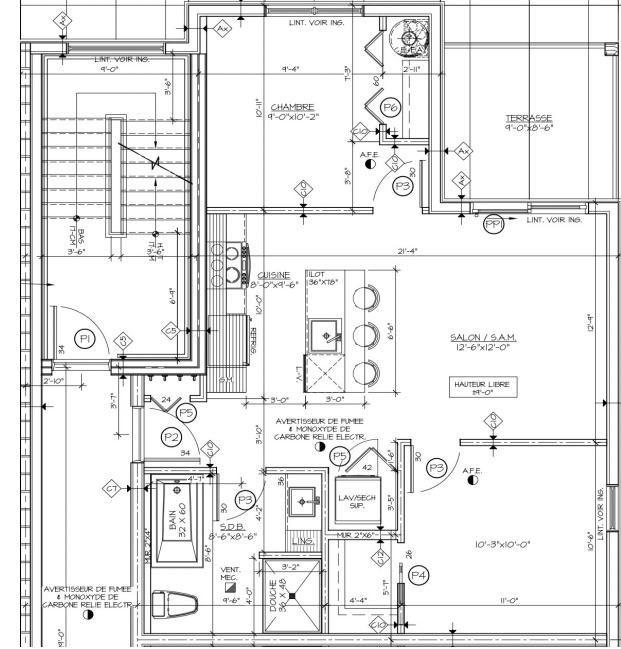
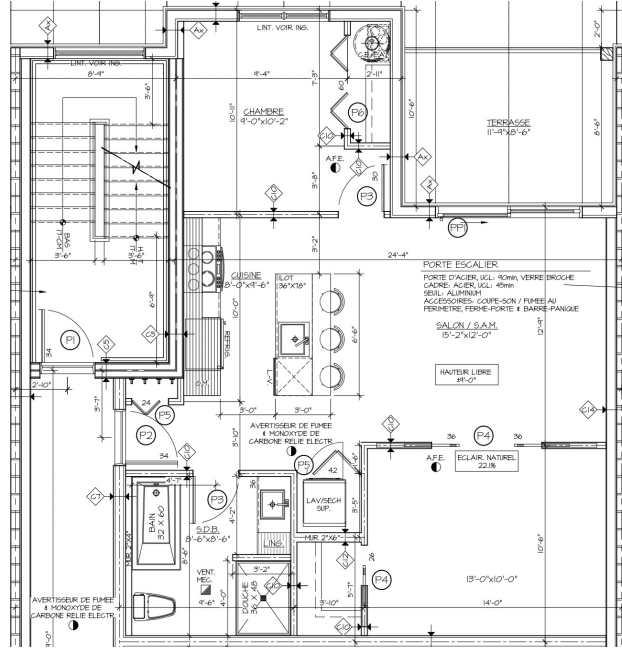
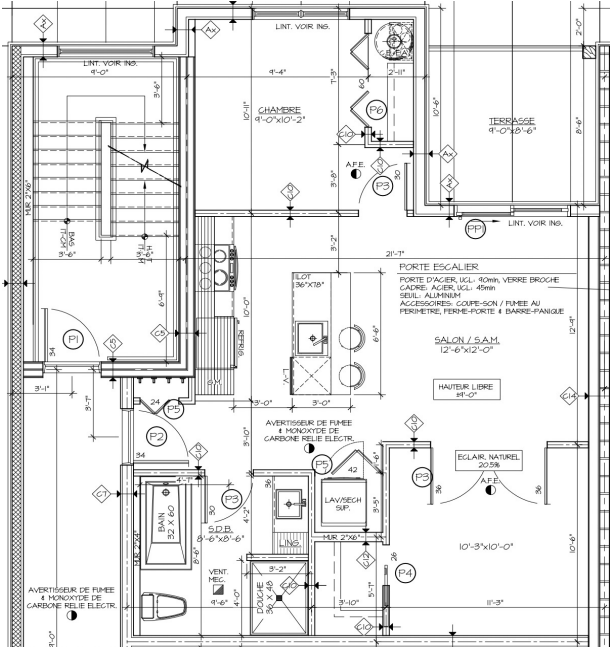

# Third Floor – Troisième Étage

## North Facing – Exposition Nord

189 Ch Old Chelsea - Unit 105/Unité 105

191-A Ch Old Chelsea - Unit 105/Unité 105

191-B Ch Old Chelsea - Unit 105/Unité 105

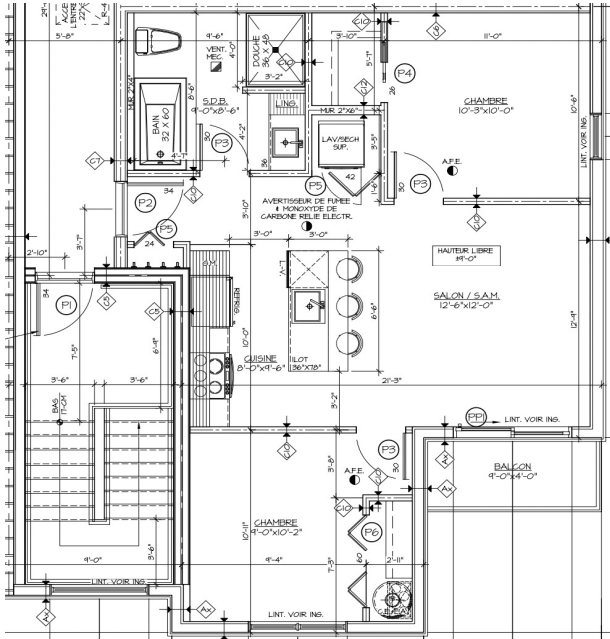
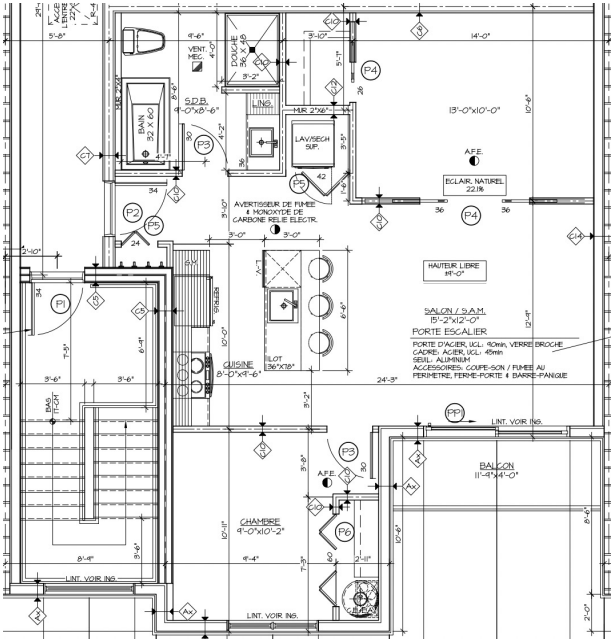
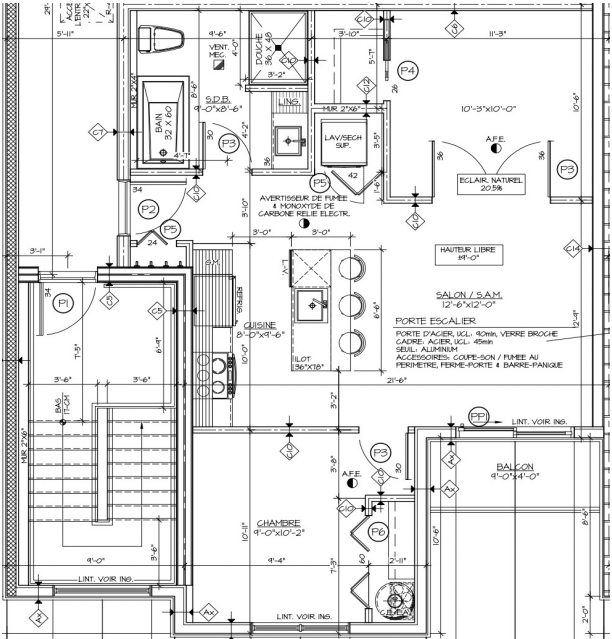





**For more information please contact:**

**Michelle Deriger**

**Email: [info@inharmony-dev.com](mailto:info@inharmony-dev.com)**

**Phone: 438-466-5980**

**[Inharmonydevelopments.com](http://Inharmonydevelopments.com)**