

AVAILABLE FOR LEASE
4N274 84TH COURT
HANOVER PARK, IL 60133



BUILDING SPECIFICATIONS:

BUILDING SIZE: 12,000 SF

AVAILABLE:

- 5,000 SF
- 3,800 SF warehouse
- 1,200 SF office

SITE SIZE: 1.0 acre

CLEAR HEIGHT: 16'

LOADING:

- 1 exterior dock
- 1 drive-in door (12' x 12')

BUILT: 2002

PARKING: 12 cars

POWER: 200 amps @ 120/240 volts

UTILITIES: Tenant responsibility

POSSESSION: Immediate occupancy

LEASE RATE: \$5,000 / Month Modified Gross

COMMENTS:

- › Renovated offices
- › Efficient warehouse layout
- › Close proximity to I-355 and I-390

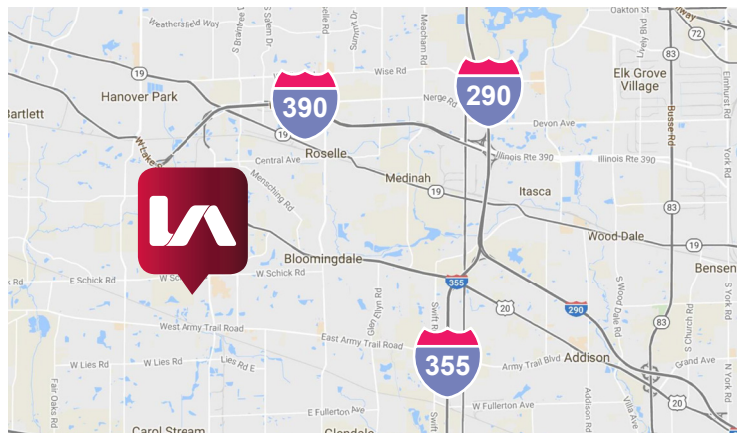

Rick Anesi
Senior Vice President
ranesi@lee-associates.com
D 773.355.3043

Brad Simousek
Senior Vice President
bsimousek@lee-associates.com
D 773.355.3016

All information furnished regarding property for sale, rental or financing is from sources deemed reliable, but no warranty or representation is made to the accuracy thereof and same is submitted to errors, omissions, change of price, rental or other conditions prior to sale, lease or financing or withdrawal without notice. No liability of any kind is to be imposed on the broker herein.

AVAILABLE FOR LEASE
4N274 84TH COURT
HANOVER PARK, IL 60133

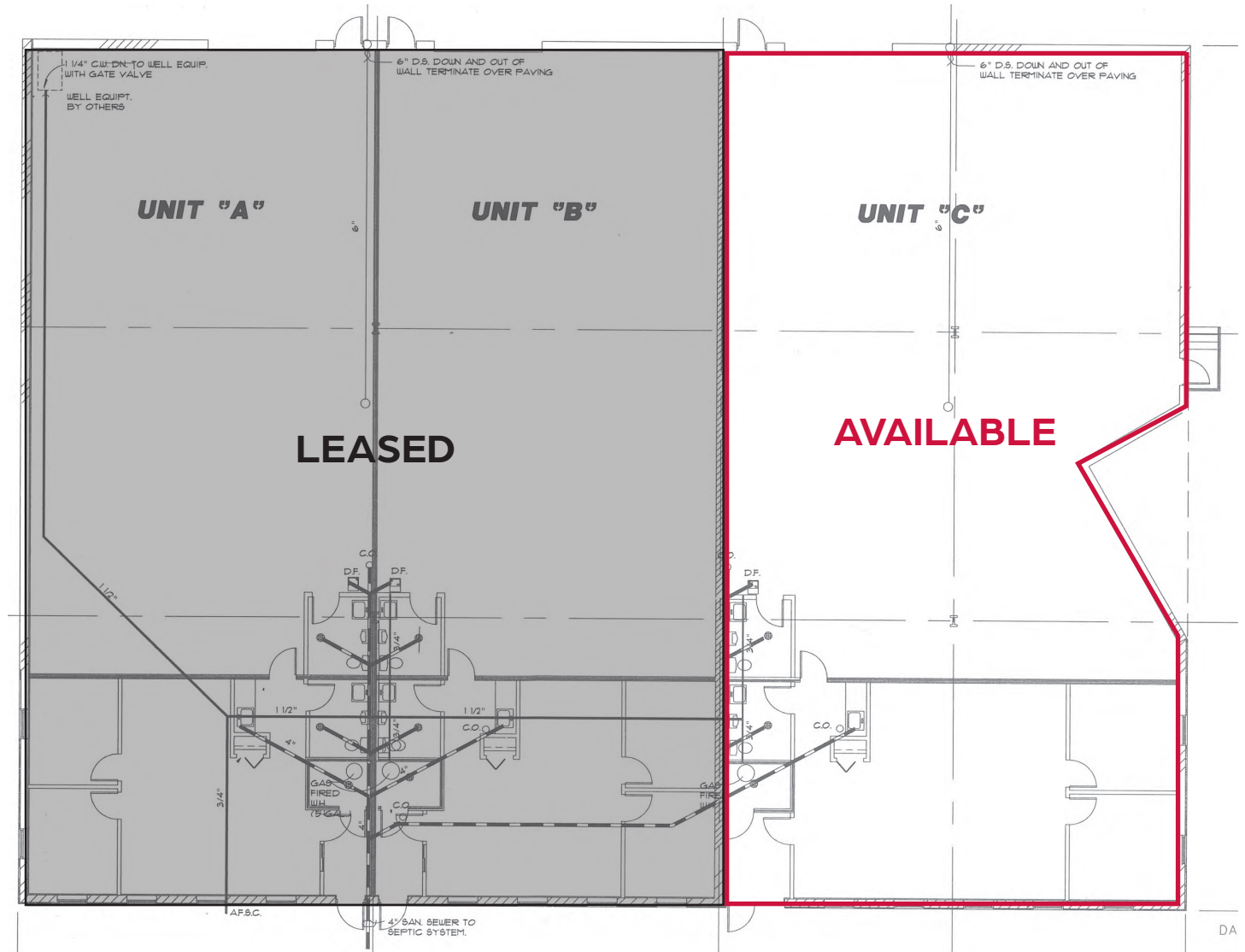

Rick Anesi
Senior Vice President
ranesi@lee-associates.com
D 773.355.3043

Brad Simousek
Senior Vice President
bsimousek@lee-associates.com
D 773.355.3016

All information furnished regarding property for sale, rental or financing is from sources deemed reliable, but no warranty or representation is made to the accuracy thereof and same is submitted to errors, omissions, change of price, rental or other conditions prior to sale, lease or financing or withdrawal without notice. No liability of any kind is to be imposed on the broker herein.