

55,000 SF  
AVAILABLE

SARASOTA MOB  
CURRY LANE



- A proposed Class A multi-specialty Medical Office Building
- Off- Hospital campus location
- Adjacent to the new Sarasota Memorial Hospital in Venice FL
- Traffic count 8,000+ cars a day
- Significant increased residential growth
- Great location for practices expanding

Conceptual Rendering

### BUILDING SPECIFICATIONS

Total Proposed Building Area	55,000 SF
Total Available Space	TBA
Breaking Ground	2025

LIZ COOK  
d. 443-517-3962  
liz.cook@FlagshipHP.com

2202 N. Westshore Blvd, Suite 200 | Tampa, Florida 33607  
D. 443-517-3962 | www.FlagshipHP.com

©2024 The information contained herein was obtained from sources believed reliable; however, Flagship Healthcare Properties makes no guarantees, warranties, or representations as to the completeness or accuracy thereof. The presentation of this property is submitted subject to errors, omissions, changes of price or conditions prior to sale or lease, or withdrawal without notice.





**Sarasota Memorial Hospital - Venice**

**SITE**



36,856 Households



\$119,670 Average Household Income

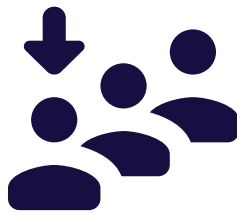

Population of 71,978



\$61,270 Per Capita

©2024 The information contained herein was obtained from sources believed reliable; however, Flagship Healthcare Properties makes no guarantees, warranties, or representations as to the completeness or accuracy thereof. The presentation of this property is submitted subject to errors, omissions, changes of price or conditions prior to sale or lease, or withdrawal without notice.



# Sarasota - Venice Medical Office Building

Curry Lane



## Surrounding Residential Data

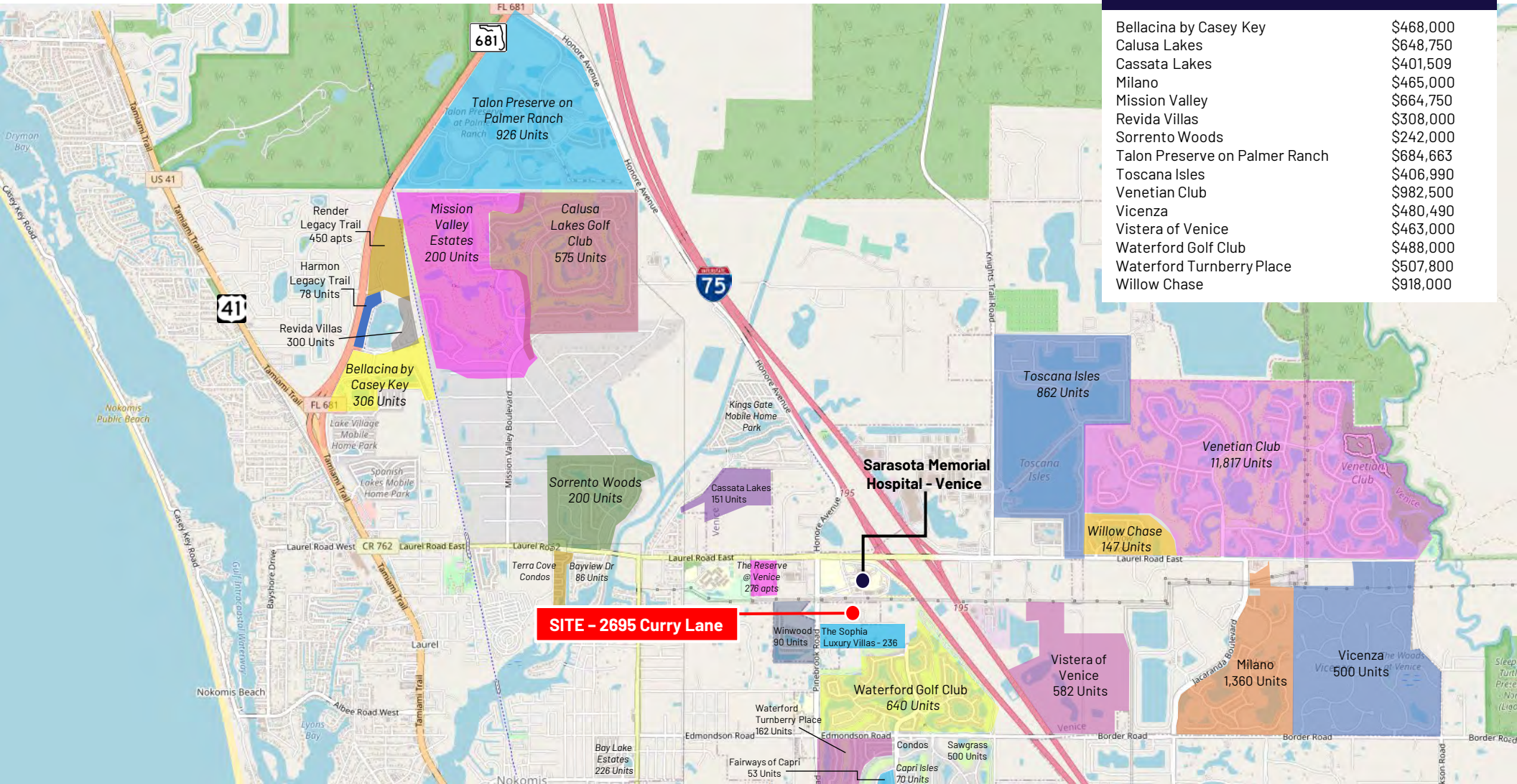

RESIDENTIAL SUBDIVISION	AVERAGE HOME PRICE
Bellacina by Casey Key	\$468,000
Calusa Lakes	\$648,750
Cassata Lakes	\$401,509
Milano	\$465,000
Mission Valley	\$664,750
Revida Villas	\$308,000
Sorrento Woods	\$242,000
Talon Preserve on Palmer Ranch	\$684,663
Toscana Isles	\$406,990
Venetian Club	\$982,500
Vicenza	\$480,490
Visterra of Venice	\$463,000
Waterford Golf Club	\$488,000
Waterford Turnberry Place	\$507,800
Willow Chase	\$918,000

Liz Cook, Vice President Leasing & Brokerage

[liz.cook@FlagshipHP.com](mailto:liz.cook@FlagshipHP.com)

2202 N Westshore Blvd, Suite 200 Tampa FL 33607

Mobile - 443.517.3962

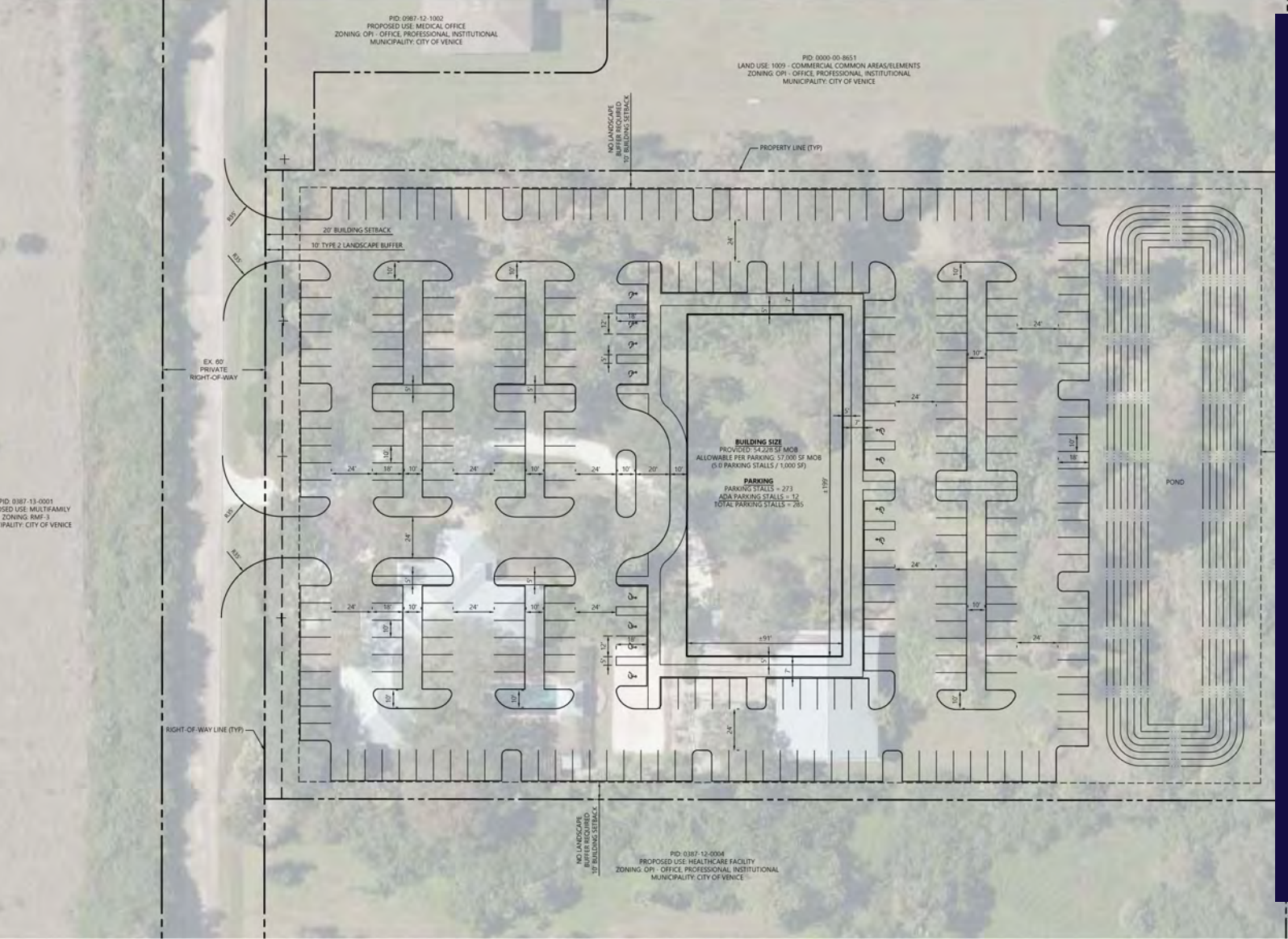

## Illustrative Concept Plan

LIZ COOK  
 d. 443-517-3962  
 liz.cook@FlagshipHP.com

2202 N. Westshore Blvd, Suite 200 | Tampa, Florida 33607  
 D. 443-517-3962 | www.FlagshipHP.com

©2024 The information contained herein was obtained from sources believed reliable; however, Flagship Healthcare Properties makes no guarantees, warranties, or representations as to the completeness or accuracy thereof. The presentation of this property is submitted subject to errors, omissions, changes of price or conditions prior to sale or lease, or withdrawal without notice.

