



S.L. NUSBAUM  
REALTY CO.

# FOR LEASE

## GREAT NECK VILLAGE



1200-1362 N GREAT NECK RD.  
VIRGINIA BEACH, VA 23454

**CHRIS HUCKE**  
SENIOR VICE PRESIDENT  
O. 757.640.2205  
CHUCKE@SLNUSBAUM.COM

**BRODY TUCKER**  
ASSOCIATE  
O. 757.640.2235  
BTUCKER@SLNUSBAUM.COM





**S.L. NUSBAUM**  
REALTY CO.

# PROPERTY SUMMARY

1200-1362 N GREAT NECK RD.  
VIRGINIA BEACH, VA 23454



## PROPERTY DESCRIPTION

Anchored by Food Lion and Dollar Tree. Great mix of Tenants. Convenient ingress and egress offered at the main entrance and from Mill Dam Road.

SPACES	LEASE RATE	SPACE SIZE
Unit 18	Contact Agent	3,000 SF
Outparcel B	Contact Agent	0.5 Acres

DEMOGRAPHICS	1 MILE	3 MILES	5 MILES
Total Households	3,459	23,861	56,893
Total Population	8,900	58,238	135,510
Average HH Income	\$90,645	\$92,280	\$86,851

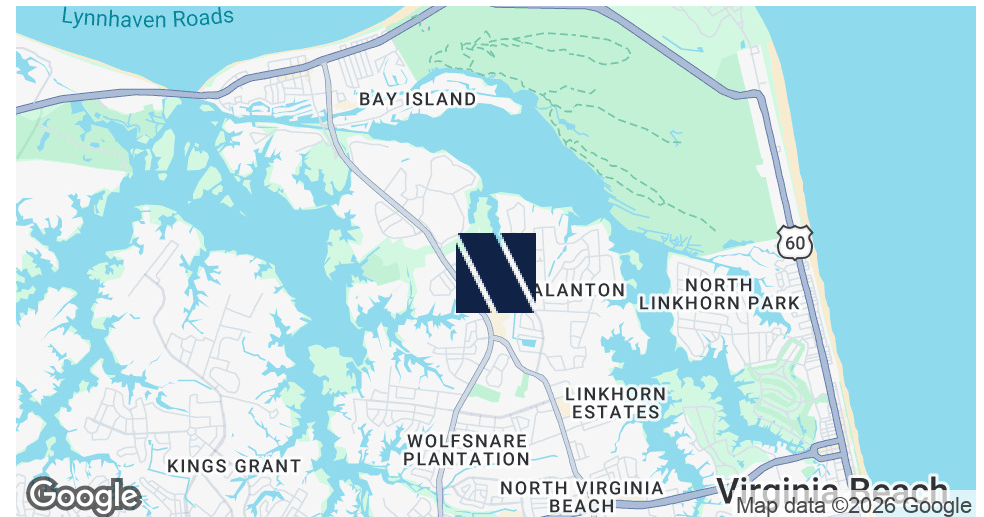

**CHRIS HUCKE**  
SENIOR VICE PRESIDENT  
O. 757.640.2205  
CHUCKE@SLNUSBAUM.COM

**BRODY TUCKER**  
ASSOCIATE  
O. 757.640.2235  
BTUCKER@SLNUSBAUM.COM

**PROUD PARTNER**  
**XTEAM**  
RETAIL ADVISORS



S.L. NUSBAUM  
REALTY CO.

# SITE PLAN

1200-1362 N GREAT NECK RD.  
VIRGINIA BEACH, VA 23454

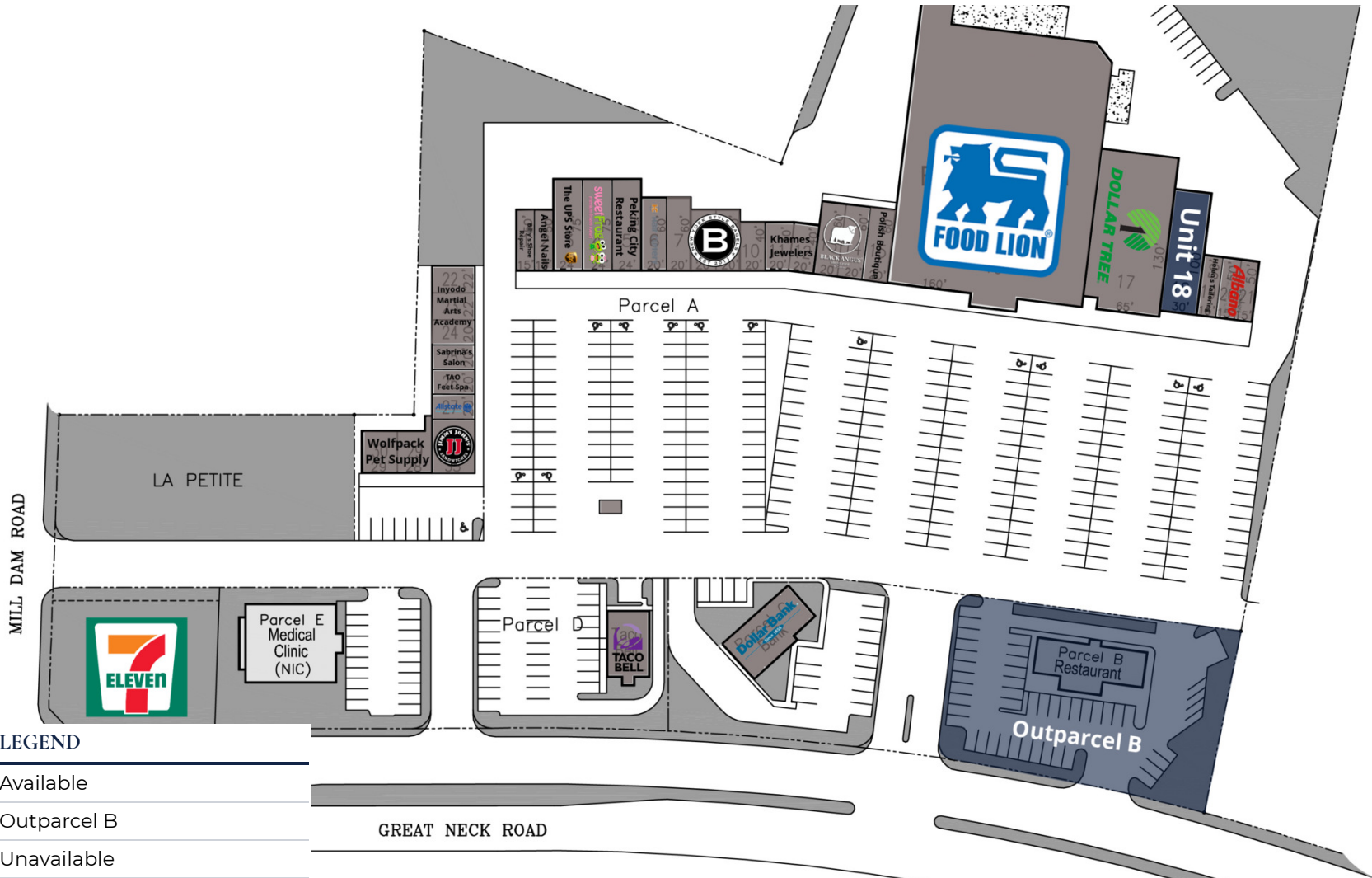

## LEGEND

- Available
- Outparcel B
- Unavailable

**CHRIS HUCKE**  
SENIOR VICE PRESIDENT  
O. 757.640.2205  
CHUCKE@SLNUSBAUM.COM

**BRODY TUCKER**  
ASSOCIATE  
O. 757.640.2235  
BTUCKER@SLNUSBAUM.COM





S.L. NUSBAUM  
REALTY CO.

# VACANCY OVERVIEW

1200-1362 N GREAT NECK RD.  
VIRGINIA BEACH, VA 23454

## LEASE INFORMATION

Lease Type: NNN; Gross  
Total Space: 3,000 - 21,780 SF

Lease Term: Negotiable  
Lease Rate: Contact Agent

## AVAILABLE SPACES

SUITE	TENANT	SIZE	TYPE
■ Unit 18	Available	3,000 SF	NNN
■ Outparcel B	Outparcel B	0.5 Acres	Gross

**CHRIS HUCKE**  
SENIOR VICE PRESIDENT  
O. 757.640.2205  
CHUCKE@SLNUSBAUM.COM

**BRODY TUCKER**  
ASSOCIATE  
O. 757.640.2235  
BTUCKER@SLNUSBAUM.COM





S.L. NUSBAUM  
REALTY CO.

# AREA RETAIL

1200-1362 N GREAT NECK RD.  
VIRGINIA BEACH, VA 23454



**CHRIS HUCKE**  
SENIOR VICE PRESIDENT  
O. 757.640.2205  
CHUCKE@SLNUSBAUM.COM

**BRODY TUCKER**  
ASSOCIATE  
O. 757.640.2235  
BTUCKER@SLNUSBAUM.COM





S.L. NUSBAUM  
REALTY CO.

# ADDITIONAL PHOTOS

1200-1362 N GREAT NECK RD.  
VIRGINIA BEACH, VA 23454



**CHRIS HUCKE**  
SENIOR VICE PRESIDENT  
O. 757.640.2205  
CHUCKE@SLNUSBAUM.COM

**BRODY TUCKER**  
ASSOCIATE  
O. 757.640.2235  
BTUCKER@SLNUSBAUM.COM





S.L. NUSBAUM  
REALTY CO.

# DEMOGRAPHICS MAP & REPORT

1200-1362 N GREAT NECK RD.  
VIRGINIA BEACH, VA 23454

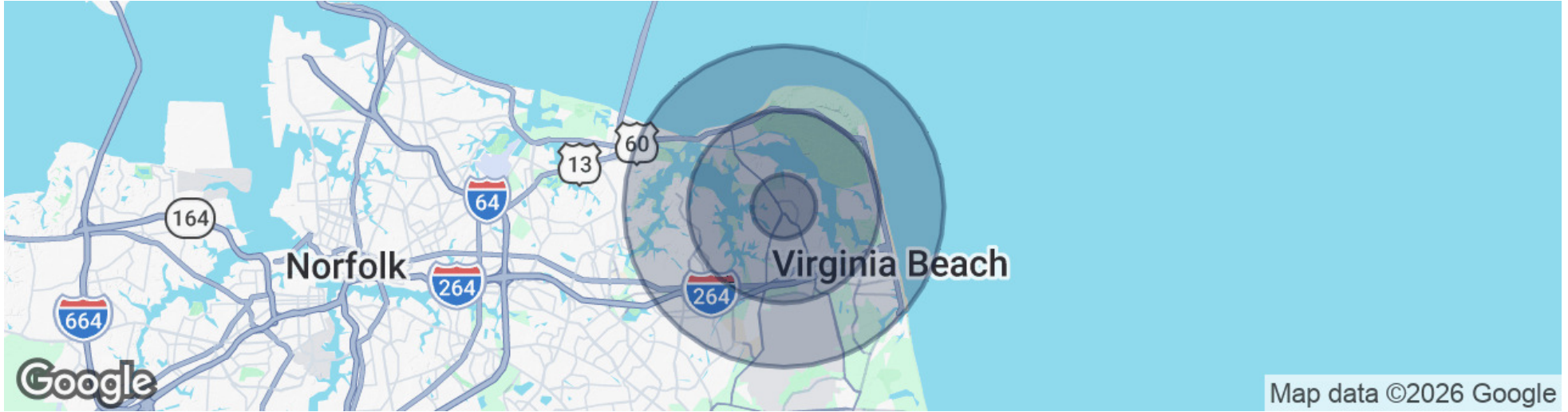

POPULATION	1 MILE	3 MILES	5 MILES
Total Population	8,900	58,238	135,510
Average Age	39.0	38.4	38.3
Average Age (Male)	37.3	37.7	37.0
Average Age (Female)	39.3	38.9	39.3
HOUSEHOLDS & INCOME	1 MILE	3 MILES	5 MILES
Total Households	3,459	23,861	56,893
# Of Persons Per HH	2.6	2.4	2.4
Average HH Income	\$90,645	\$92,280	\$86,851
Average House Value	\$407,070	\$475,939	\$450,156

\* Demographic data derived from 2020 ACS - US Census

**CHRIS HUCKE**  
SENIOR VICE PRESIDENT  
O. 757.640.2205  
CHUCKE@SLNUSBAUM.COM

**BRODY TUCKER**  
ASSOCIATE  
O. 757.640.2235  
BTUCKER@SLNUSBAUM.COM



# CONTACT US



S.L. NUSBAUM  
REALTY CO.



**CHRIS HUCKE**  
SENIOR VICE PRESIDENT  
O. 757.640.2205  
CHUCKE@SLNUSBAUM.COM



**BRODY TUCKER**  
ASSOCIATE  
O. 757.640.2235  
BTUCKER@SLNUSBAUM.COM

**S.L. NUSBAUM REALTY CO.**  
440 MONTICELLO AVENUE, SUITE 1700, NORFOLK, VA 23510  
757.627.8611  
SLNUSBAUM.COM

PROUD PARTNER  
**XTEAM**  
RETAIL ADVISORS

**DISCLAIMER:**  
No warranty or representation, expressed or implied, is made to the accuracy or completeness of the information contained herein, and same is submitted subject to errors, omissions, change of price, rental or other conditions, withdrawal without notice, and to any special listing conditions imposed by the property owner(s). As applicable, we make no representation as to the condition of the property (or properties) in question or the property's (or properties') compliance with applicable laws, regulations, and codes.