



# ONE FINANCIAL CENTER SUBLEASE

- ▶ Tour 12th Floor
- ▶ Tour 14th Floor



12TH FLOOR  
**28,468 SF AVAILABLE**

OR

12-14TH FLOORS  
**85,404 SF AVAILABLE**



# HIGHLIGHTS

- Term through 12/31/28
- Open & Flexible Space
- Furniture Available
- Views of Boston Harbor and Rose Kennedy Greenway
- LEED-Certified Gold Tower
- Easy access to South Station (Red and Silver Lines) and easy vehicular access
- Refreshed lobby and new amenity center along with state-of-the-art fitness center
- Building now offers café, market, showers, Starbucks, Bright Horizons, Conference facility, tenant lounge, and expanded bicycle parking

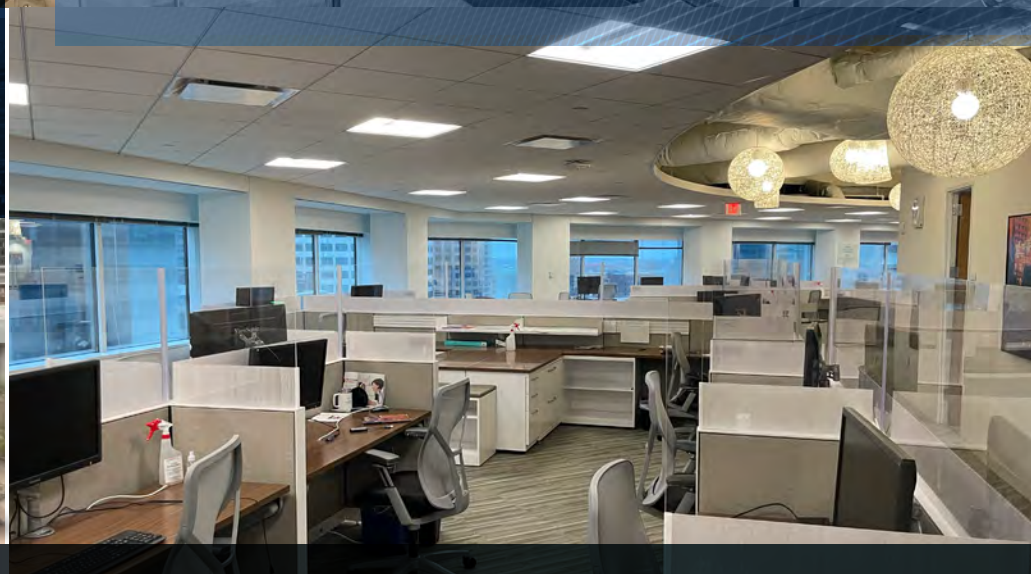



# FLOOR PLAN

## Floor 12

- Reception
- Large Kitchen / Lounge
- Pantry/Kitchen
- Restrooms
- 11 Conference Rooms
- Collaboration Areas
- 8 Private Offices
- Wellness Room
- 130 Desks
- Phone Room
- 2 Copy Rooms

- Conference Rooms/Meeting Room
- Private Office
- Restroom
- Open Area/Desks
- Pantry / Small Kitchen
- Large Kitchen/Lounge
- Copy Rooms

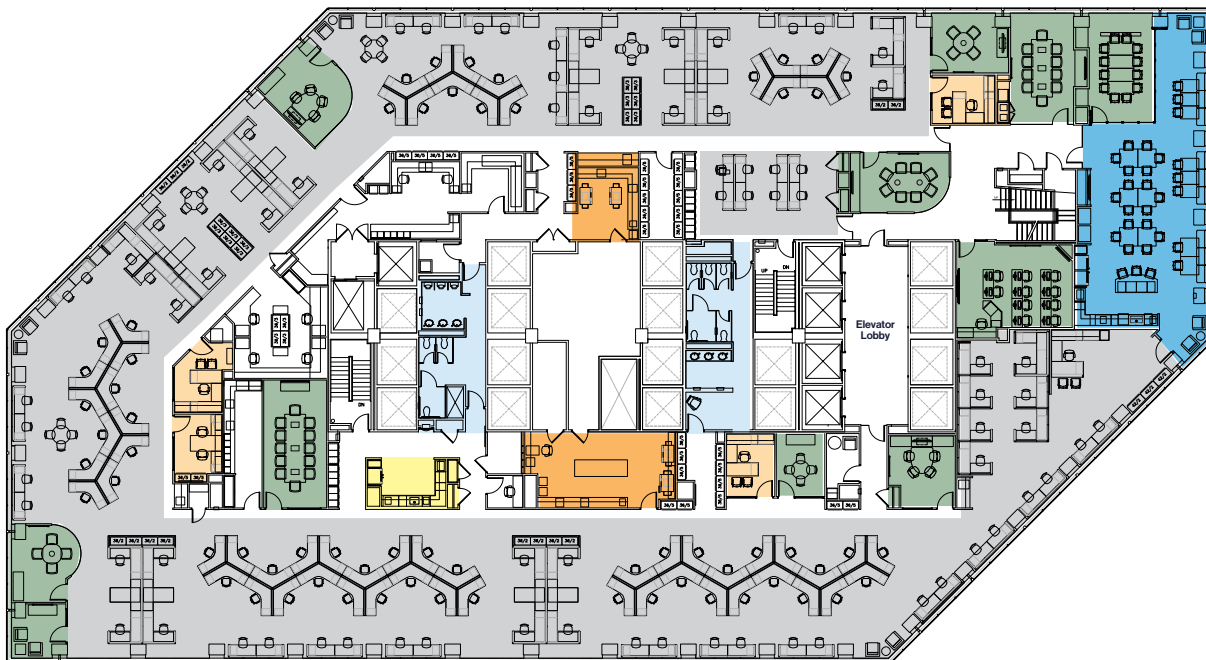

▶ Tour Space

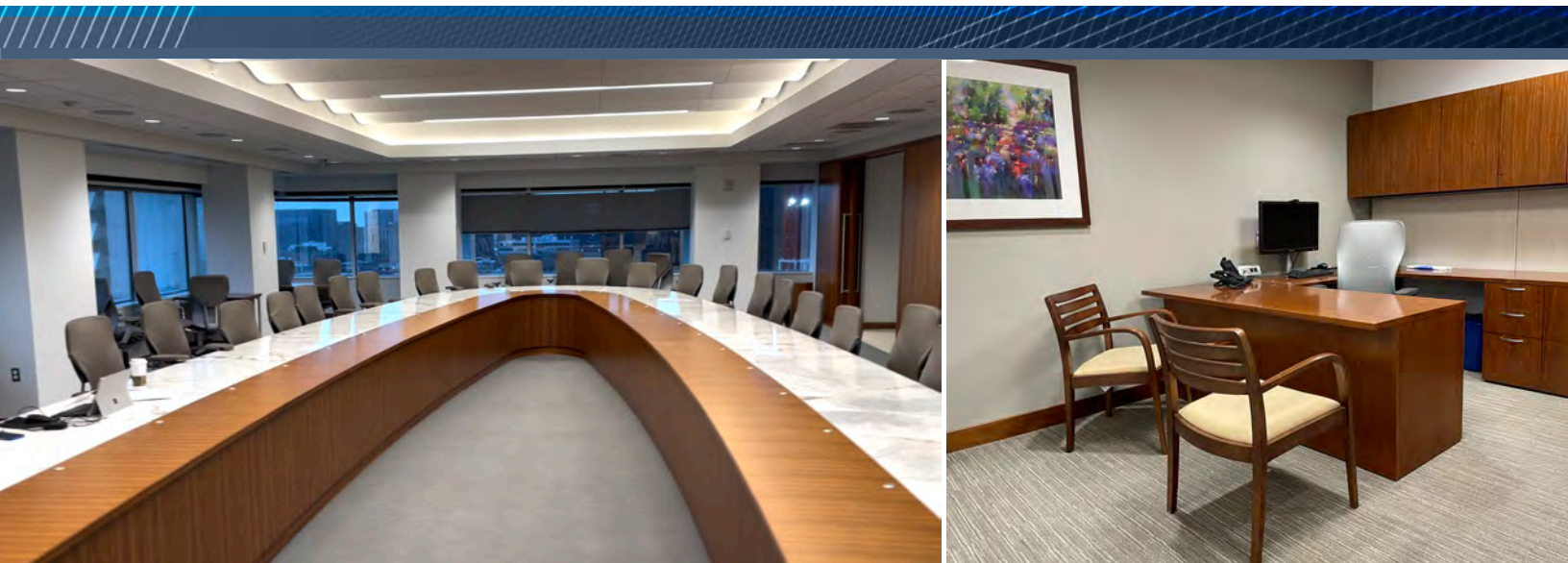

# FLOOR PLANS

## Floor 13

- Reception
- 78 Desks
- Wellness Room
- Pantry/Kitchen
- 4 Copy Rooms
- Phone Room
- 13 Conference Rooms
- Restrooms
- 11 Private Offices
- Collaboration Areas

- Conference Rooms/Meeting Room
- Private Office
- Restroom
- Open Area/Desks
- Pantry / Small Kitchen
- Large Kitchen/Lounge
- Copy Rooms
- IT



## Floor 14

- Reception
- 94 Desks (15 additional cubes can be added)
- Collaboration Areas
- Pantry/Kitchen
- 3 Copy Rooms
- Wellness Room
- 7 Conference Rooms
- Men & Women Bathrooms with Showers
- Phone Room
- 4 Private Offices



# LOCATION OVERVIEW

One Financial Center is located directly across from the transportation hub, South Station, as well as the Rose Kennedy Greenway, a 1.5 mile outdoor landscaped walkway of art, gardens, fountains, beer garden, food trucks and events.

Walk Score

98/100  
*Walker's Paradise*



Transit Score

100/100  
*Rider's Paradise*

Bike Score

82/100  
*Very Bikable*

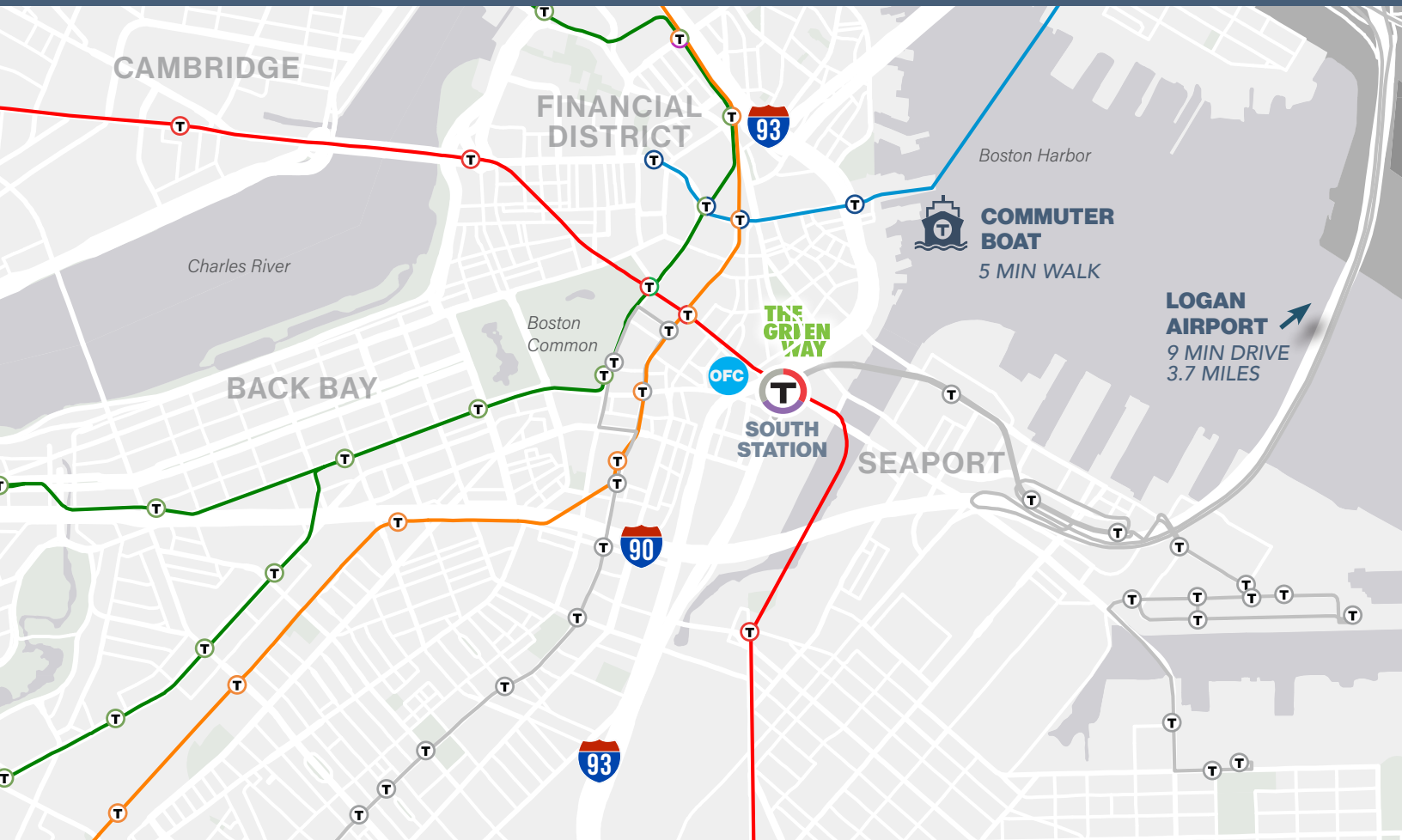

## CONTACT US

**Ellie Fantini Cullinan**  
EVP, Principal  
617.835.3323  
ecullinan@fpcpre.com

**Christopher Rogers**  
EVP, Principal  
617.974.6363  
crogers@fpcpre.com

[www.fpcpre.com](http://www.fpcpre.com)

265 Franklin Street, 16th Floor, Boston 02110



The information contained herein has been obtained through sources deemed reliable by Freudenheim Partners, but cannot be guaranteed for its accuracy. Any interested party should undertake their own inquiries as to the accuracy of the information. This publication is the copyrighted property of Freudenheim Partners and/or its licensor(s). © 2024. All rights reserved.