

301 PINNACLE ROAD, LAREDO, TX 78045

INDUSTRIAL WAREHOUSE FOR LEASE



FOR PROPERTY INFORMATION & SITE TOURS PLEASE CONTACT:

EDWARD VILLAREAL, SIOR
Managing Partner | Real Estate Broker
evillareal@stxcre.com
956.712.8022

SOUTH TEXAS COMMERCIAL
216 W Village Blvd, Ste 102
Laredo, TX 78401
www.stxcre.com

301 PINNACLE ROAD, LAREDO, TX 78045



LOCATION FEATURES

- Located in the Pinnacle Industrial Park, one of Laredo's largest and fastest growing industrial parks
- Conveniently accessed via FM 1472 (Mines Rd.)
- 5 miles north of the World Trade Bridge
- 13 miles south of the Laredo Columbia Solidarity Intl Bridge
- 5 miles to I-35
- Proximity to Hachar-Reuthenger Pkwy currently in development to offer direct access to I-35
- Offers prime advantages for seamless logistics in Laredo

IDEAL LOCATION

- Laredo's transportation network includes, 2 commercial bridges, 1 rail bridge and 3 vehicle bridges.
- The Port of Laredo, the nation's top-ranked port, facilitated \$320 billion in global trade in 2023, as per U.S. Census Bureau data analyzed by WorldCity.
- Annually, it accommodates approximately 5.5 million trucks (15,000 trucks per day) traveling north and south and supports a robust infrastructure.
- The Laredo market has 251 freight forwarders, 656 transportation companies, and 120 U.S. Customs Brokers.

Source: Laredo EDC

301 PINNACLE ROAD, LAREDO, TX 78045



PROPERTY SPECIFICATIONS

Total Building Size (SF):	120,691 SF
Expansion Potential:	+ 100,000 SF Up to 220,691 SF Total
Main Office (SF):	2,800 SF
Clear Height:	28'
Column Spacing (in speed bays):	60' x 52'
Column Spacing (interior bays):	50' x 52'
Auto Parking:	50 Spaces
Dock Doors:	35 Dock Doors
Dock Equipment:	Edge of dock levelers
Grade Level Access:	2 ramps
Warehouse Lighting:	LED
Trailer Parking Spaces:	58 Trailer Parks
Truck Court:	Fenced & secured
Building Construction Type:	Concrete tilt wall
Construction Age (Year):	2024
Fire Protection:	ESFR

301 PINNACLE ROAD, LAREDO, TX 78045

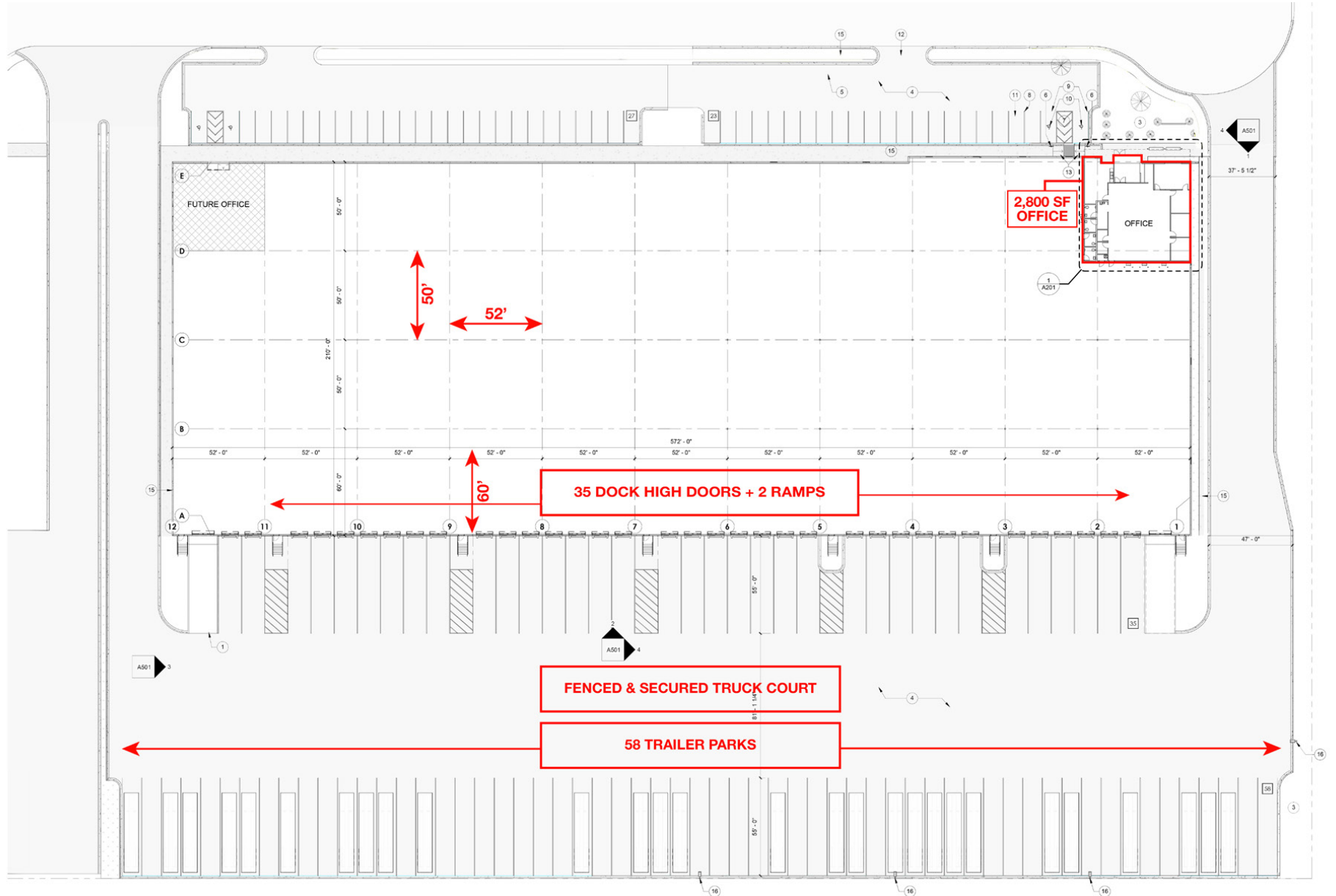

301 PINNACLE ROAD, LAREDO, TX 78045

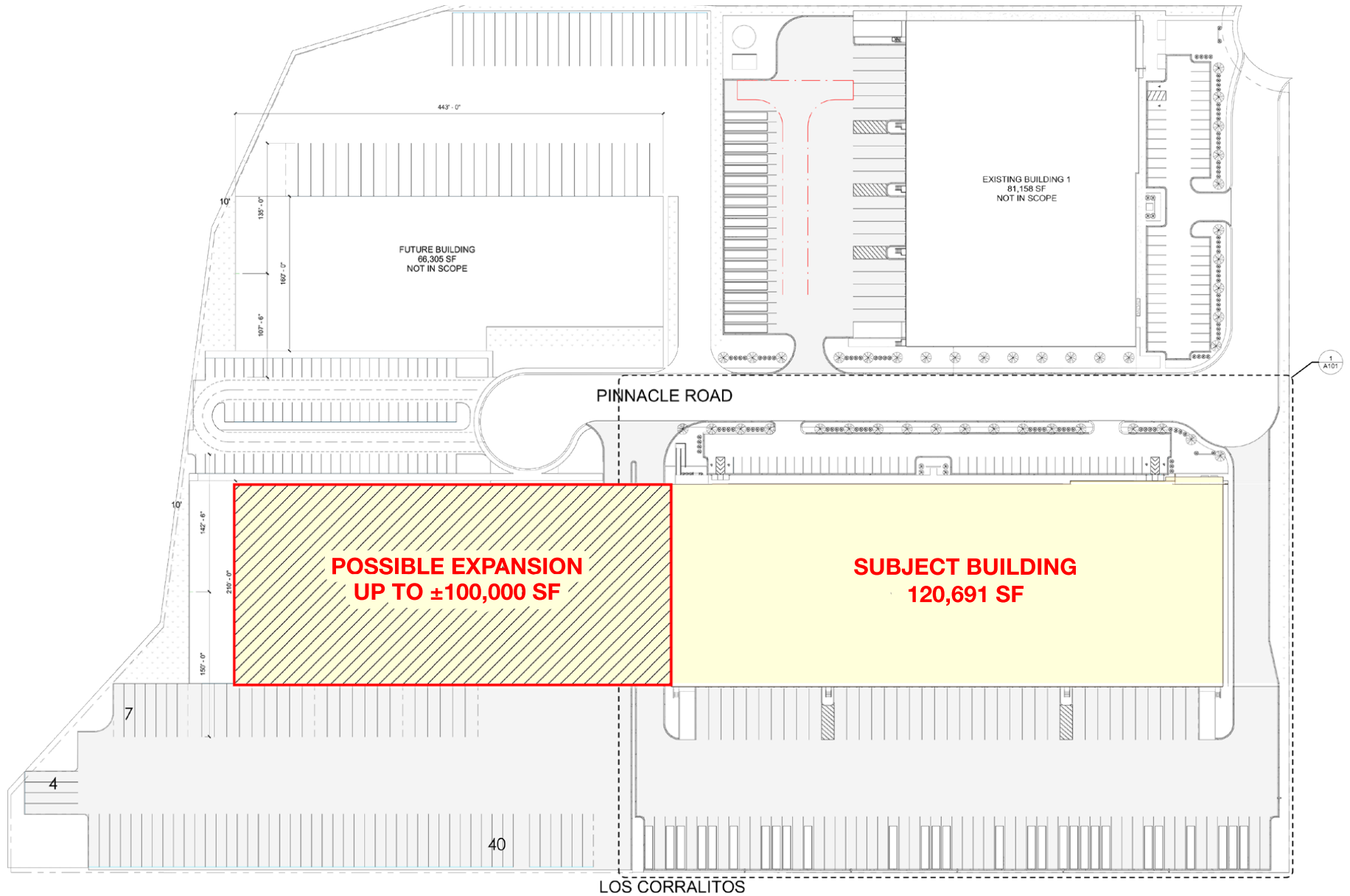

301 PINNACLE ROAD, LAREDO, TX 78045

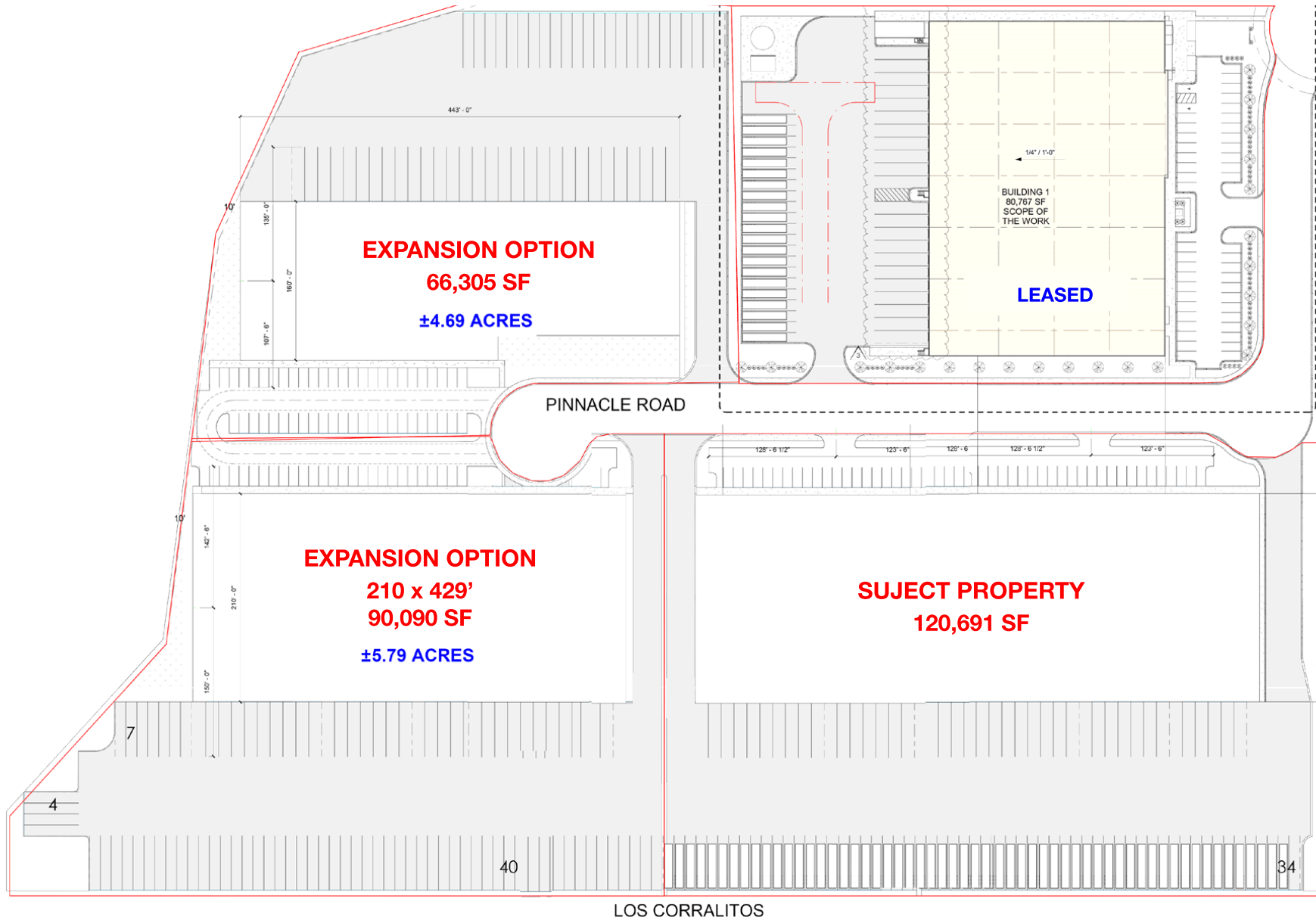

301 PINNACLE ROAD, LAREDO, TX 78045



301 PINNACLE ROAD, LAREDO, TX 78045

FOR INFORMATION & SITE TOURS CONTACT:

EDWARD VILLAREAL, SIOR

Managing Partner // Real Estate Broker
evillareal@stxcre.com

SOUTH TEXAS COMMERCIAL

216 W Village Blvd, Ste 102
Laredo, TX 78401
www.stxcre.com
956.712.8022



The information contained herein is proprietary and strictly confidential. It is intended to be reviewed only by the party receiving it from STXCRE, and should not be made available to any other person or entity without the written consent of the Brokerage. This Marketing Brochure has been prepared to provide summary, unverified information to prospective purchasers, and to establish only a preliminary level of interest in the subject property. The information contained herein is not a substitute for a thorough due diligence investigation. STXCRE has not made any investigation, and makes no warranty or representation, with respect to the income or expenses for the subject property, the future projected financial performance of the property, the size and square footage of the property and improvements, the presence or absence of contaminating substances, PCB's or asbestos, the compliance with State and Federal regulations, the physical condition of improvements thereon, or the financial condition or business prospects of any tenant, or any tenant's plans or intentions to continue occupancy of the subject property.

The information contained herein has been obtained from sources we believe to be reliable; however, STXCRE has not verified, and will not verify, any of the information contained herein, nor has the aforementioned Brokerage conducted any investigation regarding these matters and make no warranty or representation whatsoever regarding the accuracy or completeness of the information provided. All potential purchasers must take appropriate measures to verify all of the information set forth herein.



Information About Brokerage Services

Texas law requires all real estate license holders to give the following information about brokerage services to prospective buyers, tenants, sellers and landlords.

TYPES OF REAL ESTATE LICENSE HOLDERS:

- **A BROKER** is responsible for all brokerage activities, including acts performed by sales agents sponsored by the broker.
- **A SALES AGENT** must be sponsored by a broker and works with clients on behalf of the broker.

A BROKER’S MINIMUM DUTIES REQUIRED BY LAW (A client is the person or party that the broker represents):

- Put the interests of the client above all others, including the broker’s own interests;
- Inform the client of any material information about the property or transaction received by the broker;
- Answer the client’s questions and present any offer to or counter-offer from the client; and
- Treat all parties to a real estate transaction honestly and fairly.

A LICENSE HOLDER CAN REPRESENT A PARTY IN A REAL ESTATE TRANSACTION:

AS AGENT FOR OWNER (SELLER/LANDLORD): The broker becomes the property owner's agent through an agreement with the owner, usually in a written listing to sell or property management agreement. An owner's agent must perform the broker’s minimum duties above and must inform the owner of any material information about the property or transaction known by the agent, including information disclosed to the agent or subagent by the buyer or buyer’s agent.

AS AGENT FOR BUYER/TENANT: The broker becomes the buyer/tenant's agent by agreeing to represent the buyer, usually through a written representation agreement. A buyer's agent must perform the broker’s minimum duties above and must inform the buyer of any material information about the property or transaction known by the agent, including information disclosed to the agent by the seller or seller’s agent.

AS AGENT FOR BOTH - INTERMEDIARY: To act as an intermediary between the parties the broker must first obtain the written agreement of *each party* to the transaction. The written agreement must state who will pay the broker and, in conspicuous bold or underlined print, set forth the broker's obligations as an intermediary. A broker who acts as an intermediary:

- Must treat all parties to the transaction impartially and fairly;
- May, with the parties' written consent, appoint a different license holder associated with the broker to each party (owner and buyer) to communicate with, provide opinions and advice to, and carry out the instructions of each party to the transaction.
- Must not, unless specifically authorized in writing to do so by the party, disclose:
 - o that the owner will accept a price less than the written asking price;
 - o that the buyer/tenant will pay a price greater than the price submitted in a written offer; and
 - o any confidential information or any other information that a party specifically instructs the broker in writing not to disclose, unless required to do so by law.

AS SUBAGENT: A license holder acts as a subagent when aiding a buyer in a transaction without an agreement to represent the buyer. A subagent can assist the buyer but does not represent the buyer and must place the interests of the owner first.

TO AVOID DISPUTES, ALL AGREEMENTS BETWEEN YOU AND A BROKER SHOULD BE IN WRITING AND CLEARLY ESTABLISH:

- The broker’s duties and responsibilities to you, and your obligations under the representation agreement.
- Who will pay the broker for services provided to you, when payment will be made and how the payment will be calculated.

LICENSE HOLDER CONTACT INFORMATION: This notice is being provided for information purposes. It does not create an obligation for you to use the broker’s services. Please acknowledge receipt of this notice below and retain a copy for your records.

<u>South Texas Commercial Real Estate</u> Licensed Broker /Broker Firm Name or Primary Assumed Business Name	<u>9003917</u> License No.	<u>evillareal@stxcre.com</u> Email	<u>956-682-4242</u> Phone
<u>Edward J. Villareal</u> Designated Broker of Firm	<u>467182</u> License No.	<u>evillareal@stxcre.com</u> Email	<u>956-682-4242</u> Phone
<u>Licensed Supervisor of Sales Agent/ Associate</u>	<u>License No.</u>	<u>Email</u>	<u>Phone</u>
<u>Sales Agent/Associate’s Name</u>	<u>License No.</u>	<u>Email</u>	<u>Phone</u>

Buyer/Tenant/Seller/Landlord Initials

Date