

**For Lease** - Showroom | Office | Warehouse

**Airport Powers Business Centre**

**NAI Highland**

**NEWLY REMODELED!**



**1290 N Newport Rd | Colorado Springs, Colorado 80916**

## **BUILDING FEATURES**

Total Building Size:  $\pm$ 15,750 Square Feet  
Office Area:  $\pm$ 3,600 Square Feet  
Mezzanine Office Available  
Zoning: BP (Business Park)  
Construction: Concrete Tilt Up  
Power to Building: 277/480 Volt  
Ceiling Height: 20'  
Doors: Three (3) 12' x 12' Dock-High  
Two (2) 12' x 12' Grade-Level  
Column Spacing: 37.5' x 52.5'  
Other: Fire Sprinklers  
**Lease Rate: \$12.95 PSF, NNN**  
**NNN Expenses: Estimated at \$3.95 PSF**

**Exclusively Marketed By:**

**Randy Churchill Dowis**

Principal | Senior Broker

+1 719 667 6865

dowis@highlandcommercial.com

**Paul Engel**

Senior Broker

+1 719 332 9607

engel@highlandcommercial.com

NAI Highland, LLC

Two North Cascade Avenue, Suite 300  
Colorado Springs, CO 80903

+1 719 577 0044

[www.highlandcommercial.com](http://www.highlandcommercial.com)

12/17/2025





Immediate access  
and visibility to  
Powers Blvd



Adjacent to  
Colorado Springs  
Airport



4.5 Miles to I-25

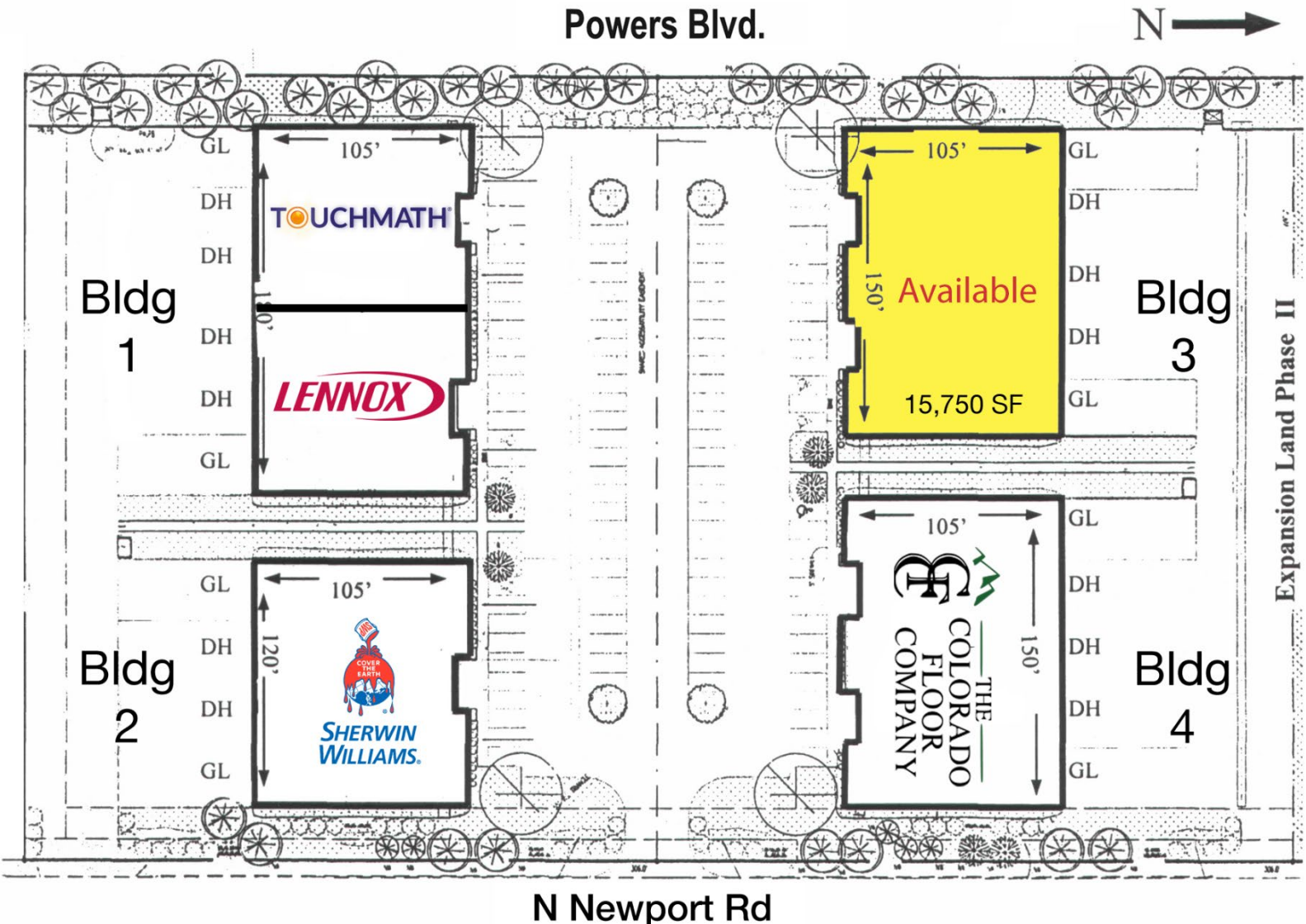

DISCLAIMER: NAI HIGHLAND, LLC OBTAINED THIS INFORMATION FROM SOURCES WE BELIEVE TO BE RELIABLE. HOWEVER, WE HAVE NOT VERIFIED ITS ACCURACY AND MAKE NO GUARANTEE, WARRANTY OR REPRESENTATION ABOUT IT. IT IS SUBMITTED SUBJECT TO THE POSSIBILITY OF ERRORS, OMISSIONS, CHANGE OF PRICE, RENTAL OR OTHER CONDITIONS, PRIOR SALE, LEASE OR FINANCING, OR WITHDRAWAL WITHOUT NOTICE. WE INCLUDE PROJECTIONS, OPINIONS, ASSUMPTIONS OR ESTIMATES FOR EXAMPLE ONLY, AND THEY MAY NOT REPRESENT CURRENT OR FUTURE PERFORMANCE OF THE PROPERTY. YOU AND YOUR TAX AND LEGAL ADVISORS SHOULD CONDUCT YOUR OWN INVESTIGATION OF THE PROPERTY AND TRANSACTION. LISTING BROKER IS ALSO A PART OWNER IN THIS PROJECT.