

# 110 N. 11TH STREET

## BOISE | IDAHO

# FOR LEASE



Space Available	+/- 2808 SF
Lease Rate	\$19.50 PSF + NNN (\$6.10)
Availability	30 Days
Zoning	Boise MX-5
Parking	Public Street
Building Size	+/- 7408 SF
Agent Showing	Contact agent

### Property Highlights

- Turn-key Restaurant/Bar Opportunity in the heart of downtown Boise
- Located on 11th St. between Main and Idaho with high vehicle and foot traffic
- Space has quality finishes, offers excellent visibility, walk up window, and an outdoor patio
- Furniture, fixtures and equipment are negotiable with current tenant
- Do not disturb tenant—contact agent



# 110 N. 11TH STREET

## BOISE | IDAHO

# FOR LEASE





# 110 N. 11TH STREET

BOISE | IDAHO

# FOR LEASE





# 110 N. 11TH STREET

## BOISE | IDAHO

# FOR LEASE

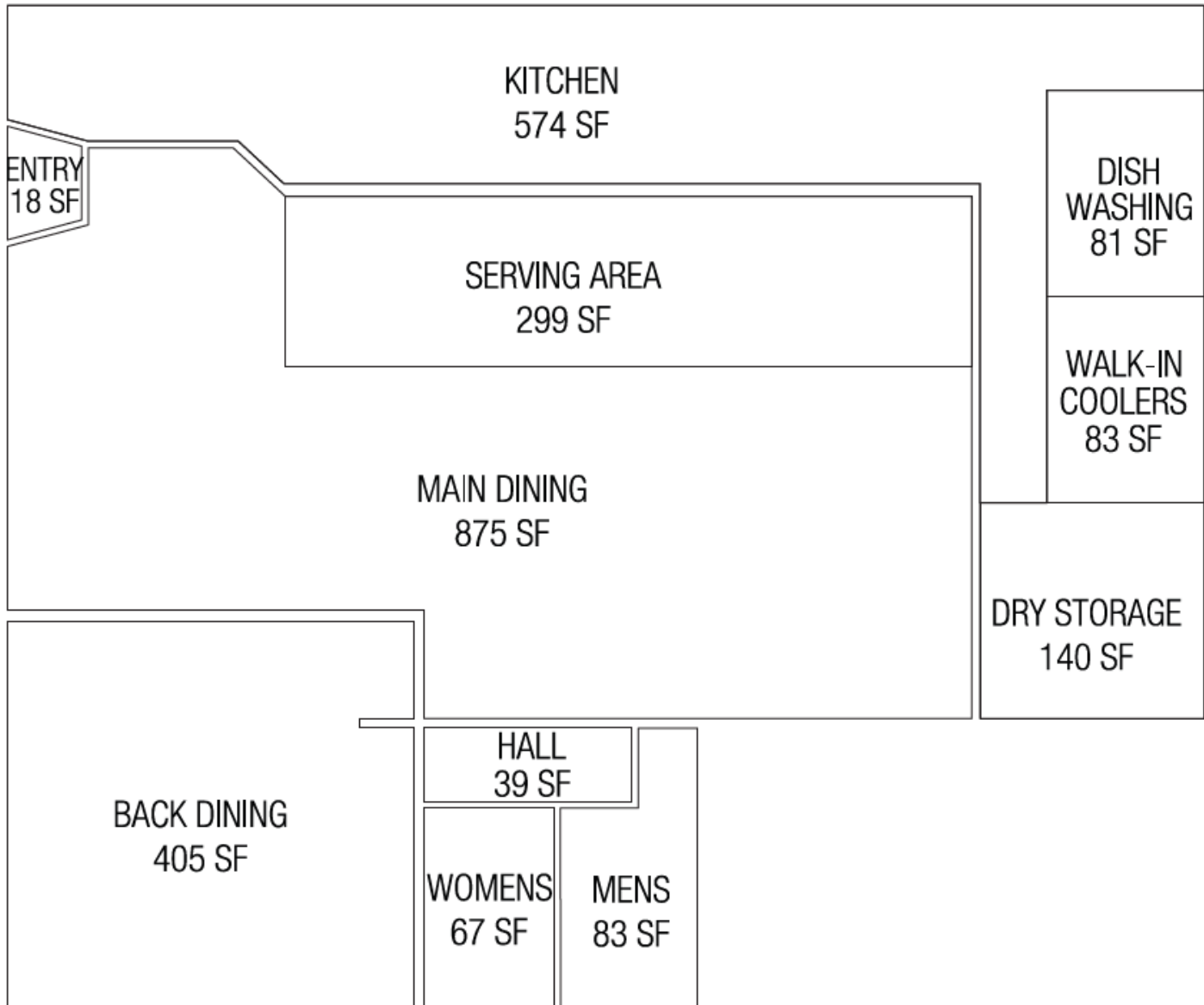

### AREA DIAGRAM

1/8" = 1'-0"



# 110 N. 11TH STREET

## BOISE | IDAHO

# FOR LEASE

