

9701 Windisch Road

West Chester, OH

Key Facts

Property type	Industrial space
Building size	427,920 SF
Space available	178,743 SF



Contact Us

Learn more about this property or schedule a tour by reaching out to our local investment and leasing officer.

Aaron Schmidt

+1 (860) 713-3901

aaron.schmidt@eqtpartners.com

Chris Simons

+1 (330) 697-9131

chris.simons@eqtpartners.com

9701 Windisch Road

West Chester, OH

BUILDING SPECIFICATIONS

Class A Industrial Space

Building Space Available: 178,743 SF

Office Area 1: 4,663 SF

Office Area 2 : 7,978 SF

Clear Height: 32'

Column Spacing: 48' x 50' with 60' x 50' dock bays

Dock Doors: 33

Drive-In Doors: 2

Truck Court: 162' with 60' concrete apron

Car Parking: 76

Fire Protection: ESFR sprinkler system

Roof Top HVAC - gas heat and electric air conditioning

Power: 3,000 amps, 277/480 volt, 3-phase electrical panels

Located less than 1 miles from I-75 and less than 1.5 miles from I-275

Located on 28.80 acre site

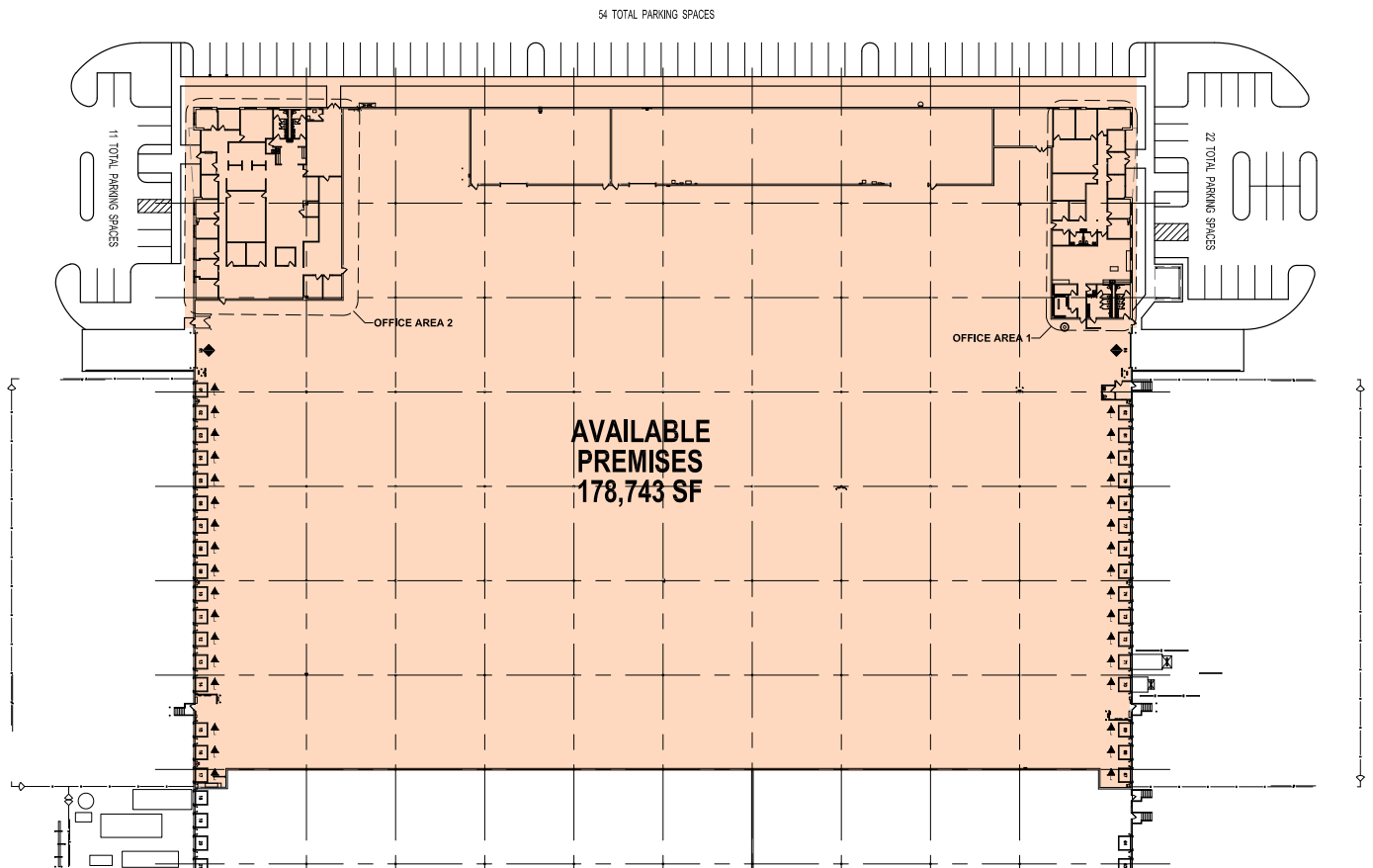

Contact Us

Learn more about this property or schedule a tour by reaching out to our local investment and leasing officer.

Aaron Schmidt

+1 (860) 713-3901

aaron.schmidt@eqtpartners.com

Chris Simons

+1 (330) 697-9131

chris.simons@eqtpartners.com

9701 Windisch Road

West Chester, OH

SITE PLAN

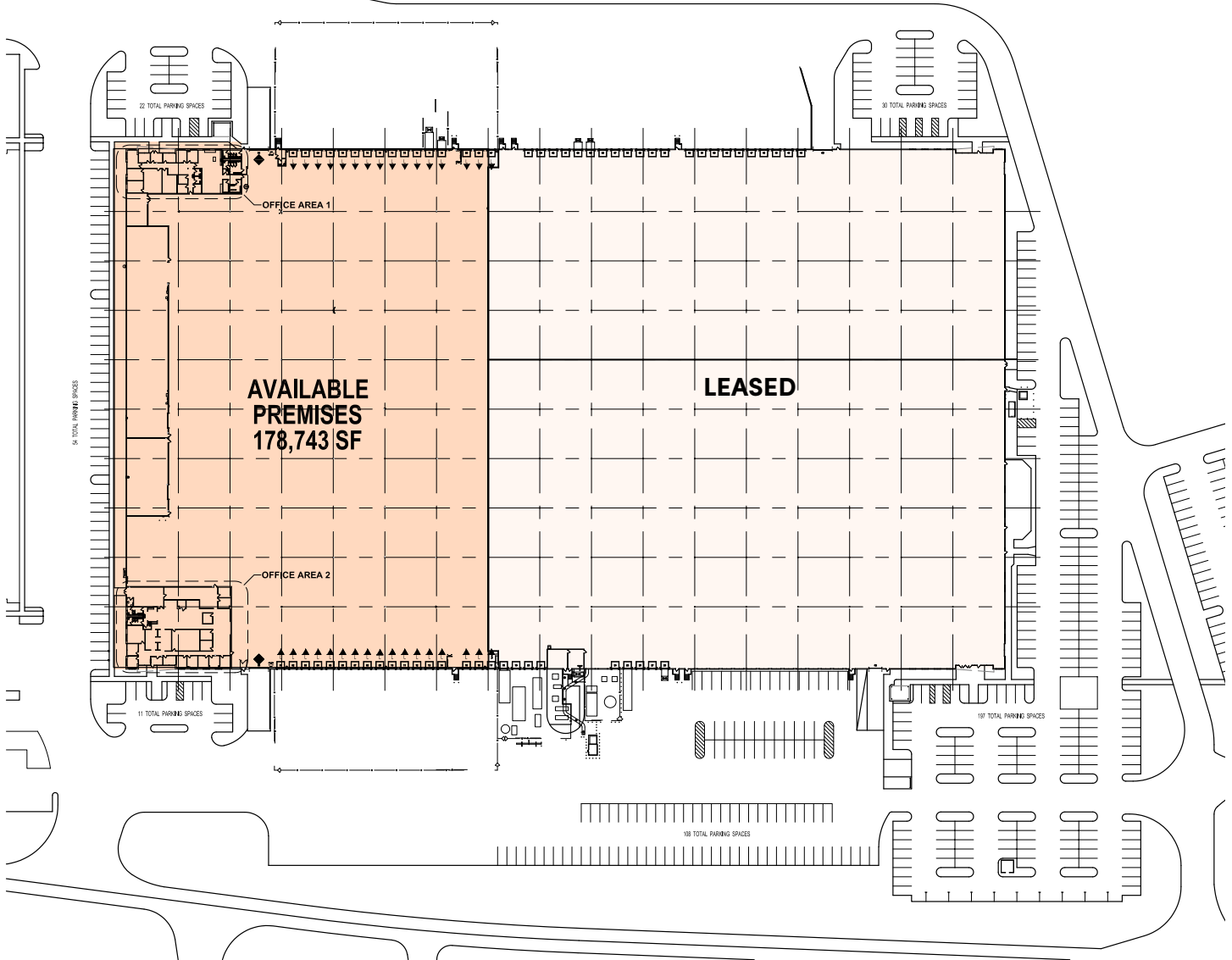

Contact Us

Learn more about this property or schedule a tour by reaching out to our local investment and leasing officer.

Aaron Schmidt

+1 (860) 713-3901

aaron.schmidt@eqtpartners.com

Chris Simons

+1 (330) 697-9131

chris.simons@eqtpartners.com

9701 Windisch Road

West Chester, OH



Contact Us

Learn more about this property or schedule a tour by reaching out to our local investment and leasing officer.

Aaron Schmidt

+1 (860) 713-3901

aaron.schmidt@eqtpartners.com

Chris Simons

+1 (330) 697-9131

chris.simons@eqtpartners.com