

Montclair Retail

34 Church St, Montclair, NJ



4,545 SF available, divisible

David Townes

Managing Director

+1 917 993 5515

david.townes@jll.com

Alana Friedman

Vice President

+1 201 741 0990

alana.friedman@jll.com



Property Location

- » Rare retail opportunity at the epicenter of downtown Montclair's coveted Church Street
- » Currently Montclair Antique Center
- » Located directly adjacent to Crescent Parking deck
- » Dedicated parking and rear entrance offered



Space Availability

- » 4,545 SF divisible
- » Asking Rent: Upon Request
- » Possession: Arranged



Co-Tenants

ANTHROPOLOGIE



Floor Plan – 4,545 SF

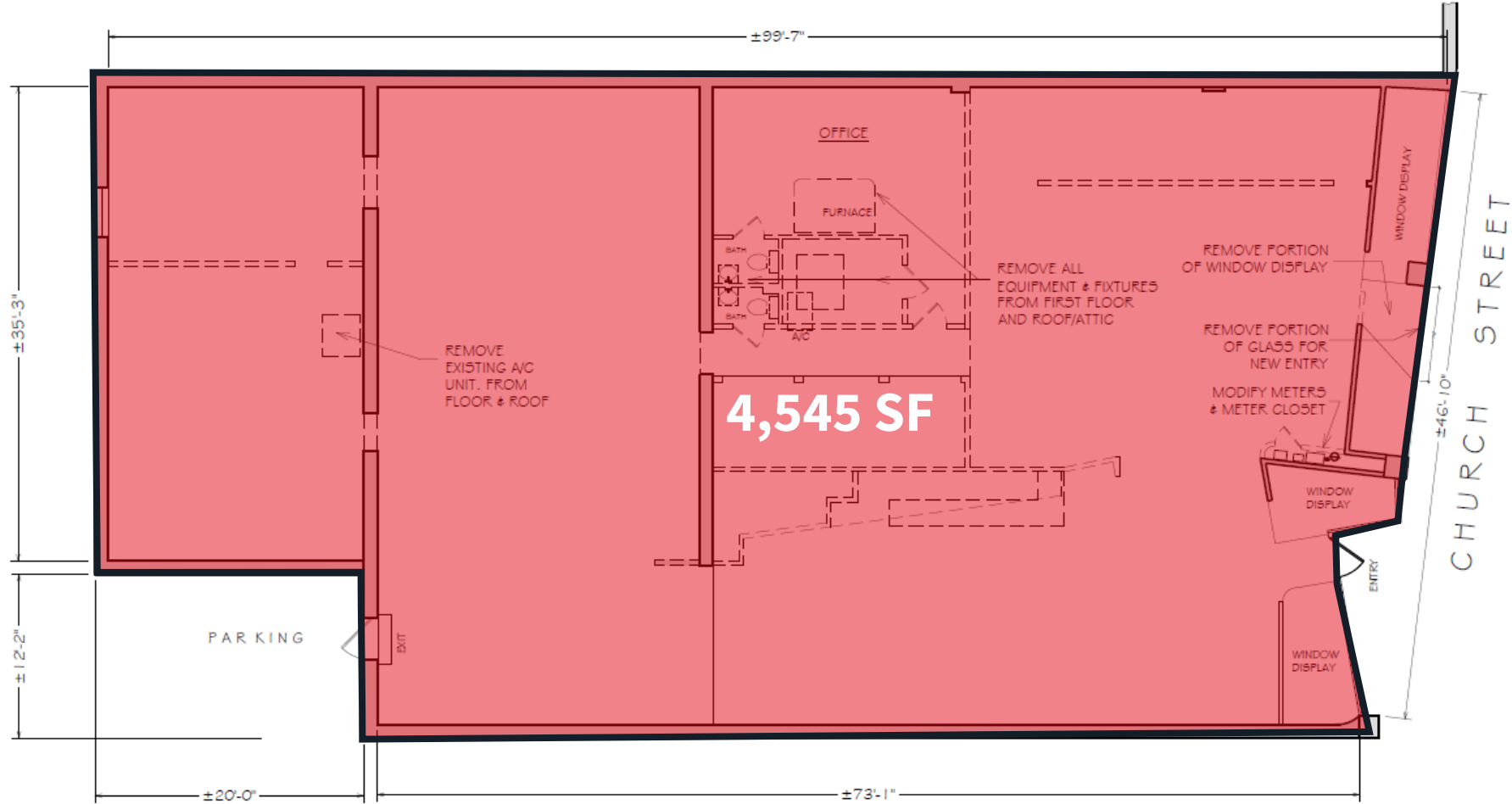

Proposed Division Plan

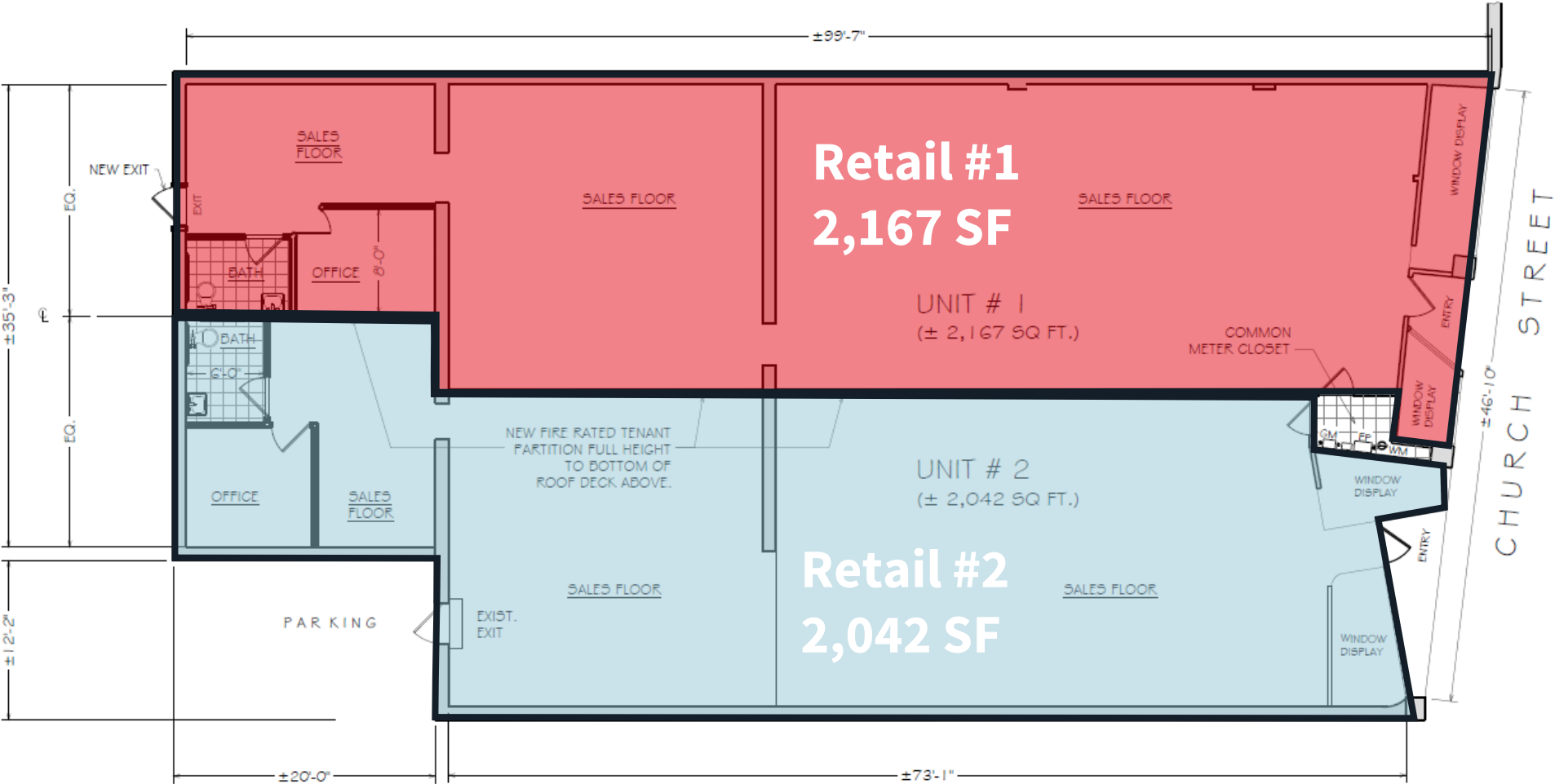

Neighborhood Aerial



Retail Aerial

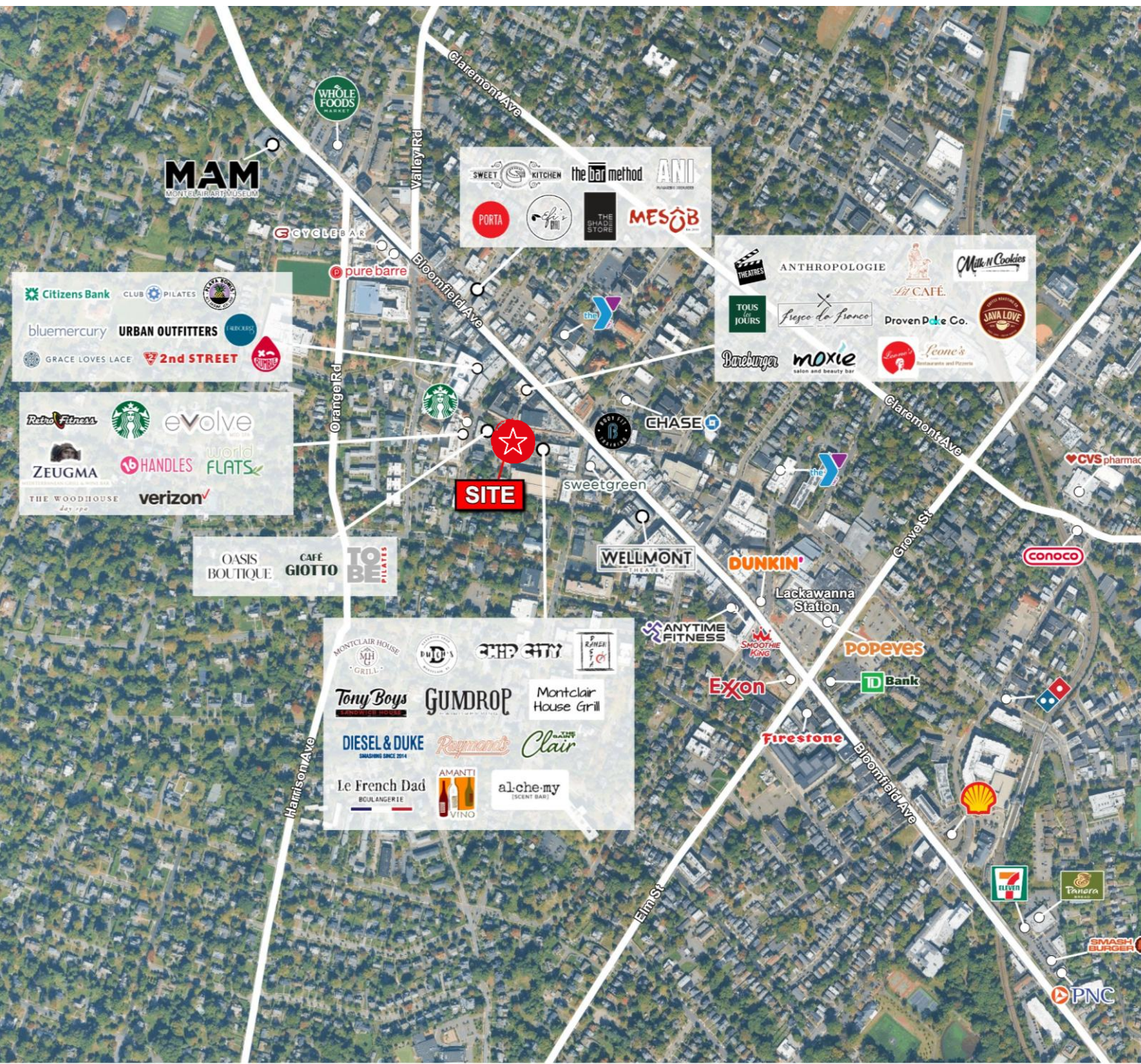

Demographics



1 Mile	2 Mile	3 Mile
23,276	87,832	196,966

Population



1 Mile	2 Mile	3 Mile
\$118,112	\$110,002	\$95,069

Med. HH Income



1 Mile	2 Mile	3 Mile
14,053	29,863	62,218

Employees



1 Mile	2 Mile	3 Mile
2,414	5,010	9,269

Businesses