

Northwest R-1 School District
 P.O. Box 500
 House Springs, MO 63051

NOTE: Clear, grub, and seed all areas to 40' from the centerline. (See sheet 2)

FIELD WORK BY	T. Hilbert	REVISED	
DRAWN BY	M. Huber	REVISED	11/28/07
CHECKED BY	D.L.G./J.J.G.	REVISED	
DATE	12/12/05	REVISED	
ENGINEER'S SEAL			

DISCLAIMER
 THE PLANS WHICH THE REGISTERED PROFESSIONAL ENGINEER HAS PREPARED OR SUPERVISED UNDER HIS DIRECTION, AS AUTHENTICATED BY HIS SIGNATURE AND SEAL, ARE LIMITED TO ONLY THE WORK ITEMS OF GRADING, SEWERS, WATER AND APPLICANT SITE DRAINAGE, AND IMPROVEMENTS. BUT DOES NOT COVER THE ENGINEER FOR SERVICES NOT BY THE REGISTERED PROFESSIONAL ENGINEER'S CONTRACT, INCLUDING MECHANICAL, ELECTRICAL, PLUMBING, AND TELEPHONE SUPPLY AND INSTALLATION. THE ENGINEER'S REPORTS, SURVEYS AND OTHER PLANS, SPECIFICATIONS, AND ESTIMATES RELATING TO OR INSTRUMENTS RELATING TO OR AUTHORIZED BY THE DATED AUTHENTICATION OF ANY PART REGISTERED PROFESSIONAL ENGINEER'S CONSTRUCTION MEANS AND METHODS AND ANY REVISIONS UNLESS AUTHENTICATED.

Copyright. All Rights Reserved
 by Goverevo Land Services, Inc.

GOVERO
 LAND SERVICES
 SURVEYING • ENGINEERING

5929 OLD STATE ROAD
 WHEELING, MO. 63084
 PH: 636-252-7448 FAX: 636-252-7448

SHEET NO. 4 of 9
 JOB NO. 06050

SITE IMPROVEMENT PLAN

First Baptist Church House Springs
 4375 Groylds Road
 House Springs, MO 63051

Mitchell V. & Deborah L. Cleek
 4308 Oakcrest Dr.
 House Springs, MO 63051

Deborah L. & Kathleen Kahlberg
 6446 Maple Lane
 House Springs, MO 63051

Mitchell V. & Deborah L. Cleek
 4308 Oakcrest Dr.
 House Springs, MO 63051

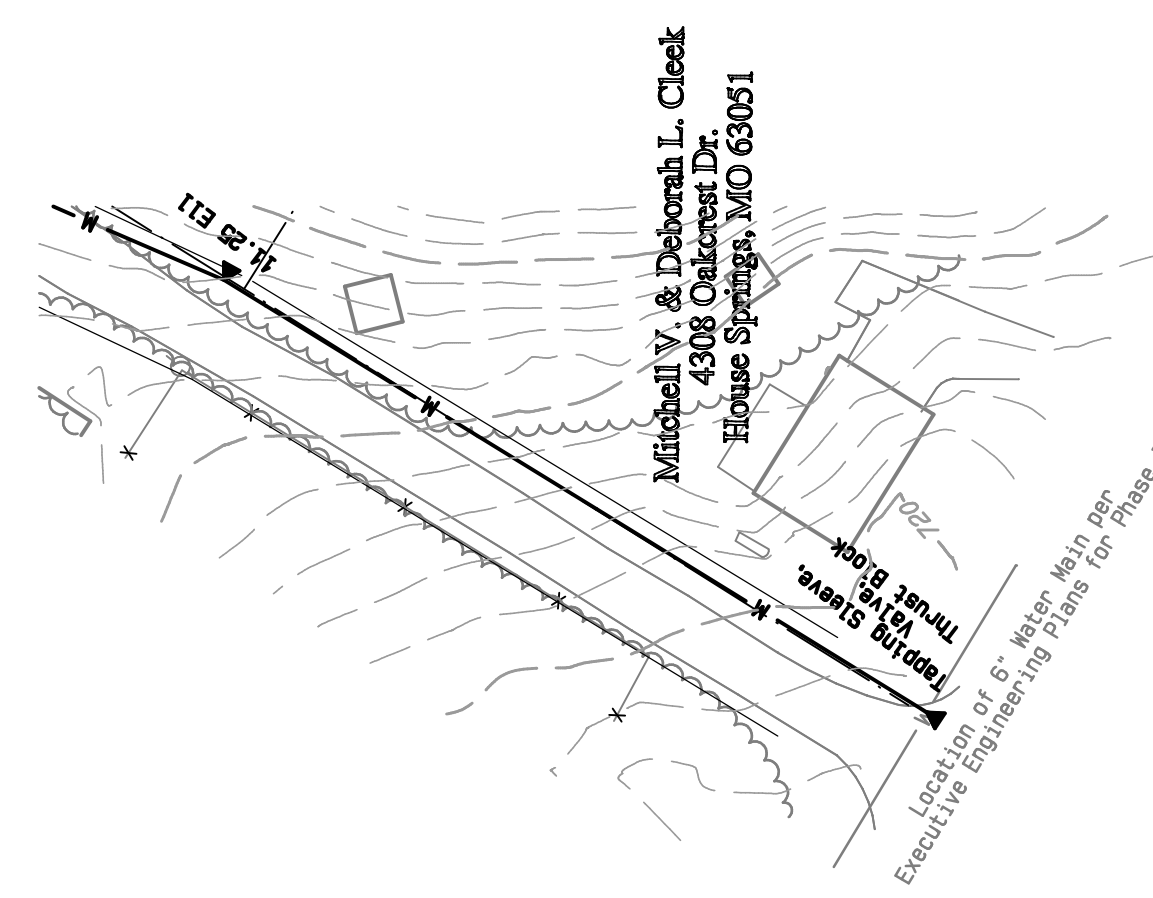
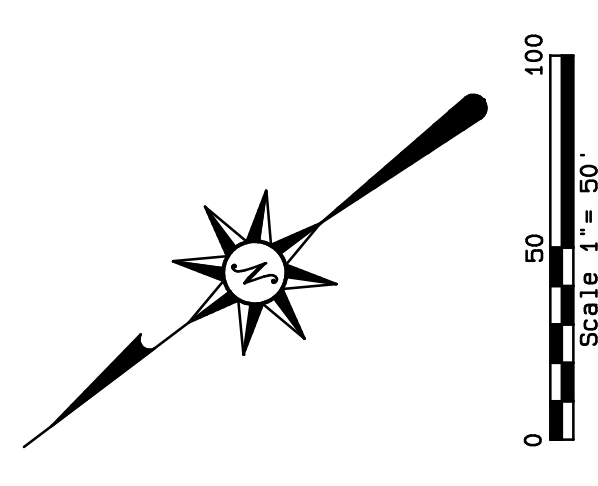

OFFSITE WATER LINE CONTINUATION

FOR WATER LINE CONTINUATION THIS SHEET