



DINING & ENTERTAINMENT
AT

UNION STATION



BE A PART OF THE CITY'S PAST, PRESENT,
AND FUTURE GRANDEUR...

UNION STATION

...ONE OF WASHINGTON D.C.'S MOST
ICONIC ARCHITECTURAL MARVELS AND A
LIVING MONUMENT TO THE CITY AND
NATION'S RICH HISTORY

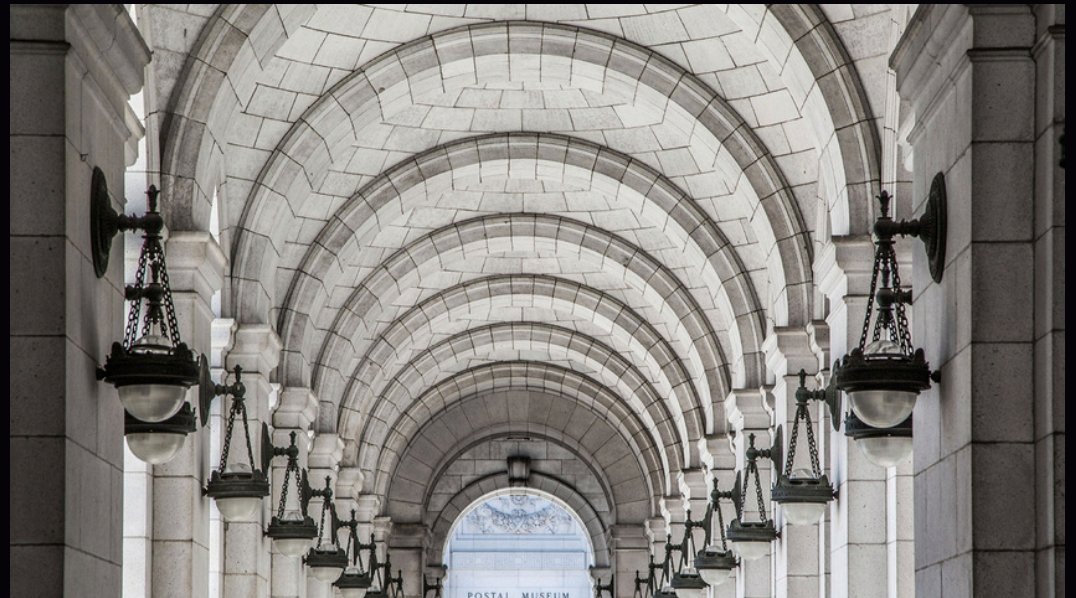
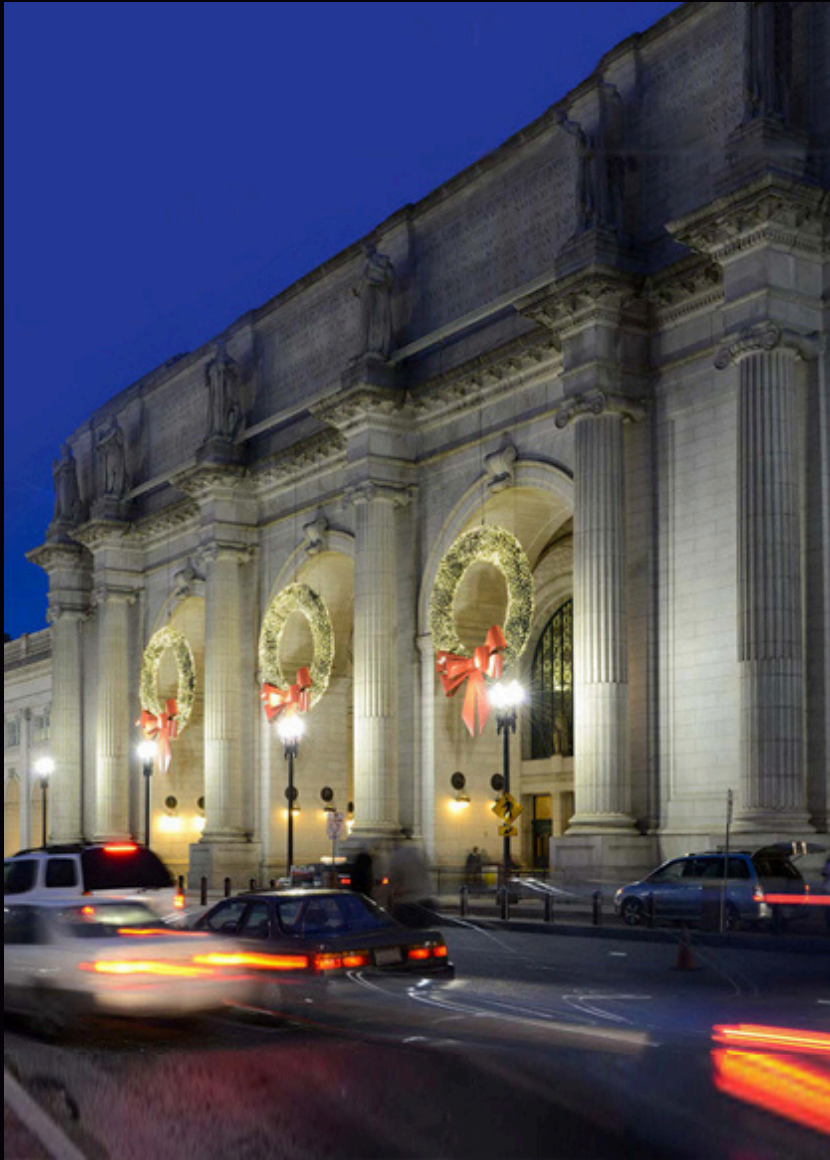

16.2 million



visitors come through Washington, D.C. annually



712,816

residents in the federal district of Washington, D.C. and 6,385,162 in greater metro D.C.



3rd largest office market, behind Chicago and New York

Washington, D.C.'s primary industry after the federal government is **tourism**



110

hotel properties with over 27,500 rooms and an additional 18 hotels planned

888,000

daytime population

The Washington, D.C. Convention Center hosts +800,000 attendees each year, representing \$689 million in delegate spending



\$6.2 billion

total visitor spending



\$1,278,457

consumer expenditures: entertainment & recreation



\$104,515

consumer expenditures: computers & accessories



\$101,486

average household income



the greater Washington area has the largest percent of adults with the advanced degrees (19%) in the US, more than twice the national average





3rd

most visited
tourist attraction
in the world
**TRAVEL+
LEISURE**



The station serves **Amtrak, MARC, VRE commuter rail** services, the **Washington Metro, inner city buses** and **regional buses** such as Greyhound, Mega Bus, and Bolt Bus



100,000

people passing through each day

1907



October 27, 1907
Union Station **officially opened** at 6:50 a.m., when the Baltimore and Ohio Pittsburgh Express pulled into the Station

40 million

visitors each year



A **central hub** for all Washington, D.C. tour buses



2nd busiest Amtrak rail station in the US and is **Amtrak's Headquarters**

Attractions near Union Station:



US Capitol



Library of Congress



Smithsonian Museums



2,500

parking spaces

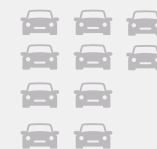

75%

of all **Capitol Hill employees** come in and out of Union Station daily



5 million

annual ridership on Amtrak



Nationals Baseball Stadium



Main Level

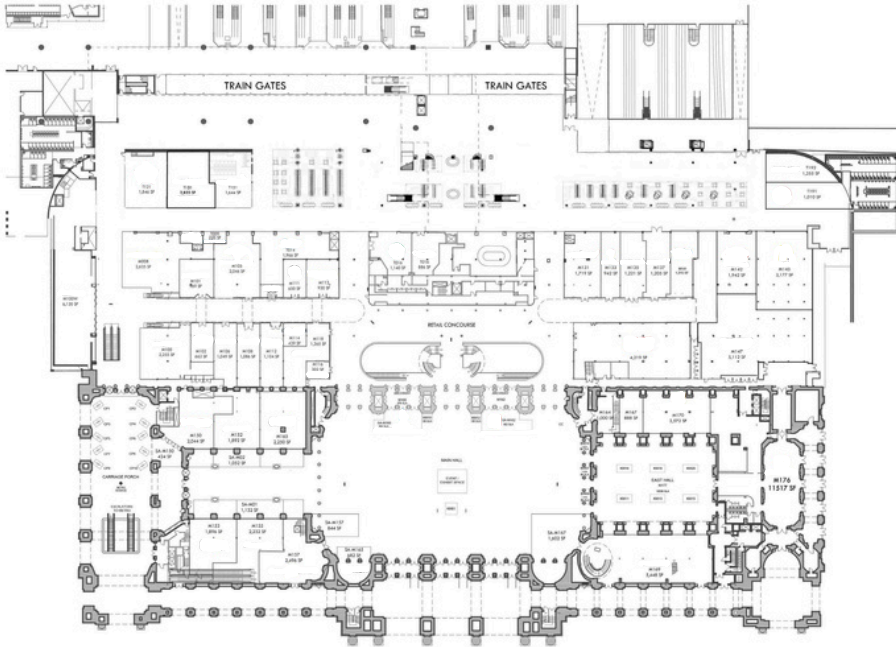

Mezzanine Level

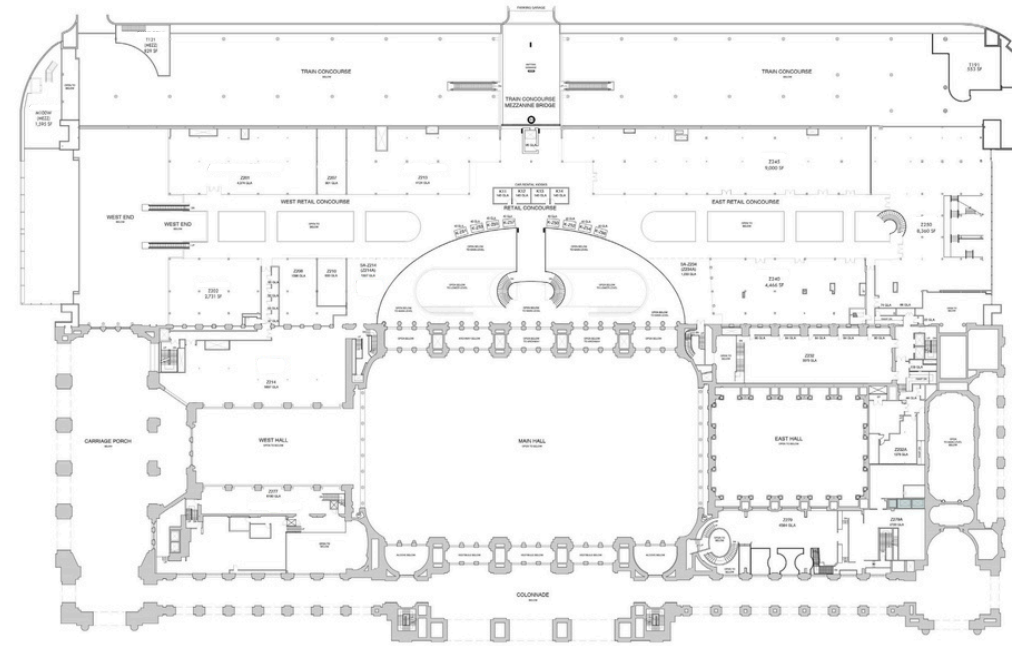

Lower Level

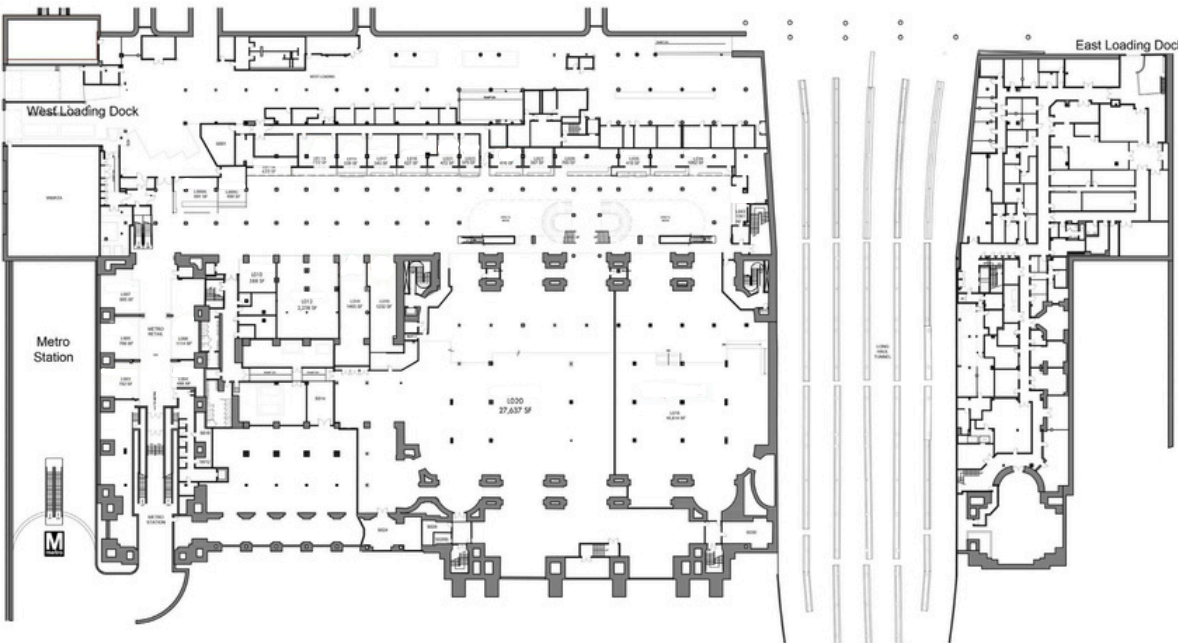

**VARIOUS
OPPORTUNITIES
AVAILABLE**



- | | | | | |
|--------------------------------------|---|--|--|--|
| 1 UNION STATION | 7 BOTANIC GARDENS | 13 NATIONAL GALLERY OF ART | 19 US HOLOCAUST MEMORIAL MUSEUM | 25 MARTIN LUTHER KING JR MEMORIAL |
| 2 SMITHSONIAN'S POSTAL MUSEUM | 8 NATIONAL MUSEUM OF THE AMERICAN INDIAN | 14 SMITHSONIAN LIBRARIES | 20 NATIONAL WWII MUSEUM | 26 FDR MEMORIAL |
| 3 COLUMBUS CIRCLE | 9 AIR AND SPACE MUSEUM | 15 WASHINGTON MONUMENT | 21 CONSTITUTION GARDENS | 27 JEFFERSON MEMORIAL |
| 4 UNITED STATES CAPITOL | 10 HIRSHORN MUSEUM | 16 SMITHSONIAN AMERICAN ART MUSEUM | 22 LINCOLN MEMORIAL REFLECTING POOL | 28 NEWSEUM |
| 5 LIBRARY OF CONGRESS | 11 NATIONAL MALL | 17 SMITHSONIAN MUSEUM OF AMERICAN HISTORY | 23 LINCOLN MEMORIAL | 29 CAPITAL ONE ARENA |
| 6 STANTON PARK | 12 SMITHSONIAN CASTLE | 18 THE WHITE HOUSE | 24 KOREAN WAR VETERANS MEMORIAL | 30 NATIONAL BUILDING MUSEUM |

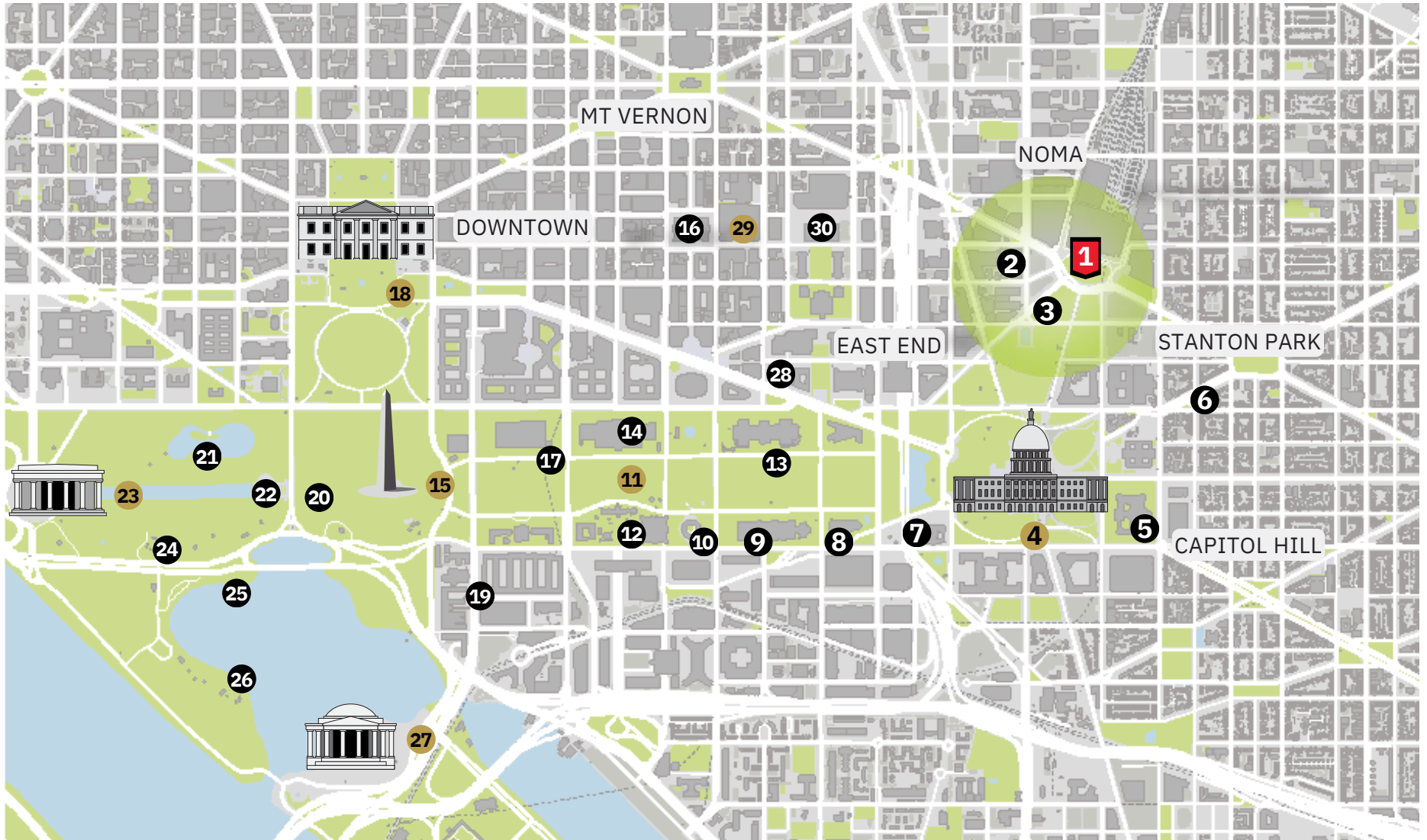

Food, Beverage, and Entertainment Leasing By:



Thomas Papadopoulos

tpap@papadop.com

O: (202) 466-2200

C: (202) 271-8661

John Gogos

Partner

jgogos@papadop.com

O: (202) 466-2200

C: (202) 365-5589

Adam Bush

Associate

abush@papadop.com

O: (202) 466-2200

C: (703) 268-9504

