

FOR SUBLEASE

# THE LANDMARK

14800 Landmark Blvd / Dallas, TX 75254



## BUILDING HIGHLIGHTS

- 158,650 SF
- 8 Stories
- Building Conference Center
- Tenant Lounge
- Grab & Go Cafe
- Garage Parking



# THE LANDMARK

14800 Landmark Blvd / Dallas, TX 75254

## SPACE HIGHLIGHTS

- Available January 1, 2025
- \$19.00/RSF + Electric
- Suite 640 - 5,246 SF (includes 1,154 RSF of shared space)
  - April 30, 2026 or September 30, 2026 Expiration
- Suite 720 (8,140 SF)
  - April 30, 2026 Expiration
- Available Furniture Includes
  - Cubicles
  - Task Chairs
  - Conference Room Furniture in Suite 640
  - Lobby Furniture in Suite 640
  - Microwaves in Suite 640 and Suite 720
  - No Furniture Available in Offices
  - No Conference Room Furniture Available in Suite 720



## FLOORPLANS

### SUITE 640



### SUITE 720

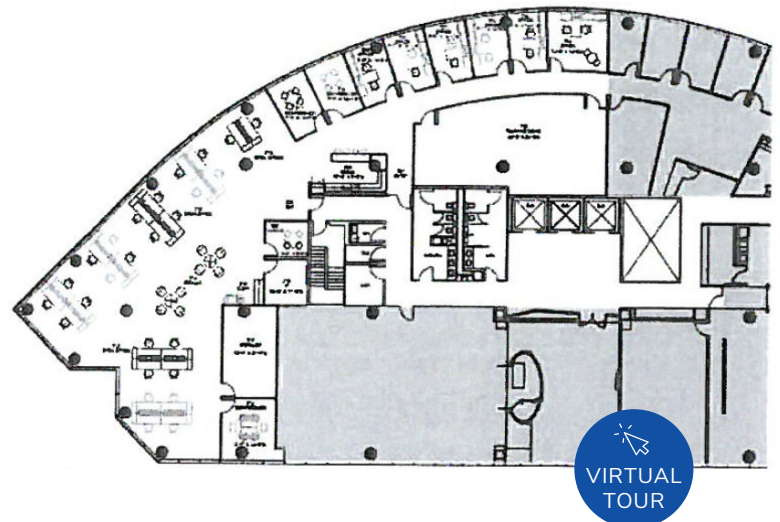

Copyright © 2024 Stream Realty Partners. All rights reserved. The information contained herein was obtained from sources believed reliable; however, Stream Realty Partners, L.P. make no guarantees, warranties or representations as to the completeness or accuracy thereof. The presentation of this property is submitted subject to errors, change of price, or conditions, prior sale or lease, or withdrawal without notice.

**Will Langenbahn**  
210.602.9085  
will.langenbahn@streamrealty.com

**Dylan Spencer**  
512.906.9798  
dylan.spencer@streamrealty.com



# THE LANDMARK

14800 Landmark Blvd / Dallas, TX 75254

## SUITE 640



## SUITE 720



**Will Langenbahn**  
210.602.9085  
will.langenbahn@streamrealty.com

**Dylan Spencer**  
512.906.9798  
dylan.spencer@streamrealty.com

