

# 1220 HARBOR BAY PKWY

Harbor Bay  
BUSINESS PARK | ALAMEDA



## FOR LEASE



## 1220 HARBOR BAY PKWY

This versatile space in the iconic Harbor Bay Business Park is perfect for a variety of uses, from small offices to large corporate suites, with options ranging from 50 SF to 40,000 SF. Headquarters of the Oakland Roots and Oakland Soul, the USL men's and women's soccer clubs, (previously home to the Oakland Raiders), this location offers prime access to Oakland International Airport, the San Francisco Ferry, and the Oakland Airport BART Shuttle, making it ideal for businesses seeking convenience and visibility. With its proximity to the Waterfront Bay Trail, this property is well-suited for sports, entertainment, arts, fitness, and other creative or collaborative industries. On-site amenities include meeting rooms, theaters, film rooms, ample gated parking, HVAC, and elevators, providing everything needed for a dynamic and professional environment.

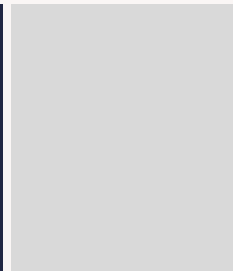
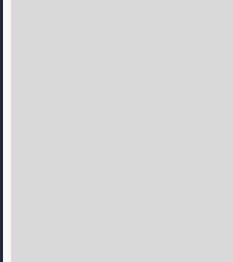
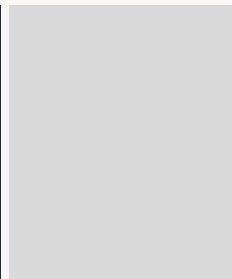

Office building located in the heart of Harbor Bay Business Park has multiple office spaces for lease

1220 HARBOR BAY PKWY

+ / - 50 - + / - 40,000 SF Available

Property Size + / 119,000 SF

Ample Parking ( 2.52 / 1,000 )

Free Shuttle to Oakland Airport BART

Walk or bike the Bay Trail

Easy access to :

San Mateo Bridge | I - 880 | I - 580

Dumbarton Bridge | Bay Bridge



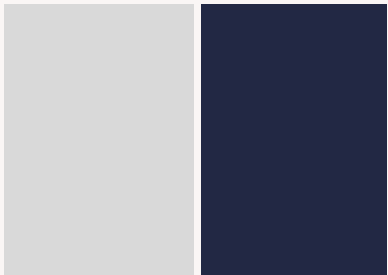
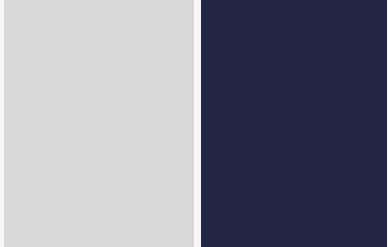

# PROMINENT HARBOR BAY BUSINESS PARK LOCATION

CLOSE PROXIMITY TO PORT OF OAKLAND  
NEXT TO FERRY DROP OFF AND PICKUP POINT

—○—  
**5 MIN**

DRIVE TO  
OAK INT'L AIRPORT

—○—  
**5 MIN**

DRIVE TO  
FERRY TERMINAL

—○—  
**15 MIN**

DRIVE TO  
BART

—○—  
**30 MIN**

DRIVE TO  
DOWNTOWN SF

# First Floor

SMALL PRIVATE OFFICES AND LARGE CORPORATE SUITES, 50 SF AND UP .  
FULL-SERVICE RENTS STARTING AT \$2.45 PER SF PER MONTH.

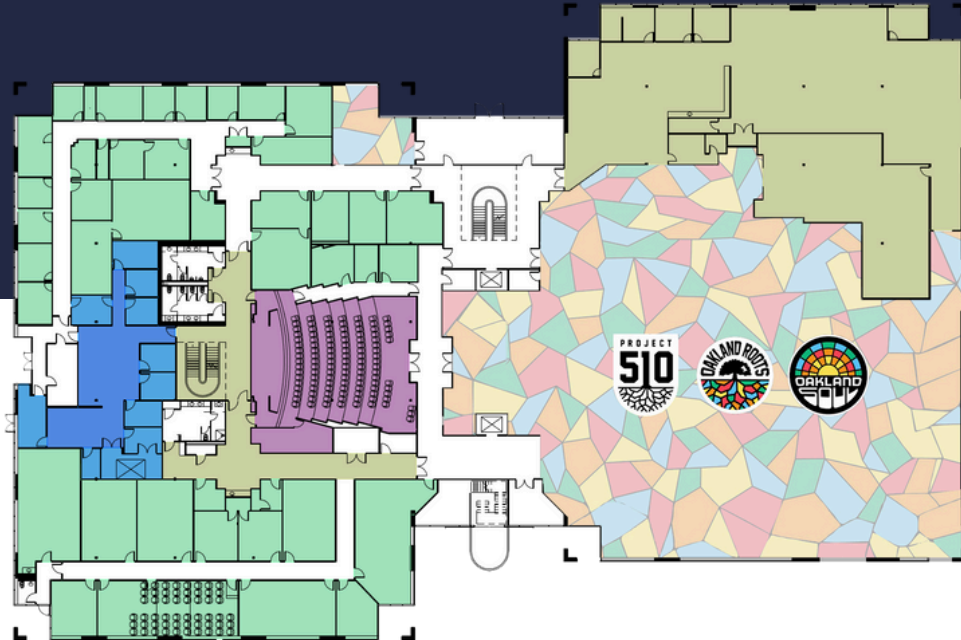

# Second Floor

SMALL PRIVATE OFFICES AND LARGE CORPORATE SUITES, 50 SF UP.  
FULL-SERVICE RENTS STARTING AT \$2.45 PER SF PER MONTH.

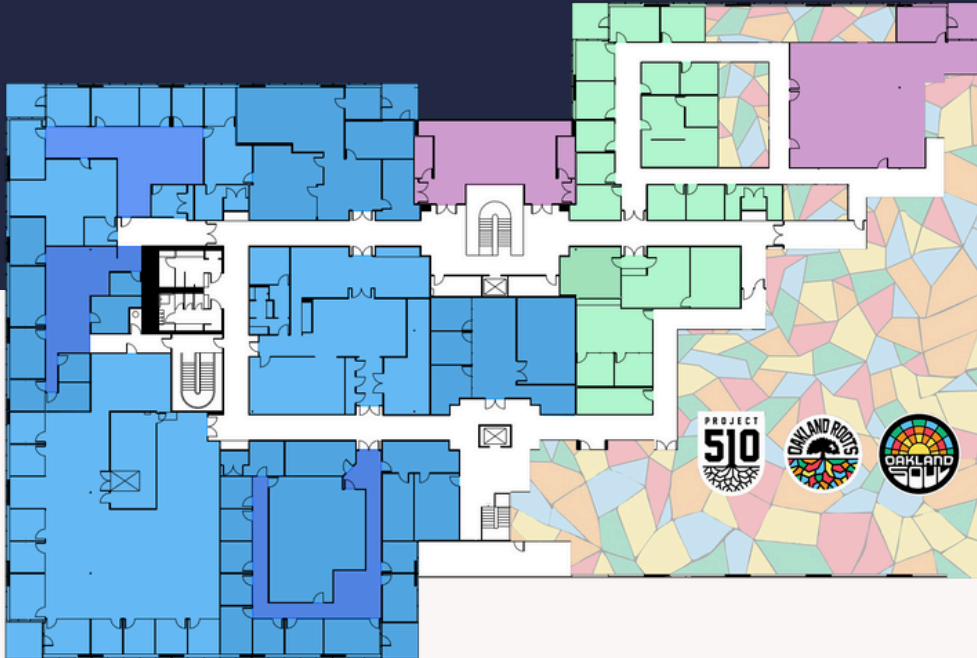



1220 HARBOR BAY PKWY  
ALAMEDA, CA 94502

FOR MORE INFORMATION  
PLEASE CONTACT :



KELLY KLINGLER

925. 550. 9540 DRE # 01052191  
KELLYK@WELLSANDBENNETT.COM  
WWW.WELLSANDBENNETT.COM

**WELLS & BENNETT**  
REAL ESTATE EXPERTISE SINCE 1924