



**2,000-
3,953 SF
FOR LEASE**

[Lease Details](#)

Available Immediately

Space Can Be Divided

\$17.75/SF/YR

Modified Gross

CAM Estimate \$6.52/SF

Minimum 4-year Lease Term

940 PARK EAST BLVD - IN NEW VA CLINIC COMPLEX



PRIME NEW SPACE AVAILABLE TO MAKE YOUR OWN!
Available immediately, the space can be further divided ranging from 2,000-3,953 square feet and can be built out to fit your needs.

Landlord will be providing:

- \$25/SF Tenant Improvement Allowance
- Electrical panel ready for distribution
- HVAC system ready for distribution
- Water and drain stubbed up in space
- Fire suppression system

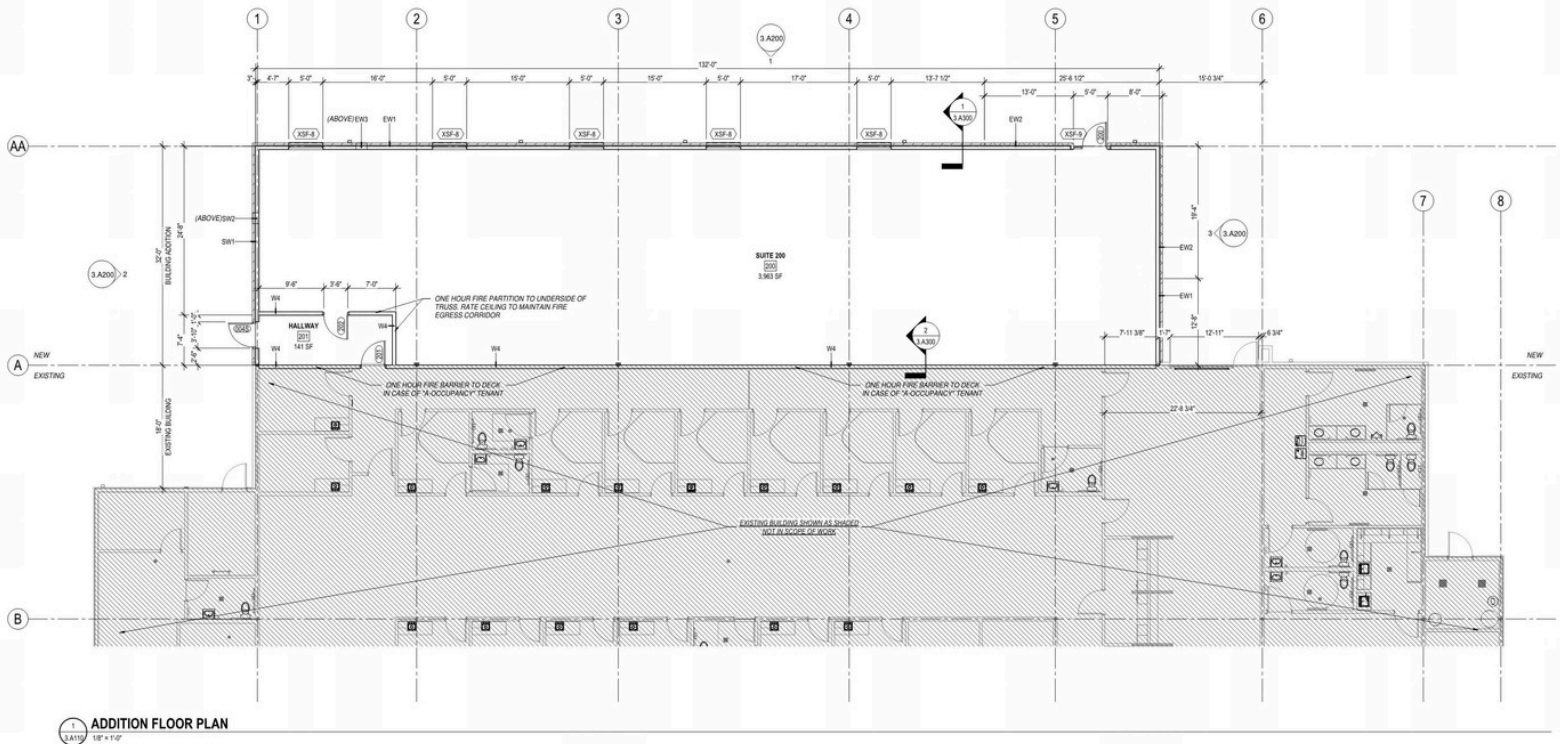

CALL US TODAY FOR MORE INFORMATION!

TRUVANT
REALTY

RANDY TRUITT
765-404-7584
RANDY@TRUVANTREALTY.COM

BRI POWELL
765-426-2339
BRI@TRUVANTREALTY.COM