

UNIVERSITY MEDICAL CENTER

2829 S UNIVERSITY DR., FARGO, ND 58103



MEDICAL OFFICE FOR LEASE



EASY ACCESS ON SOUTH UNIVERSITY DRIVE

Space Available: 1,993 SF - 19,636 SF

Base Rent: \$14.00 PSF

CAM: \$10.00 PSF (Includes Heat)

Tenant Expenses: Phone, Internet, Janitorial

Patrick Vesey | 701.239.5840

Patrick.Vesey@goldmark.com

Goldmark Commercial Real Estate

www.goldmarkcommercial.com

UNIVERSITY MEDICAL CENTER

2829 S UNIVERSITY DR., FARGO, ND 58103



2ND FLOOR SPACE AVAILABLE

SUITE 201: 1,993 SF
SUITE 202: 2,115 SF
SUITE 203: 4,799 SF
SUITE 204: 10,456 SF

BASE RENT

\$ 14.00 PSF

CAM

\$ 10.00 PSF (includes heat)

TENANT EXPENSES

Phone/internet
Janitorial

BUILDING TENANTS

Urgent Medicine Associates
Independent Radiology Services
Northern Plains Surgery Center

PROPERTY DESCRIPTION:

Space available for lease on the 2nd floor of the University Medical Center. Suites can be combined. Up to 18 treatment/consult rooms, surgery room, seven offices, conference room, break rooms, two waiting areas, large reception area, staff lockers and multiple restrooms.

Building amenities include:

- Elevator
- Ample Parking
- Strong signage presence on South University

Neighbors:

- Sanford Plastic Surgery
- Burggrafs Ace Hardware
- Baker's Garden & Gift
- American Federal Bank

This information has been secured from sources we believe to be reliable, but we make no representation or warranties, expressed or implied, as to the accuracy of the information. Interested parties should conduct their own independent investigations and rely only on those results.

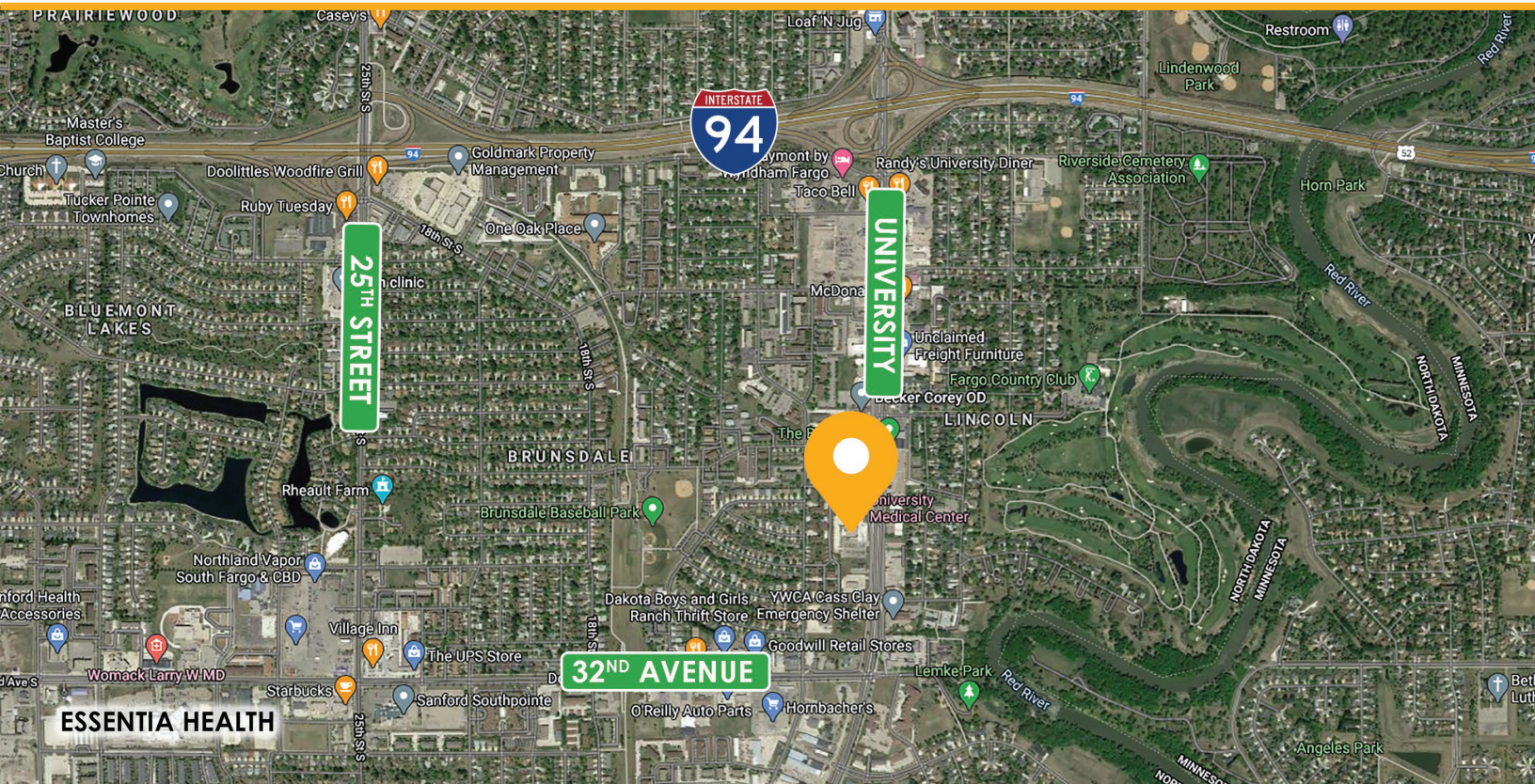

UNIVERSITY MEDICAL CENTER

2829 S UNIVERSITY DR., FARGO, ND 58103

GOLDMARK™
COMMERCIAL REAL ESTATE INC

FLOORPLAN

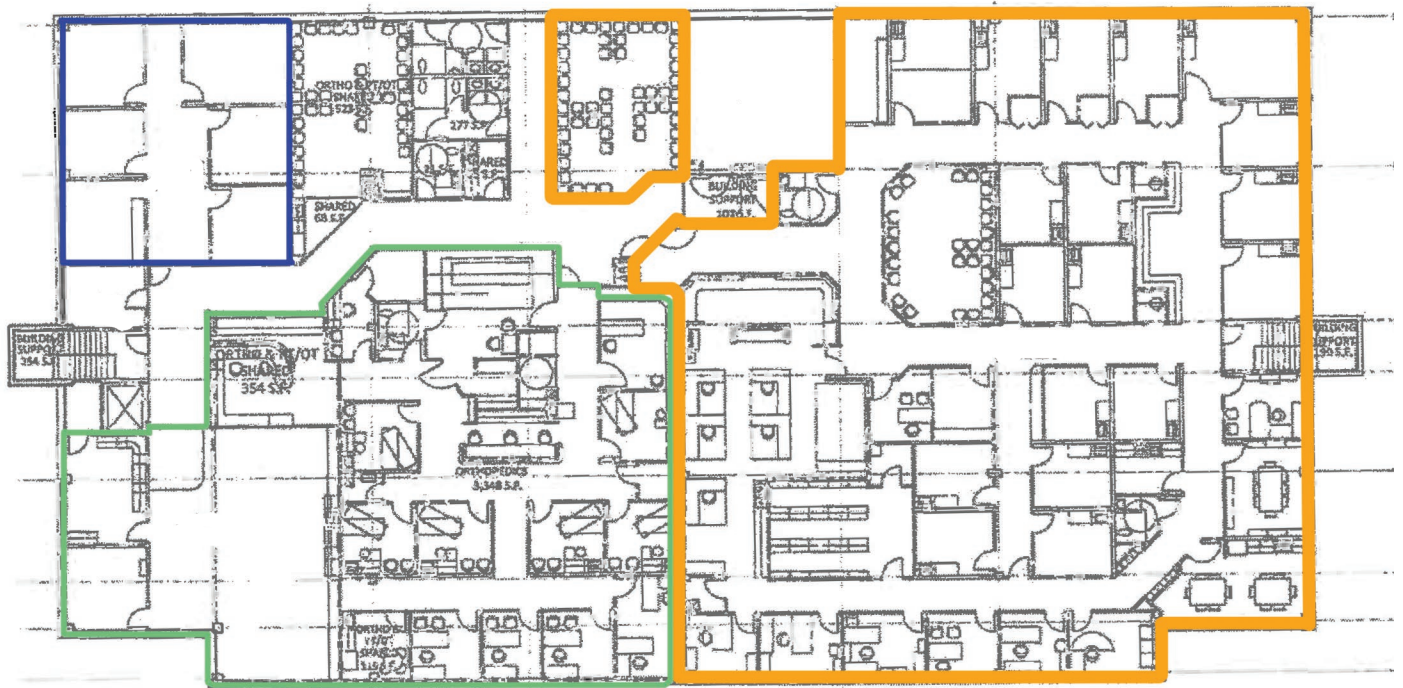

EXTERIOR PHOTO



UNIVERSITY MEDICAL CENTER

2829 S UNIVERSITY DR., FARGO, ND 58103

GOLDMARK™
COMMERCIAL REAL ESTATE INC

SUITE 202/203



UNIVERSITY MEDICAL CENTER

2829 S UNIVERSITY DR., FARGO, ND 58103

GOLDMARK™
COMMERCIAL REAL ESTATE INC

SUITE 204

