

6.1 AC - 1 AC Available

Tractor Trailer/Fleet Parking



FENCED - LIT - PAVED

MIDDLE GEORGIA INDUSTRIAL PARK



Located within the logistics hub of Macon, Georgia. MGIP is a unique 390,000 SF Industrial Park that sites on 45 acres.

Location Highlights

- 1/4 miles to I-75 | 3 Miles to I-16
- 2 Hours to Port of Savannah | 1 Hour to Atlanta
- 3 Regional and International Airports

**LEASE RATE:
\$4,500/ PER AC
MONTHLY**

**FOR MORE
INFORMATION
CONTACT**

Lan Heath, Commercial Sales & Leasing
478-731-5899 (C)
478-746-9421 (O)
lheath@fickling.com

commercial.fickling.com

577 Mulberry St, Suite 1100 * P.O. Box 310 * Macon, GA 31202 | Phone (478) 746-9421 | Fax (478) 742-2015

This information is from resources deemed to be reliable, no warranties or guarantees for accuracy are made by Fickling and Company

6.1 AC - 1 AC Available

Tractor Trailer/Fleet Parking

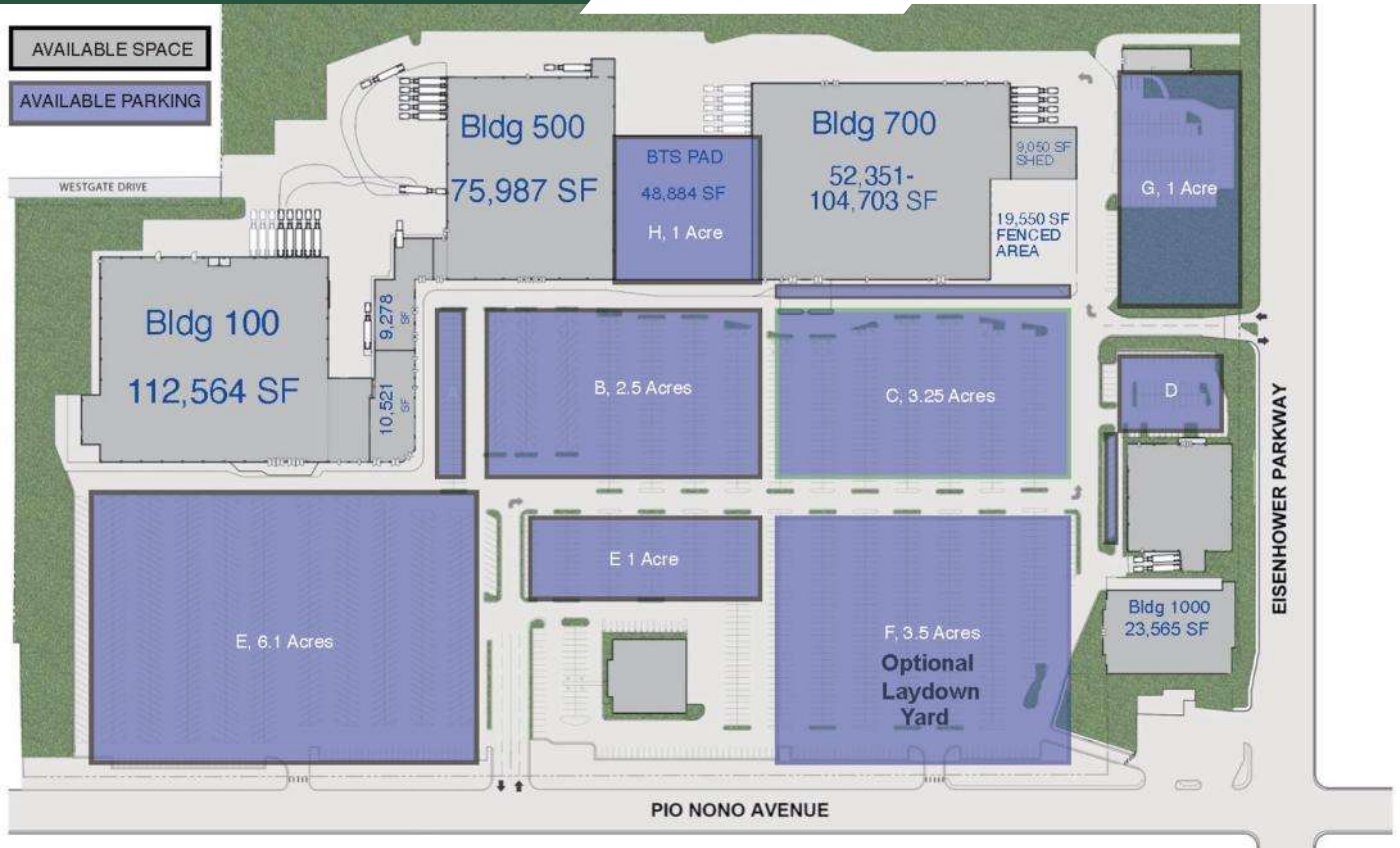

Available Lots	Acres	Total Price
Lot B	2± Acres	\$9,000.00/ per mo
Lot C	3.25 Acres	\$14,625.00/ per mo
Lot E	1 Acres	\$4,500.00/ per mo
Lot F	3.5 Acres	\$15,750.00/ per mo
Lot G (BTS PAD)	1 Acres	\$4,500.00/ per mo

LEASE RATE: \$4,500/ PER AC MONTHLY

**FOR MORE
INFORMATION
CONTACT**

Lan Heath, Commercial Sales & Leasing
 478-731-5899 (C)
 478-746-9421 (O)
 lheath@fickling.com

commercial.fickling.com

577 Mulberry St, Suite 1100 * P.O. Box 310 * Macon, GA 31202 | Phone (478) 746-9421 | Fax (478) 742-2015

This information is from resources deemed to be reliable, no warranties or guarantees for accuracy are made by Fickling and Company

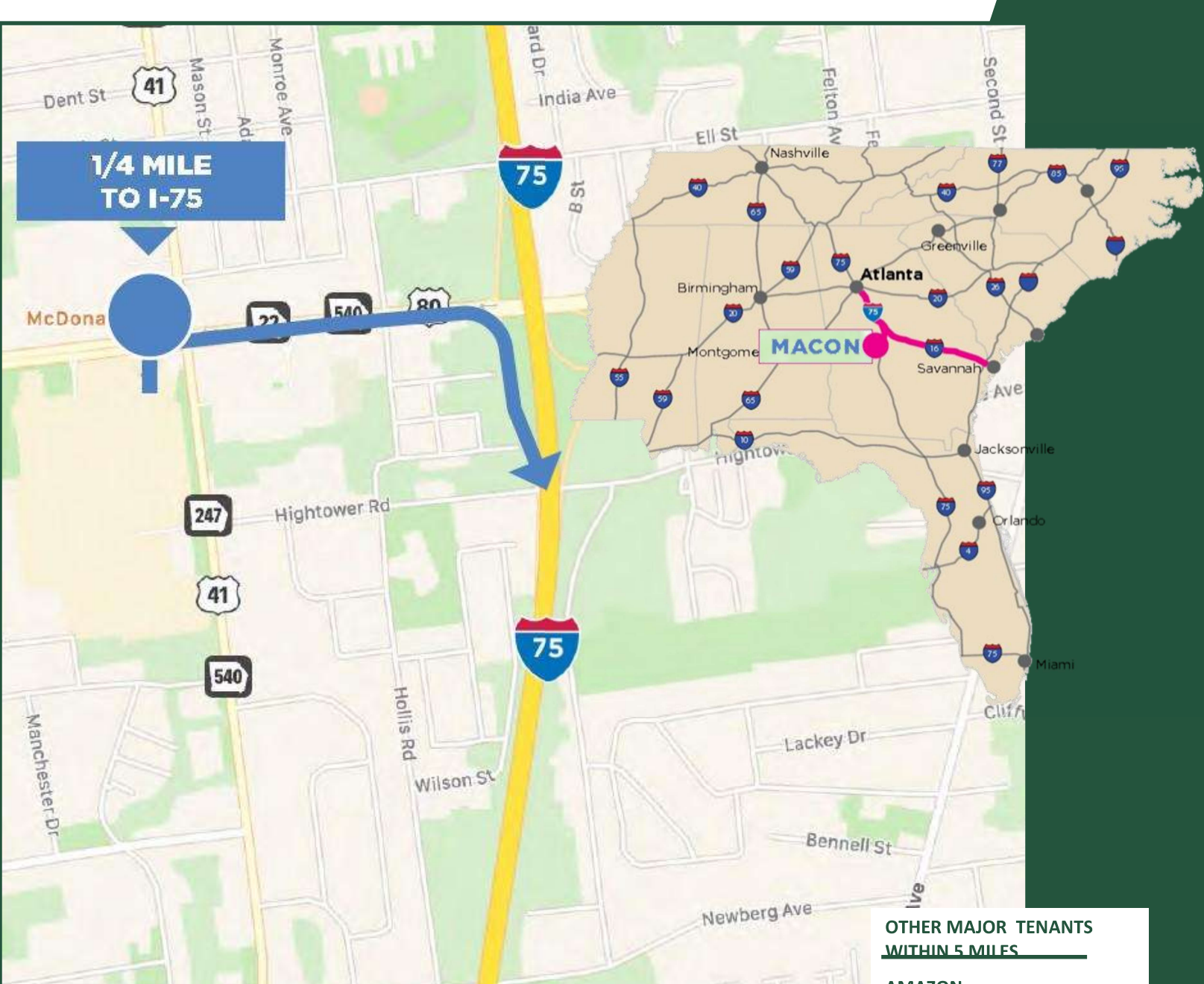

**OTHER MAJOR TENANTS
WITHIN 5 MILES**

- AMAZON
- TRACTOR SUPPLY COMPANY
- YKK CAMPUS
- FEDEX GROUND
- KUMHO TIRE
- KOHL'S DISTRIBUTION CENTER

0.25 MILES	To I-75
3 MILES	To I-16
80 MILES	TO THE PORT OF SAVANNAH
171 MILES	TO THE ATLANTA AIRPORT

**FOR MORE
INFORMATION
CONTACT**

Lan Heath, Commercial Sales & Leasing
 478-731-5899 (C)
 478-746-9421 (O)
 lheath@fickling.com

commercial.fickling.com

577 Mulberry St, Suite 1100 * P.O. Box 310 * Macon, GA 31202 | Phone (478) 746-9421 | Fax (478) 742-2015

This information is from resources deemed to be reliable, no warranties or guarantees for accuracy are made by Fickling and Company