

FOR LEASE

AVAILABLE SPACE



2775 HWY 101 - FLORENCE, OREGON

## PROFESSIONAL OFFICE/RETAIL

- SPACE C: 1,440 SQUARE FEET
- HIGH VISIBILITY CORNER - 28TH & HWY 101
- NEIGHBORS: VERIZON WIRELESS, DOMINO'S PIZZA & MIRACLE EAR

*Lease Rate:* \$1.50/SF/NNN (NNN=\$0.45/SF)

*Please contact for more information:*

**SUZANNE KINTZLEY**  
suzannek@campbellre.com | (541) 484-2214

**TIM CAMPBELL**  
timc@campbellre.com | (541) 484-2214

**Campbell**  
COMMERCIAL  
REAL ESTATE  
www.campbellre.com

HWY 101

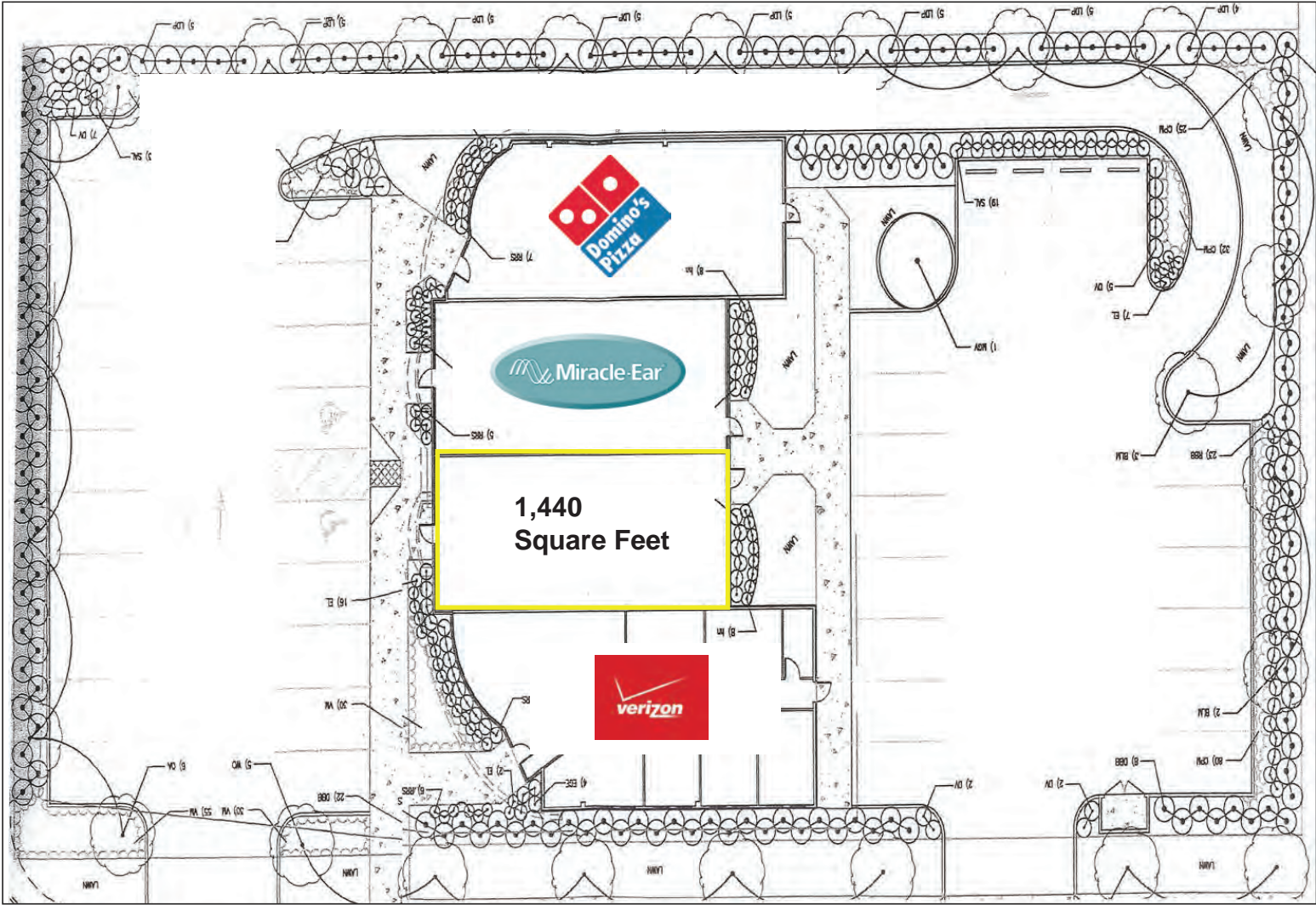

28th Street

The information in this package was obtained from sources deemed reliable, and is not guaranteed by agent. Package is subject to change, error or omission, prior sale or lease, correction or withdrawal. Any party contemplating purchase is urged to conduct their own independent study and inspection.



