

# OFFICE WAREHOUSE FOR LEASE

1305 Progress Road, Suffolk, VA 23434



## ABOUT PROPERTY

- 84,200 - 119,317 SF Available (Subdividable)
  - Up to 9,117 SF office
  - 84,200 - 110,200 SF warehouse
- 352 SF Warehouse Office Within Warehouse
- Seven Dock Doors: (6) 8' x 10' & 8' x 13' with Hydraulic Pit Levelers, Dock Locks, Dock Seals, Light Communication Systems, and Dock Bumpers
  - (1) 8' x 13' with Mechanical Pit Leveler
- Two Grade-Level Doors: 8' x 14' & Motorized 12' x 14'
- 18' - 27' Clear Ceiling Height
- 25' x 40' Column Spacing
- Wet Fire Suppression System
- Exhaust Fans in Warehouse
- 2,400 amp, 120/480V, 3-phase electrical service
- Two separate locker rooms, one with shower
- 150 Parking Spaces Available
- Foreign Trade Zone #20
- Zoned M-2 (Heavy Industrial)
- **REDUCED RATE:** \$7.25 psf, NNN



### FOR MORE INFORMATION:

**BOBBY BEASLEY, III, SIOR**

757.640.8241

[BobbyBeasley3@HarveyLindsay.com](mailto:BobbyBeasley3@HarveyLindsay.com)

**HARVEY LINDSAY**  
COMMERCIAL REAL ESTATE

# PHOTOS

1305 Progress Rd, Suffolk, VA



**FOR MORE INFORMATION:**  
**BOBBY BEASLEY, III, SIOR**  
757.640.8241  
[BobbyBeasley3@HarveyLindsay.com](mailto:BobbyBeasley3@HarveyLindsay.com)

**HARVEY LINDSAY**  
COMMERCIAL REAL ESTATE

The information contained herein has been obtained from sources believed to be reliable but is not warranted. We cannot be responsible for errors, omissions, withdrawal, or prior lease or sale.

# PORT MAP

1305 Progress Rd, Suffolk, VA

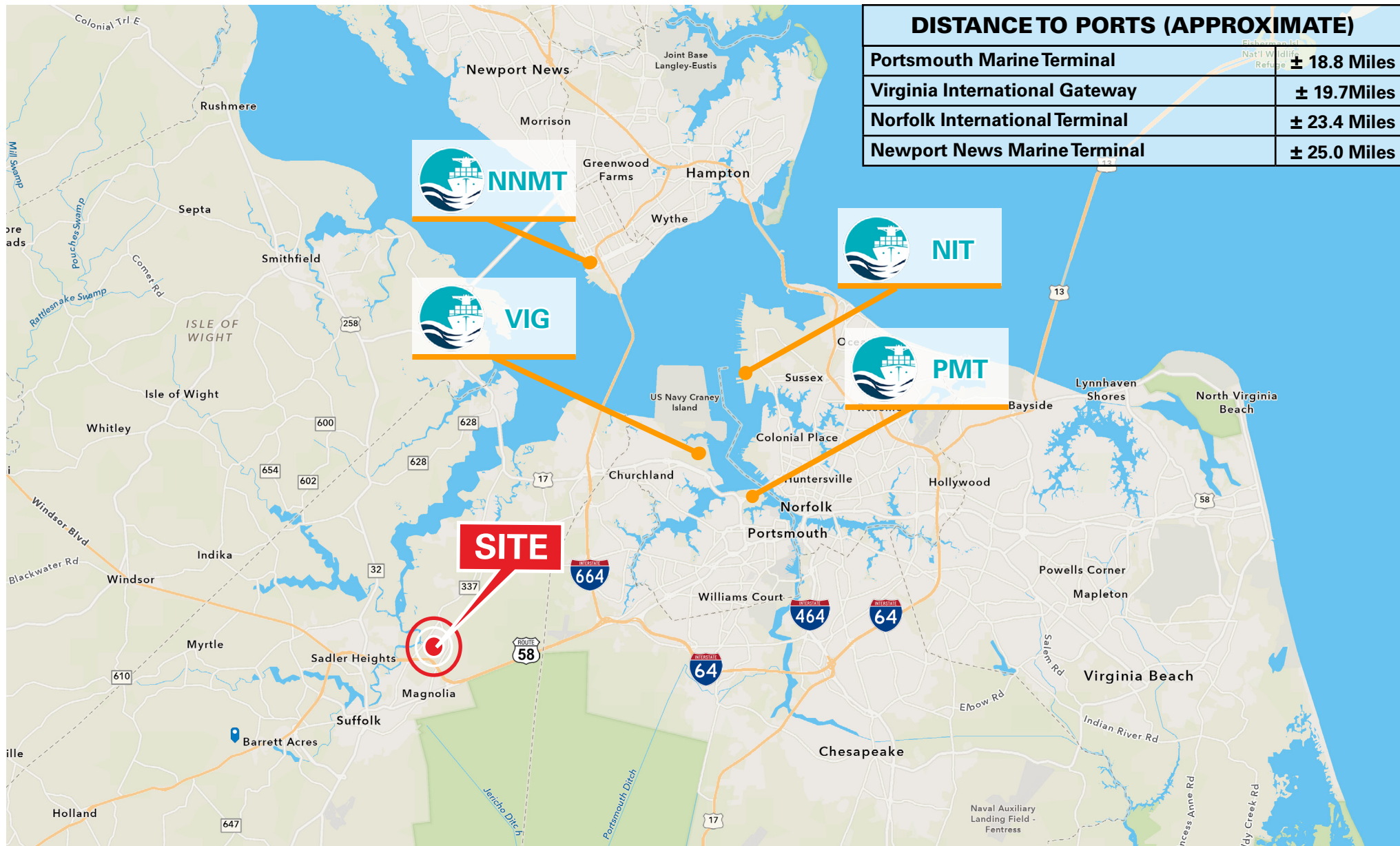

**FOR MORE INFORMATION:**  
**BOBBY BEASLEY, III, SIOR**  
757.640.8241  
[BobbyBeasley3@HarveyLindsay.com](mailto:BobbyBeasley3@HarveyLindsay.com)

**HARVEY LINDSAY**  
COMMERCIAL REAL ESTATE

The information contained herein has been obtained from sources believed to be reliable but is not warranted. We cannot be responsible for errors, omissions, withdrawal, or prior lease or sale.

# LOCATION AERIAL

1305 Progress Rd, Suffolk, VA



**FOR MORE INFORMATION:**  
**BOBBY BEASLEY, III, SIOR**  
757.640.8241  
[BobbyBeasley3@HarveyLindsay.com](mailto:BobbyBeasley3@HarveyLindsay.com)

**HARVEY LINDSAY**  
COMMERCIAL REAL ESTATE

The information contained herein has been obtained from sources believed to be reliable but is not warranted. We cannot be responsible for errors, omissions, withdrawal, or prior lease or sale.

# OFFICE FLOOR PLANS

1305 Progress Rd, Suffolk, VA

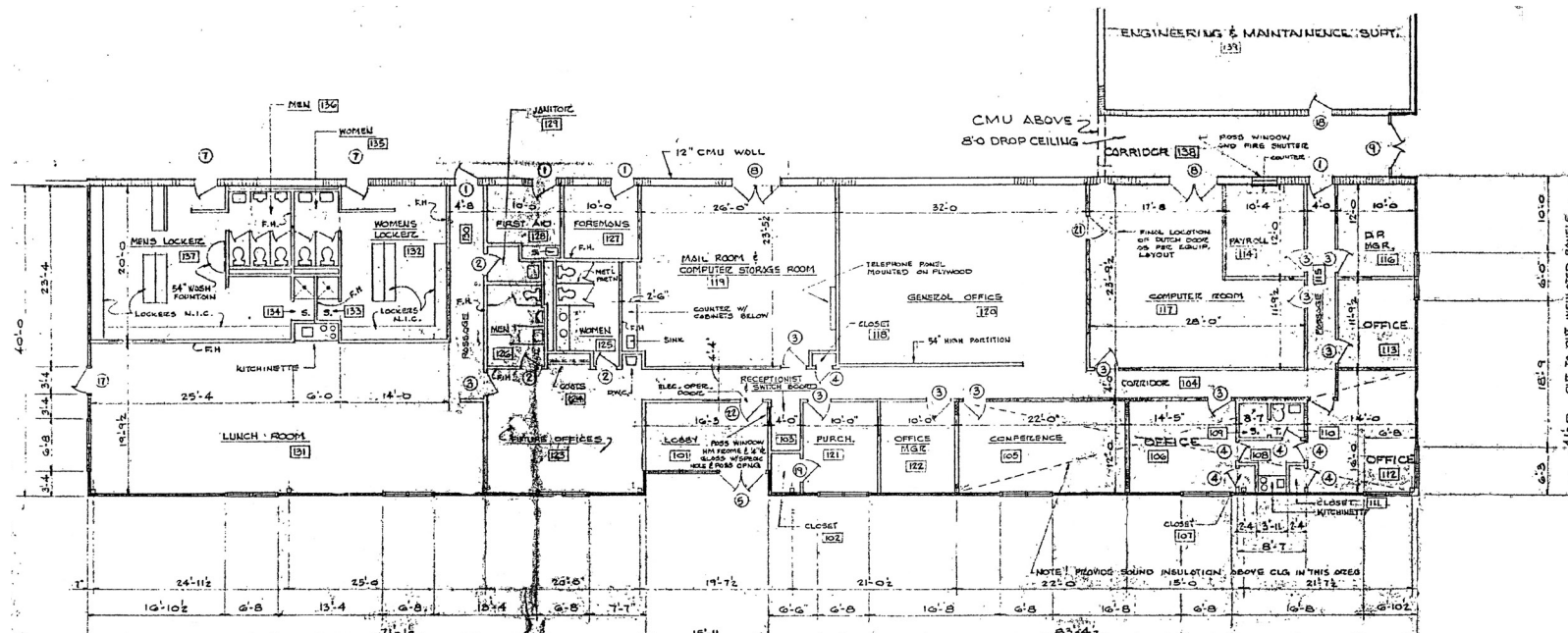
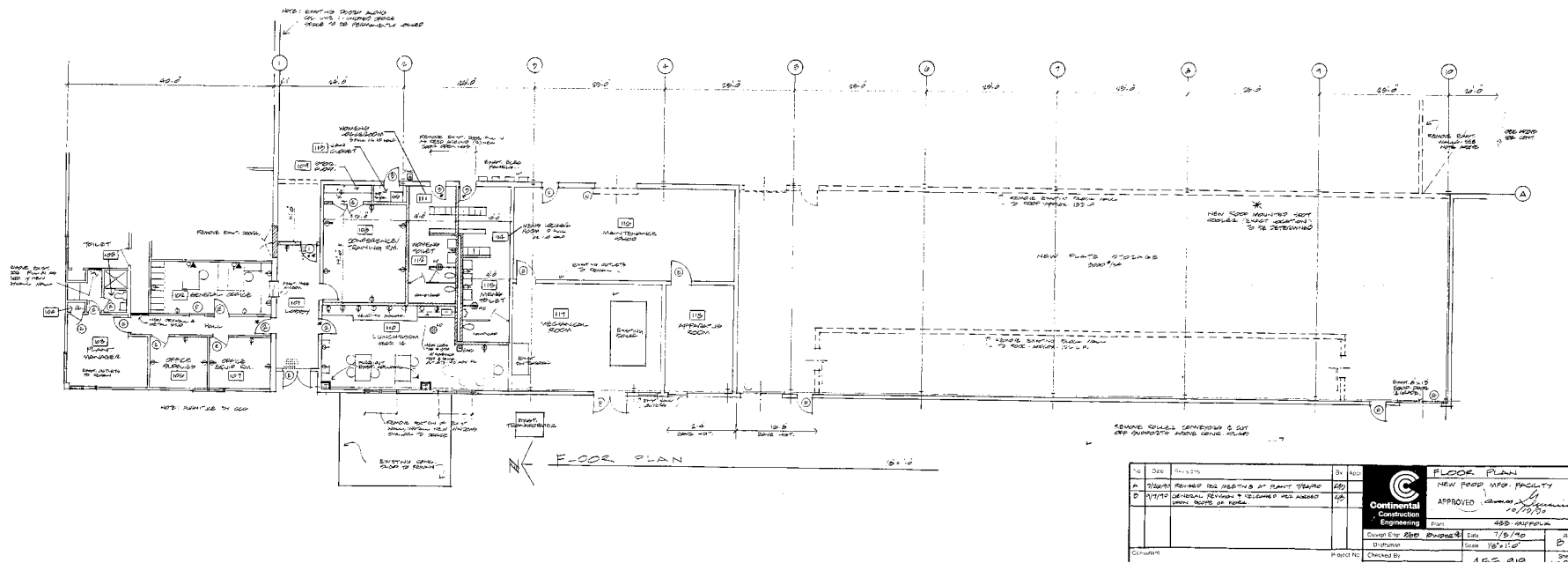

**FOR MORE INFORMATION:**  
**BOBBY BEASLEY, III, SIOR** | 757.640.8241 | [BobbyBeasley3@HarveyLindsay.com](mailto:BobbyBeasley3@HarveyLindsay.com)

**HARVEY LINDSAY**  
COMMERCIAL REAL ESTATE

The information contained herein has been obtained from sources believed to be reliable but is not warranted. We cannot be responsible for errors, omissions, withdrawal, or prior lease or sale.