

2216-2276 FOURTEEN MILE RD.
UNIT #2228
WARREN, MICHIGAN



**SIGNATURE
ASSOCIATES**
KNOW SIGNATURE | KNOW RESULTS

INDUSTRIAL FOR LEASE
3,600 Square Feet Available

MULTI-TENANT COMPLEX



PROPERTY FEATURES

- 3,600 square feet available
- 16' clear height
- (1) 12' x 14' grade level door
- Zoned M-2, Industrial
- Well-maintained multi-tenant complex
- Located on 3.10 acres
- Ample parking
- Easy access to I-696 and I-75
- 220 amps, 240 volts power
- Lease Rate: \$9.95/sq. ft. MG



For more information, please contact:

PAUL SAAD
(248) 359 0652
psaad@signatureassociates.com

PETER VANDERKAAY
(248) 359 3837
pvanderkaay@signatureassociates.com

SIGNATURE ASSOCIATES
One Towne Square, Suite 1200
Southfield, MI 48076
www.signatureassociates.com

2216-2276 Fourteen Mile Road – Warren, Michigan

Industrial For Lease

3,600
Square Feet
AVAILABLE

Site Plan

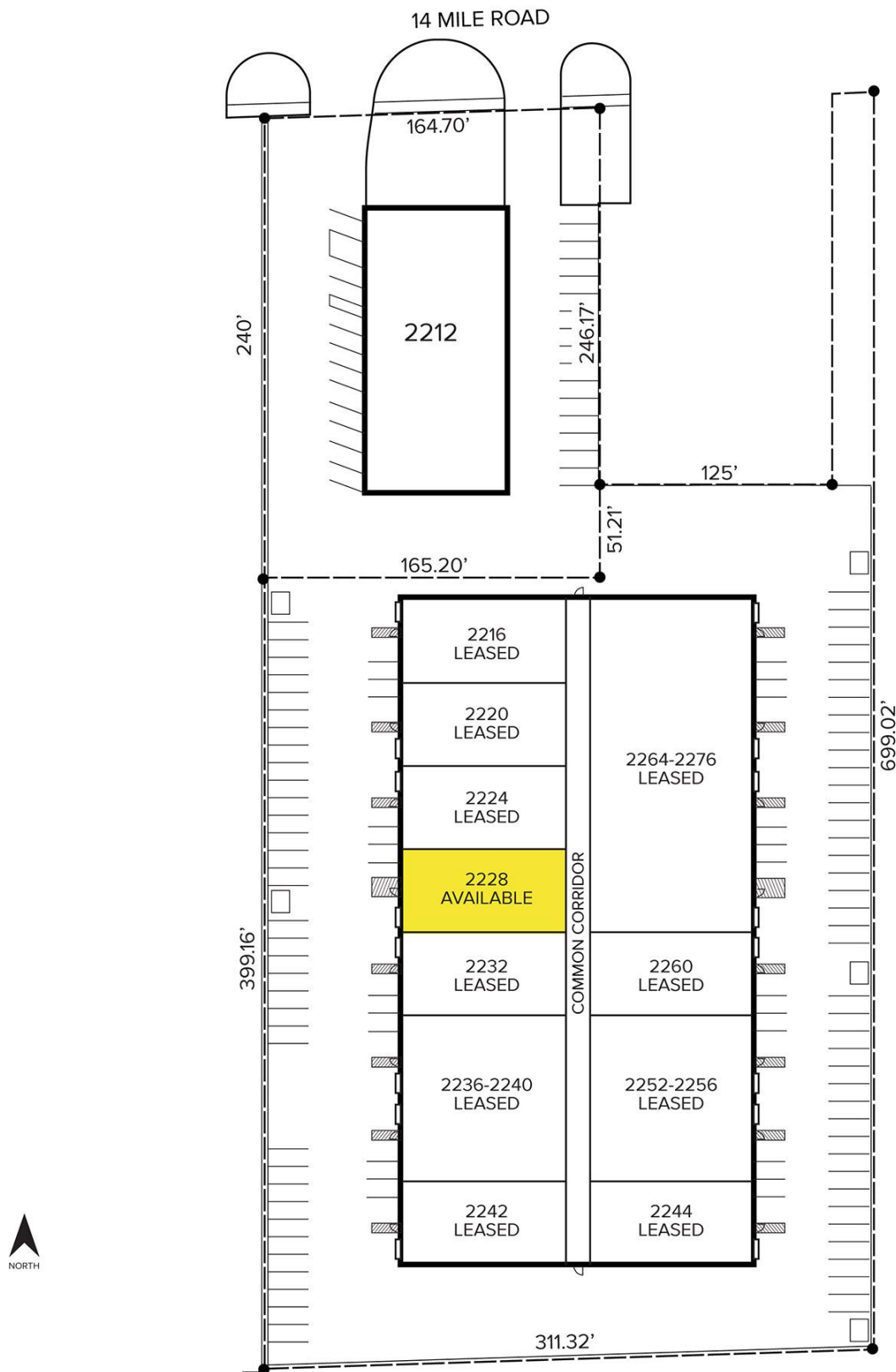

For more information, please contact:

PAUL SAAD
(248) 359 0652
psaad@signatureassociates.com

PETER VANDERKAAY
(248) 359 3837
pvanderkaay@signatureassociates.com

SIGNATURE ASSOCIATES
One Towne Square, Suite 1200
Southfield, MI 48076
www.signatureassociates.com

2216-2276 Fourteen Mile Road – Warren, Michigan

Industrial For Lease

3,600
Square Feet
AVAILABLE

Aerial



For more information, please contact:

PAUL SAAD
(248) 359 0652
psaad@signatureassociates.com

PETER VANDERKAAY
(248) 359 3837
pvanderkaay@signatureassociates.com

SIGNATURE ASSOCIATES
One Towne Square, Suite 1200
Southfield, MI 48076
www.signatureassociates.com

Information is subject to verification and no liability for errors or omissions is assumed. Price is subject to change and listing withdrawal.