

FOR LEASE

249 St Catharines Street

Smithville, Ontario



HOME

HIGHLIGHTS

SURVEY

LOCATION

For more information, please contact:

Fraser Vrenjak
Sales Representative
+1 519 804 4355
fraser.vrenjak@cushwakewr.com

Ryan Kaitting
Associate Vice President
+1 519 804 4339
ryan.kaitting@cushwakewr.com

cushwakewr.com

Property Highlights

- Village Square Mall is the major retail node of Smithville
- Grocery anchored shopping centre with multiple retail/office availabilities
- Total of 111,035 SF GLA
- Excellent parking, traffic, and exposure along with prominent signage availabilities
- Co-tenants currently include Foodland, Home Hardware, Tim Horton's, etc.
- Zoned as C4 (Commercial Plaza)

[Click here to view the property video.](#)

Property Details

Suite Number	Square Footage	Price	TMI
Suite 2	2,165 SF	\$13.00 PSF	\$5.45 PSF
Suite 18-19	5,214 SF	\$14.00 PSF	\$5.45 PSF
Suite 21	1,468 SF	\$11.00 PSF	\$5.45 PSF

Criteria	1 KM	3 KM	5 KM
Population	1,489	5,572	7,195
Daytime Population	252	776	1,133
Household Spending	\$76,825	\$91,828	\$95,282
Household Income	\$81,246	\$97,111	\$100,770

For more information, please contact:

Fraser Vrenjak
Sales Representative
+1 519 804 4355
fraser.vrenjak@cushwakewr.com

Ryan Kaitting
Associate Vice President
+1 519 804 4339
ryan.kaitting@cushwakewr.com

HOME

HIGHLIGHTS

SURVEY

LOCATION

Survey

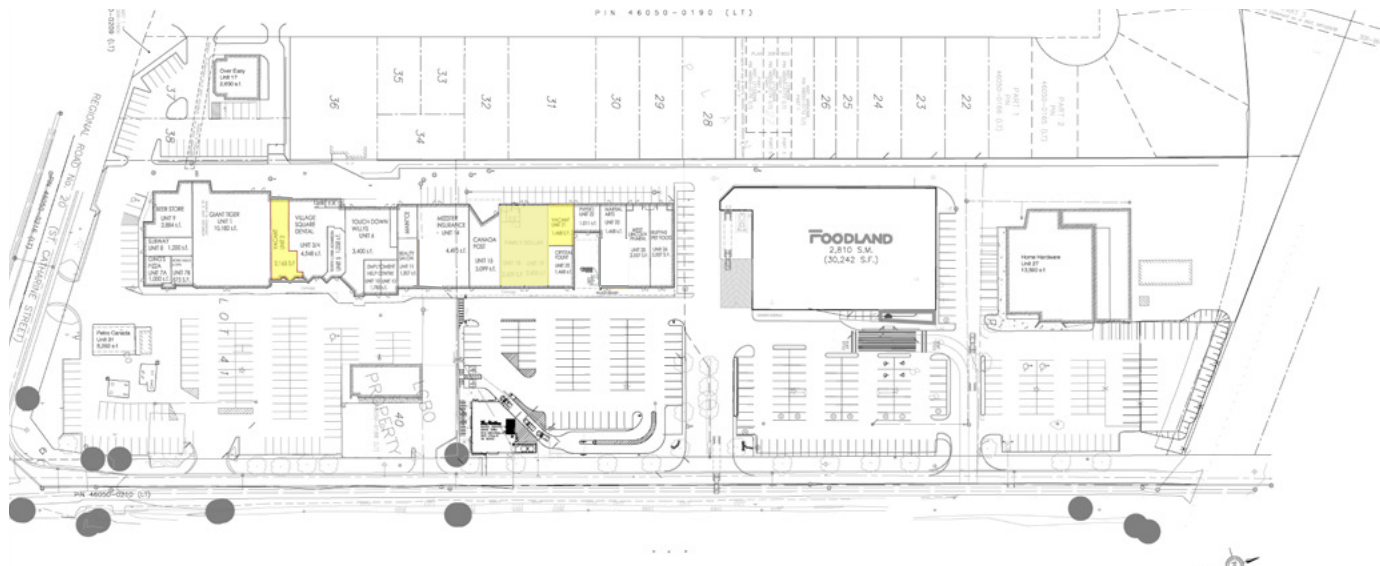

For more information, please contact:

Fraser Vrenjak
Sales Representative
+1 519 804 4355
fraser.vrenjak@cushwakewr.com

Ryan Kaitting
Associate Vice President
+1 519 804 4339
ryan.kaitting@cushwakewr.com

Location

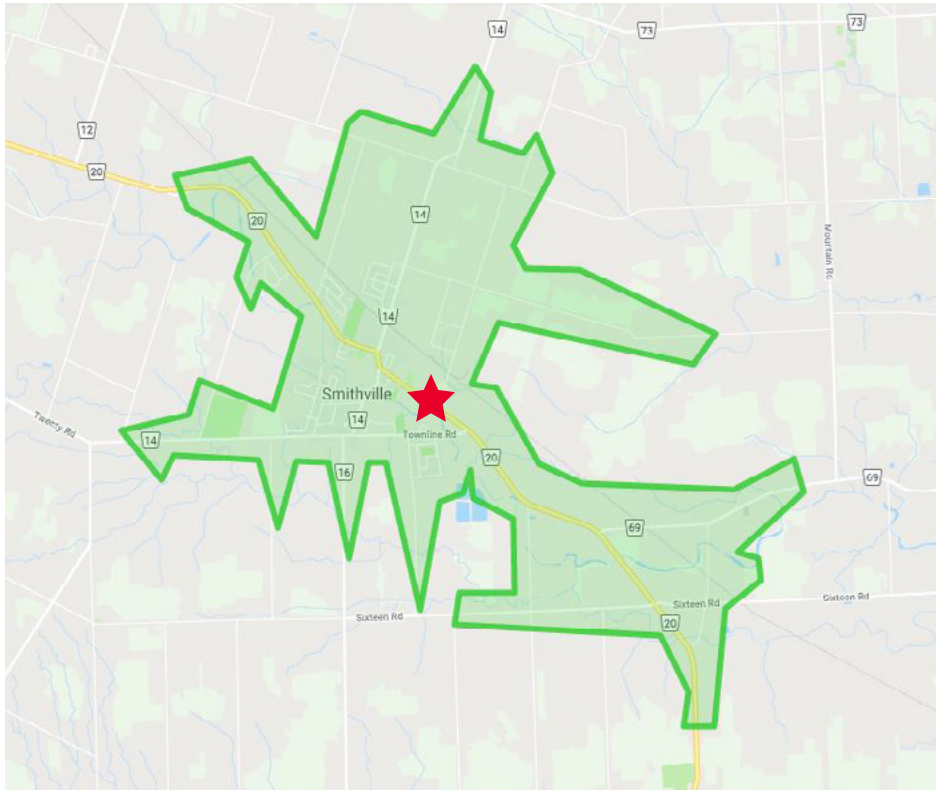

10-minute drive time



Aerial

For more information, please contact:

Fraser Vrenjak
Sales Representative
+1 519 804 4355
fraser.vrenjak@cushwakewr.com

Ryan Kaitting
Associate Vice President
+1 519 804 4339
ryan.kaitting@cushwakewr.com