



Rendering

185

**BROADWAY
BROOKLYN, NYC**

PROMINENT WILLIAMSBURG CORNER | 1,290 SF

185 Broadway

Northeast Corner of Driggs Avenue

Available Space

Ground Level	Frontage	Possession	Rent
Unit 1 (corner): 1,290 sf	74'-0" wraparound	Immediate	Upon request

Comments

- Ideal for Café, Fitness and other dry retail uses
- Pedestrian traffic all day from **J M Z** subway station at Marcy Avenue 2 blocks to the east
- Prominent corner location in 50,000 sq. ft. re-developed building anchored by co-working space provider The Yard

Area Tenants

Peter Lugers, Weylin B. Seymour's event venue, April Nicole Pilates, and Dermatology Specialists in this underserved trade area on the border of North and South Williamsburg

By the Numbers

Annual Subway Ridership

2,540,327+

2022 Annual - Marcy Ave. Station

Household Income

\$114,305

2023 Average

Retail Businesses

1,015+

1 Mile Radius

Floor Plan

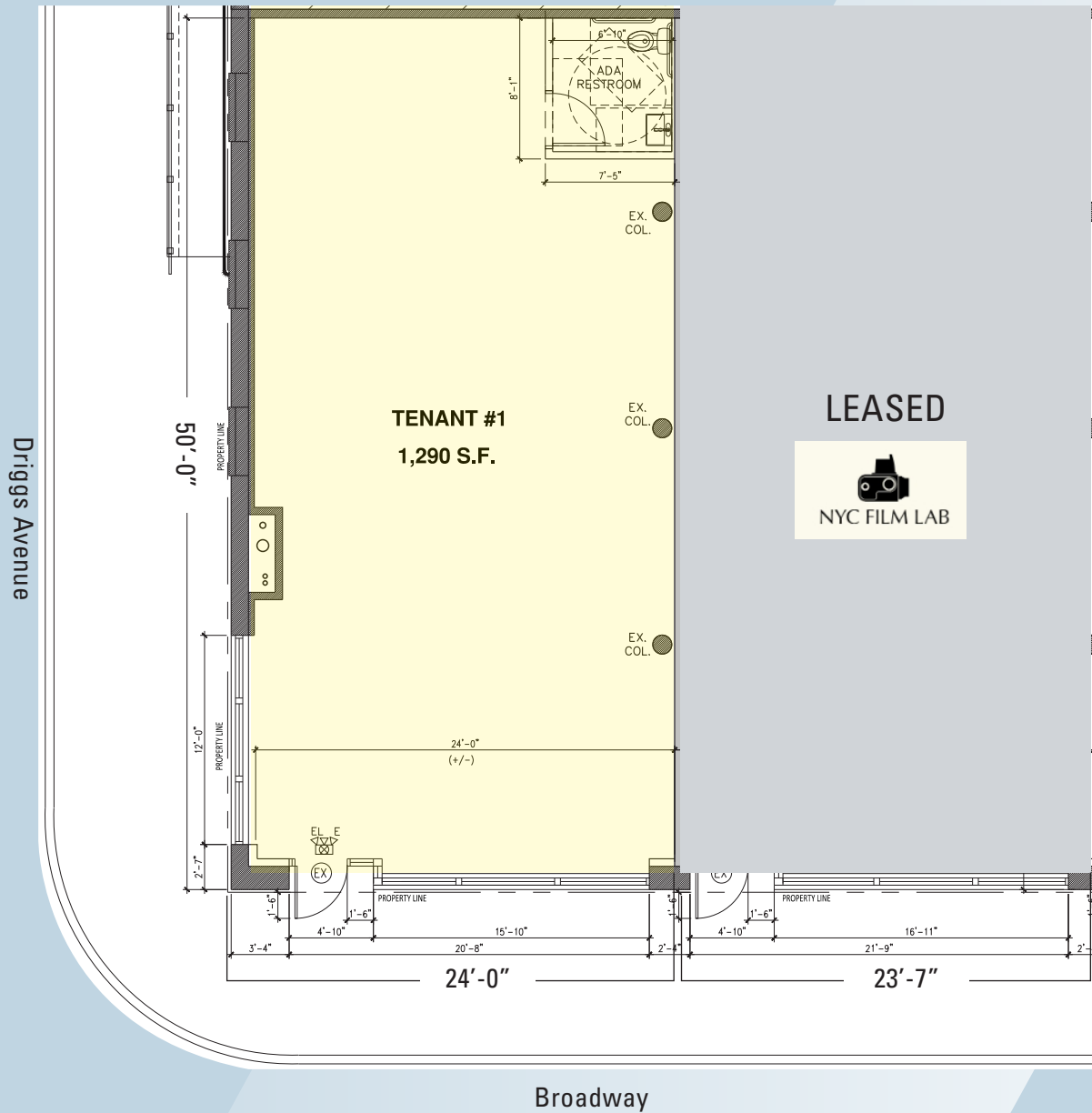

Area Tenants



Peter Luger Steak House



Weylin

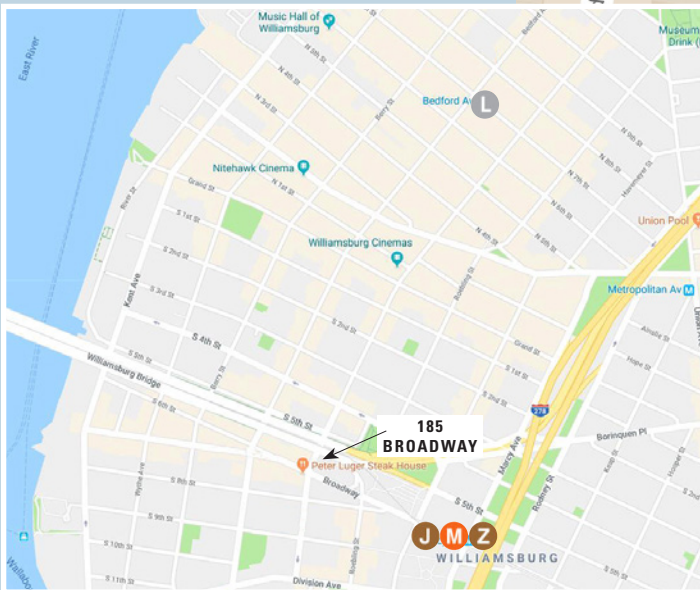



For further information and/or inspection contact:

Mark Tergesen

Licensed Assoc. Real Estate Broker
212.400.9528
mt@absre.com

Ben Waller

Licensed Assoc. Real Estate Broker
212.400.9515
bwaller@absre.com

Anthony Diorio

Licensed Real Estate Salesperson
518.894.1605
adiorio@absre.com

ABS Partners Real Estate • 200 Park Avenue South, 10th Floor, New York, NY 10003 • 212.400.6060 • www.absre.com