

134 Biesterfield Road

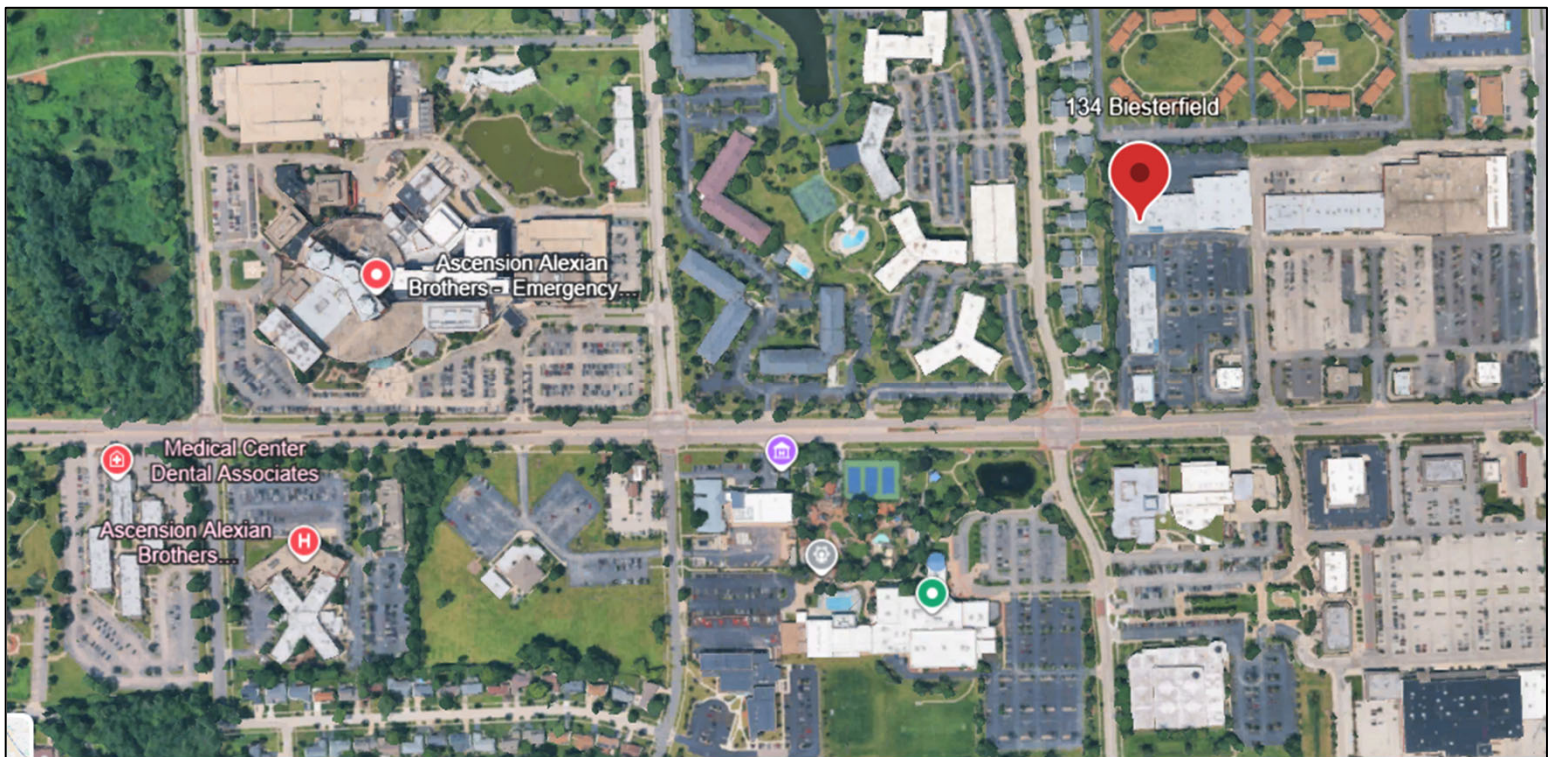

- **Location:** 134 Biesterfield Road
Elk Grove Village, IL 60007
- **Space Available:** 2,000 Sq. Ft.
- **Total Building Size:** 67,282
- **Land Area:** 7.80 Acres +/-
- **Parking:** 351 Stalls
- **Comments:** Adjacent to Jewel-Osco
End Cap
- **Net Lease Price:** Negotiable
- **Real Estate Taxes:** \$7.30 Per Sq. Ft.
- **CAM:** \$3.40 Per Sq. Ft.
- **Escalation:** Negotiable
- **Lease Term:** Negotiable

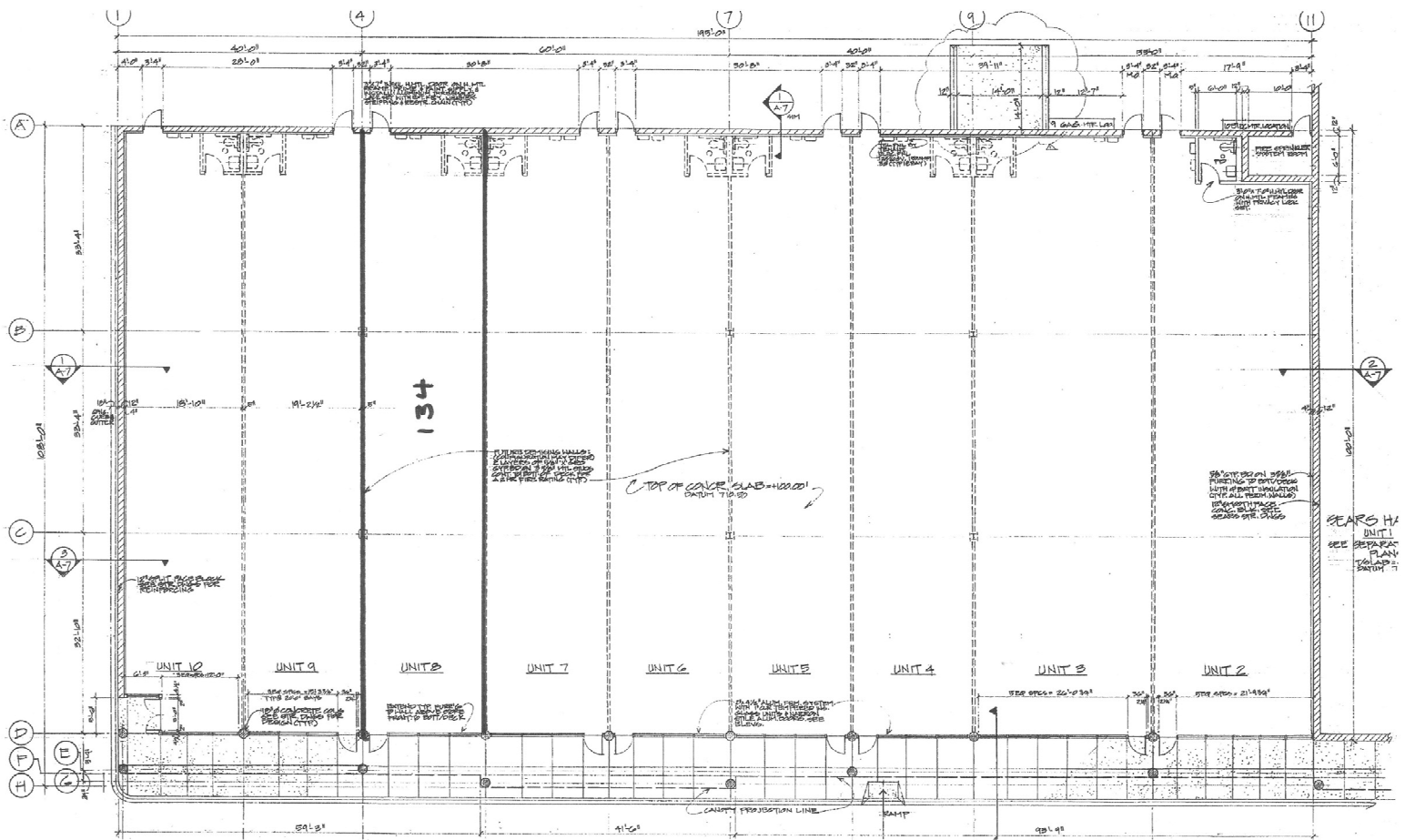

All information herein is sources deemed reliable but not guaranteed accurate, subject to errors, omissions, and to change of price and term, prior to sale or lease, all without notice.

Contact Information • Mario Gullo • (847) 439-4400 Ext. 106 • mgullo@georgegullo.com

2050 E. Higgins Road • Elk Grove Village, IL 60007