

8105 ONEIDA STREET

COMMERCE CITY, COLORADO 80022

FOR LEASE
3.7 ACRES
NEW CONSTRUCTION

TRUCK MAINTENANCE BUILDING

PROPOSED DEVELOPMENT

DRIVE-IN DOORS



ARCHITECTURAL RENDERING

Q4 2025 DELIVERY DATE

 **LEE & ASSOCIATES**
COMMERCIAL REAL ESTATE SERVICES

8105 ONEIDA STREET

COMMERCE CITY, COLORADO 80022

FOR LEASE
3.7 ACRES
NEW CONSTRUCTION

BUILDING ATTRIBUTES

SITE SIZE	3.7 Acres
BUILDING SIZE	7,750 SF
WAREHOUSE	6,400 SF
OFFICE	1,350 SF
ZONING	I-2, Heavy Industrial
CLEAR HEIGHT	16' - 18'
LOADING	4 Drive-In Doors (12' x 14')
YEAR BUILT	2025 (Proposed)
CITY/COUNTY	Commerce City/Adams
LEASE RATE	Call Brokers



8105 ONEIDA STREET

COMMERCE CITY, COLORADO 80022

FOR LEASE
3.7 ACRES
NEW CONSTRUCTION

SITE PLAN

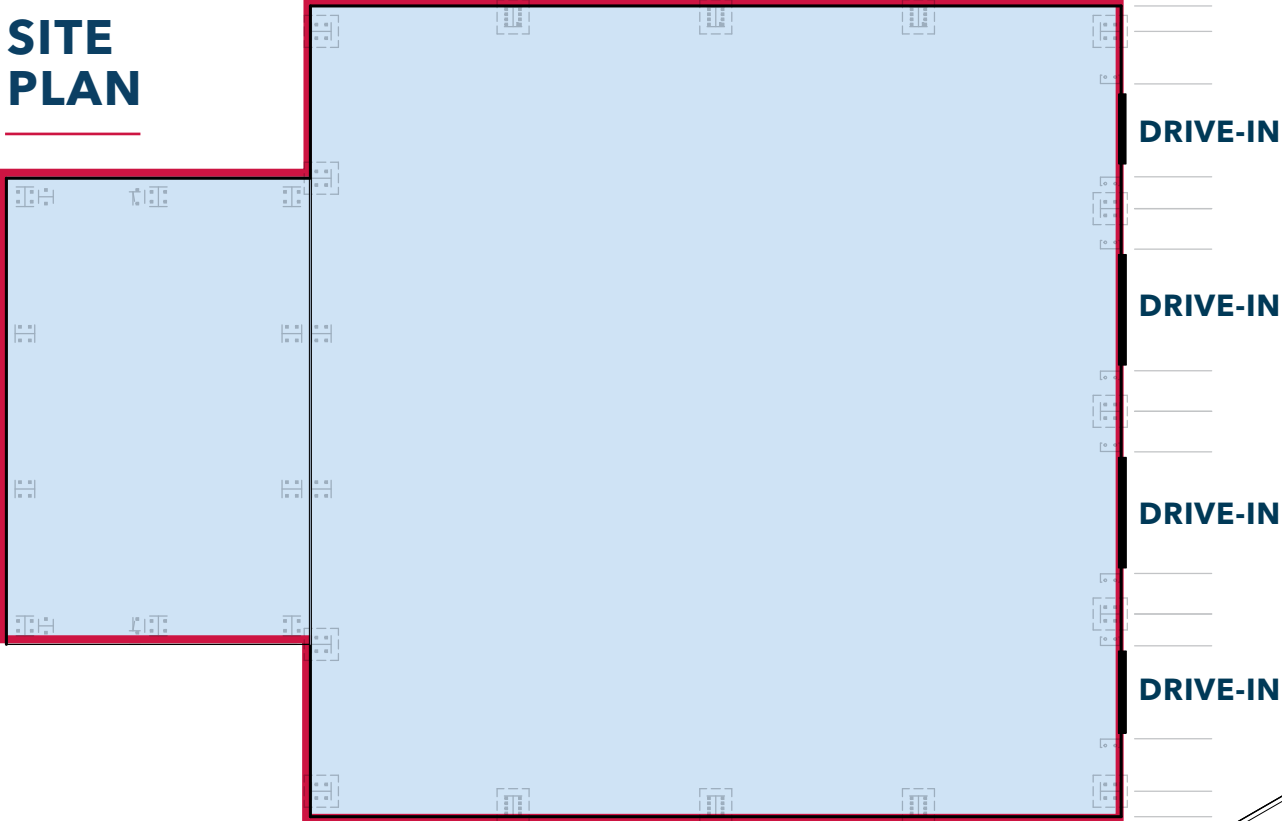

3D ELEVATION

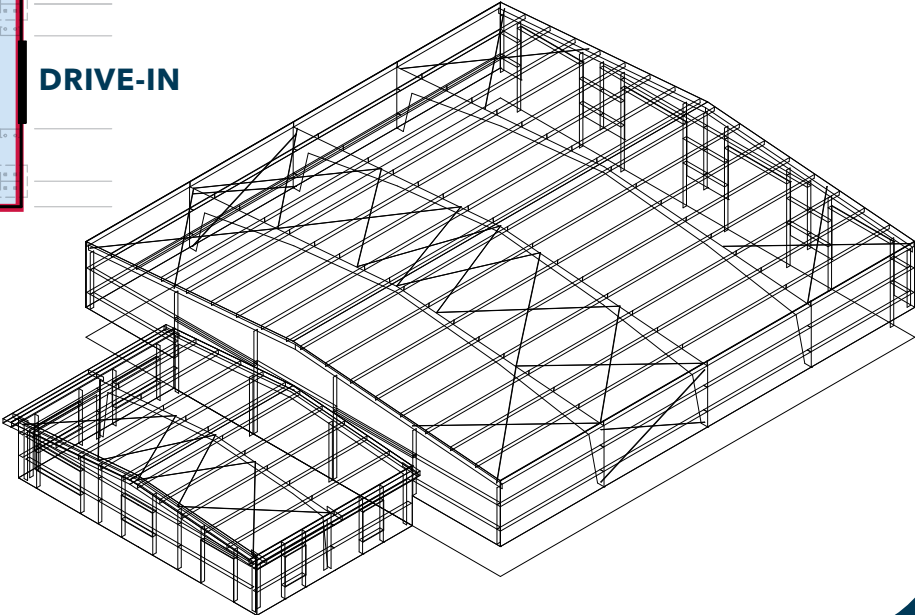

8105 ONEIDA STREET

COMMERCE CITY, COLORADO 80022

FOR LEASE
3.7 ACRES
NEW CONSTRUCTION



CALL BROKERS FOR DETAILS

MATT NORA PRINCIPAL
mnora@lee-associates.com
C 720.295.4353

KIRK VANINO PRINCIPAL
kvanino@lee-associates.com
C 303.250.4760

 **LEE &
ASSOCIATES**
COMMERCIAL REAL ESTATE SERVICES