

FOR SUBLEASE

4350 EAST WEST HWY, STE 350
BETHESDA, MD



3D Tour!



AVAILABLE TERMS

- 100 - 3,010 SF
- \$35.50 PSF
- Sublease through May 31, 2028
- Furniture negotiable

[CLICK FOR 3D TOUR](#)

FLOOR PLAN

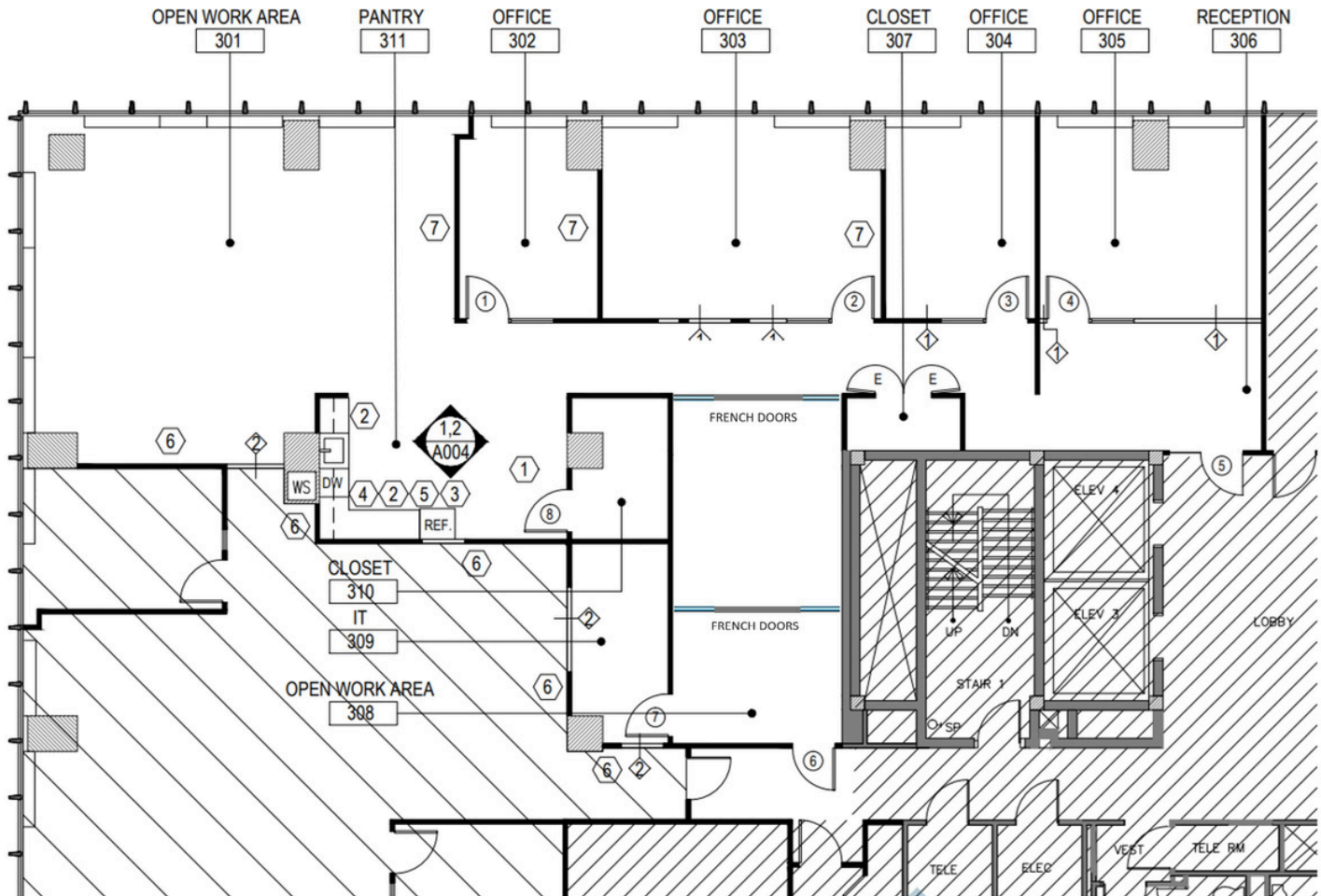

- 1 kitchen area
- 2 closet spaces
- 2 open work areas
- 4 office spaces

FOR MORE INFORMATION PLEASE CONTACT

FLETCHER GILL

Phone: 202.735.5382

fletcher.gill@thegenaugroup.com

4350 EAST WEST HWY, STE 350

BETHESDA, MD

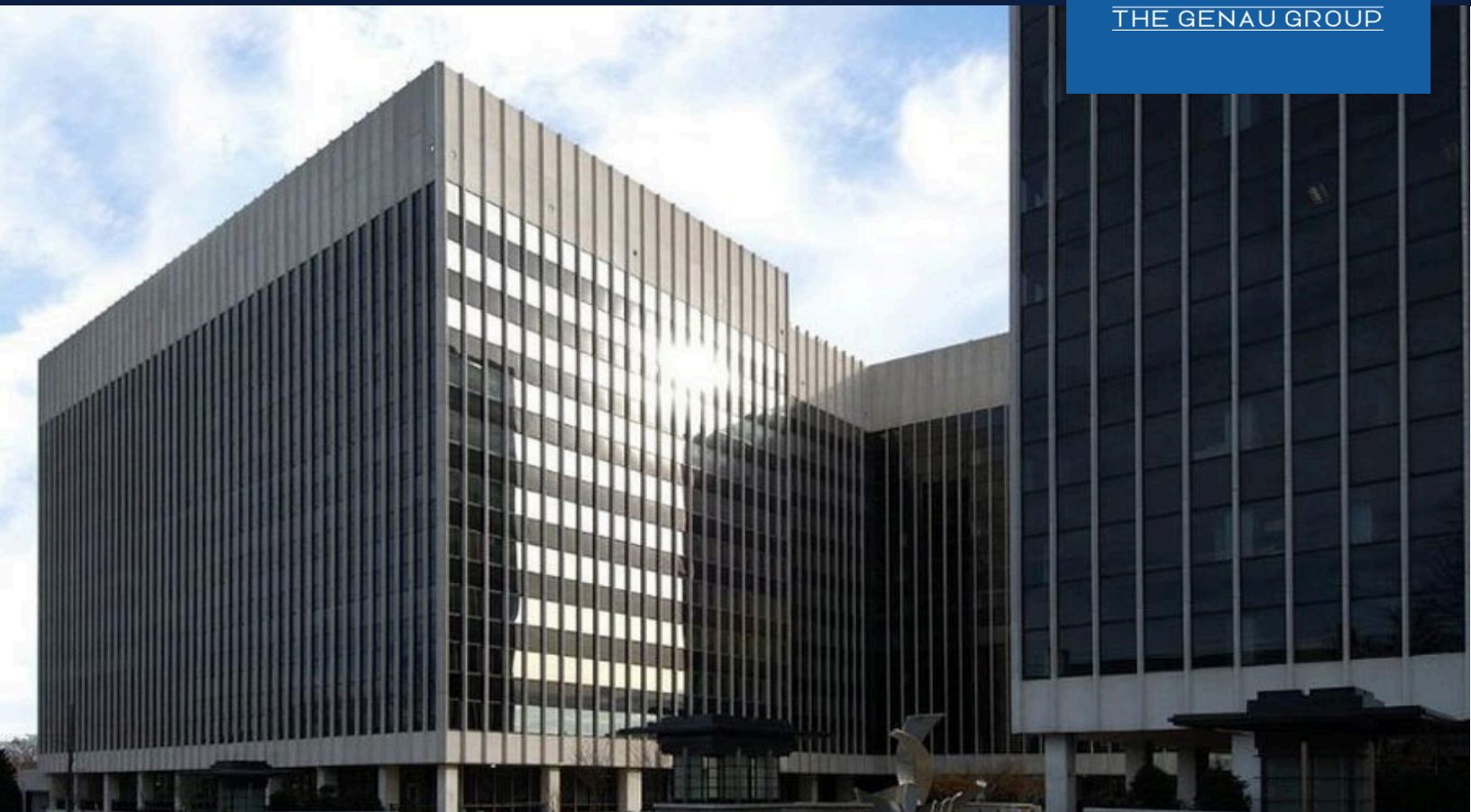

SPACE HIGHLIGHTS

- On-site café and fitness center
- Underground parking garage
- Large work areas
- Optional fully furnished
- Private office spaces
- 2 sides of glass w/ great lighting

FOR MORE INFORMATION PLEASE CONTACT

FLETCHER GILL

Phone: 202.735.5382

fletcher.gill@thegenaugroup.com

The above information was obtained from sources we deem to be reliable. However, we have not verified its accuracy, and make no warranties thereof. It is submitted subject to the possibility of errors and omissions, as well as prior leasing and change of price. Furthermore, it may be withdrawn with or without notice without penalty.

4350 East West Hwy, Bethesda, MD

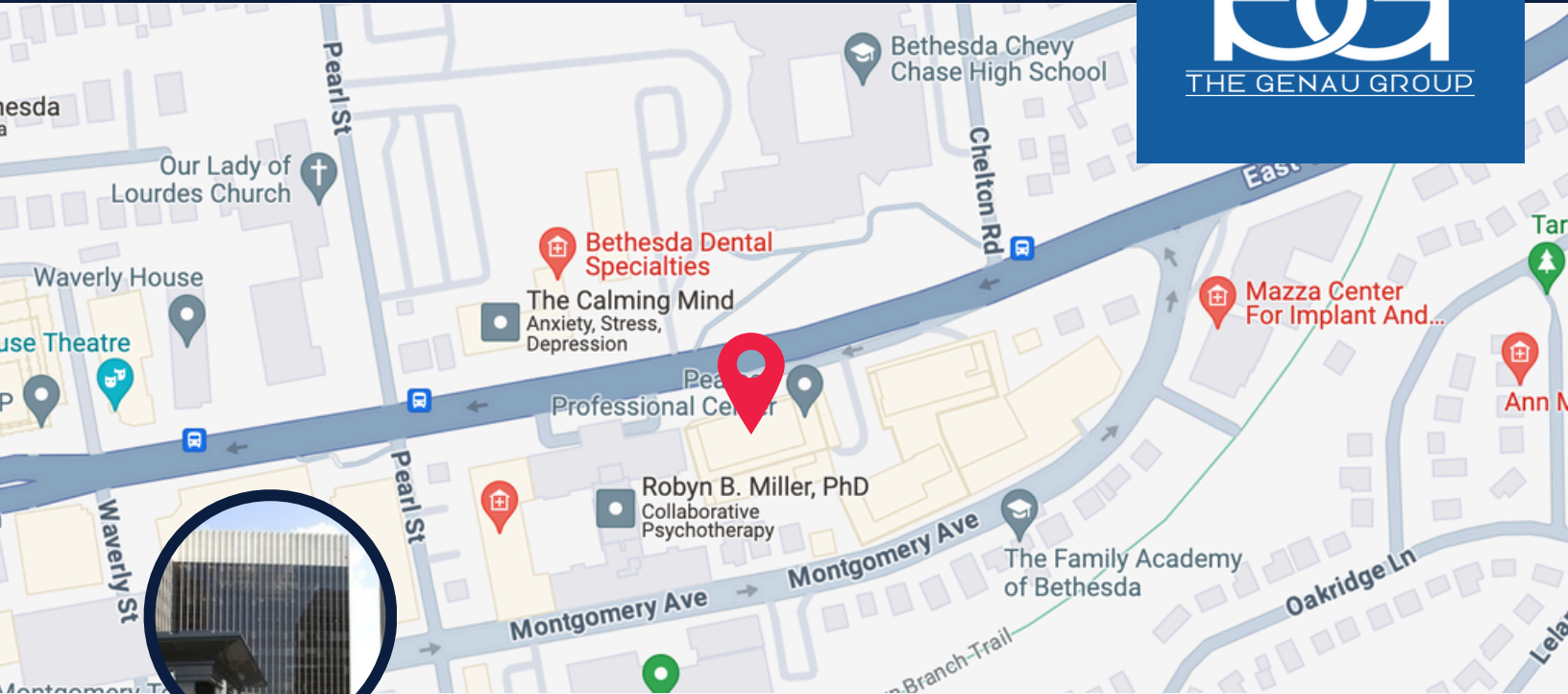

NEARBY AMENITIES



PARKING Parking lot on site

TRANSIT/METRO 7 min walk to Bethesda Metro Station
1 min walk to East West Hwy & Chelton Rd WMATA

WALK SCORE Walker's Paradise (93)

The above information was obtained from sources we deem to be reliable. However, we have not verified its accuracy, and make no warranties thereof. It is submitted subject to the possibility of errors and omissions, as well as prior leasing and change of price. Furthermore, it may be withdrawn with or without notice without penalty.

4350 East West Hwy, Bethesda, MD



The above information was obtained from sources we deem to be reliable. However, we have not verified its accuracy, and make no warranties thereof. It is submitted subject to the possibility of errors and omissions, as well as prior leasing and change of price. Furthermore, it may be withdrawn with or without notice without penalty.

4350 East West Hwy, Bethesda, MD



The above information was obtained from sources we deem to be reliable. However, we have not verified its accuracy, and make no warranties thereof. It is submitted subject to the possibility of errors and omissions, as well as prior leasing and change of price. Furthermore, it may be withdrawn with or without notice without penalty.

4350 East West Hwy, Bethesda, MD



The above information was obtained from sources we deem to be reliable. However, we have not verified its accuracy, and make no warranties thereof. It is submitted subject to the possibility of errors and omissions, as well as prior leasing and change of price. Furthermore, it may be withdrawn with or without notice without penalty.

4350 East West Hwy, Bethesda, MD



The above information was obtained from sources we deem to be reliable. However, we have not verified its accuracy, and make no warranties thereof. It is submitted subject to the possibility of errors and omissions, as well as prior leasing and change of price. Furthermore, it may be withdrawn with or without notice without penalty.

4350 East West Hwy, Bethesda, MD



The above information was obtained from sources we deem to be reliable. However, we have not verified its accuracy, and make no warranties thereof. It is submitted subject to the possibility of errors and omissions, as well as prior leasing and change of price. Furthermore, it may be withdrawn with or without notice without penalty.

4350 East West Hwy, Bethesda, MD

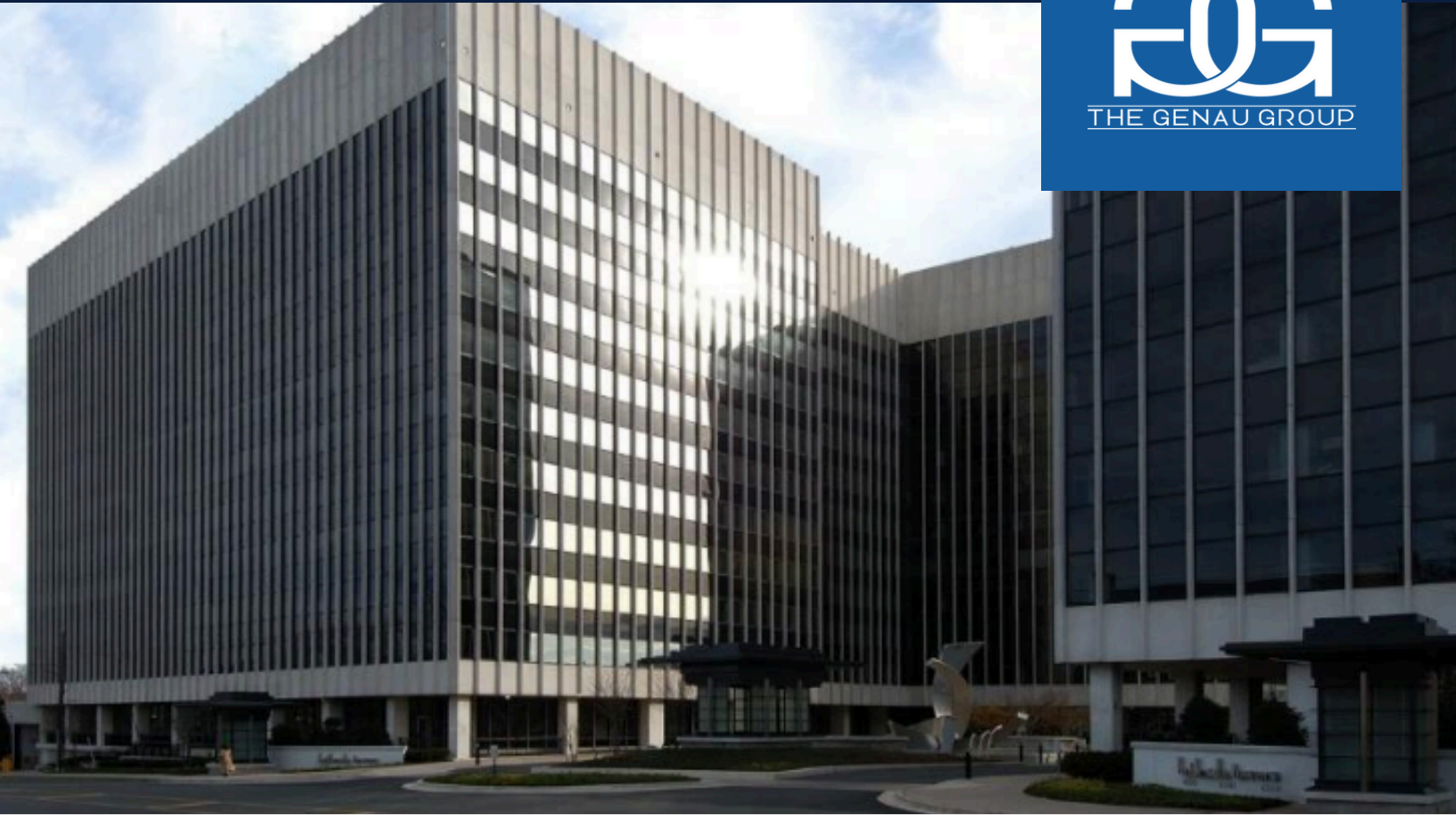

PLEASE **CONTACT** THE LISTING TEAM FOR INFORMATION



Fletcher Gill, Managing Broker

Phone: 202.735.5382

fletcherhill@thegenaugroup.com

(202) 735-5382 | Information@TheGenauGroup.com

The Genau Group Realty Advisors 1054 31st Street NW, Suite 540