

FOR LEASE



Industrial/Manufacturing Space

5710 Old Concord Road | Charlotte, NC





HIGHLIGHTS

Address:	5710 Old Concord Road Charlotte, NC 28213
Building Size:	163,891 SF
Available:	22,000 SF to 163,891 SF
Land:	9.36 Acres
Type:	Industrial/Manufacturing Space
Clear Height:	19'1 to 23'5"
Zoning:	ML-2
Dock Doors:	15 (8'x8')
Drive In Door:	1 (6'x9')
Lighting:	LED with motion sensors
Lease Rate:	Please call for lease rates



FLOOR PLAN

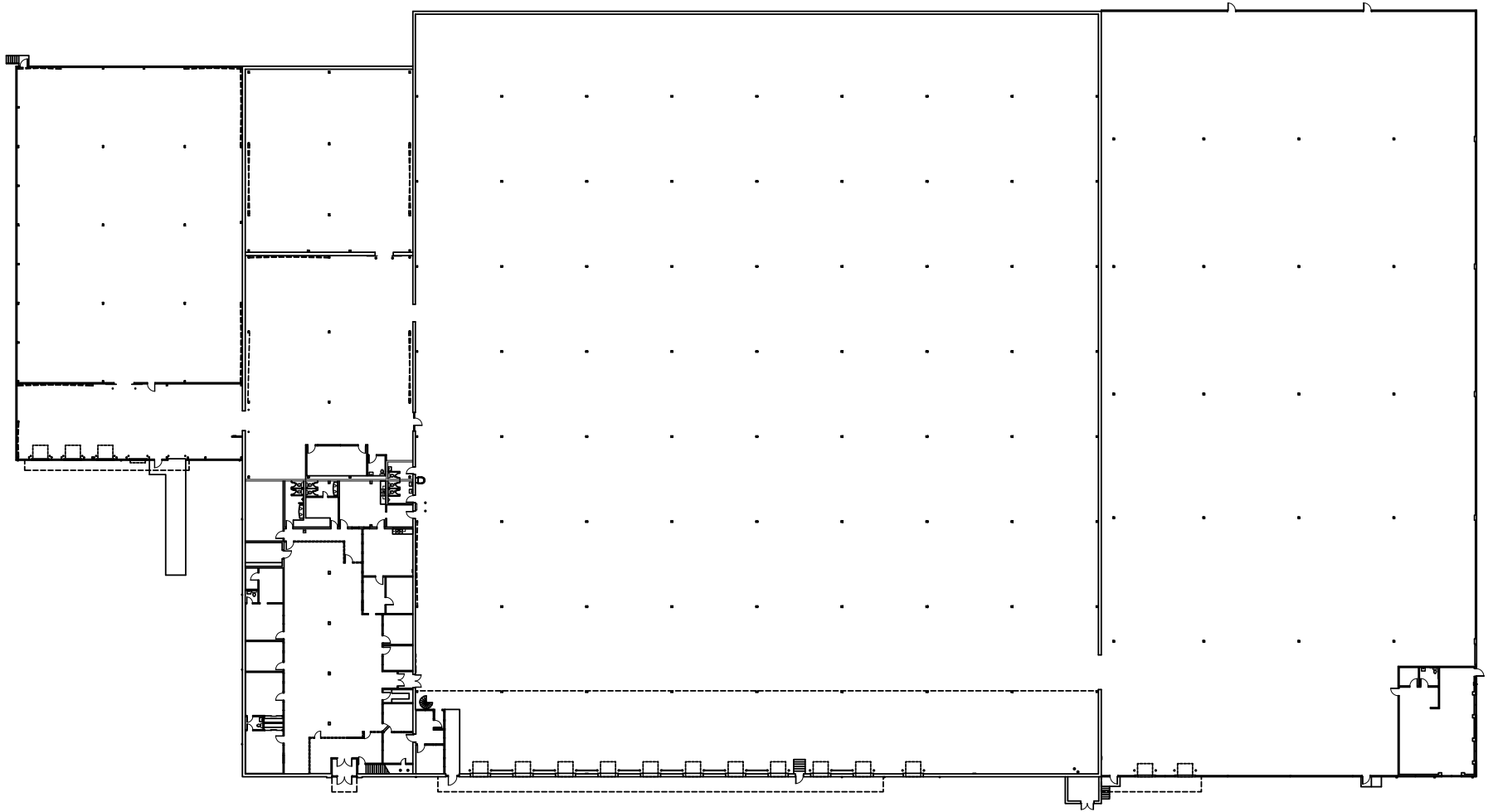

163,891 SF | AVAILABLE: 22,000 SF - 163,891 SF

SURROUNDING AREA



NEARBY AREA



DRIVE TIMES



Drive Times in North Carolina

I-85	8 Min
I-77	14 Min
I-485	22 Min
I-40	49 Min
I-26	1 Hr 43 Min
I-95	2 Hr 9 Min
<hr/>	
Uptown Charlotte	20 Min
Charlotte Douglas Airport	27 Min
Asheville, NC	2 Hr 11 Min
Raleigh, NC	2 Hr 47 Min
Wilmington, NC	3 Hr 33 Min

Drive Times to Major U.S. Cities

Columbia, SC	1 Hr 51 Min
Augusta, GA	2 Hr 46 Min
Raleigh, NC	2 Hr 50 Min
Charleston, SC	3 Hr 54 Min
Knoxville, TN	3 Hr 58 Min
Savannah, GA	4 Hr 3 Min
Richmond, VA	4 Hr 19 Min
Atlanta, GA	4 Hr 30 Min
Norfolk, VA	5 Hr 13 Min
Jacksonville, FL	5 Hr 51 Min
Birmingham, AL	6 Hr 13 Min
Washington DC	6 Hr 20 Min
Nashville, TN	6 Hr 55 Min
Baltimore, MD	7 Hr 15 Min
Pittsburgh, PA	7 Hr 35 Min
Cincinnati, OH	7 Hr 38 Min
Orlando, FL	8 Hr 15 Min
Philadelphia, PA	8 Hr 42 Min

