



11,510 SF FREESTANDING INDUSTRIAL FACILITY
FOR LEASE 1168 N. GROVE ST.
ANAHEIM | CA



FENCED YARD



1 EXTERIOR DOCK HIGH LOADING W/ LEVELER



1,957 SF NEWLY REFURBISHED OFFICE

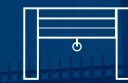

2 OVERSIZED GL DOORS (12 X 12) & (12 X 14)

FOR MORE INFORMATION, CONTACT:



NATE ORTEGA
VICE PRESIDENT
P: 562.207.3307
nortega@daumcre.com
CA DRE License #01989242



CASEY MUNGO
E.V.P. | PRINCIPAL
P: 562.207.3307
cmungo@daumcre.com
CA DRE License #01490279



DENNIS HOLT
E.V.P.
P: 949.242.1714
dholt@daumcre.com
CA DRE License #01948978



D/AQ Corp. #01129558, Maps Courtesy ©Google & ©Microsoft. Although all information is furnished regarding for sale, rental or financing from sources deemed reliable, such information has not been verified and no express representation is made nor is any to be implied as to the accuracy thereof, and it is submitted subject to errors, omissions, changes of price, rental or other conditions, prior sale, lease or financing, or withdrawal without notice.

11,510 SF
FREESTANDING
INDUSTRIAL
BUILDING

FOR LEASE
1168 N. GROVE ST.
ANAHEIM | CA

N. GROVE ST.



PROPERTY HIGHLIGHTS

- 11,510 SF Freestanding Industrial Facility on 27,354 SF Lot
- 1,957 SF of Newly Refurbished Office
- 1 Exterior Dock High Loading w/ Leveler
- 2 Oversized GL Doors (12 x 12) & (12 x14)
- 400 Amps 120/208 Voltage
- Newly Renovated Offices
- Efficient LED Warehouse Lighting
- New Drought Tolerant Landscape
- New Asphalt & Striped Parking
- New Exterior Paint
- Warehouse Skylights
- 15-16 ft Clear Height
- Fenced Yard
- Warehouse Floor Drains
- **TURN KEY FACILITY!**

ABOUT
THE
PROPERTY

D/AQ Corp. #01129558. Maps Courtesy ©Google & ©Microsoft. Although all information is furnished regarding for sale, rental or financing from sources deemed reliable, such information has not been verified and no express representation is made nor is any to be implied as to the accuracy thereof, and it is submitted subject to errors, omissions, changes of price, rental or other conditions, prior sale, lease or financing, or withdrawal without notice.

11,510 SF
FREESTANDING
INDUSTRIAL
BUILDING

FOR LEASE
1168 N. GROVE ST.
ANAHEIM | CA

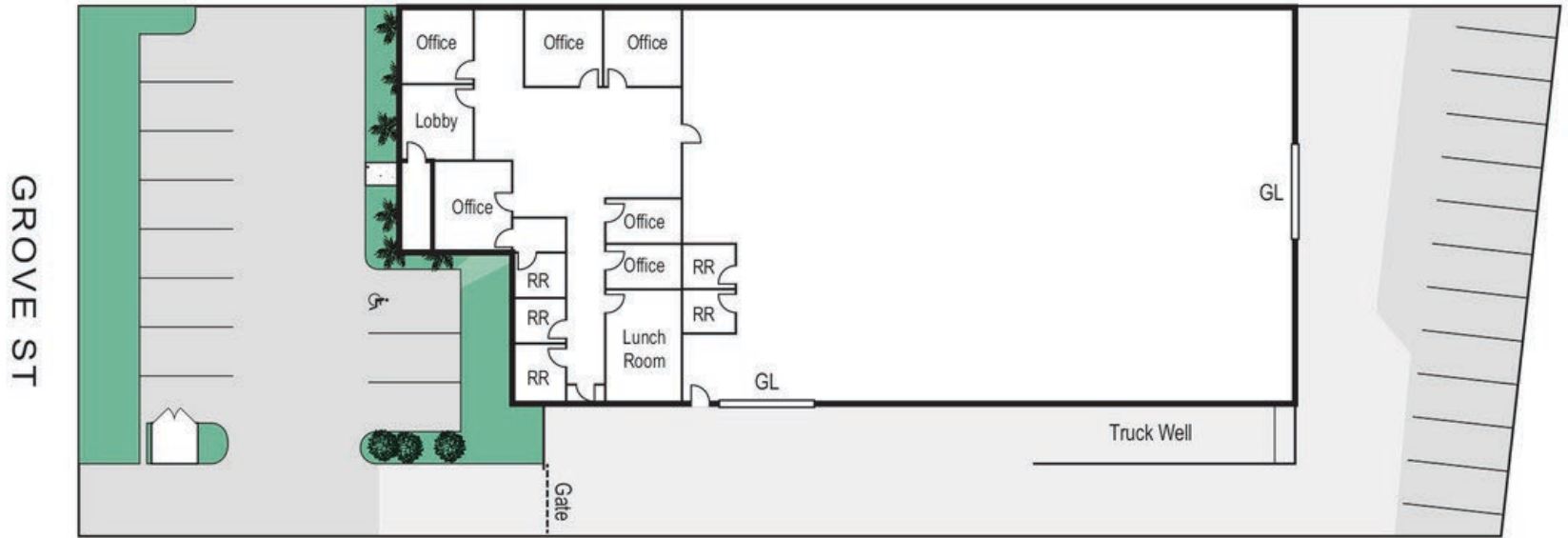

NOT TO SCALE

CONTACT EXCLUSIVE LISTING AGENTS:



NATE ORTEGA
VICE PRESIDENT
P: 562.207.3307
nortega@daumcre.com
CA DRE License #01989242



CASEY MUNGO
E.V.P. | PRINCIPAL
P: 562.207.3307
cmungo@daumcre.com
CA DRE License #01490279



DENNIS HOLT
E.V.P.
P: 949.242.1714
dholt@daumcre.com
CA DRE License #01948978



11,510 SF
FREESTANDING
INDUSTRIAL
BUILDING

FOR LEASE
1168 N. GROVE ST.
ANAHEIM | CA

FOR LEASE



CONTACT EXCLUSIVE LISTING AGENTS:



NATE ORTEGA
VICE PRESIDENT
P: 562.207.3307
nortega@daumcre.com
CA DRE License #01989242



CASEY MUNGO
E.V.P. | PRINCIPAL
P: 562.207.3307
cmungo@daumcre.com
CA DRE License #01490279



DENNIS HOLT
E.V.P.
P: 949.242.1714
dholt@daumcre.com
CA DRE License #01948978

 **DAUM**
COMMERCIAL REAL ESTATE SERVICES

11,510 SF
FREESTANDING
INDUSTRIAL
BUILDING

FOR LEASE
1168 N. GROVE ST.
ANAHEIM | CA



CONTACT EXCLUSIVE LISTING AGENTS:



NATE ORTEGA
VICE PRESIDENT
P: 562.207.3307
nortega@daumcre.com
CA DRE License #01989242



CASEY MUNGO
E.V.P. | PRINCIPAL
P: 562.207.3307
cmungo@daumcre.com
CA DRE License #01490279



DENNIS HOLT
E.V.P.
P: 949.242.1714
dholt@daumcre.com
CA DRE License #01948978

DAUM
COMMERCIAL REAL ESTATE SERVICES

11,510 SF
FREESTANDING
INDUSTRIAL
BUILDING

FOR LEASE
1168 N. GROVE ST.
ANAHEIM | CA



CONTACT EXCLUSIVE LISTING AGENTS:



NATE ORTEGA
VICE PRESIDENT
P: 562.207.3307
nortega@daumcre.com
CA DRE License #01989242



CASEY MUNGO
E.V.P. | PRINCIPAL
P: 562.207.3307
cmungo@daumcre.com
CA DRE License #01490279



DENNIS HOLT
E.V.P.
P: 949.242.1714
dholt@daumcre.com
CA DRE License #01948978



11,510 SF
FREESTANDING
INDUSTRIAL
BUILDING

FOR LEASE
1168 N. GROVE ST.
ANAHEIM | CA



CONTACT EXCLUSIVE LISTING AGENTS:



NATE ORTEGA
VICE PRESIDENT
P: 562.207.3307
nortega@daumcre.com
CA DRE License #01989242



CASEY MUNGO
E.V.P. | PRINCIPAL
P: 562.207.3307
cmungo@daumcre.com
CA DRE License #01490279



DENNIS HOLT
E.V.P.
P: 949.242.1714
dholt@daumcre.com
CA DRE License #01948978









11,510 SF
FREESTANDING
INDUSTRIAL
BUILDING

FOR LEASE
1168 N. GROVE ST.
ANAHEIM | CA



KEY DISTANCES

-  CA-91 0.9 miles
-  CA-55 2 miles
-  CA-57 3.5 miles
-  Port of Long Beach 31.9 miles
-  Port of Los Angeles 34.3 miles
-  John Wayne Airport 15.3 miles

CONTACT EXCLUSIVE LISTING AGENTS:



NATE ORTEGA
VICE PRESIDENT
P: 562.207.3307
nortega@daumcre.com
CA DRE License #01989242



CASEY MUNGO
E.V.P. | PRINCIPAL
P: 562.207.3307
cmungo@daumcre.com
CA DRE License #01490279



DENNIS HOLT
E.V.P.
P: 949.242.1714
dholt@daumcre.com
CA DRE License #01948978



D/AQ Corp. #01129558. Maps Courtesy @Google & @Microsoft. Although all information is furnished regarding for sale, rental or financing from sources deemed reliable, such information has not been verified and no express representation is made nor is any to be implied as to the accuracy thereof, and it is submitted subject to errors, omissions, changes of price, rental or other conditions, prior sale, lease or financing, or withdrawal without notice.