



# AIRPORT BUSINESS CENTER

4750 W WILEY POST WAY, SALT LAKE CITY, UT 84116

**4.5% TO PROCURING BROKER**

**\*Exterior Rendering\***



4750 W...

## PROPERTY INFORMATION

- ✓ 3,455-12,155 SF Available For Lease
- ✓ 4.5% To Procuring Broker
- ✓ Major Renovations To Building Including: 3-Tone Building Paint Scheme, New Asphalt Driveways, New TPO Roof, New Signage, New Xeriscape Landscaping, Building Exterior & Facade, New Signage, Etc.
- ✓ Fiber Available
- ✓ 3 Phase Power/208V
- ✓ One (1) 12'x12' Ground Level Door

- ✓ Clear Height: 14'
- ✓ Fire Sprinkled
- ✓ One (1) Minute To I-80 Access
- ✓ Ample Parking
- ✓ Quick Access To Salt Lake International Airport And Bus Lines
- ✓ Attractive Rate Structures Available
- ✓ Temperature Controlled Warehouse

## CONTACT US

**DEREK KLOPFER**

✉ derek@cresutah.com

☎ 801.897.9264

**COLTER SMITH**

✉ colter@cresutah.com

☎ 801.755.8794

🌐 www.cresutah.com

\$0.90 PSF NNN

\$0.20 PSF NNN/CAMs

\*Year 1 Starting Lease Rate\*

Call Us

**801.876.6070**



█ = 12'x12' GL Door

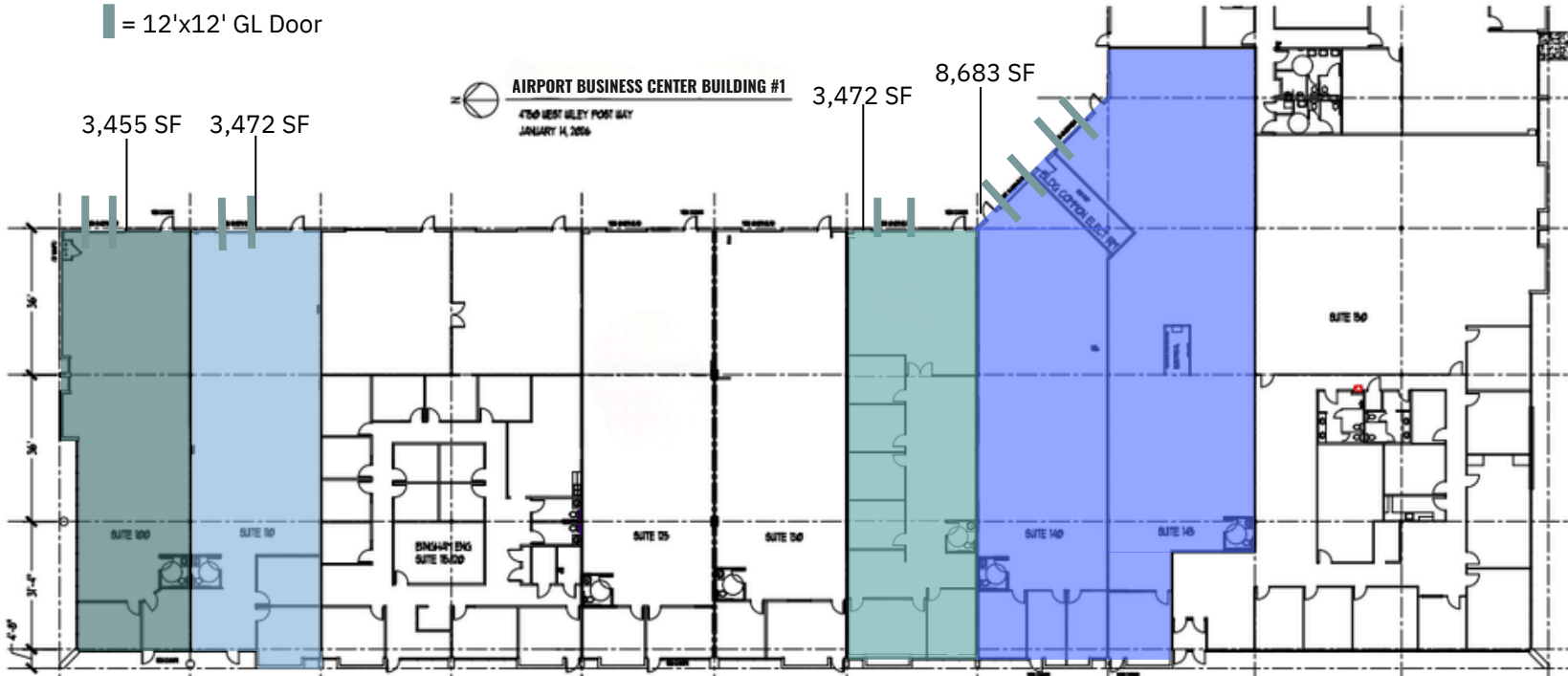

## AVAILABLE SPACE

### ✓ 3,455-6,927 SF Available

- Suite 100: 3,455 SF
- Suite 110: 3,472 SF
- One (1) 12'x12' GL Door Per Unit
- Contiguous: 6,927 SF

### ✓ 3,472-12,155 SF Available

- Suite 135: 3,472 SF
- One (1) 12'x12' GL Door
- Suite 140: ± 8,683 SF
- Two (2) Ground Level Doors



This information is given with the understanding that all negotiations and/or real estate activity related to the property described above shall be conducted through this CRES office. The above information while not guaranteed, was obtained from sources we believe to be reliable.

## CONTACT US

**DEREK KLOPFER**

✉ derek@cresutah.com ☎ 801.897.9264

**COLTER SMITH**

✉ colter@cresutah.com ☎ 801.755.8794 🌐 www.cresutah.com

Call Us  
**801.876.6070** 📞